

W Series Frame Backer Bar

Spec sheet for FCF-BACK

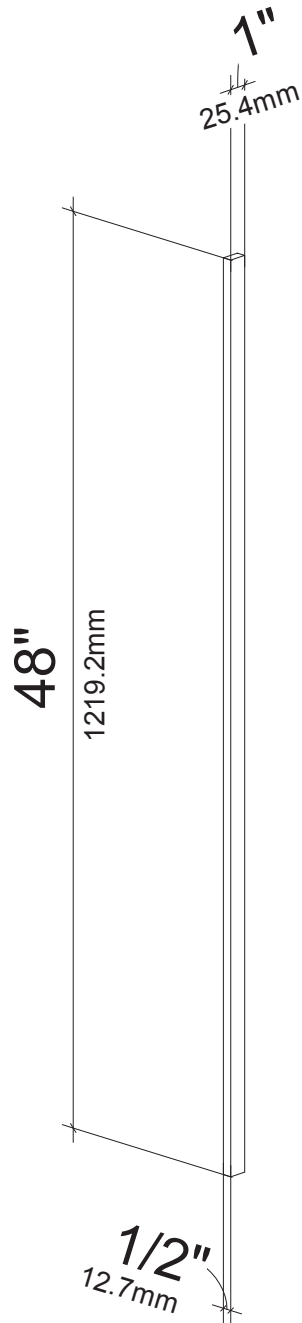

The W Series Frame Backer Bar is required for all W Series Frame displays greater than 60" and with one side of wine racking only.

The Backer Bar must cover a minimum of 12" above and below any connection point between two sections of W Series Frames.



VINTAGEVIEW®
MOVING WINE STORAGE FORWARD