

WineRacks.com  
 Phone 888.687.2517  
 Fax 845.658.5309

8\_5-250-3225-3975

# 7 COLUMN COMPOUND DIAMOND BIN ASSEMBLY INSTRUCTIONS

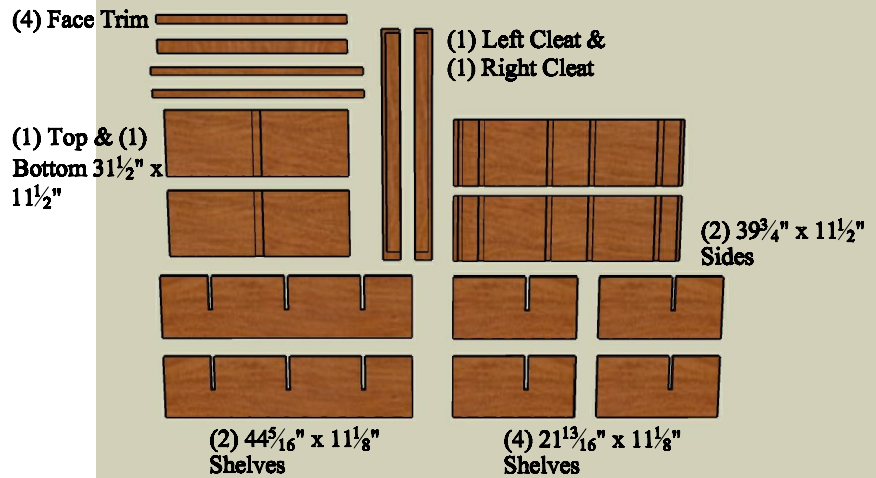

## PARTS LIST



**STEP 1.**  
 ATTACH (2) SIDES TO THE TOP & BOTTOM  
 w/ SCREWS. ENSURE SLOTS ON SIDES  
 ALIGN.



**STEP 2.**  
 ATTACH (1) LEFT & (1) RIGHT CLEAT w/  
 SCREWS

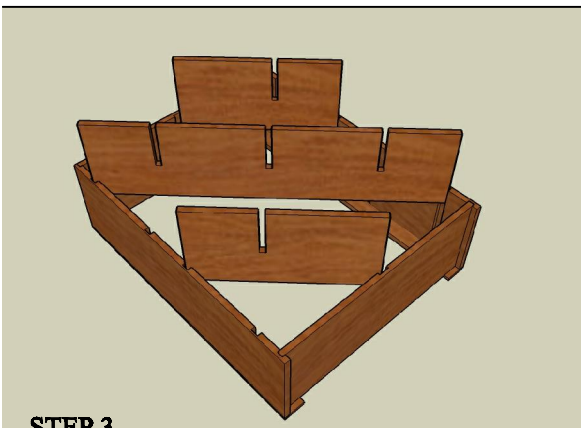

**STEP 3.**  
 FLIP BIN OVER. SLIDE (2) SHORT SHELVES  
 & (1) LONG SLELF INTO SLOTS AS SHOWN.  
 ENSURE SHELF NOTCHES FACE UP.

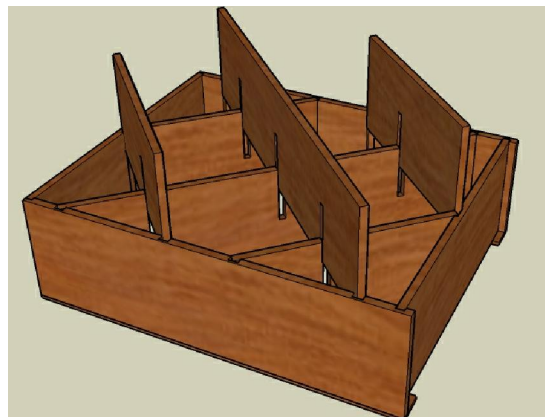

**STEP 4.**  
 SLIDE (2) SHORT SHELVES & (1) LONG  
 SLELF INTO SLOTS AS SHOWN. ENSURE  
 SHELF NOTCHES FACE DOWN.

WineRacks.com  
Phone 888.687.2517  
Fax 845.658.5309

8\_5-250-3225-3975

## 7 COLUMN COMPOUND DIAMOND BIN ASSEMBLY INSTRUCTIONS

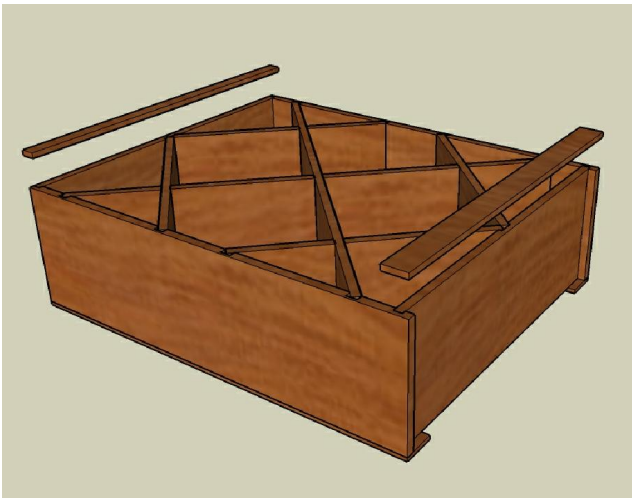

**STEP 5.**  
ATTACH (1)  $2\frac{1}{4}$ " x  $32\frac{1}{4}$ " FACE TRIM TO  
BOTTOM OF BIN. ATTACH (1)  $1\frac{1}{4}$ " x  $32\frac{1}{4}$ "  
FACE TRIM TO TOP OF BIN w/ FINISH  
NAILS.

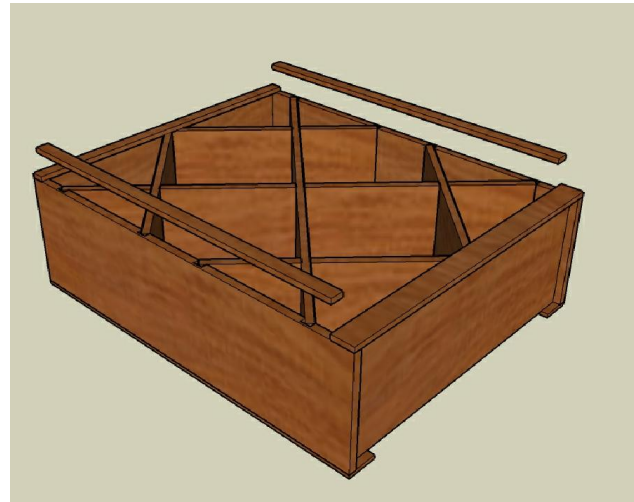

**STEP 6.**  
ATTACH (2)  $1\frac{1}{4}$ " x  $36\frac{1}{4}$ " FACE TRIM TO  
SIDES OF BIN w/ FINISH NAILS