

- Extremely resistant to weather, dirt or impact of stones and also immune to vibration
- Simple and timesaving mounting: belt must not be devided due to a devidable probe
- Can be used in the proximity of frequency converters
- Low difference in sensitivity on different sensing heights above the belt
- CE-certified

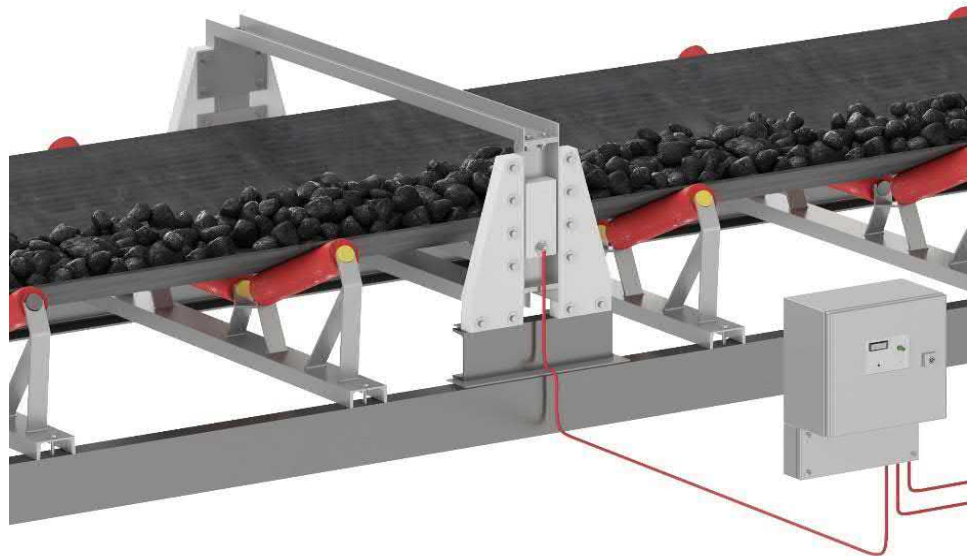

- Average sensitivity (from M40 nuts)
- Nearly homogeneous sensitivity on the belt and in the upper layers of the product
- Can be used close to frequency converters, only 1 m minimum distance between probe and motors or magnets
- Passage widths from 1 m to 2.4 m and heights can be adjusted as required
- Extremely robust design
- Very simple operation
- Monitoring and display of internal parameters. (Helpful when calling for telephone support).



Metal detector PSQ RA in the recycling industry.

Function:

The PSQ RA series of metal detector (operating with a frame-probe) detects all kinds of metal, which means not only iron, but also aluminium, stainless steel, copper or mild steel.

The specialty of this detector is a low difference between edge and center of probe aperture. Therefore it is especially suitable if the depth of burden on the belt is more than 600 mm. Its frame can be divided and easily be built around the belt.

This metal detector prevents damage, avoids downtimes and produces significant savings on repair costs.

Scope of Delivery:

- Detection unit/frame probe
- Controller in steel or stainless steel housing (wall mounting, 14 kg)

Application:

- Protection of tools and machines from metal parts such as nails or screws
- Monitoring of particularly large and heavy products in Recycling, Mining or Slag processing

Dimensions of Frame Probe

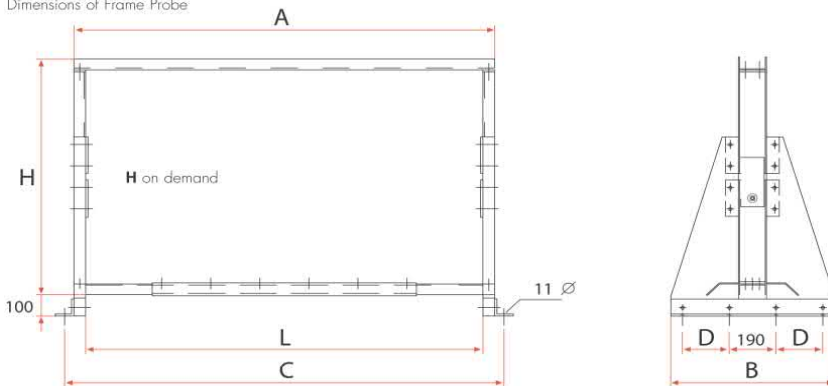

nominal probe size	A (mm)	B (mm)	C (mm)	D (mm)	L (mm)	for belt width (mm)
1000	1250	600	1310	160	1150	1000
1200	1500	600	1560	160	1400	1200
1400	1700	600	1760	160	1600	1400
1600	1900	600	1960	160	1800	1600
1800	2100	700	2180	210	2000	1800
2000	2300	700	2380	210	2200	2000
2200	2500	700	2580	210	2400	2200
2400	2700	700	2780	210	2600	2400

Specifications:

Electronics	digital signal processor, noise filter, digital balance control, digital frequency control, PowerDrive circuit
Input	1 coaxial cable, probe
Output Signals	<p>Metal alarm: 1 relais with 2 floating changeover contacts, switching capacity 230 V 5 A resistive load, switchable between normally relaxed or normally activated mode</p> <p>Fault signal: 1 relais with 2 floating changeover contacts, switching capacity 230 V 5 A resistive mode</p>
Metal Detection	ferrous, non-ferrous (e.g. aluminium or copper) und stainless steel
Belt Widths	1,000 – 2,400 mm
Protection Type	Control box: IP 55 Frame probe: IP76
Ambience	Control box: -20° C up to +55° C Frame probe: for execution PE up to +60° C for execution PA6.6 up to +120° C
Product Temperature	---
Power Supply	110-230 V, 50/60 Hz, typ. consumption 15 VA
Material	Control box: steel or stainless steel, grey RAL 7032, electrophoretic dipcoating Frame probe: stainless u-structure steel Support for mounting: PE or PA6.66



CASSEL Quality Promise:

Every single device is thoroughly tested during and after production. Before delivery from the factory it is tested over several days subjected to a final inspection.

Contact:

CASSEL Messtechnik GmbH
In der Dehne 10
37127 Dransfeld
phone: +49 (0) 5502 911 50
fax: +49 (0) 05502 911 532
email: info@cassel-inspection.com

