

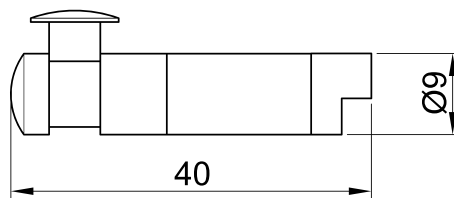

SLIM S.r.l.

Via dei Tigli, 14/16 (Z.I.)
20853 - Biassono (Monza Brianza) - Italy
commerciale@slim.it
www.slim.it

CODE: **FQ/TP/G**

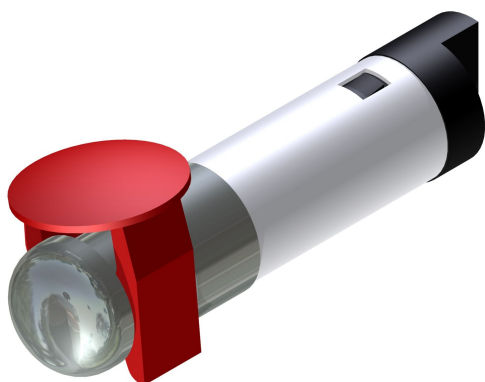

Light indicator with a device for quick connection

The front panel's connected lens is fitted with the indicator's body set on the back of the panel in correspondence of the drilling template

The light indicator is set parallel to the panel to reduce the internal encumbrance

Lamps	incandescent • neon/fluoro • LED
Working Voltage	2V • 6V • 12V • 24V • 48V • 110V • 250V • 400V
Working temperature	120°C Max • 150°C Max
Hole diameter	5mm x 10mm
Recommended thickness panel	from 0,8mm to 1,5mm
Method of connection to the panel	self-locking
Type of connection	quick connection
Type of lens	G1 • G2

Lenses available

