

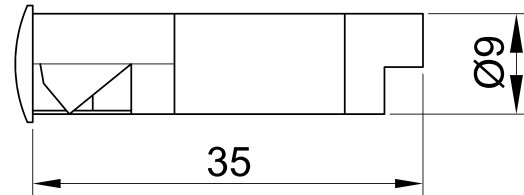

SLIM S.r.l.

Via dei Tigli, 14/16 (Z.I.)
20853 - Biassono (Monza Brianza) - Italy
commerciale@slim.it
www.slim.it

CODE: **FQ/SA**

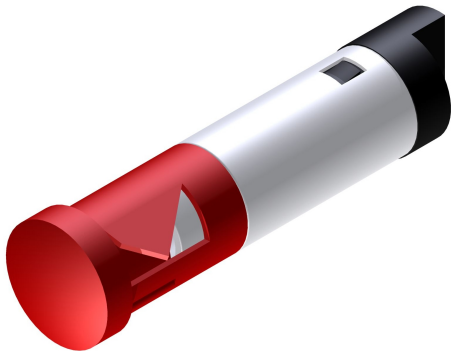

Light indicator with a device for quick connection

Light indicator with self-locking connection

It can be supplied with mounted or separated lens

Lamps	incandescent • neon/fluoro • LED
Working Voltage	2V • 6V • 12V • 24V • 48V • 110V • 250V • 400V
Working temperature	120°C Max • 150°C Max
Hole diameter	9mm
Recommended thickness panel	from 0,8mm to 2mm
Method of connection to the panel	self-locking
Type of connection	quick connection
Type of lens	DL2 • SA1 • SA2 • SA3 • SA4 • SA5 • SA6 • SA7 • SA8 • SA9

Lenses available

<p>DL2</p>	<p>SA1</p>	<p>SA2</p>	<p>SA3</p>	<p>SA4</p>
<p>SA5</p>	<p>SA6</p>	<p>SA7</p>	<p>SA8</p>	<p>SA9</p>