

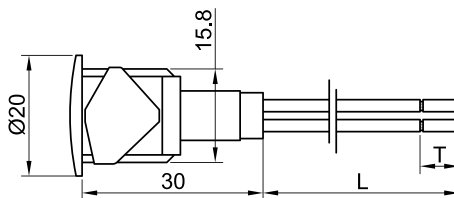

SLIM S.r.l.

Via dei Tigli, 14/16 (Z.I.)
20853 - Biassono (Monza Brianza) - Italy
commerciale@slim.it
www.slim.it

CODE: TB/016/SH

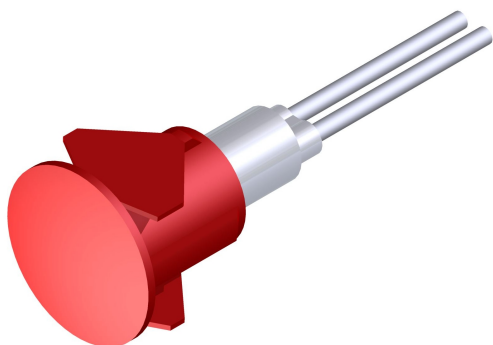

Light indicator with self-locking connection

Lamps	incandescent • neon/fluoro • LED
Working Voltage	2V • 6V • 12V • 24V • 48V • 110V • 250V • 400V
Working temperature	90°C Max • 120°C Max • 150°C Max
Hole diameter	16mm
Recommended thickness panel	from 0,5mm to 2,5mm
Method of connection to the panel	self-locking
Type of connection	PVC cable • silicone cable • silicone-glass cable
Wire ends	on request
Tipo di lente	SH3

Lenses available

