

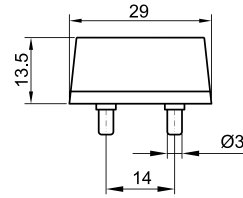

SLIM S.r.l.

Via dei Tigli, 14/16 (Z.I.)
20853 - Biassono (Monza Brianza) - Italy
commerciale@slim.it
www.slim.it

CODE: **SL/RR**

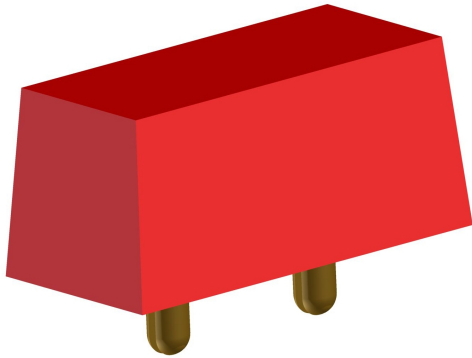

Trapezoidal light indicator with pins

Base's dimensions 30 x 15mm

Lamps	incandescent • neon/fluoro • LED
Working Voltage	2V • 6V • 12V • 24V • 48V • 110V • 250V • 400V
Working temperature	120°C Max • 150°C Max
Base dimensions	30 x 15mm
Type of connection	pins Ø3mm