

PISTON PUMP MONITORING.



MEASURE TEMP AND PRESSURE

Measure important attributes of pump health from case drain.



STREAMLINED SENSOR PACK

In-line sensing requires minimal amount of work for installation of units.



INSTANT REMOTE MONITORING

Get instant notification when pump is operating out of spec via email.



SIMPLE CASE DRAIN MONITORING

Case drain has been known as the holy grail for insights to pump health.

AN INDUSTRY IN NEED.

It is no secret that the pump is the heart of every hydraulic system. So why isn't there a smart device for pump monitoring? We asked the same question and decided to change that.

The PumpMD™ provides critical first alerts for your workhorse axial piston pumps. This cost-effective sensor pack allows you to scale across your fleet of pumps and manage PM schedules around real-time performance data.



Your IoT Diagnostics Distributor: **Airline Hydraulics Corp**



800-999-7378



leads@airlinehyd.com



Throughout the Northeast
from Maine to Virginia

**ORDER
NOW!**

GETTING YOUR PUMPMD CONNECTED

THE POWER OF OUR IoT ASSIST.

The IoT Assist is our device setup tool that overcomes the complexities of connectivity and configuration.

- ✓ **FREE DOWNLOAD**
Available to download on Apple Store and Android Market.
- ✓ **SET ALARM THRESHOLD PARAMETERS**
Set the pressure and temperature alarm to receive a notification when exceeded via email.
- ✓ **QUICKLY CONFIGURE TO NETWORK**
Input Wi-Fi network credentials to get device on the network.
- ✓ **GET DEVICES INTO IOT DATA EXPERIENCE**
Automatically puts PumpMD into your specific IoT data experience dashboard for remote monitoring.

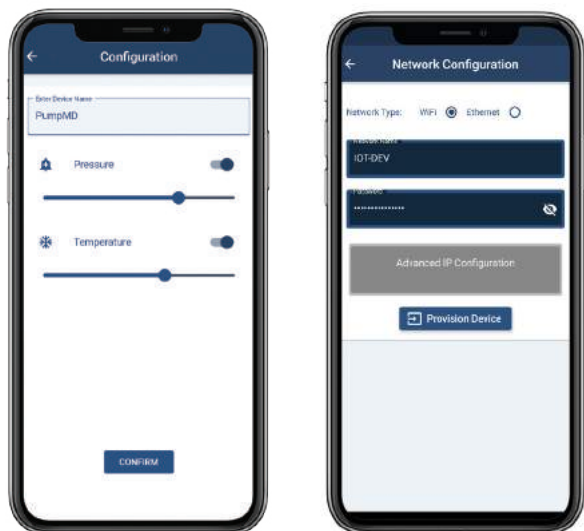

THE POWER OF OUR IoT DATA EXPERIENCE.

Our IoT Data Experience unlocks real-time, secure remote monitoring, and predictive analytics for your products. It's the gasoline for your machine learning engine. Easily manage your service online.

- ✓ **REAL-TIME DATA**
See up-to-the minute performance data from any device, anywhere in the world.
- ✓ **NOTIFICATIONS**
The ability to set notifications when assets are operating out of spec.
- ✓ **DATA STORAGE & SECURITY**
Review up to 6 months of historical trending data, and assurance that devices are receiving latest security and performance updates.
- ✓ **COMMISSIONING & SCALING**
Simplified experience for bringing new sensing capabilities online.

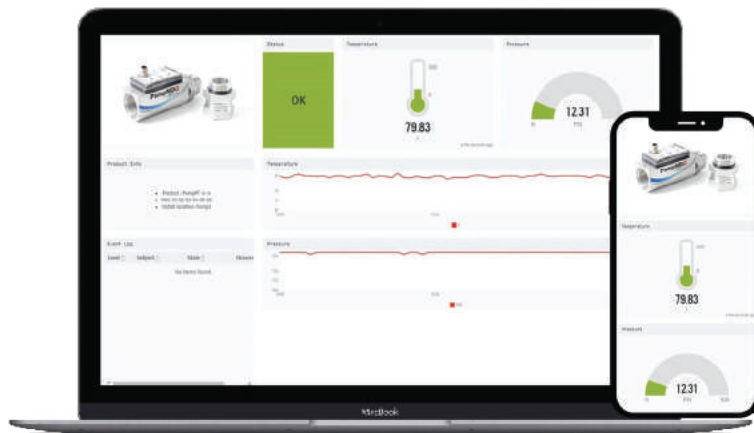

PUMPMD TECHNICAL DATA

Power	
Supply Voltage	12 - 24VDC M12 5pin
Current Consumption	Max: 250mA

Wireless	
Radio	Wi-Fi 802.11 b/g/n Wi-Fi channel 2.4GHz
Antenna	Built-in Range: 20-30 ft.
Security	WPA/WPA2/WPA2-Enterprise
Net Data Throughput	Up to 150Mbps of data rate
RF Output Power	Up to 20.5dBm
Sensitivity	-98dBm

Environmental	
Storage Temperature	0-175 °F
Operating Temperature	0-175 °F
Operating Pressure	0-100 PSI
Fluid Type	Mineral Based Hydraulic Fluids
Materials Used	Aluminum 6061 - T6 & Polycarbonate

Measurements		
MEASUREMENTS	PRESSURE	TEMPERATURE
Calibrated Range	0-50 PSI	100-175 °F
Accuracy of Calibrated Range	1.25%	+/- 2.5 °F
Analog 0-10V Scale*	-12.5 to 112.5 PSI	-21.875 to 196.875 °F
*Signal below 1V rounds to 0V and above 9V rounds to 10V		

Technology	
Sample Rate	Pressure: 10bit @ 1Hz Temp: 10bit @ 2Hz
Data Push (To Web App)	Once every minute (pressure, temperature)
Information Security	HTTPS TLS v1.2 encryption
Networking	Unique MAC address
Software Updates	Over-the-air (OTA) firmware updates
M12 Pin-Outs	Brown - Pin1/Supply in 24VDC White - Pin2/Analog Out - 0-10VDC (Temp) Blue - Pin3/Supply 0VDC Grey - Pin5/Analog Out - 0-10VDC (Pressure)

Dimensions					
Threaded Ports (UNF)	3/4"-16	7/8"-14	1-1/16"-12	1-5/16"-12	1-5/8"-12
Aluminum Body	L: 4" W: 2" H: 1"	L: 4.5" W: 2" H: 1.5"	L: 4.5" W: 2" H: 1.5"	L: 4.5" W: 2" H: 2"	L: 4.5" W: 2" H: 2"
Connector	M12 5pin male	M12 5pin male	M12 5pin male	M12 5pin male	M12 5pin male

PUMPMD DIMENSIONAL DRAWINGS

UNITS: INCHES

SAE #8

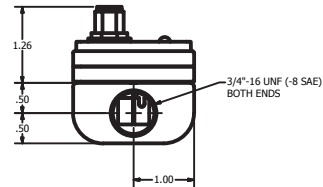
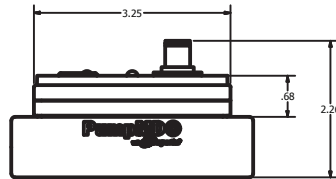
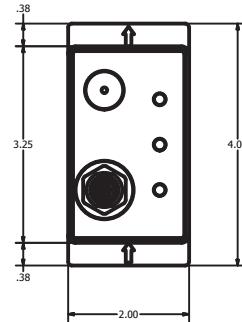
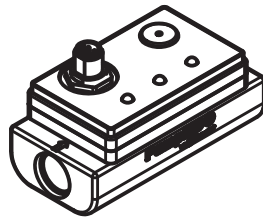

SAE #10

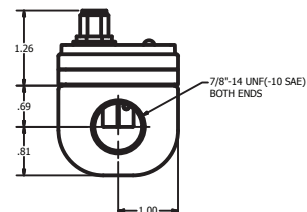
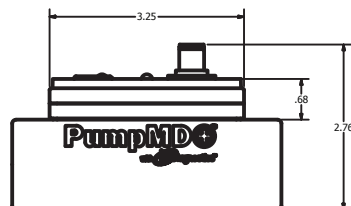
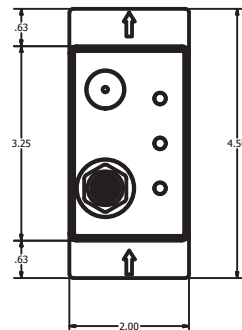
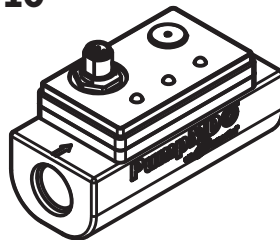

PUMPMD DIMENSIONAL DRAWINGS

UNITS: INCHES

SAE #12

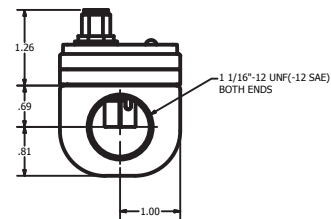
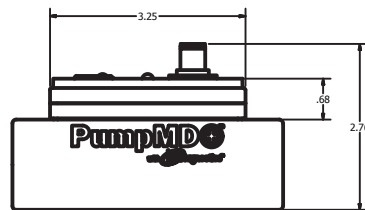
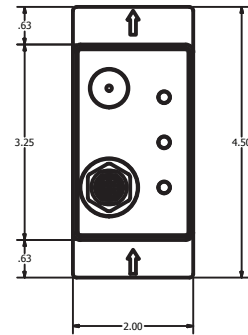
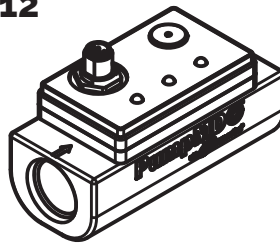

SAE #16

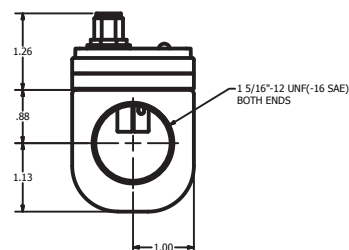
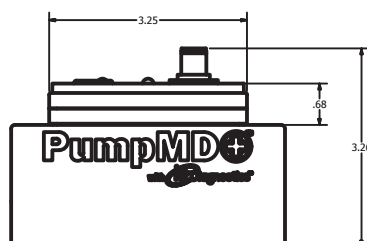
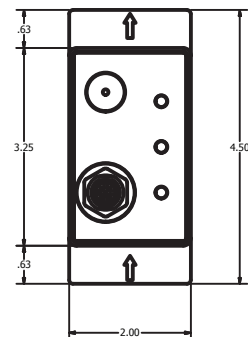
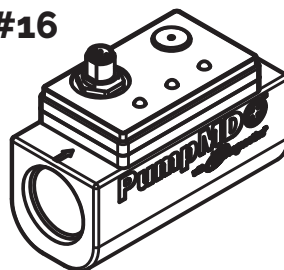

PUMPMD DIMENSIONAL DRAWINGS

UNITS: INCHES

SAE #20

