



# UPLANDS TERRACE APARTMENTS

6117 Uplands Drive  
Nanaimo, BC

## MAYNE

### 873 sq ft



**CABINETY:**  
FLAT PANEL

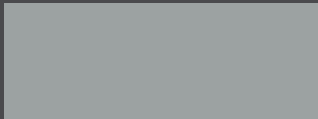

**COUNTERS:**  
QUARTZ



**FLOORING:**  
LUXURY  
VINYL PLANK

**PRIMARY BEDROOM:**  
11' x 9'10"

**LIVING ROOM:**  
11' x 11'7.5"

**BEDROOM:**  
9'6.5" x 9'1.5"



**DEN:**  
5'7" x 5'1"

**KITCHEN:**  
9'4" x 10'1"

**LAUNDRY ROOM:**  
STACKED WASHER/DRYER

All suite measurements are preliminary based on current building concept and unit configurations and are subject to change.  
[uplandsterrace.ca](http://uplandsterrace.ca)



# UPLANDS TERRACE

APARTMENTS

6117 Uplands Drive  
Nanaimo, BC

---

MAYNE

**873** sq ft

---

## First Floor Suite 116

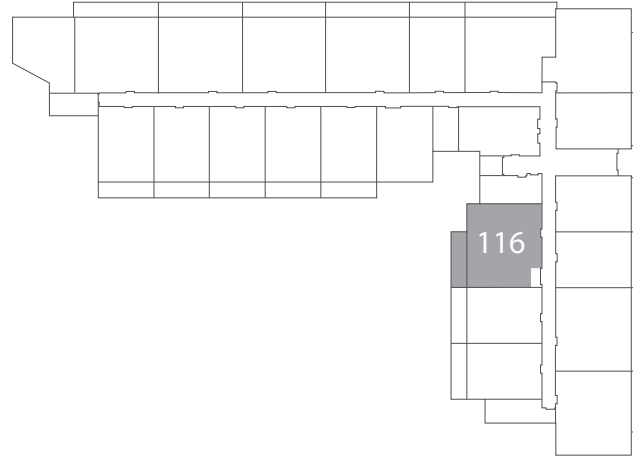

## Second Floor - Fifth Floor Suites 216, 316, 416, 516

