

FACS MOBILE APP TIPS

STATE OF HAWAII

DEPARTMENT OF TRANSPORTATION

HIGHWAYS DIVISION

E-CONSTRUCTION



FACS Mobile App Tips

OVERVIEW

The FACS E-Construction Platform can be accessed from both an iPhone and iPad. Many users find the iPhone easier to use since it fits easily within your hand. This allows for easy photo taking and data entry mimic the process used to write text messages.

The following slides show additional tips that can be used from the iPhone for the FACS app to make recording information in the field as easy as possible.



FACS Mobile App Tips

TAKING PHOTOS FROM THE APP

Photographs can be taken inserted directly through the app.

To take and insert a photograph, go to the Reference section, click on the Blue button with the Plus sign, and then click on the Camera button.

Enter any notes or dates to be associated with the picture.

Note: if photograph enhancements are to be made, the pictures will need to be downloaded first. FACS does not have a built-in photo editor



FACS Mobile App Tips

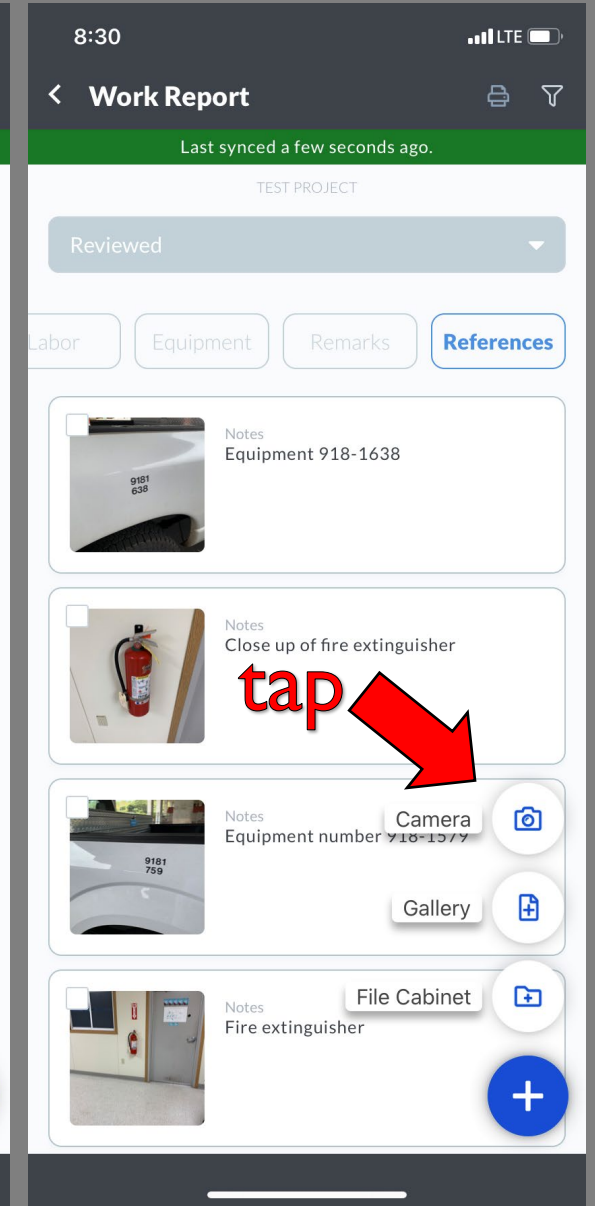
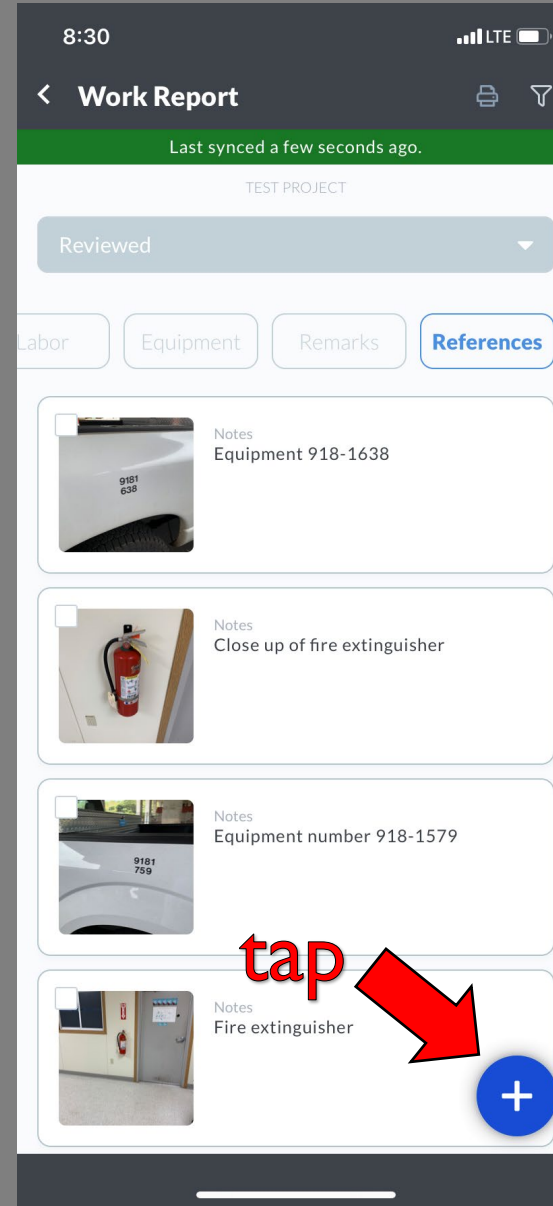

ENHANCE PHOTOS

You can make many adjustments to your photos from the Photos app before, or while, loading the photos into FACS.

1. Select **Edit** on the top right of the photo.



2. The options at the bottom allow you to change the contrast/color and orientation of the photo.

Select the three horizontal dots at the top to access the Markup feature.



FACS Mobile App Tips

ENHANCE PHOTOS

You can make many adjustments to your photos from the Photos app before, or while, loading the photos into FACS.

3. Click **Markup**

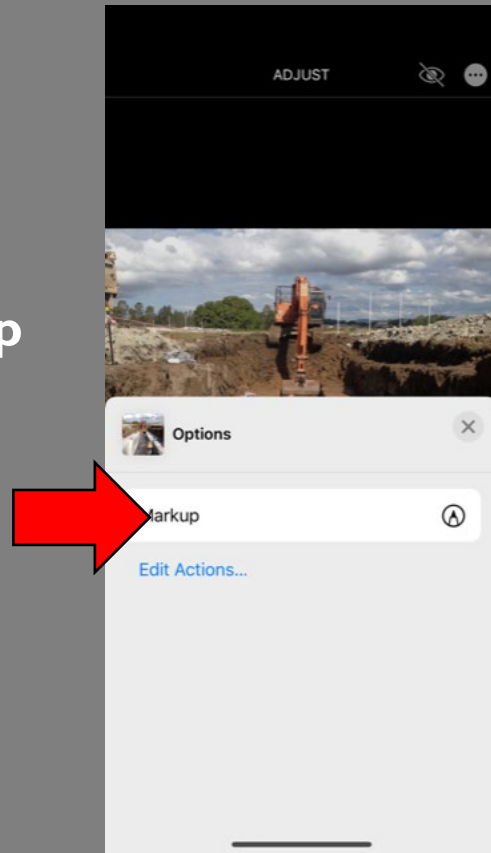

4. The **Markup** tool allows for drawings to be applied directly to field photos.



FACS Mobile App Tips

MEASURE

The Measure app will make it easy to measure the distance in the field

All you need to do is trace the distance using the app and it will tell you how long they are.

1. Open the app and you will see the option to Move the iPhone to start.
2. Eventually a circle will appear and the option to add a point.
3. Add points and the app will tell you how many cm between them.

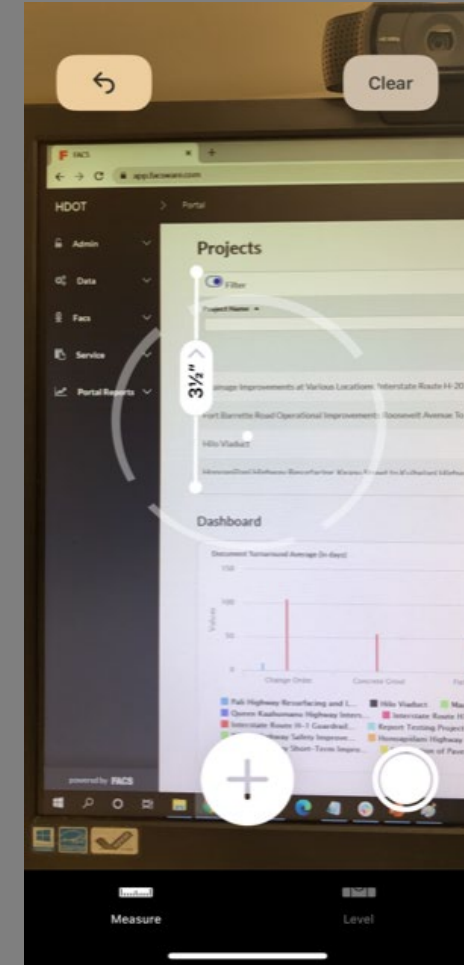
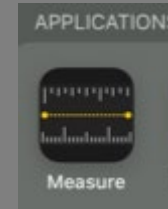

FACS Mobile App Tips

SWITCH DIRECTIONS IN PANORAMA MODE

You can change the direction of your Panorama photograph in the Camera app by tapping the arrow that appears in the middle of the screen in the Panorama mode.

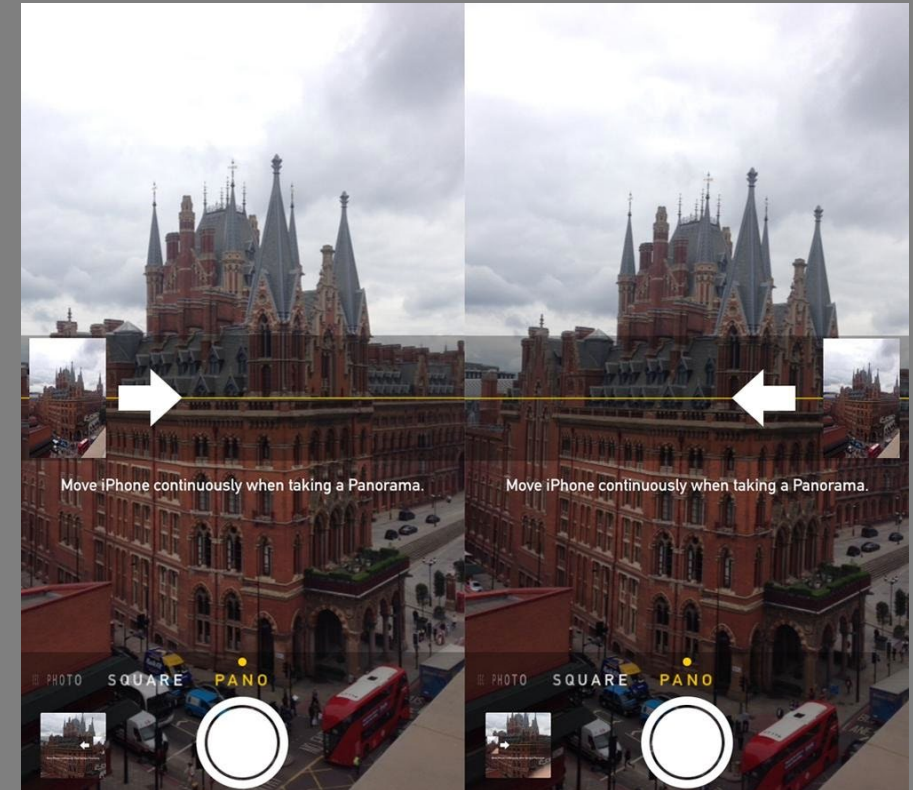

ADDING TEXT BY VOICE

To avoid typing mistakes caused by “fat” fingers, add text to most of the input fields (non-date or pulldown menu input fields) using the voice memo option - tap in the Notes input field, tap on the microphone icon, and then speak into the iPhone’s microphone

Editing of the text may be required as the microphone may pickup background noise or may interpret your words differently based on pronunciations or use of pidgin English

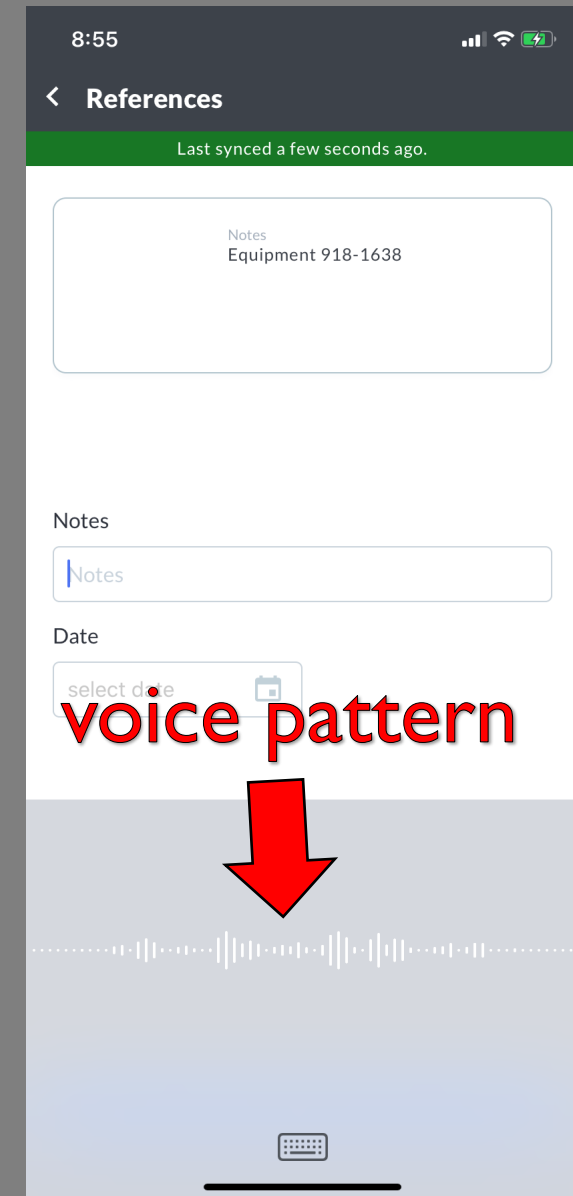
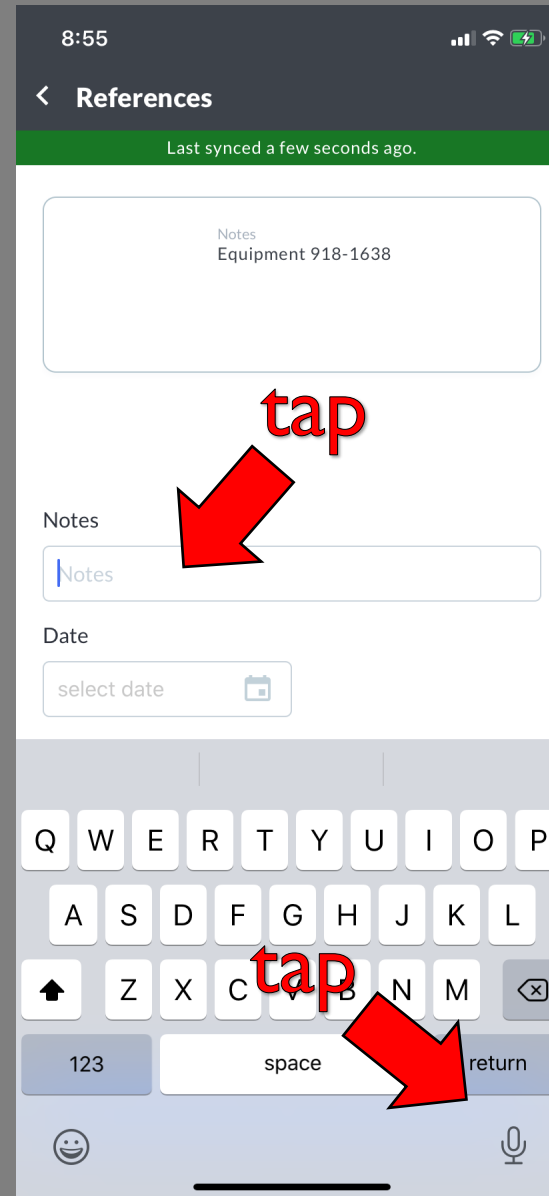

DOUBLE TAP SPACEBAR FOR PERIOD

One of the simplest ways to add a period at the end of sentence while typing text is by double tapping on the spacebar.

This can be much faster than tapping on the “123” button and then tapping on the period button.

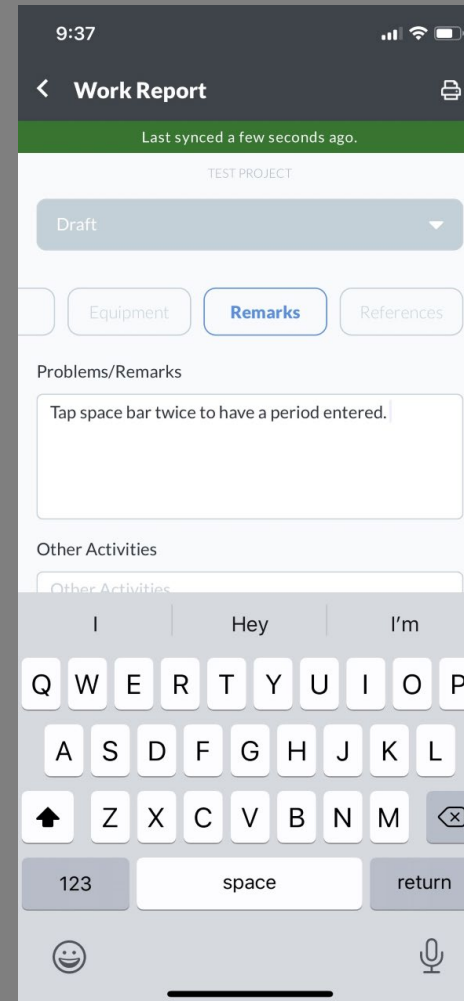

PRINT TO SEE THE FULL ENTRY

- Click the print icon in the top right corner of any Entry, or from the Log page, to see the printer friendly pdf version of the entry. This is a quick way to see all data entered in an Entry without scrolling through each Section.
- The printer icon is only available while online.

9:49

< Work Report

Print Delete

Last synced a few seconds ago.

Pali Highway Resurfacing and Lighting Replacement

☐

REPORT DATE: 09/08/2020

ID: 0915H

STATUS: Submit

INSPECTOR: Josh Kephart

PAY PERIOD:

CONDITION: Overcast

☒

REPORT DATE: 09/04/2020

ID: 0911E

STATUS: Submit

INSPECTOR: Donaven Chong

PAY PERIOD:

CONDITION: Clear

☐

REPORT DATE: 08/05/2020

ID: 0881H

+

9:49

< PDF View

Last synced a few seconds ago.

STATE OF HAWAII DEPARTMENT OF TRANSPORTATION HIGHWAYS DIVISION

Work Report

Contract No. 80306 Charge Code 1029 P.A.P. No. 80401-1029 Pali Highway Resurfacing and Lighting Replacement Qualifying Item: 30 Island Duty District: Honolulu & Koolaula

DESCRIPTION

ID: 0911E Inspector: Donaven Chong

Report Date: 09/04/2020 STATUS: SUBMIT

Pay Period

TIME

Contractor: SHR 09:00 Contractor: SHR 15:00

Start

Contractor: 6 End

Total Time

WEATHER

Condition: Clear Rain Amount:

Time Measured

Rain Comments: No Data

ITEMS

No Data

REMARKS

HDOT - Pali Highway Resurfacing and Lighting Replacement - Work Report

15

STATE OF HAWAII DEPARTMENT OF TRANSPORTATION HIGHWAYS DIVISION

Work Report

Contract No. 80306 Charge Code 1029 P.A.P. No. 80401-1029 Pali Highway Resurfacing and Lighting Replacement Qualifying Item: 30 Island Duty District: Honolulu & Koolaula

Problems/Remarks

Pali Hwy Contractor: GPS Sta. 45+50+/-, 54+50+/-, 66+50 and 51+50+/- Mangrove: Ruston, Derek, Kevin, Terry Equipment: 2 Rollback and mobile powder Contractor: added a mobile traffic construction PSDS on the left shoulder at

9:49

< PDF View

Last synced a few seconds ago.

STATE OF HAWAII DEPARTMENT OF TRANSPORTATION HIGHWAYS DIVISION

Work Report

Contract No. 80306 Charge Code 1029 P.A.P. No. 80401-1029 Pali Highway Resurfacing and Lighting Replacement Qualifying Item: 30 Island Duty District: Honolulu & Koolaula

DESCRIPTION

ID: 0911E Inspector: Donaven Chong

Report Date: 09/04/2020 STATUS: SUBMIT

Pay Period

TIME

Contractor: SHR 09:00 Contractor: SHR 15:00

Start

Contractor: 6 End

Total Time

WEATHER

Condition: Clear Rain Amount:

Time Measured

Rain Comments: No Data

ITEMS

No Data

REMARKS

HDOT - Pali Highway Resurfacing and Lighting Replacement - Work Report

15

STATE OF HAWAII DEPARTMENT OF TRANSPORTATION HIGHWAYS DIVISION

Work Report

Contract No. 80306 Charge Code 1029 P.A.P. No. 80401-1029 Pali Highway Resurfacing and Lighting Replacement Qualifying Item: 30 Island Duty District: Honolulu & Koolaula

Problems/Remarks

Pali Hwy Contractor: GPS Sta. 45+50+/-, 54+50+/-, 66+50 and 51+50+/- Mangrove: Ruston, Derek, Kevin, Terry Equipment: 2 Rollback and mobile powder Contractor: added a mobile traffic construction PSDS on the left shoulder at



QUICK ACCESS MENU

Swiping from the top right corner of the iPhone will open the Quick Access Menu. Use this menu to quickly access to many key settings like Wi-Fi, Brightness, Calculator and the Camera.

The Quick Access Menu can even be accessed while the phone is locked, saving an extra step of having to unlock the phone to take a quick photo.



END OF TIPS



FACS Mobile App Tips