

90° Post Foot Rail Bracket

2" OD

The angular design of our 90° bar foot rail brackets accent the look of your foot rail system, while the finish seamlessly matches your bar rail tubing.



Perpendicular arm and foot for equal contact.



Sleek, straight, and secure design.



Dependable support for metal tubing.

Standard Finishes

Brushed Brass	Polished Brass	Brushed Stainless	Polished Stainless
Antique Brass	Pewter	Matte Black	Gunmetal Grey
Sunset Copper	Oil Rubbed Bronze		

Custom Order Finishes

Antique Bronze	Antique Copper	Blackened Steel

Custom finishing is available upon request.

Dimensions

(H)	Height	7.00"
(W)	Width	7.00"
(D)	Diameter	2.01"
(CP)	Center Point	5.89"

Included Hardware

(8)	#10 1-1/2" mounting screws
(1)	#8 3/4" self-drilling set screw

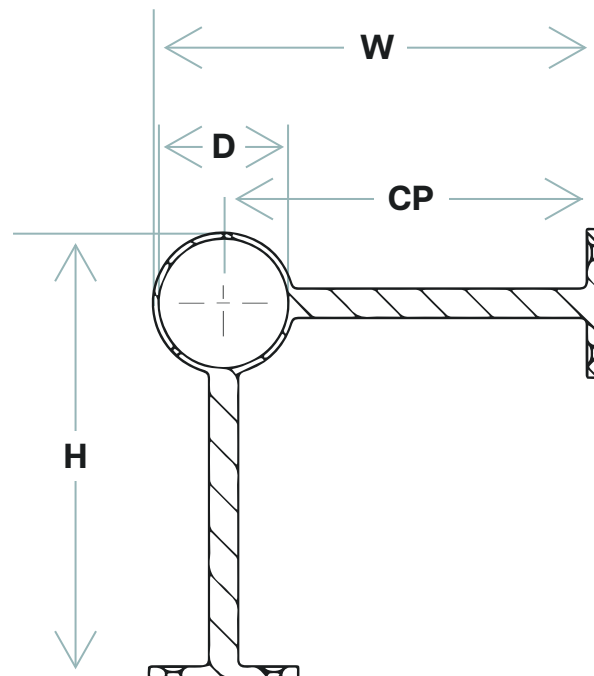

Installation

1. Measure and mark holes for mounting screws.
2. Attach brackets to the face of the bar and floor with the 8 mounting screws.
3. Secure tubing to bracket by fastening set screw through hole in the bottom of bracket.

Care and maintenance varies by finish. Given the nature of the product, typical wear and tear may be noticed with your bar rail over time, such as scuffs, scratches, and dirt.

Visit [Kegworks.com/care-guide](https://www.kegworks.com/care-guide) to read our guide on how to properly prep, clean, and maintain all bar rail finishes.

Complete The System

Make sure to get all the necessary components to complete your bar rail system.

