

# 90° Flush Elbow

1.5" OD

The flush elbow fitting turns a bar foot rail at a 90° angle, connecting two sections of bar rail tubing.



Angled elbow fitting that allows bar rail to wrap around corners.

## Standard Finishes



Brushed Brass



Polished Brass



Brushed Stainless



Matte Black



Oil Rubbed Bronze

*Custom finishing is available upon request.*



Elbow fitting slides into tubing for a straight flush look

## Dimensions

(W)	Width	2.66"
(H)	Height	2.66"
(D <sub>1</sub> )	Diameter 1	1.5"
(D <sub>2</sub> )	Diameter 2	1.38"

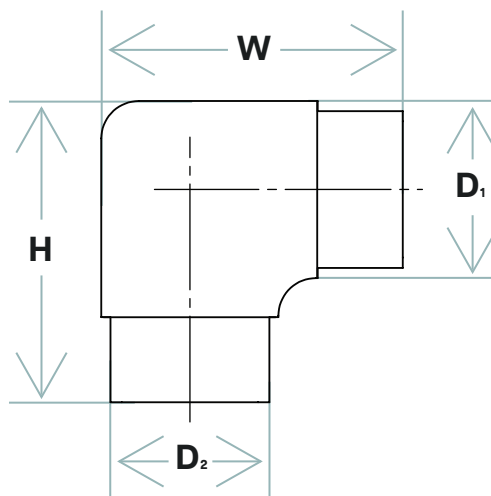

## Installation

1. Completely secure the first section of bar rail tubing to the bar face or wall.
2. Insert elbow fitting into the end of the secured section of tubing.
3. Connect the second piece of tubing to the elbow fitting before securing to bar.
4. Secure the second section of bar rail tubing to bar face.

## Complete The System

Make sure to get all the necessary components to complete your bar rail system.

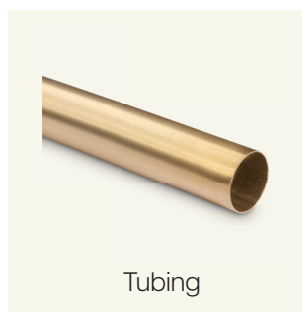

Tubing



End Caps

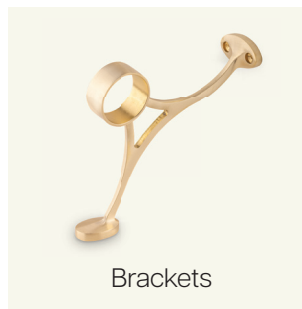

Brackets

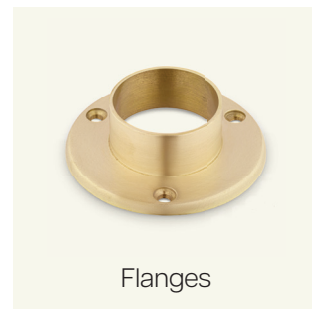

Flanges

Care and maintenance varies by finish. Given the nature of the product, typical wear and tear may be noticed with your bar rail over time, such as scuffs, scratches, and dirt.

Visit [Kegworks.com/care-guide](https://www.kegworks.com/care-guide) to read our guide on how to properly prep, clean, and maintain all bar rail finishes.