



THE ASIMOV TOWER



View from the highway



Have a drink on the terrace with a fantastic view...



Bird's eye view of the tower in the park



Bird's eye view of the tower and the river

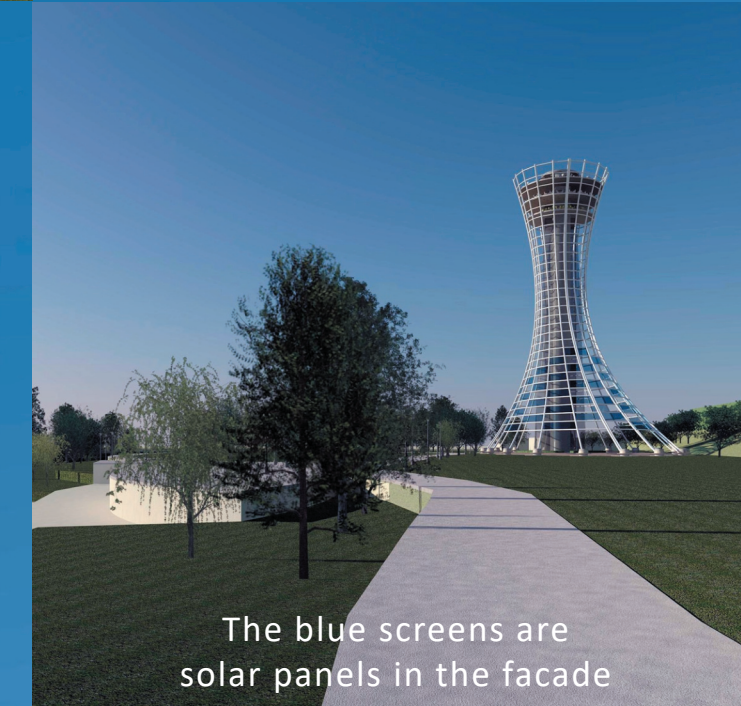

The blue screens are solar panels in the facade



The entrance with elevators...



Read a book in the park...



The Asimov Tower, a new icon for San Jose, California, USA. In the middle of Silicon Valley, the area where the world's largest and most important tech-companies are housed, such as Apple, Microsoft, Alphabet and Facebook ... a new tower with a question and a message. Do we not make ourselves superfluous if we develop superior artificial intelligence? At least every hour it reminds the viewer of the 3 laws of robotics ethics by science-fiction writer Isaac Asimov.

IF: A robot may not injure a human being or, through inaction, allow a human being to come to harm.

THEN: A robot must obey the orders given it by human beings except where such orders would conflict with the First Law.

ELSE: A robot must protect its own existence as long as such protection does not conflict with the First or Second Laws.

The new tower will become part of the Arena Green Park park and is placed next to the highway, as much as possible in the space between the existing buildings. The tower is 200 ft high and has a roof terrace with views over the surrounding area. A restaurant and bar are located on the floors below.



the Asimov Tower

Site map



THE ASIMOV TOWER



View from the highway

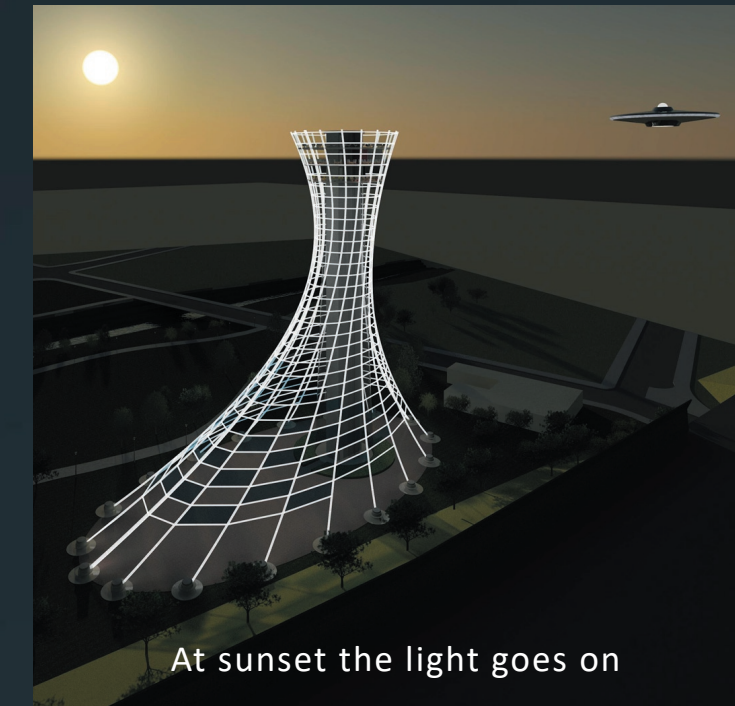

At sunset the light goes on

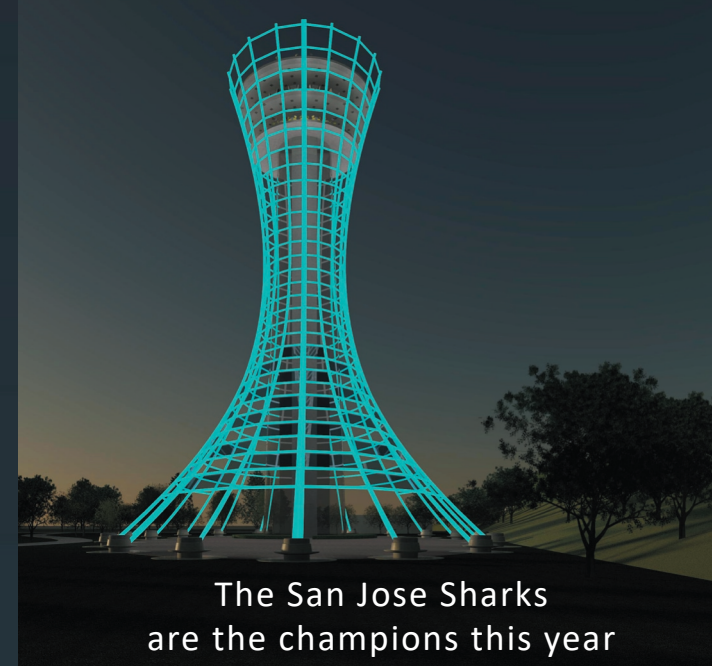

The San Jose Sharks are the champions this year



And the new president is a democrat

Every hour a short message from Isaac Asimov for Silicon Valley

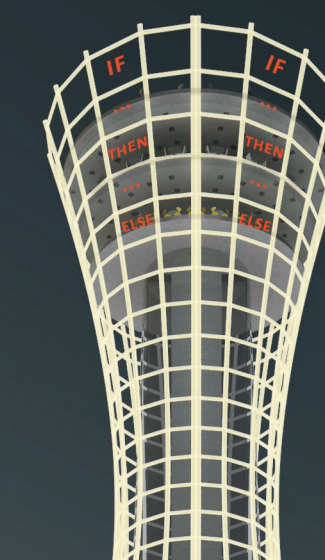

The bar on the 1st floor



And a restaurant on the 2nd floor



Nobody knows... but ufos use the tower at night as a gas station

THE ASIMOV TOWER - NIGHT -

Two glass elevators and a double emergency stairwell ensure the safe internal traffic of the visitors. A green noise barrier of 5 meters high, covered with plants, will be made along the highway. The tower and noise barrier upgrade the existing park. A place where you can quietly remember, recreate and exercise.

At sunset, the LED lighting of the tower turns on. A beacon in the area. The base color is muted white light. During the evening, it changes to a muted soft green light. This color causes the least disturbance to nocturnal animals in the surrounding park. The light of the tower can be adjusted for special events.

For example when the Sharks become champions or a new president is elected. Every hour the message IF THEN ELSE can be seen on the top of the tower.

The base of the tower is a concrete construction covered with glass surrounded by a web of white aluminum pipes. The LED lighting follows the aluminum construction. Solar panels, included in the facade construction, provide green energy. An underground battery pack provides for energy storage. The foundation construction of the facade has the function of benches. The tower is 200 ft high. In the base the length is 230 ft and the width is 115 ft.

the Asimov Tower is 200 ft high



two glass elevators and a double emergency stairwell
cross section longitudinal section
Sections