

# THE TOWER OF INNOVATION, SILICON VALLEY

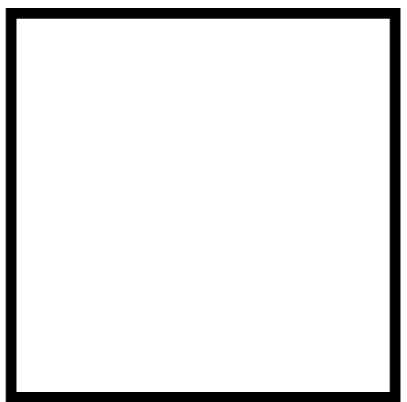

## MAZE → EDUCATIONAL

The educational maze, look like "integrated circuit", has clue signs related to computer knowledge in all intersections, that guide players to pick right way to destination.

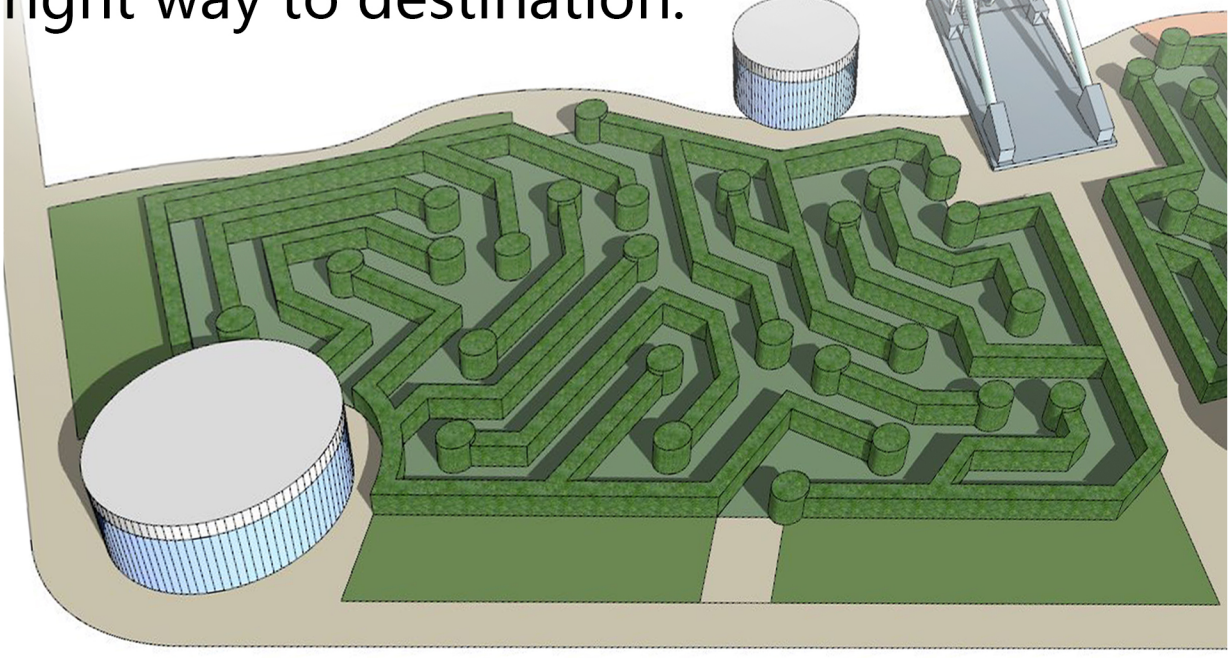

## FAME WALK → CELEBRATING

The computer pioneers' names and footprints are molded on the paving of "fame walk" for inspiring future generation to follow their footprints.

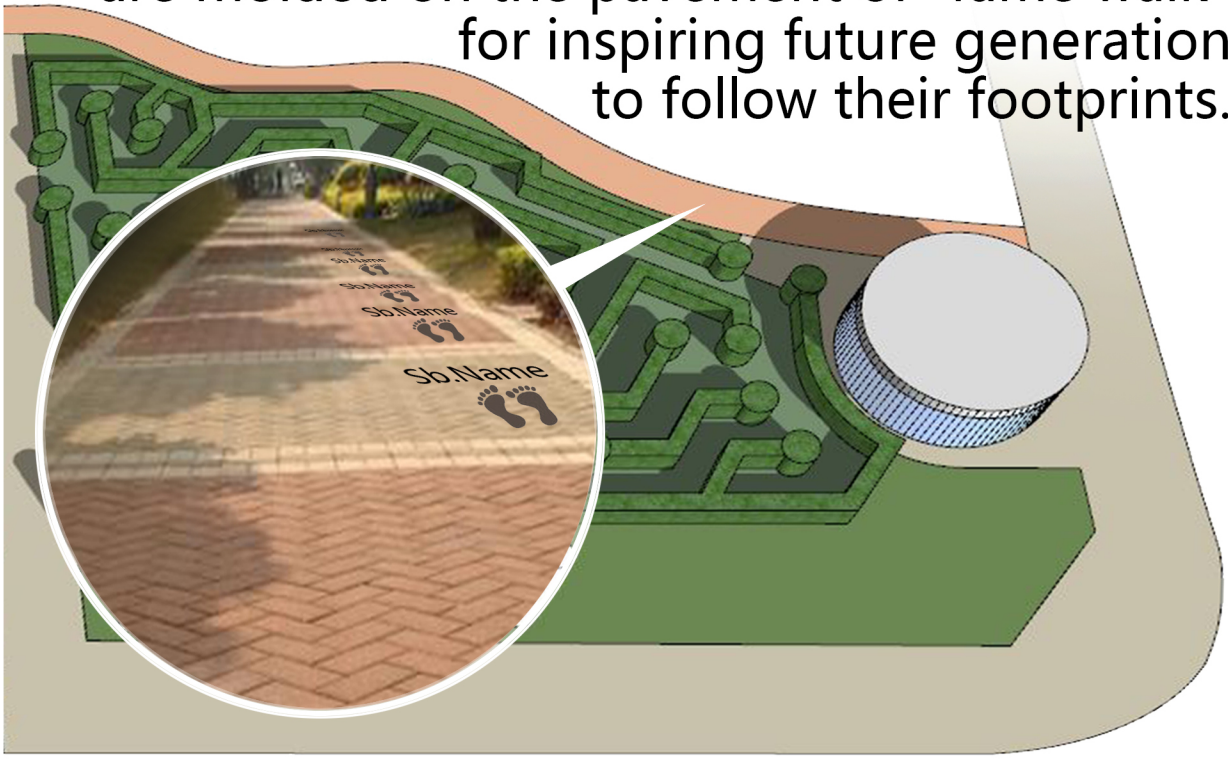

## A PLAYFUL AND EDUCATIONAL PLACE

The strategy of site planning in this design is to create a playful place where education and inspiration are given. A maze garden is built with educational function and a path of "fame walk" is designed to celebrate the contributions of computer pioneers.

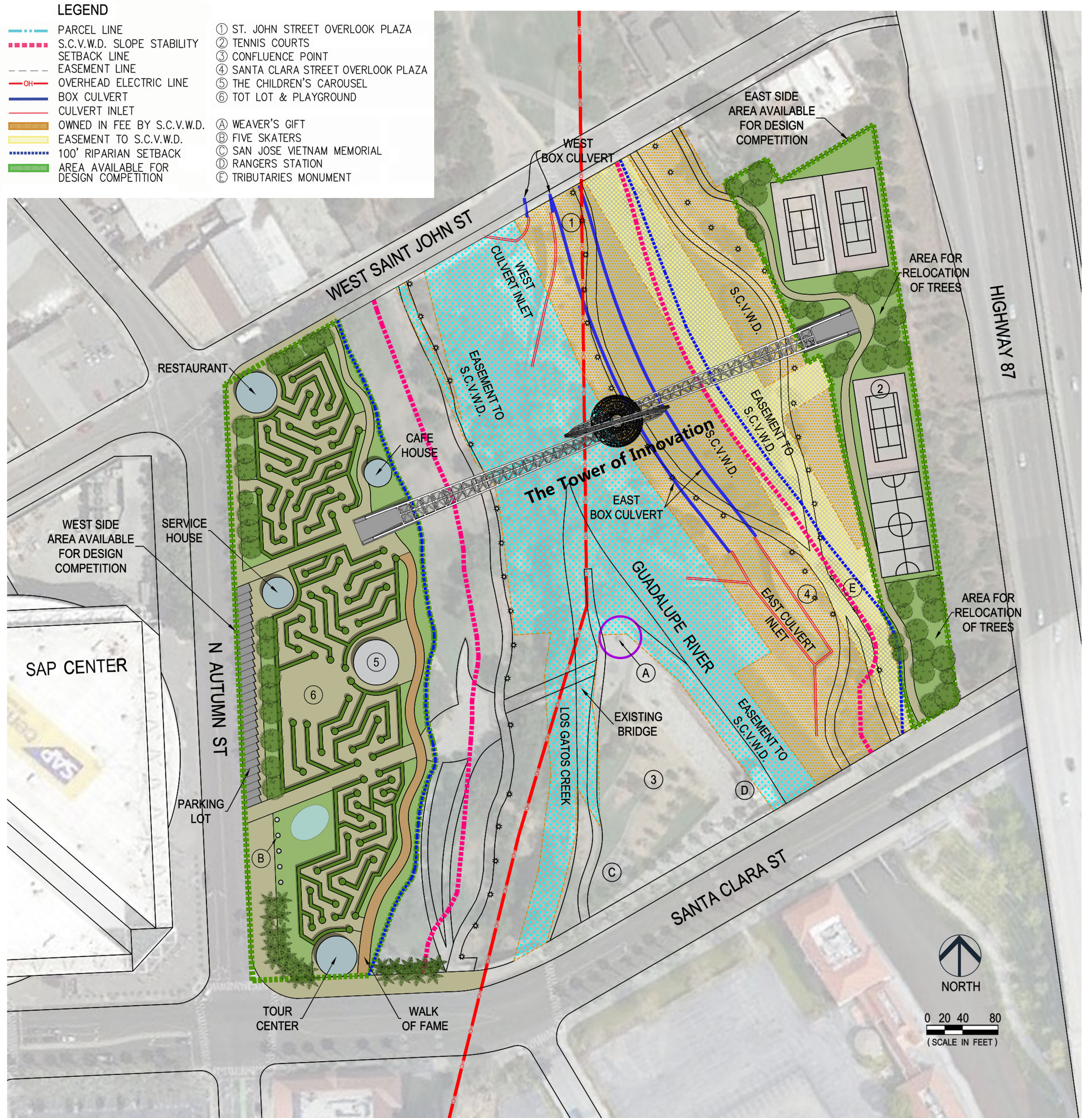

It is feasible to add more gondolas.

A gondola that carry up to 6 visitors for sight-seeing along the track of the structure outline.

## GONDOLA → SIGHT-SEEING

The steel structure of the tower shapes the track for a gondola to move along, while supporting the "light bulb" that most clearly manifests the indispensable meaning, INNOVATION.



DAY VIEW FROM SOUTH OF ARENA GREEN

# THE TOWER OF INNOVATION, SILICON VALLEY

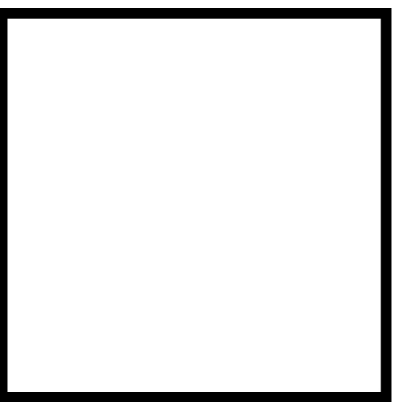

## AN ICONIC AND MEANINGFUL MONUMENT

The impressive icon of the tower is "light bulb" formed of many "0" and "1" components, a unique physical presence in the world, that reflects the extraordinary legacy of Silicon Valley as the world's epicenter of innovation in the field of computer technology.

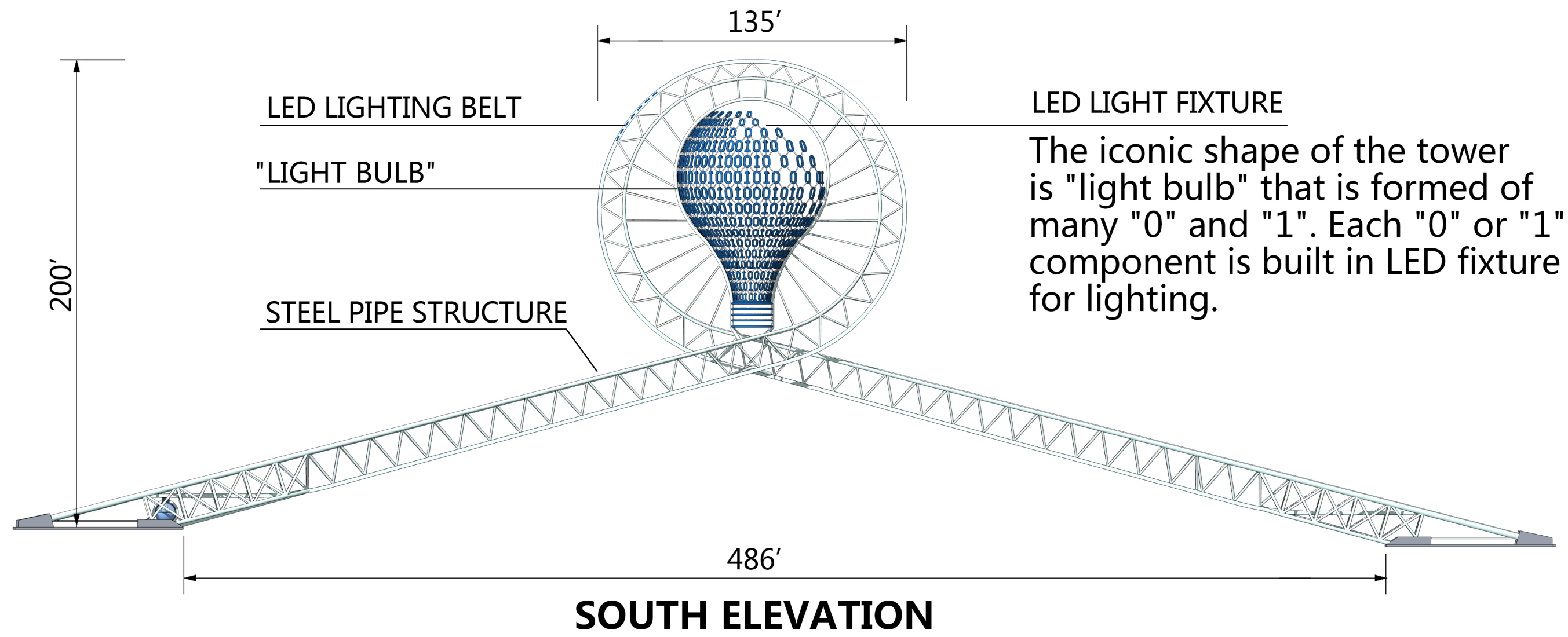

The iconic shape of the tower is "light bulb" that is formed of many "0" and "1". Each "0" or "1" component is built in LED fixture for lighting.

The glass spherical gondola has a diameter of 3 meters and can accommodate up to 6 passengers. It moves forward and backward between west and east area of the project site along the rail mounded on the structure "outline".

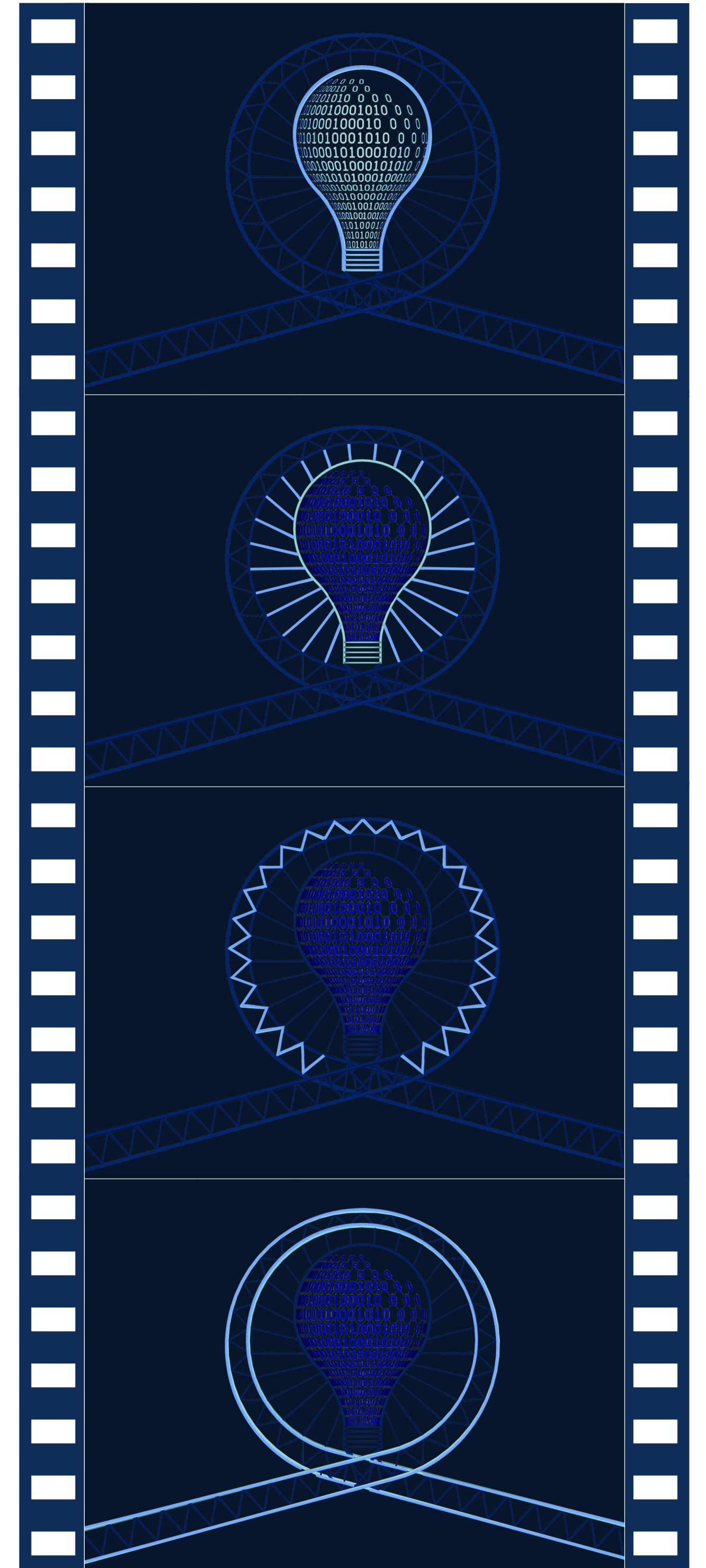
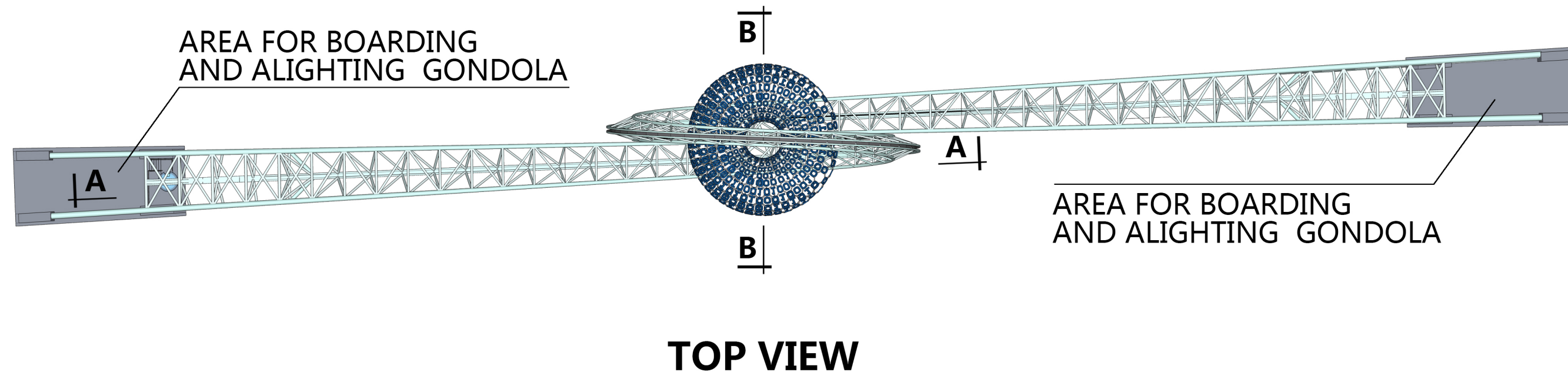
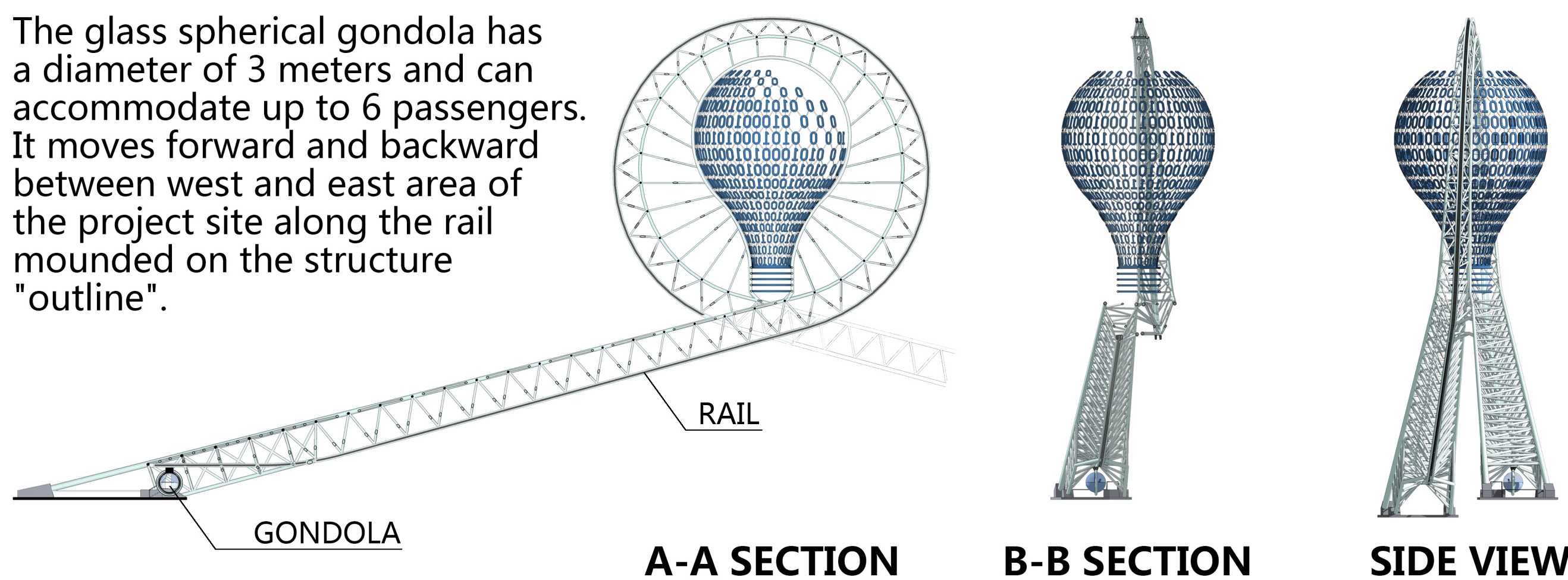

LIGHTING MODES

To minimize the impact on the surrounding natural environment, the light source is limited within blue spectrum, the effect shifts from one mode to another mode for kinetic lighting, and it is controlled by a computer program.

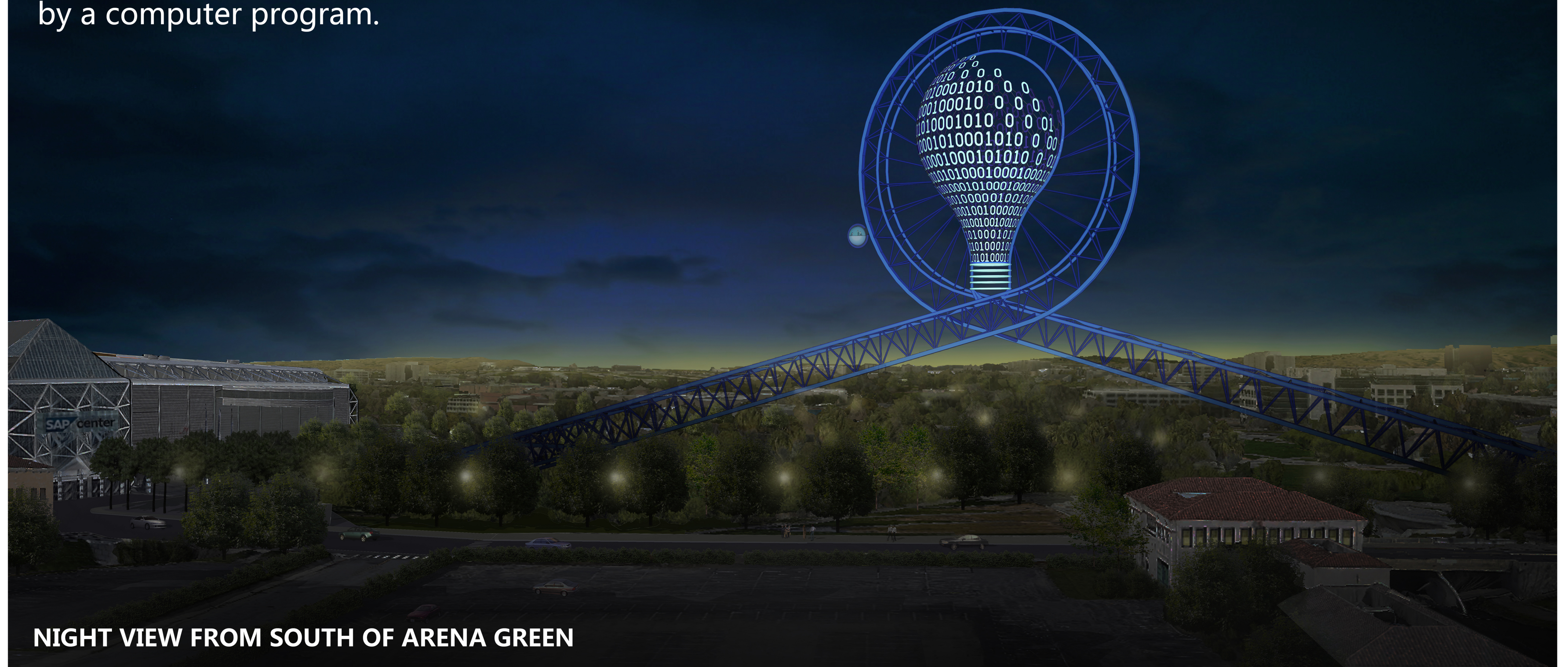

NIGHT VIEW FROM SOUTH OF ARENA GREEN