

Project Summary

The proposal is a series of promenades in multiple elevations. This creates unique views of the park and the city, playful interactions between nearby levels, and an interplay of light and shadows, changing with the sun and enhanced by lighting at night. With strong orthogonal shapes and sharp angles, these ramps are nevertheless fully equipped for the comfortable and enjoyable experience of individuals with disabilities and the safety of children. They have shifting textures and color cues to guide the user, balancing orientation and adventure, inspired by the concept of the labyrinth. These long ramps are structurally sustained by tall modules with semitransparent walls and vertical greenery. Modules also contain smaller secondary ramps to connect principal promenades. Modules have an open concept and can serve many uses such as gatherings, art expositions, or performances, enhancing the area's urban activity. The site's topography is slightly ridged to help reduce noise pollution, and facilities such as restrooms, water fountains, and shades are provided.

The Promenades

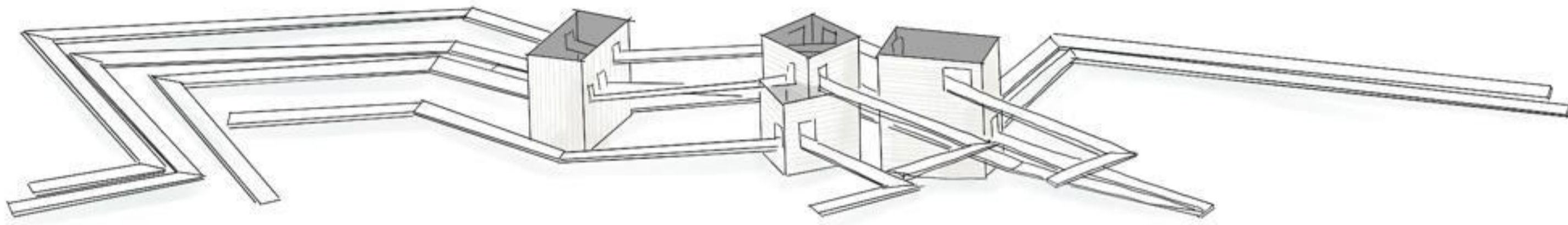
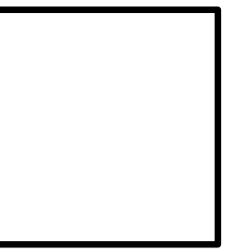

East Side Perspective

East Side, Interior Detail

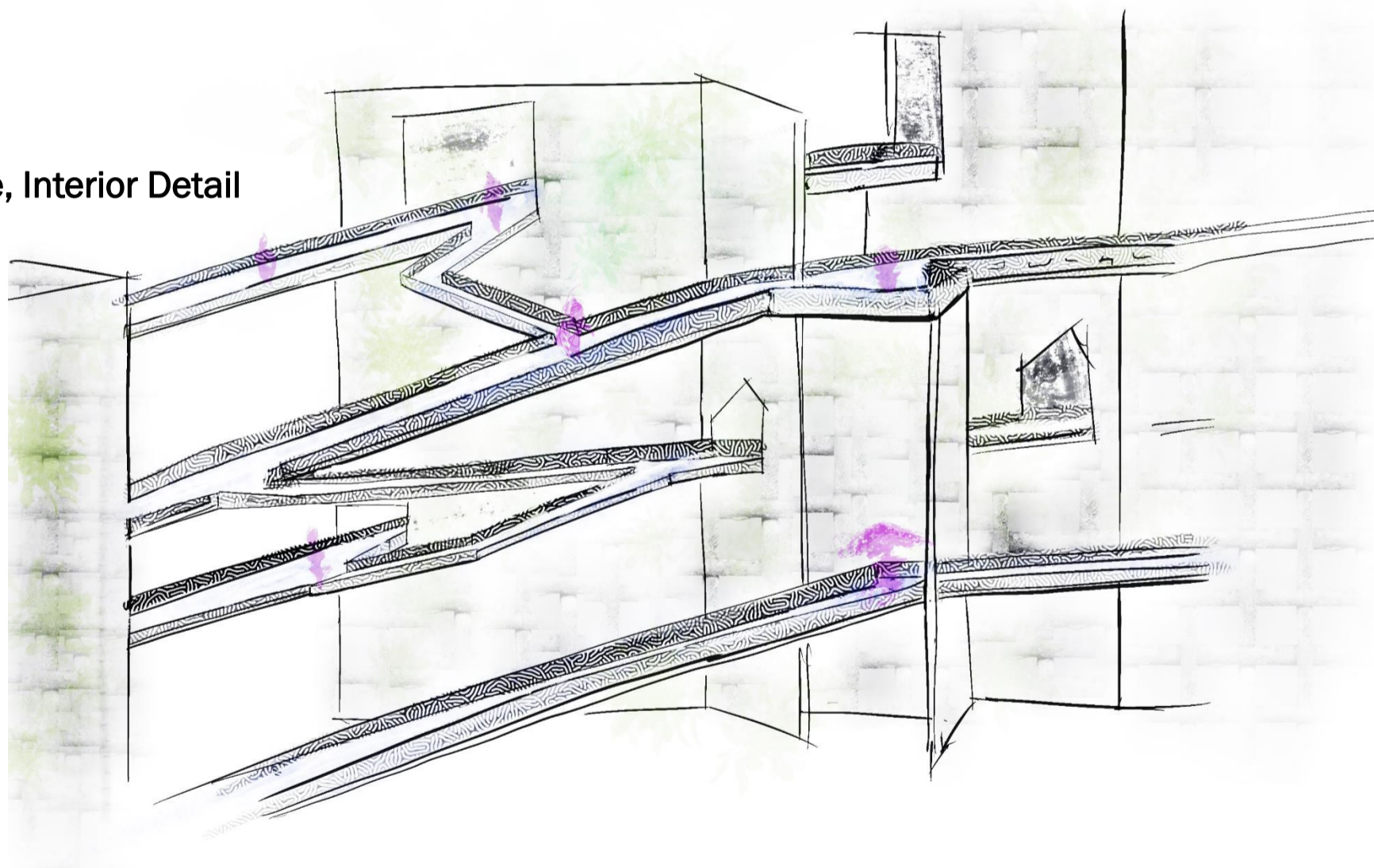

East Side, Santa Clara Street

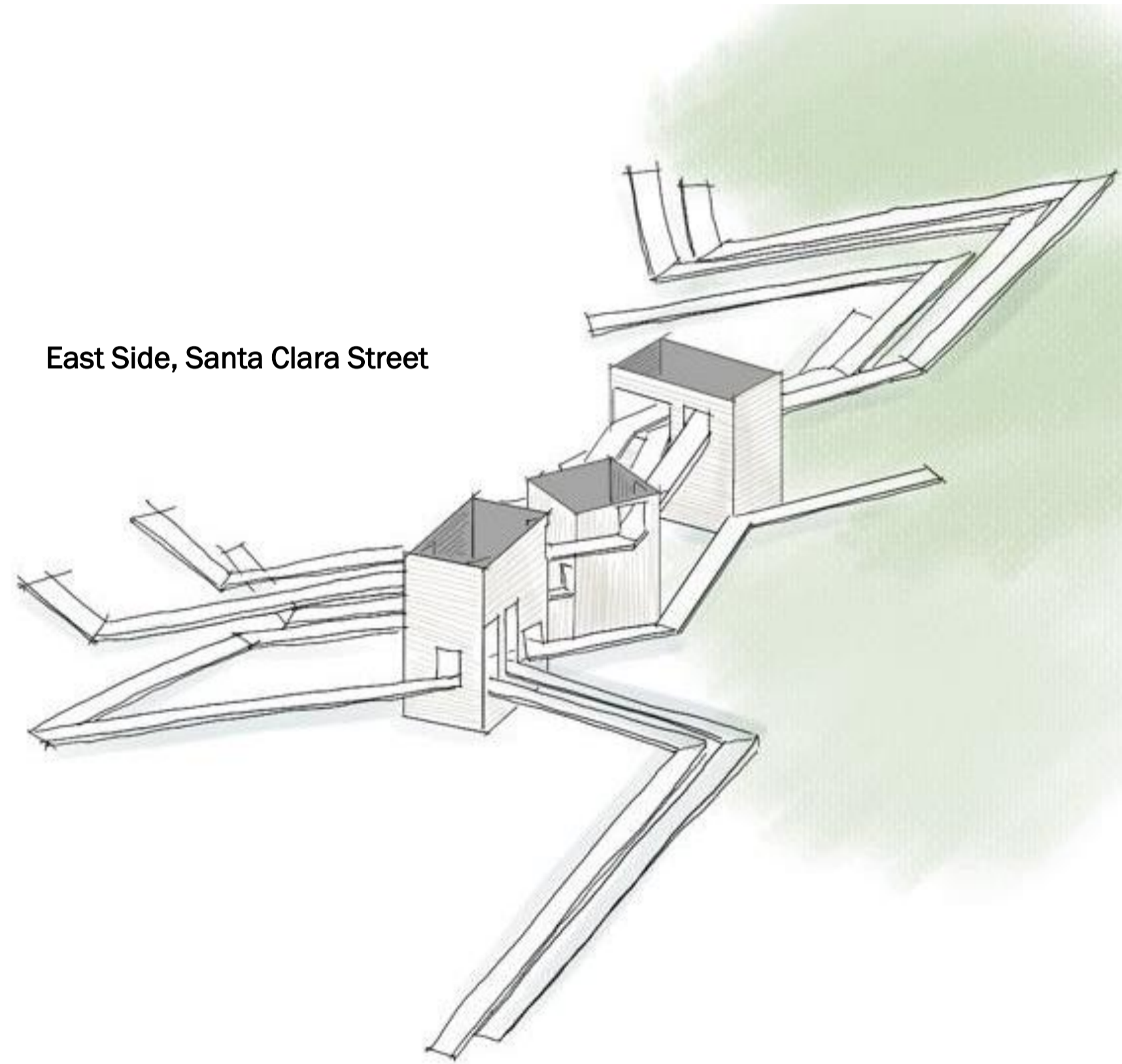

East Side, Longitudinal Section

