

THE STATUE OF INNOVATION Silicon Valley

The statue is formed by using the model of silicon crystal structure as elements of structure framing. The name of "Silicon Valley" comes from "silicon". Therefore, to express "silicon" in the design is one aspect of most associated with this project.

The proposed project is located in the west side. The visual features of "integrated circuit board" are used in site planning to create the landscape design with a sense of technology theme.

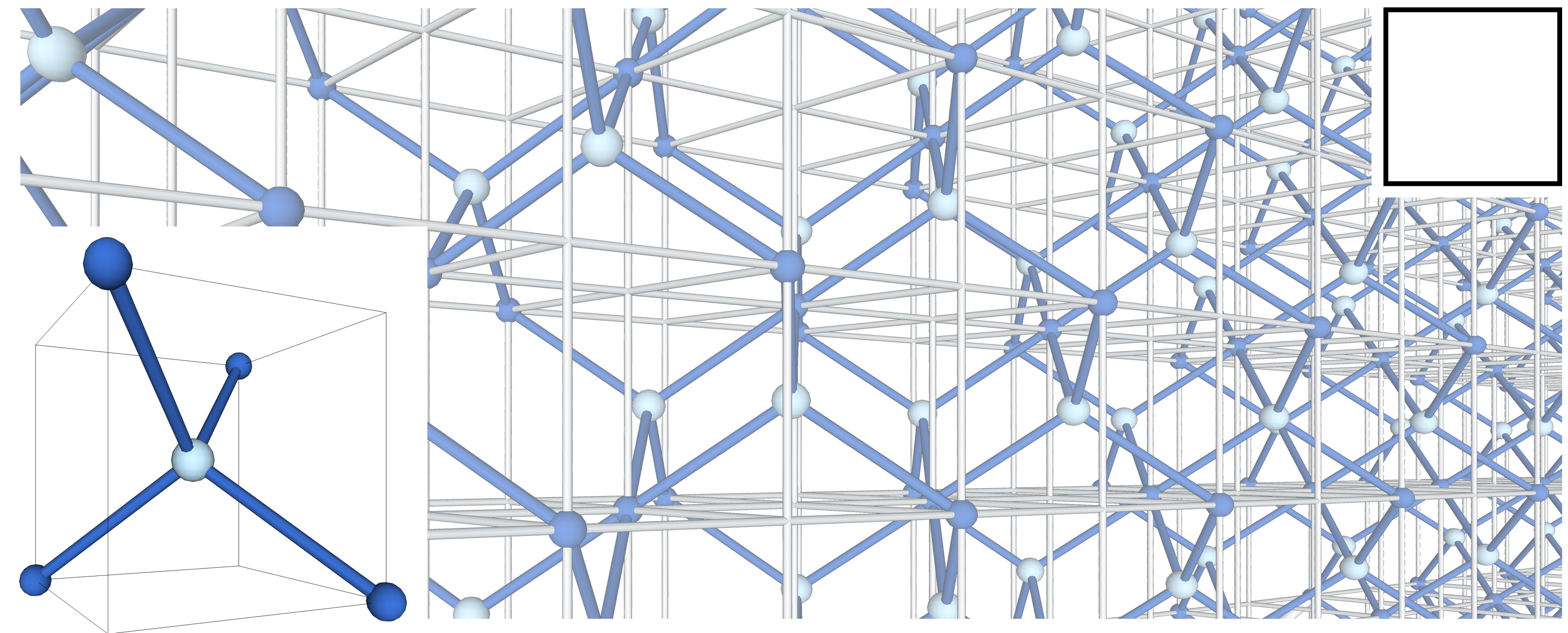
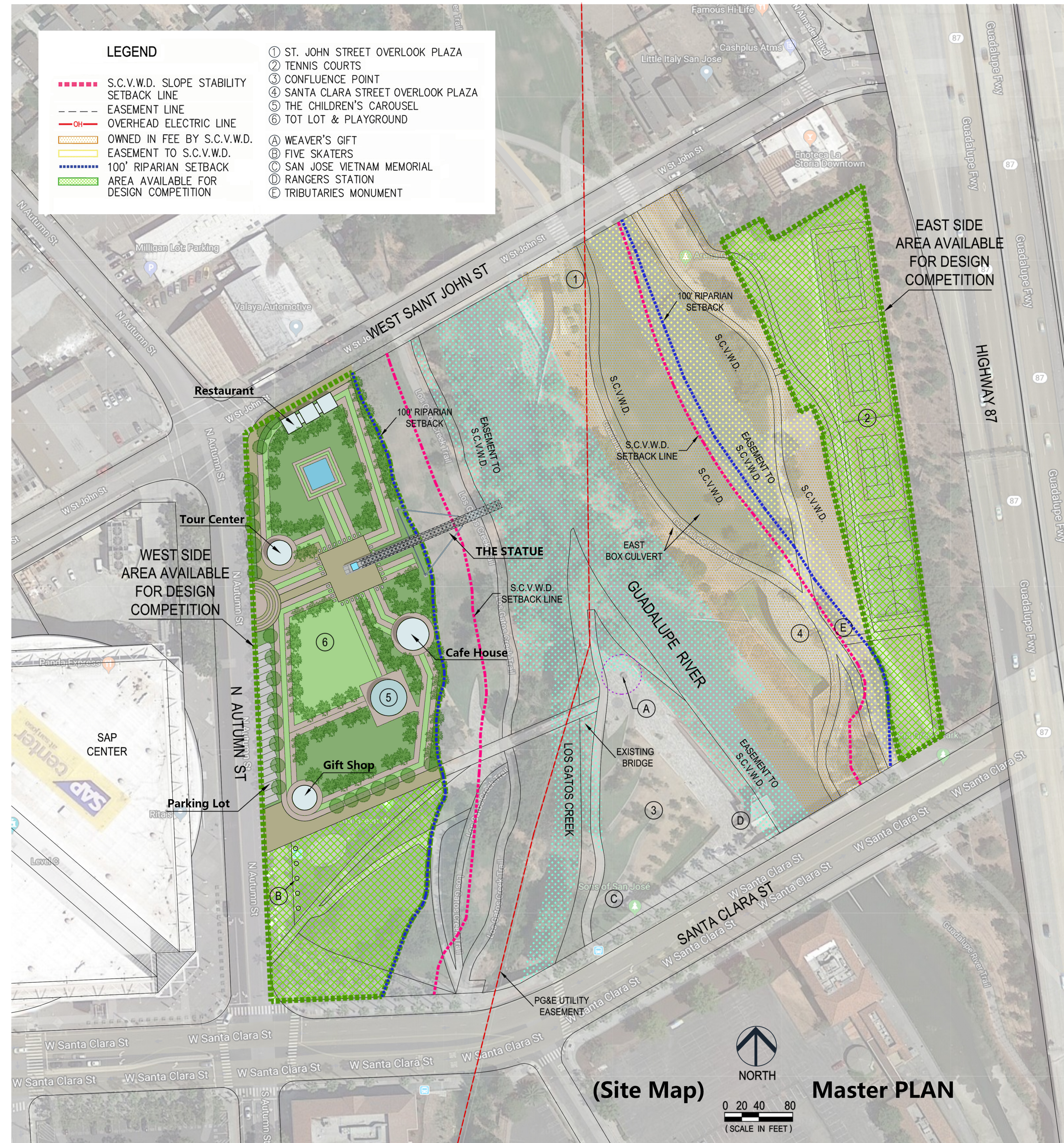

Silicon Crystal Structure ↑

Skywalk →

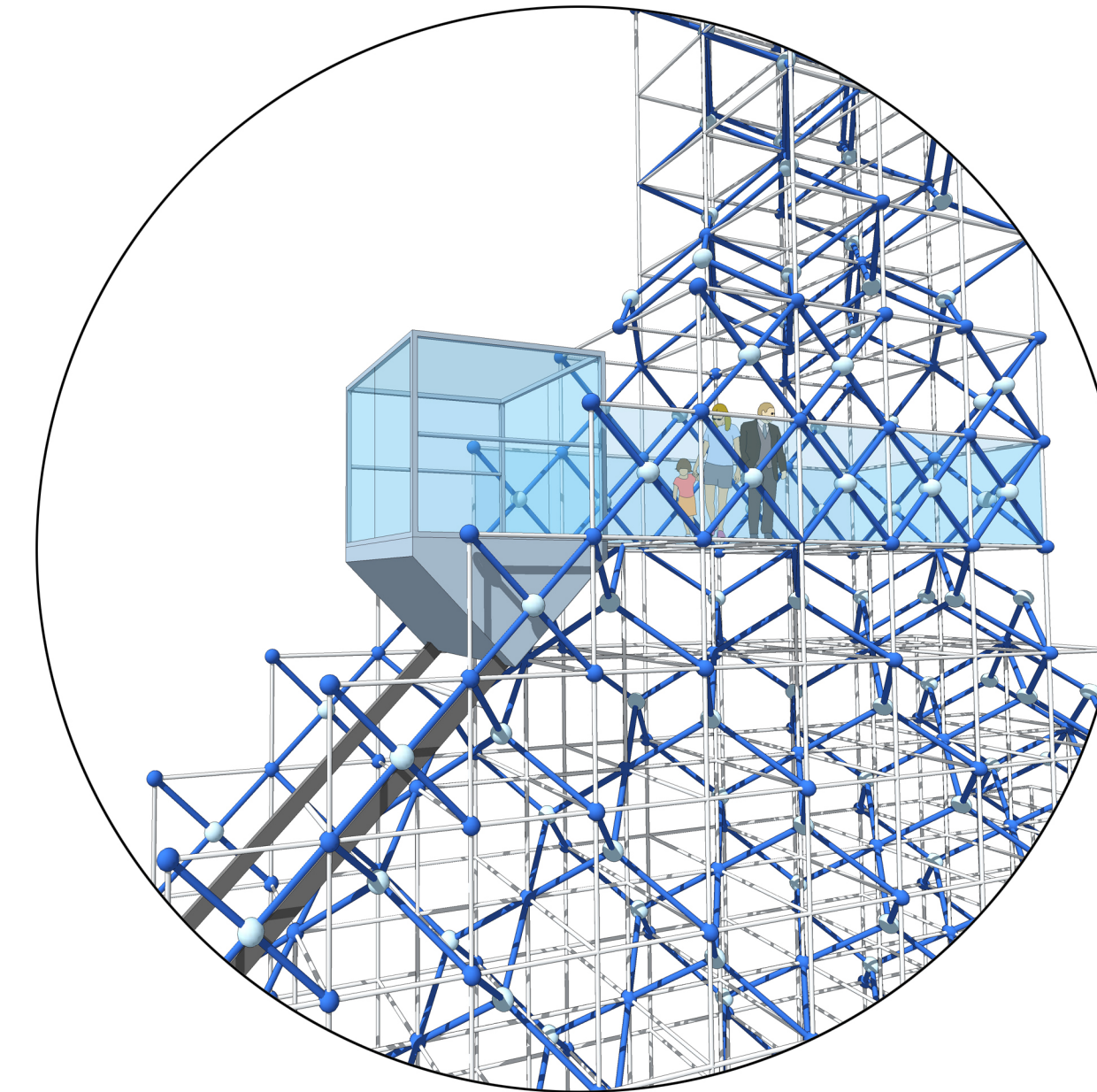

Sightseeing Lift →

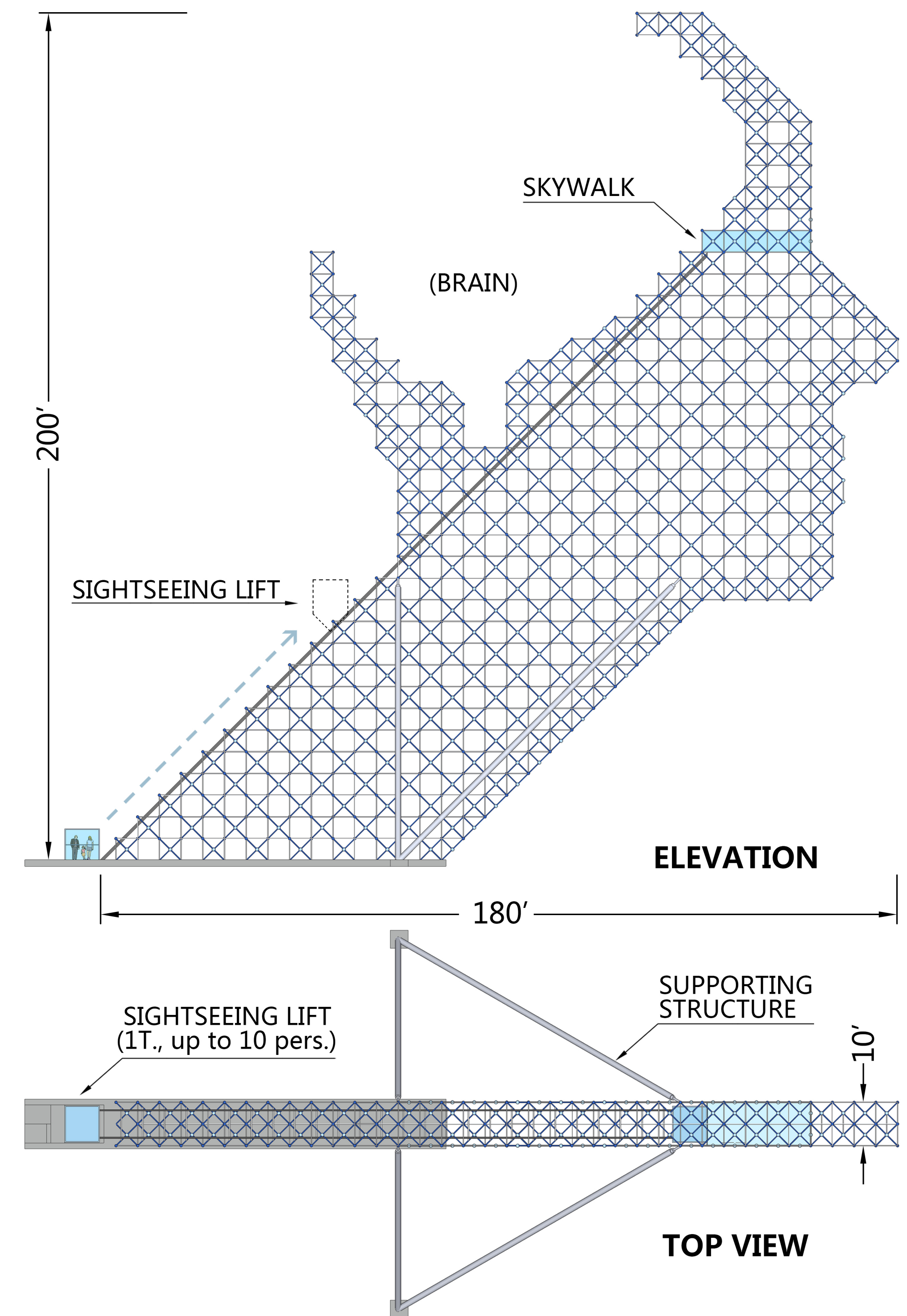
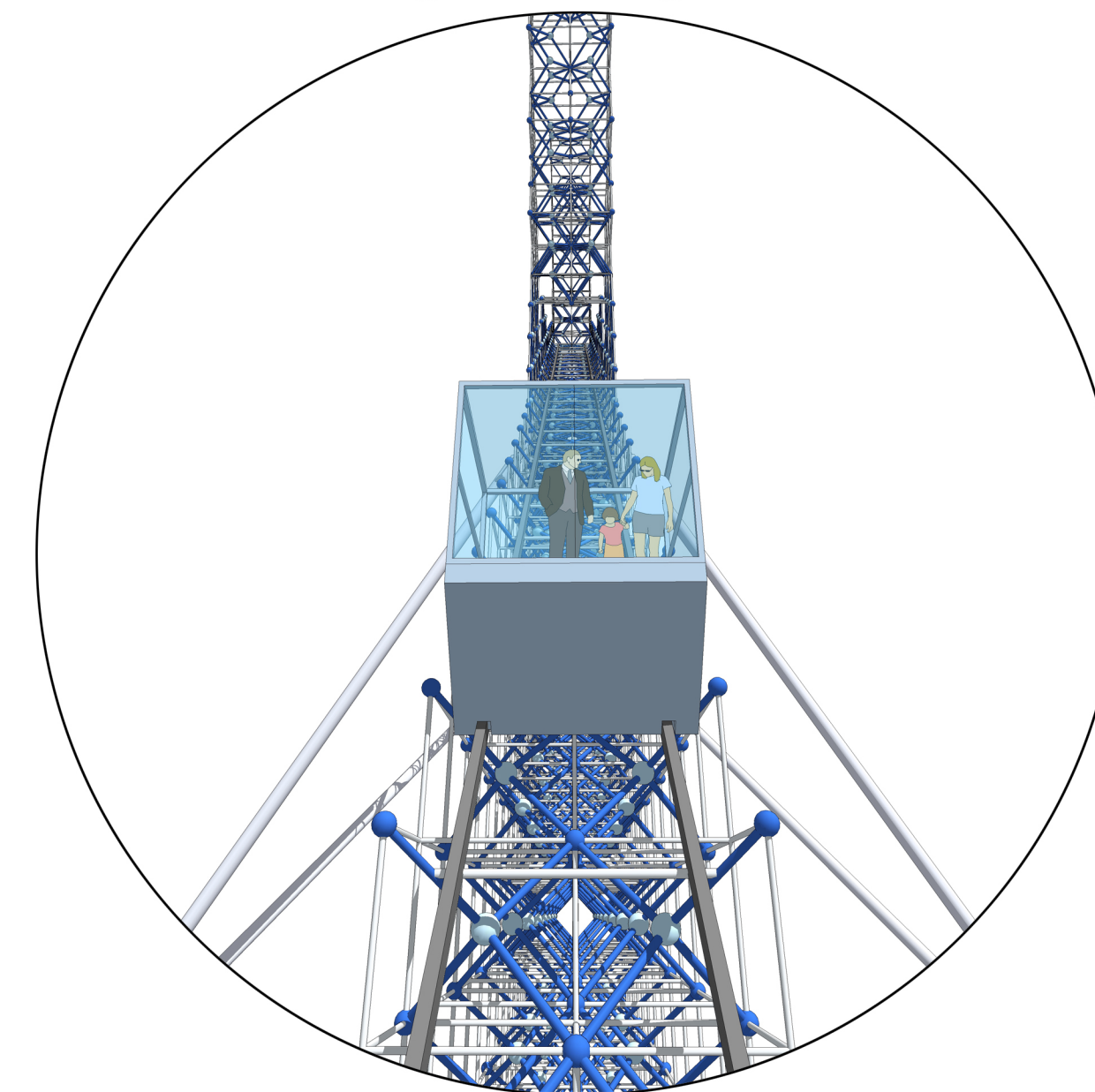

THE STATUE OF INNOVATION

The conception of design for Silicon Valley's landmark project is to create a statue with image of human HEAD/BRAIN that reflecting the legacy of this remarkable global center of life-changing THOUGHT, celebrating people's intelligence, the driving force of Silicon Valley's technological development, and embracing the theme of INNOVATION in the advancement of humanity.

For lighting, LED fixtures and LED lighting belts are fixed on the frames & nodes of the structure for showing the image of human head, brain, silicon crystal structure, characters, etc..

