

THE BULB

URBAN CONFLUENCE



SILICON VALLEY



SAN JOSÉ

THE BULB's shape celebrates the Culture of Innovation and of New Ideas, thus defining the Soul of Silicon Valley. The Spirit of San José is represented with the Seal of the City, the Spectacular Lighting Set of Filament LED Sources (Wheat Bunch) and the Terrace Garden Wine Bar/Restaurant (Purple Grapes). The Bulb Dimensions, both in Plan and in Section, are Inspired by the Form of the Original San José Electric Light Tower. The Height of the Proposed Landmark is 200 feet calculated from the Ground, but if you consider the Basement, the Height is the same as the Original, 237 feet. Located in the Eastern Side of the Park is visible from Highway 87. From the Sky, The Bulb will look like the Internet Position Indicator. A World-Class Destination Designed according to Net-Zero Energy Principles, which incorporates Transparent Photovoltaic Openable Glass for Temperature Control and Kinetic Facade. Collection of Rainwater & Kinetic Light Sources with Timeclock Controls are also proposed, thus respecting the Riparian Corridor. The Top of the Glass Bulb is Screened, thus avoiding Up-lighting beyond the Building Height with respect to the Flight Path Zone. Part of the Design Strategy is to also Redevelop the West Side of the Park with a Childrens Playground and Food/Ice-Cream Kiosks. Refurbishment of the Existing Bridge between the West Side and Confluence Point makes possible extending it to the Eastside. Landscape Design and Urban Art are part of an Integrated Holistic Proposal, ensuring a Memorable and Successful Project.

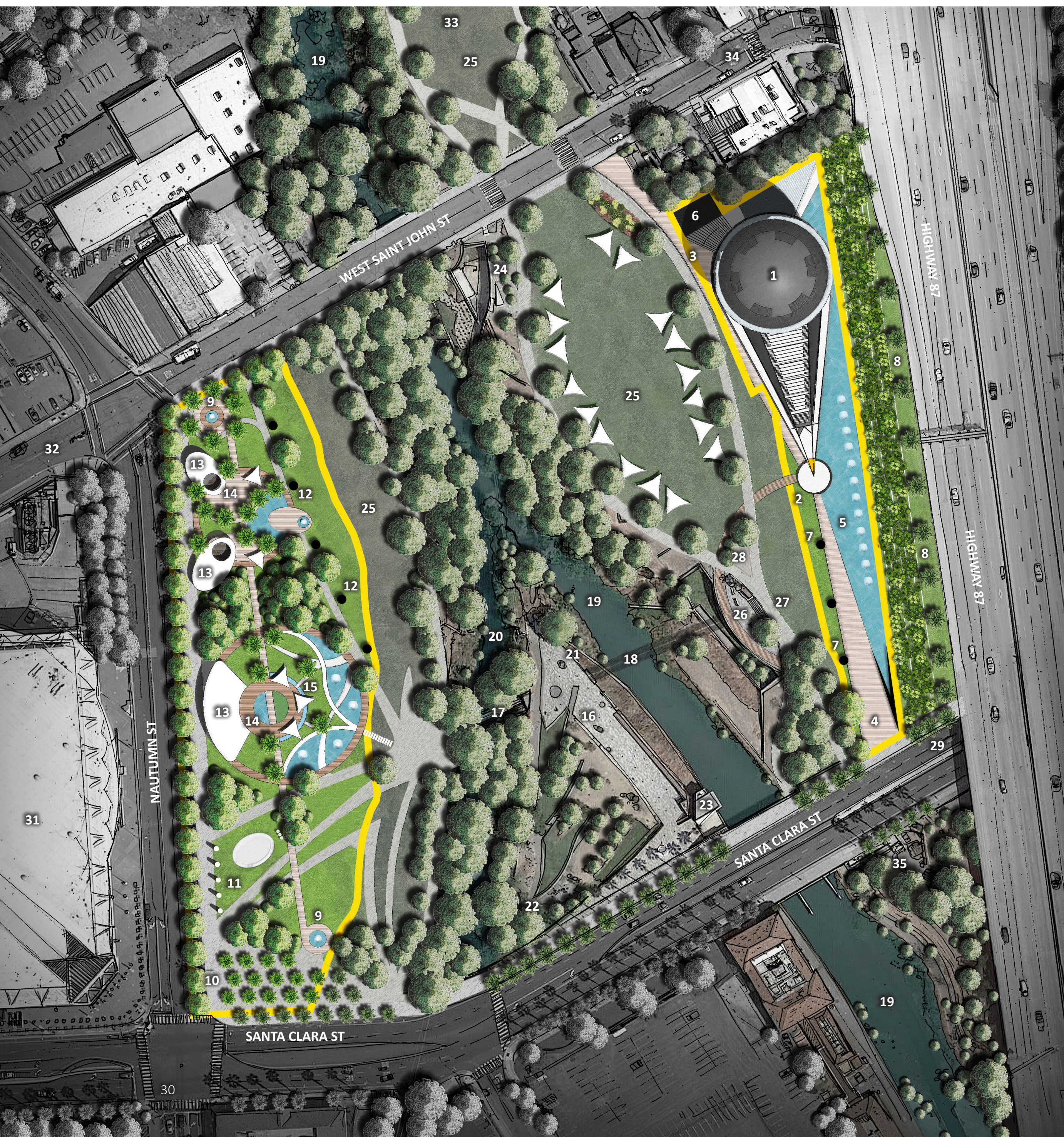

LEGEND:

EAST SIDE - ARENA GREEN

AVAILABLE AREA = 1,5362 ACRES

1. THE BULB - URBAN CONFLUENCE
2. ENTRY BULB - MEMORIAL & AUDITORIUM
3. ENTRY BULB - UNDERGROUND FOYER
4. WALKWAY + BULB'S ENTRANCE SIGN
5. WATER MIRROR WITH JETS AND CASCADE
6. AMENITIES + SERVICES + BULB'S ENTRANCE SIGN
7. URBAN ART - INSTALLATION
8. TERRACED GARDEN - GREEN BUFFER

WEST SIDE - ARENA GREEN

AVAILABLE AREA = 3,2384 ACRES

9. PLAZA & URBAN ART - INSTALLATION
10. EXISTING PALM TREES - PARK'S ATRIUM
11. FIVE SKATERS - POOL, PILLARS, STANDS
12. URBAN ART - INSTALLATION
13. KIOSKS & MARKETS - FOOD & BEVERAGES
14. F&B - OUTDOOR SEATING AREA
15. CHILDREN PLAYGROUND

SURROUNDING - EXISTING CONTEXT

16. CONFLUENCE POINT
17. EXISTING BRIDGE - REFURBISHMENT
18. FUTURE OPPORTUNITY - NEW BRIDGE
19. GUADALUPE RIVER
20. LOS GATOS CREEK
21. WEAVER'S GIFT
22. SAN JOSÉ VIETNAM MEMORIAL
23. RANGER STATION
24. ST JOHN STREET OVERLOOK PLAZA
25. PUBLIC EVENTS AREA - MARKET STALLS
26. SANTA CLARA OVERLOOK PLAZA
27. TRIBUTARIES MONUMENT
28. FUTURE OPPORTUNITY - URBAN ART
29. TO DOWNTOWN
30. TO DIRIDON STATION
31. SAP CENTER
32. TO PUBLIC CARPARK
33. TO GUADALUPE GARDENS
34. LITTLE ITALY - SAN JOSÉ
35. GUADALUPE RIVER TRAIL

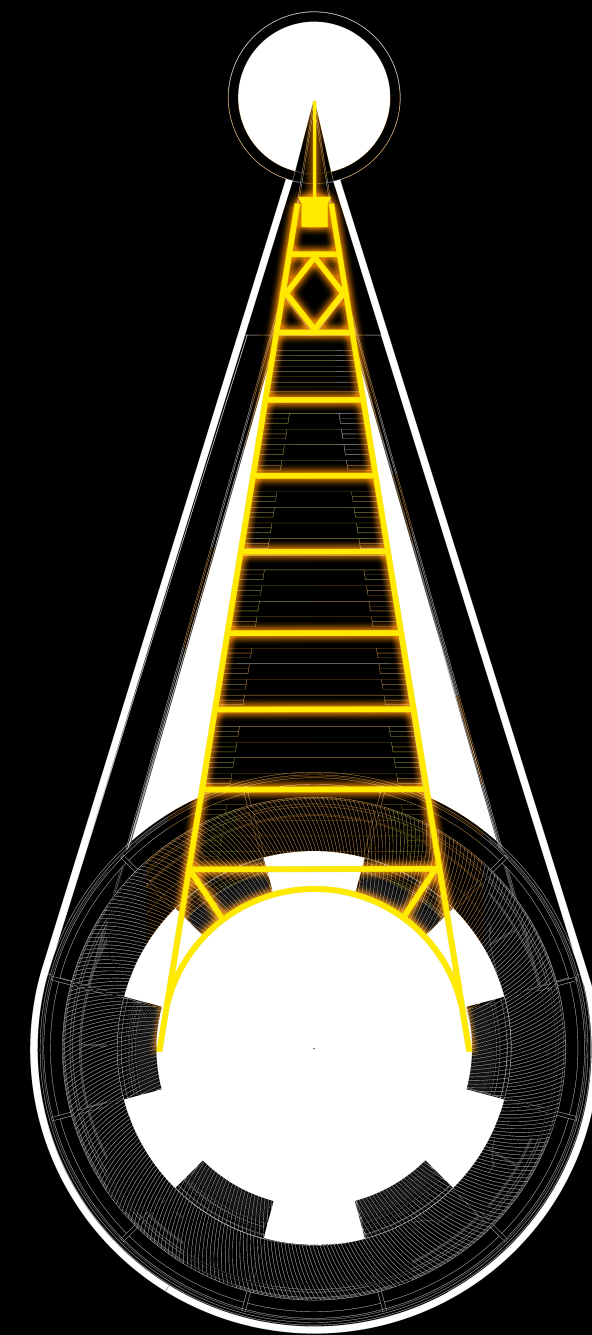

307 ft
328 ft

142 ft

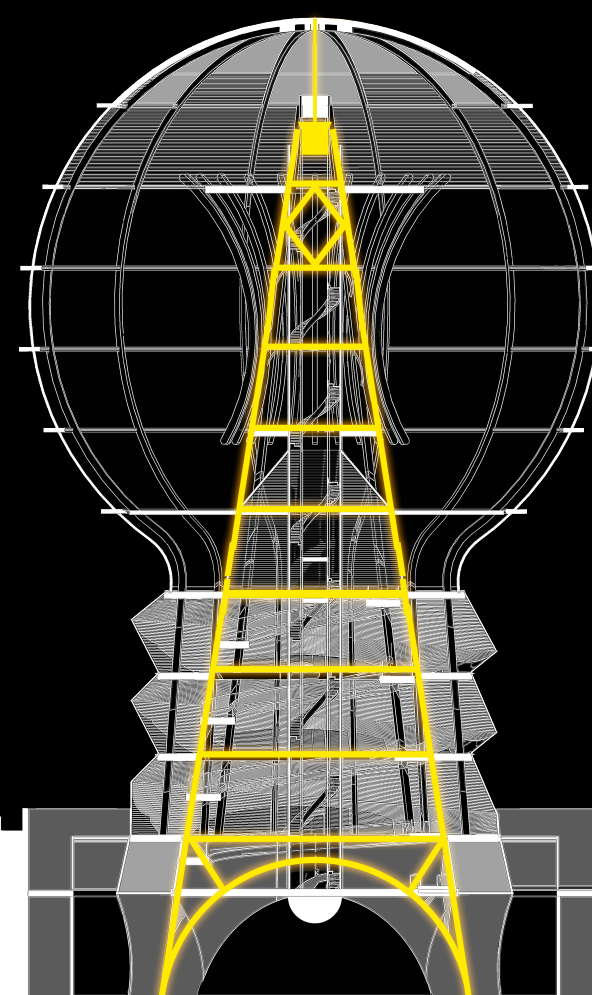

200 ft
237 ft



THE BULB

URBAN CONFLUENCE

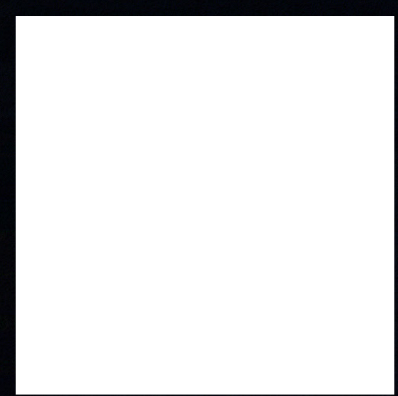

*"THE SOUL OF SILICON VALLEY ...
... THE SPIRIT OF SAN JOSÉ ,,"*



The Bulb is accessible from Main Stairs from the Park or via 2 Ramps/Memorial from the Auditorium side. Inscribed along the Walls are all the Names of the Generous Donors. The Foyer/Entry is an Underground Square that includes a Visitor Centre, Book Shop, Amenities and Services. Below the square, an Auditorium/Piazza with 300 seats and a Conference Hall. A Meeting Point as the Heart of the Community. Above the Square, the base with a Semi-transparent Kinetic Steel Facade comprises of Temporary Exhibition Gallery arranged through Helical Ramps. At the Base of the Glass Bulb, there is a Garden Terrace incorporating a Wine Bar. One level above, a Restaurant is situated, overlooking the Park. At the topmost level, readily accessible through a Stair and Lift, sits the Lookout, with Views of the Surrounding Cityscape and serviced by a Café-Bar. A 30-foot Flagpole, like the Original Light Tower, terminates the Internal Vertical Space. This Iconic Urban Landmark, with a Strong Visual Presence at a Distance, is a Mix of Modern Technology, History, Architecture, Engineering and Art. A Vibrant Place-Making for Varies Day & Night Activities.



DAY TIME

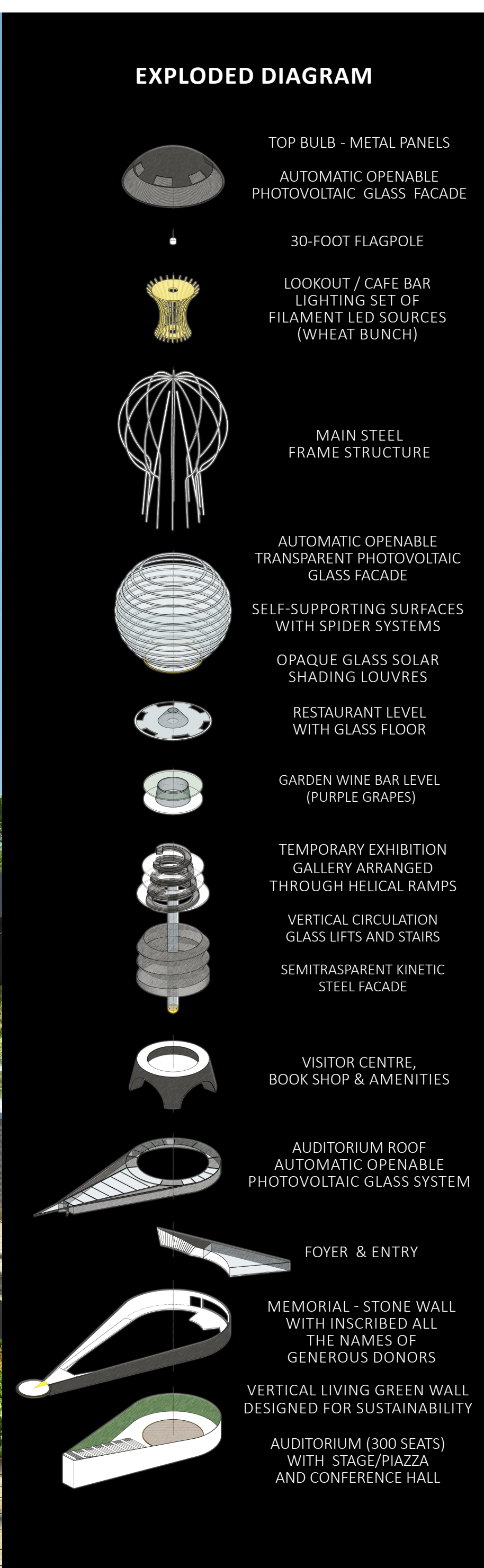

NIGHT TIME