

The 200-foot structure occupies a prominent place at the junction between Santa Clara and Autumn Streets, facing the future Google Village and San José's Diridon Station. The building's location at the edge of the park favors the environmental preservation of Arena Green while simultaneously maximizing its urban exposure, with the new landmark being visible for quite a distance.

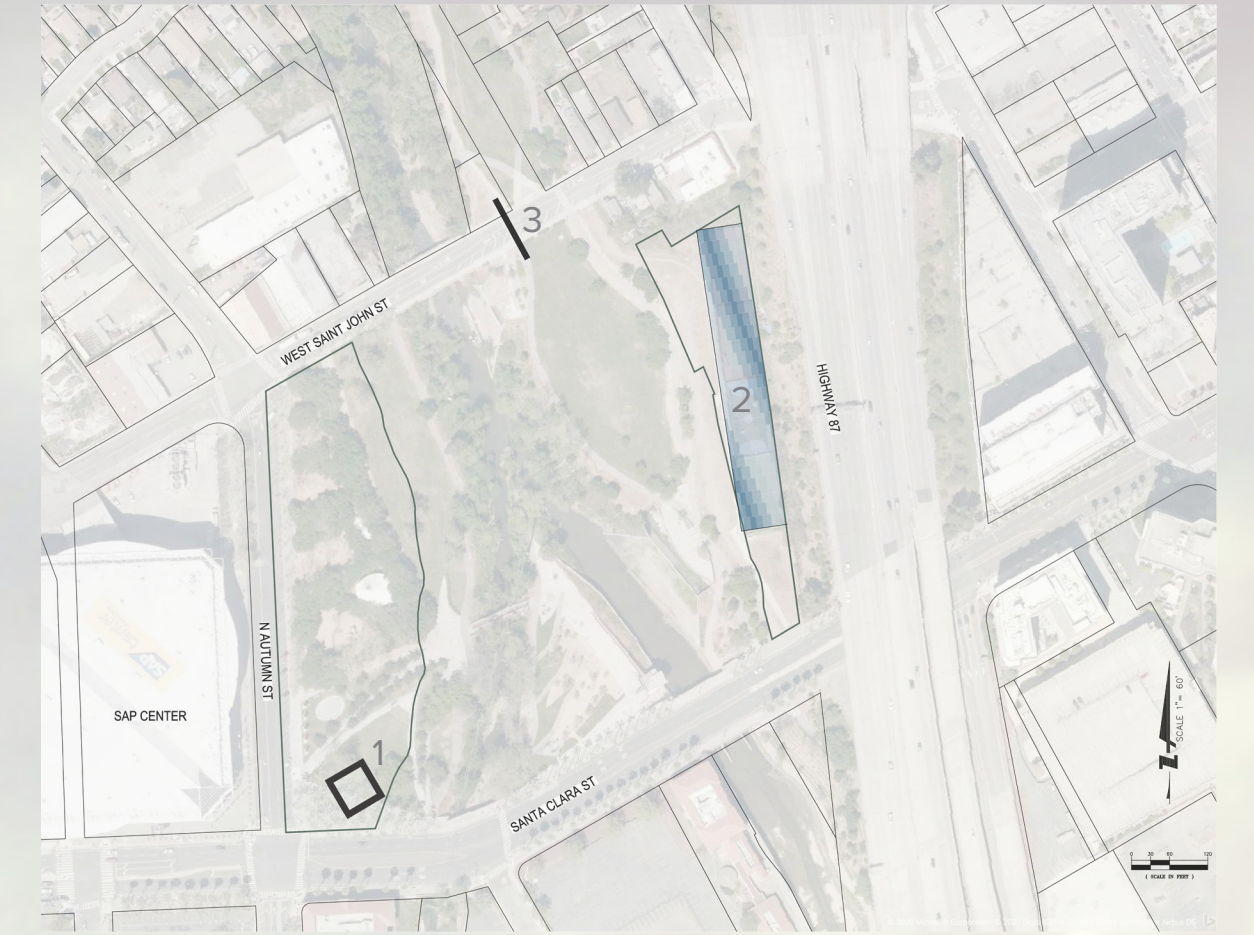

1 - Zephyr The Landmark 2 - Solar Farm (covering the tennis courts) The Power Source 3 - Trail bridge The Urban Connector



OUTLINE CONCEPT
inhabiting the line

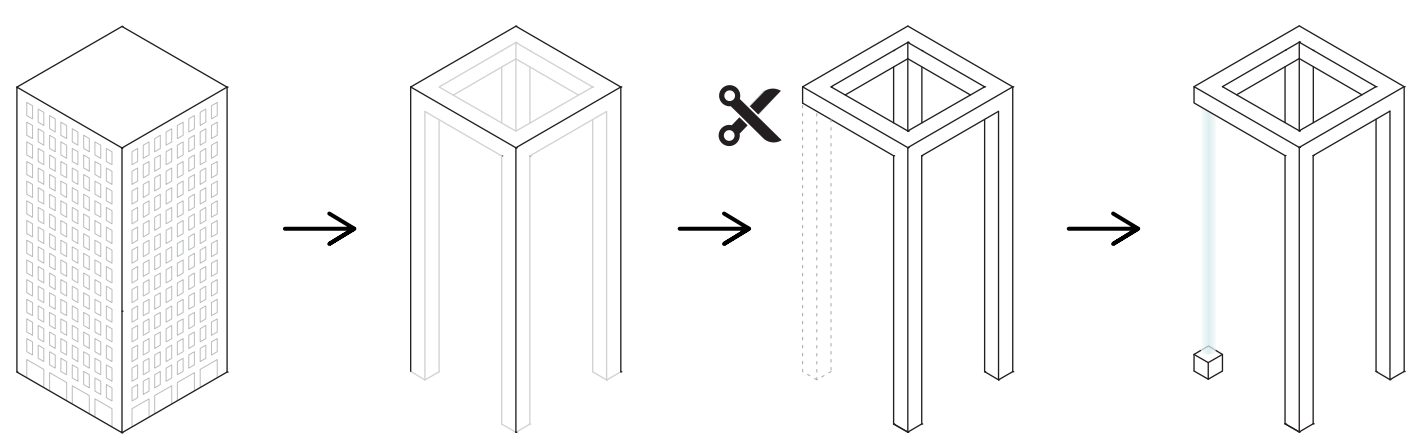

The new landmark is conceived as the graphic outline of a traditional high-rise.

Ethereal and light, the structure defies spatial & programmatic conventions.

SKIN CONCEPT
mimicking nature

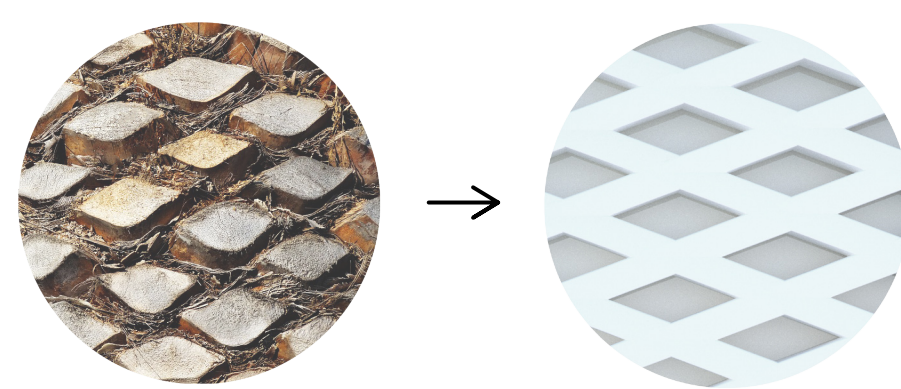

Palm Tree Bark

Structural Lattice

CIRCULATIONS
gathering in the sky

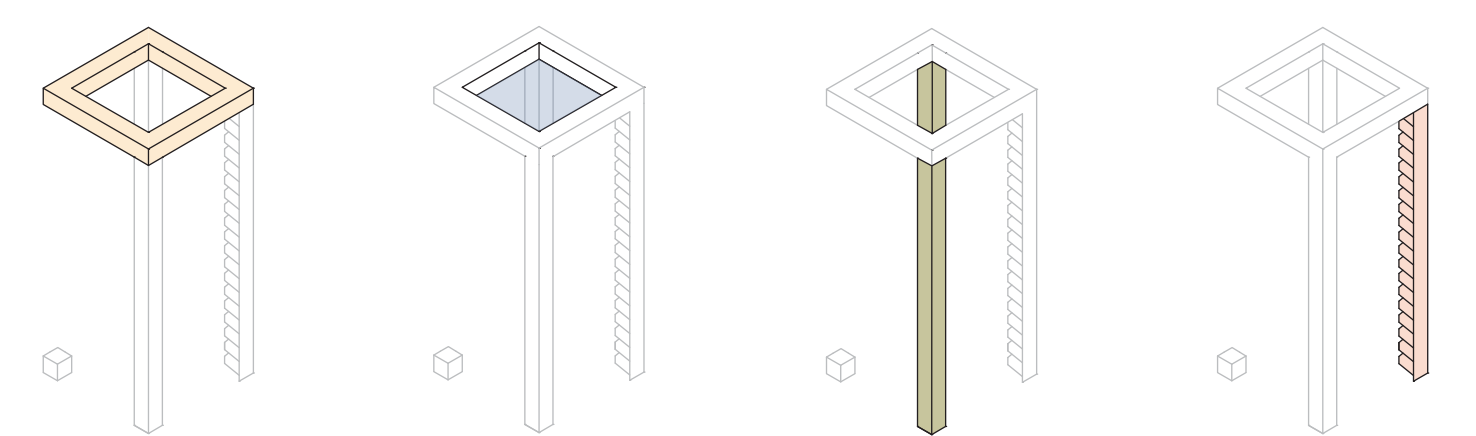

360° Observation Deck

Suspended Plaza

Elevators & Climbing

Stairway to Heaven

The Suspended Net is equipped with LED's underneath, capable of displaying digital content

The Light Pillar - a powerful symbol for innovation and technology

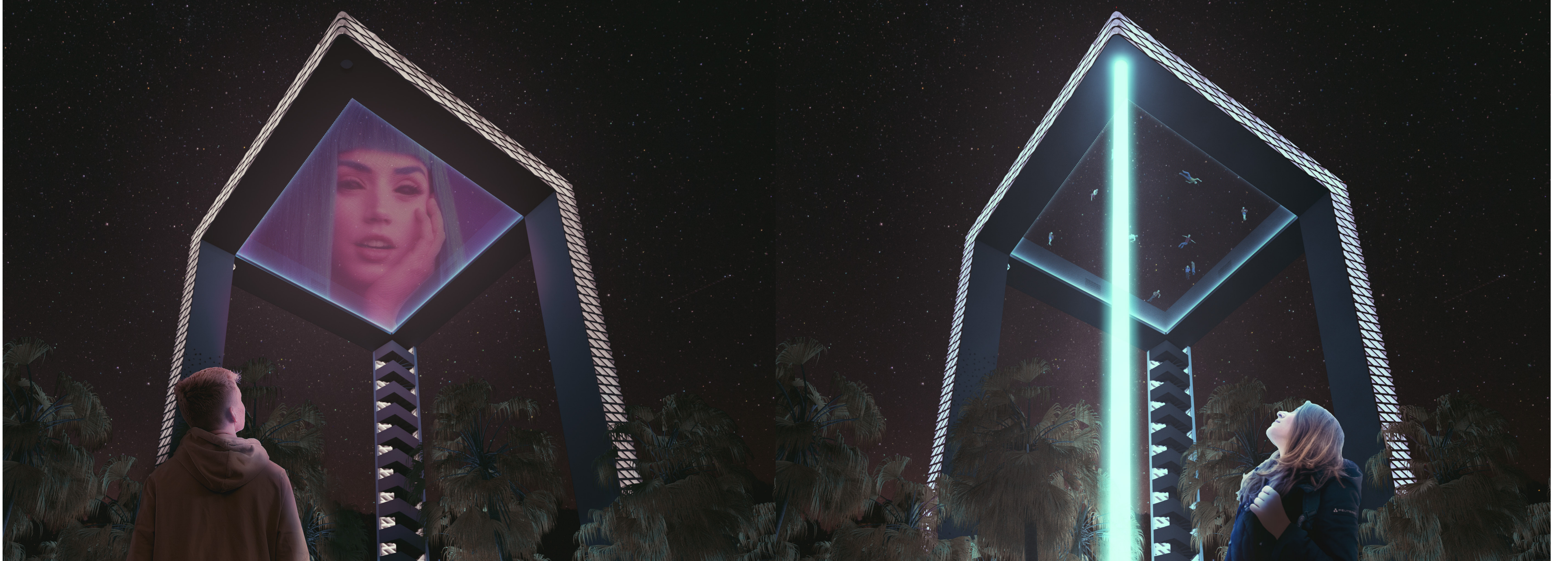

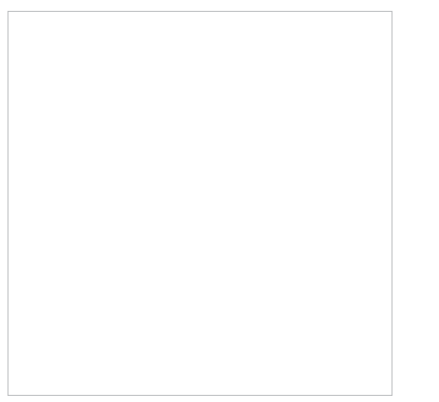

The structure has a total footprint as little as 530 square feet, keeping the Arena Green Park as untouched as possible. The slender core-structure and open layout allows the sun to shine on every corner of the park and its slim profile reduces wind loads and tunnel effects. The building's structural geometry is based on a 3D lattice, composed to mimic the growth excisions that wrap the trunks of palm trees, such as the ones found on-site.



Top Corner Axonometric

NET-ZERO STRATEGIES

- Solar Farm (covering the tennis courts)*
- *all PV panels are anti-reflective/glare
- Prefabrication & Waste Management
- Lightweight & Sustainable Materials
- Geothermal Cooling/Heating
- Natural Ventilation Systems
- Efficient Façade Shading
- Water Efficiency
- Smog-eating Coating

MAIN DIMENSIONS

- Footprint: 530 sq ft
- Height: 200 ft
- Length: 86 ft
- Width: 86 ft

PROGRAM

1. Observatory
Lounge/Café
Gallery/WC's
2. Suspended Plaza
3. Climbing Wall
(inner faces)
4. Light Pillar
5. Stairway
6. Elevators (2 cores)
7. Reception Booth
8. Solar Energy Cluster

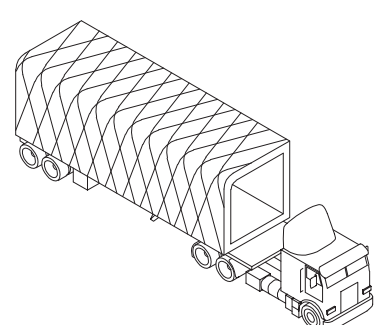

PREFAB CONSTRUCTION

Factory Produced and Assembled On-site

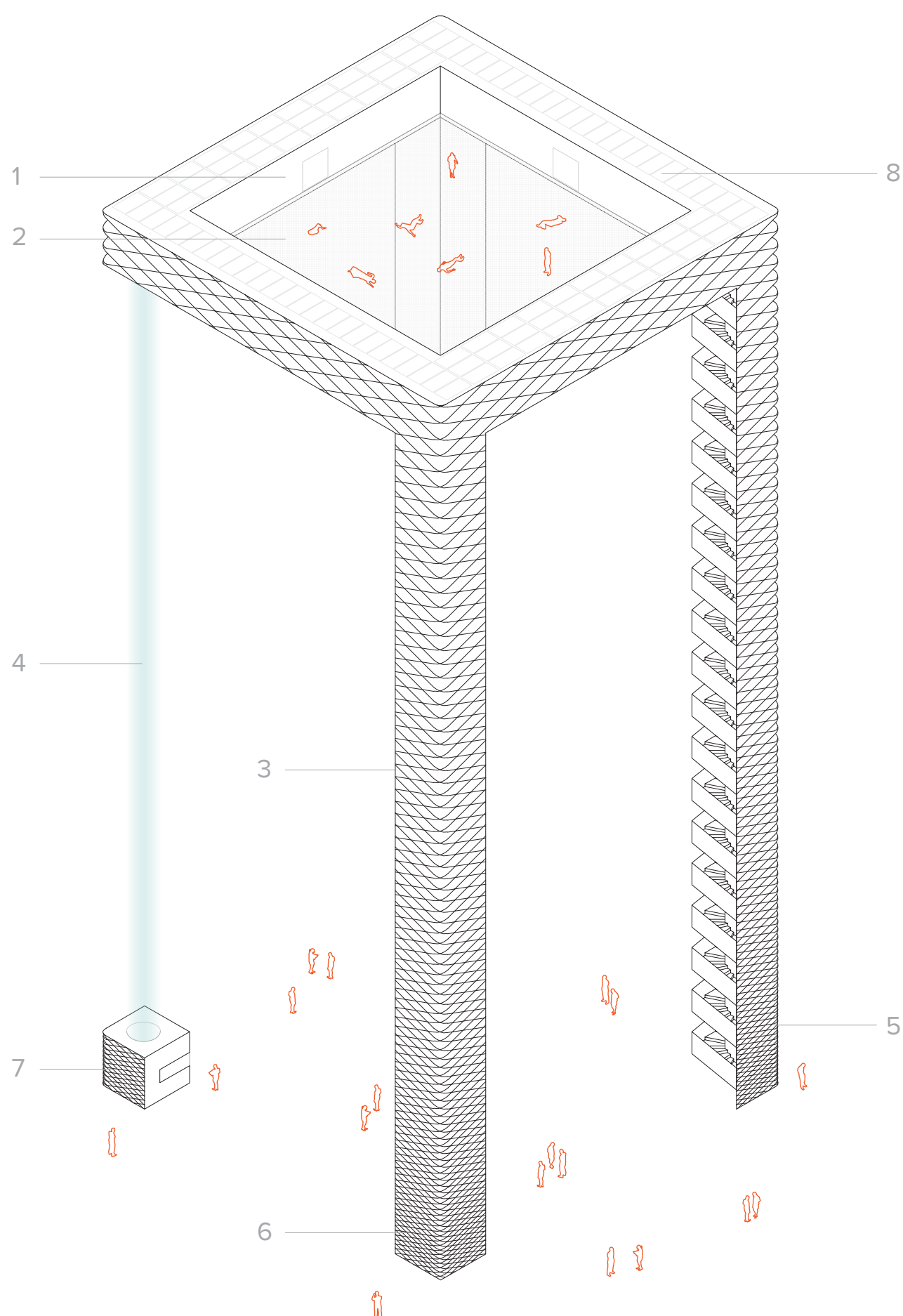

A People-centered Landmark:
The Record-breaking Climbing Wall & Suspended Plaza