



JUNGLE SPARKS



The goal was to create a unique landmark that enhances the quality of people's lives as well as preserves and improves the habitat of native animals. By combining a spectacular tower construction with vertical gardens, newest sustainable power generation technology, urban gardening and innovative lighting systems people and animals should get a place to relax, get together, retreat, enjoy projected image and video art, play or do sports.

In a first step it was important to find an adequate mental model for a design which should reflect the spirit and the unlimited innovation performance of Silicon Valley.

The idea of the design is to symbolize a creative firework of ideas by showing a sculptural landmark with visual effects looking like flying energetic sparks in the sky.

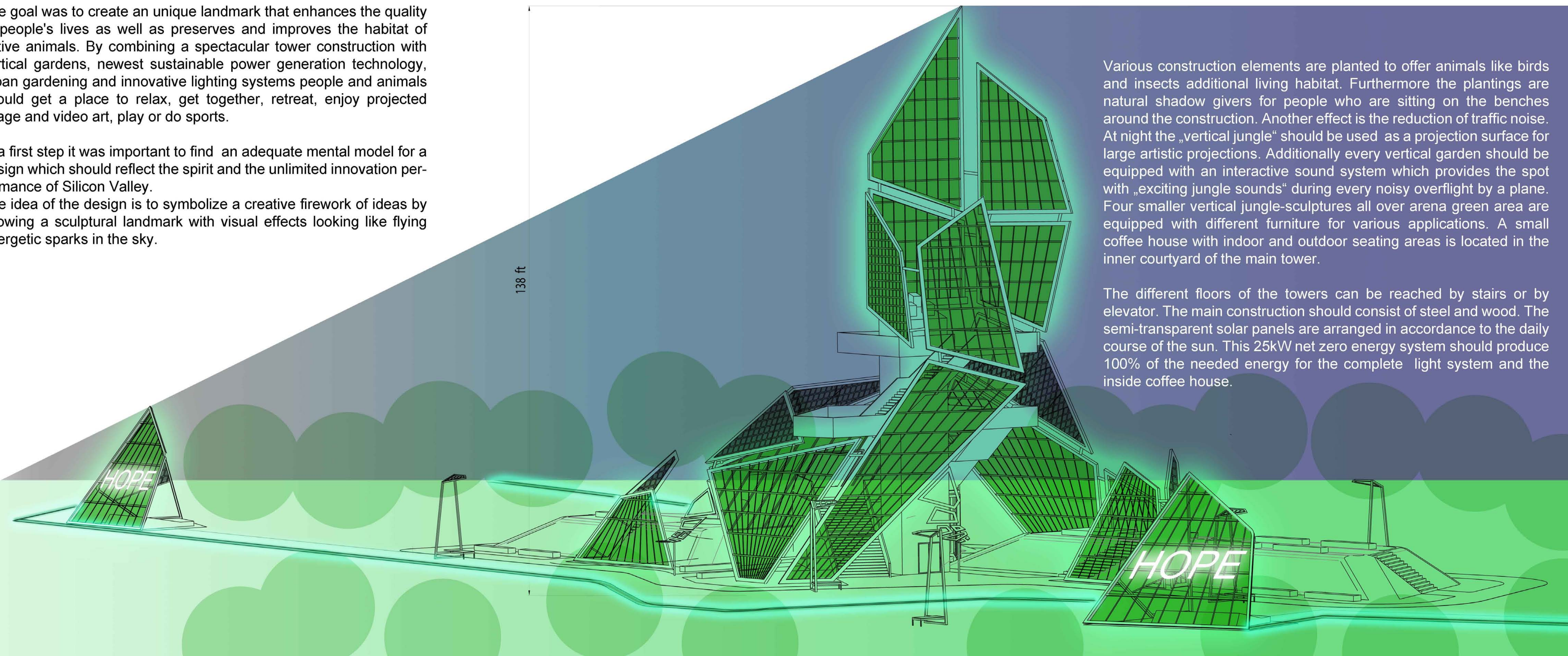

Various construction elements are planted to offer animals like birds and insects additional living habitat. Furthermore the plantings are natural shadow givers for people who are sitting on the benches around the construction. Another effect is the reduction of traffic noise. At night the „vertical jungle“ should be used as a projection surface for large artistic projections. Additionally every vertical garden should be equipped with an interactive sound system which provides the spot with „exciting jungle sounds“ during every noisy overflight by a plane. Four smaller vertical jungle-sculptures all over arena green area are equipped with different furniture for various applications. A small coffee house with indoor and outdoor seating areas is located in the inner courtyard of the main tower.

The different floors of the towers can be reached by stairs or by elevator. The main construction should consist of steel and wood. The semi-transparent solar panels are arranged in accordance to the daily course of the sun. This 25kW net zero energy system should produce 100% of the needed energy for the complete light system and the inside coffee house.

Every vertical garden should be equipped with an interactive sound system which provides the area with „exciting jungle sounds“ during every noisy overflight by a plane.

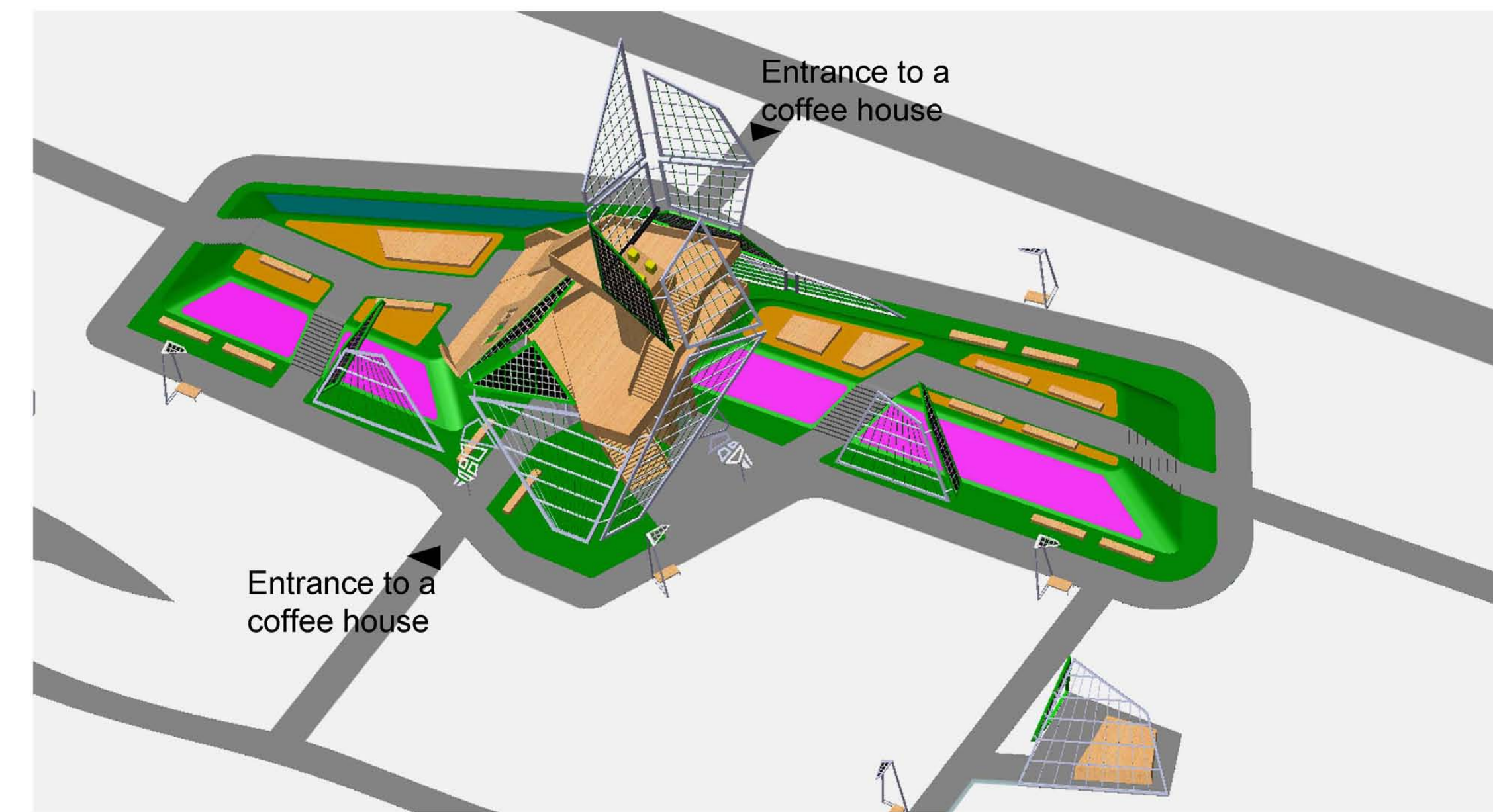
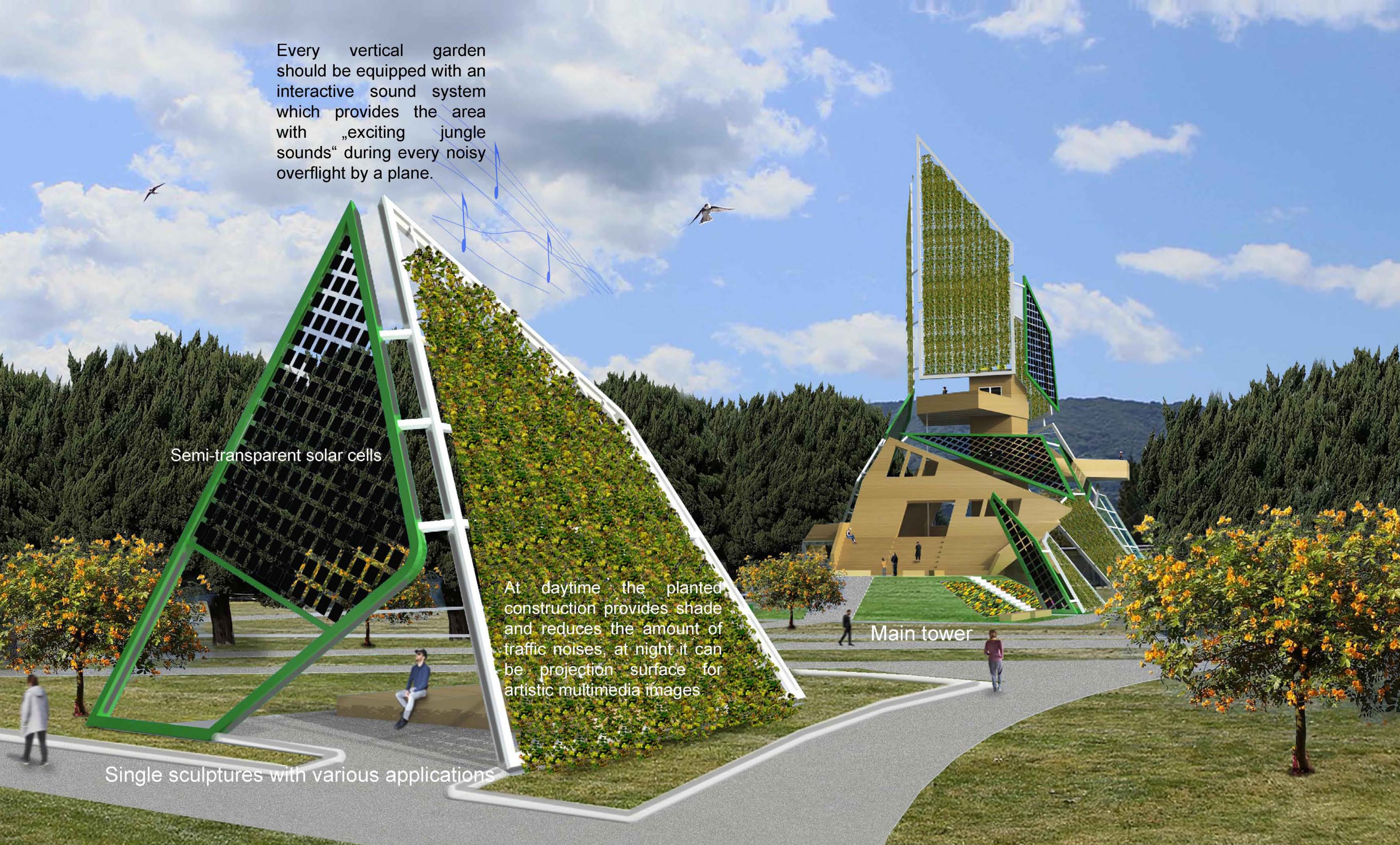

- Lawn
- Path surface
- Accessible recreation area
- Construction, seating elements made of wood
- Flower beds
- Vegetable beds for urban farming
- Beehives
- Construction beams, steel
- Semi-transparent solar cells
- Area with trees

