



ABOVE THE SKYGARDEN PLAZA

BELOW BIRDS EYE VIEW OF THE SKYGARDEN OVERLOOKING THE VALLEY



PROPOSAL FOR URBAN CONFLUENCE SILICON VALLEY IDEAS COMPETITION | 2020

Sky Garden is a true icon for the future of the Santa Clara Valley: an environmentally-minded park that inspires visitors to expand their horizons to the future without forgetting the details of the past that lay right in front of them through the creation of two unique viewplanes. As a living bridge decorated with the most sustainable and environmentally-friendly green infrastructure strategies, the living bridge creates a truly unforgettable experience without destroying the environment in which it is placed. Sky Garden serves as a living bridge that creates an iconic connection between river, city, and sky.



BIRD'S EYE VIEW STEPPING TERRACES



BIRD'S EYE VIEW SPATIAL EMBRACE

A New Icon in the Valley

San Jose deserves an icon worthy of the natural beauty of the Santa Clara Valley. Currently, the low-lying urbanized areas form a stark contrast to the magnificent framing of the surrounding mountains. This site offers an opportunity to add an additional icon to this dynamic landscape, one that establishes a connection to these mountains and the sky, a place that can lift visitors up from the horizontality of urban living to the complexity and ever changing beauty of nature.

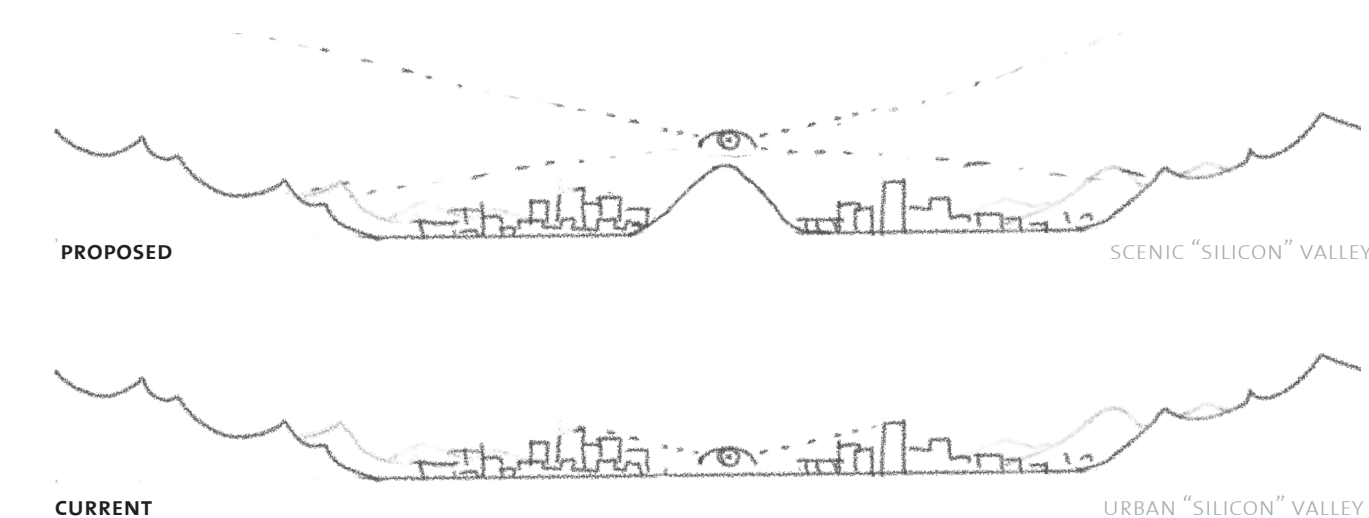

SITE CONCEPT
A bridge with two views

The bridge provides an opportunity for two opposite views: an expansive panorama to the north which, take in the full panorama of the Bay Area and the many inspiring geographies which drive the innovation economy. The bridge also creates an interior view and amphitheater, which draws attention to the confluence of two rivers and inspires visitors to reflect on the natural beauty right in front of them. This second view inspires visitors to learn more about the history and the past and provides ample opportunities for reflection and introspection which also motivate future leaders and change makers. Together, they form a bridge with two views: a striking park by day and an illuminated crescent ridge at night.

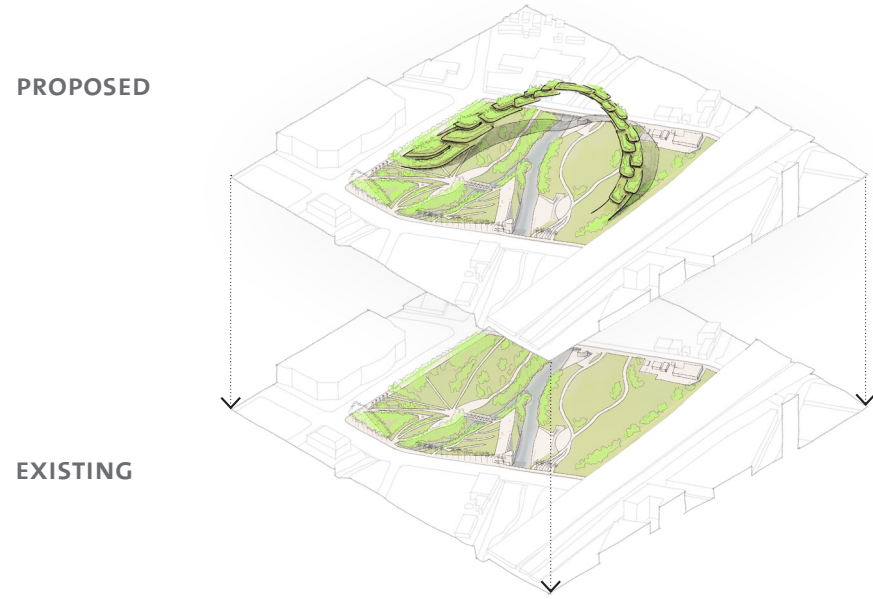

PROPOSED

EXISTING

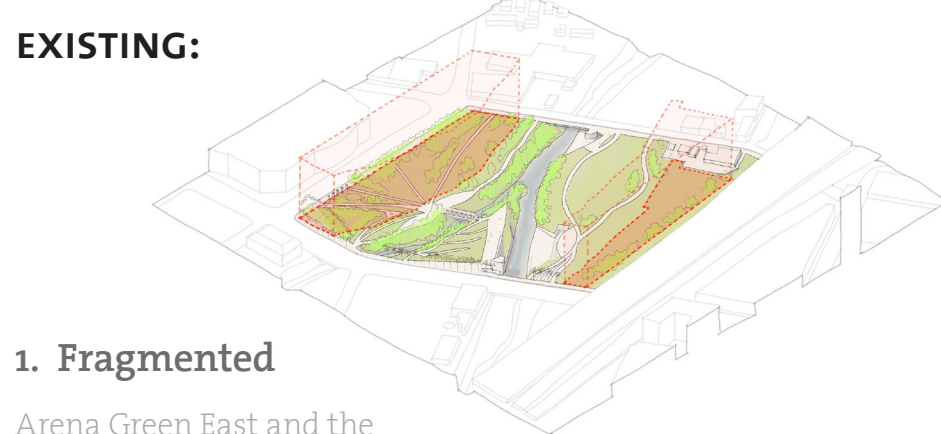

1. Fragmented

Arena Green East and the proposed site are fragmented.



1. Unite

Bridging the park's two sides through a gradual elevation extends the park area, improves walkability, and creates a distinctive architectural form.



2. Separated

Fragmentation creates an incohesive park experience that pushes visitors to walk along busy streets from one side of the park to another.



2. Create

The Sky Garden creates a unique experience for viewing Silicon valley and the Guadalupe River estuary. The inner side of the garden bridge creates an amphitheater for communal events and people watching.

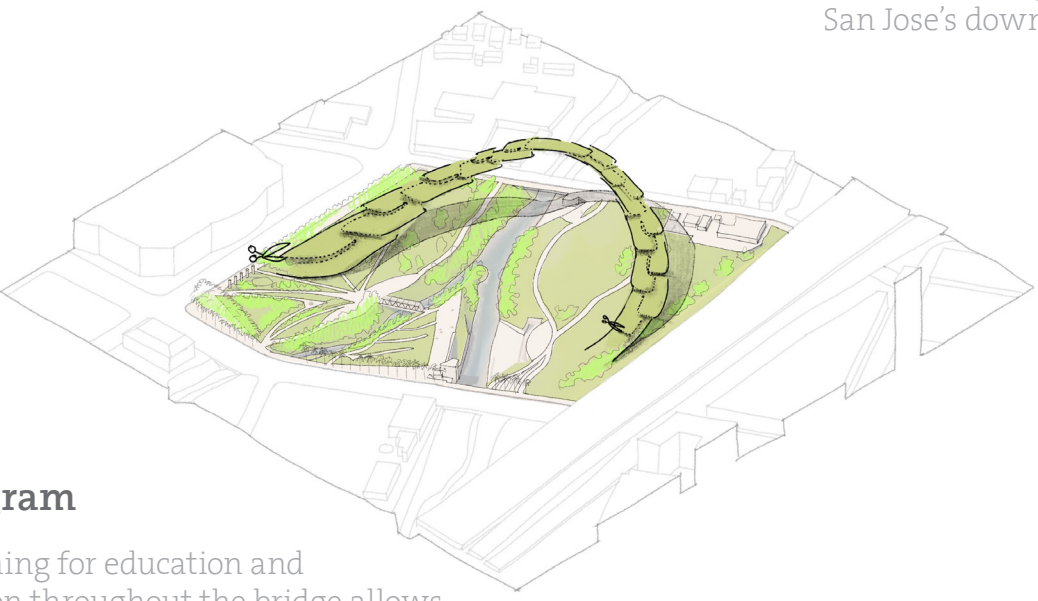

3. Program

Programming for education and recreation throughout the bridge allows for sustainable coexistence of natural ecosystems and humans.



SITE PLAN 1" = 150'

The plan of the Sky Garden reacts to the confluence of the Guadalupe river and Los Gatos creek. The resultant arched shape exposes the panorama of the Santa Clara Valley. The shape and orientation of the stepping terraces is informed by the solar orientation of the site. The concave side faces north provides natural shade and the spectacular views, while the convex side faces south and embraces the view over the Confluence point and Arena Green park.



CONTEXT PLAN

The centrality of the site's location creates a center piece in an otherwise sprawling urban fabric. A visual icon ties the newly developed Google campus with San Jose's downtown.

THE SKYGARDEN
A Living Bridge

Spanning across the Los Gatos Creek and the Guadalupe River, the San Jose Sky Garden also serves as a living bridge. Silicon Valley is a place to connect present and future without disregarding the past, the same way that the living bridge connects the West and East sides of the site. On the living bridge, humans have an opportunity to learn more about the unique flora and fauna which exist in the area's ecosystem without interfering with the fragile habitats below. The bridge includes a variety of green infrastructure features and is powered by renewable energy sources, creating a vibrant and sustainable gathering space that also speaks to the area's limitless potential.

Increased Tree Canopy and Avian Habitat

The Sky Garden adds dozens of new trees to the site, creating new habitat for bird species and facilitating opportunities for bird watchers and visitors to learn more about the region's species. The tree canopy maximizes carbon sequestration, contributing to the site's carbon offsets.

Permeable Surfaces and Bioretention Rain Gardens

The porous material of the walkway and various green plantings capture and filter rainwater to reduce stormwater runoff. They also feed retention systems which facilitate a more sustainable watering regimen during periods of drought.

Noise reduction

Vegetation is shown to reduce noise pollution in heavily congested urban areas. The hanging gardens on the bridge's eaves absorb noise from the nearby freeway and make the space more accessible and enjoyable.

Passive Cooling and Ventilation

Ample shaded areas and the structure's unique shape create chambers of passive ventilation which keep the site an enjoyable temperature without having to provide air conditioning. Exterior spaces reflect heat to minimize urban heat island effect.

Minimal building footprint

The bridge's minimal footprint results in maximization of permeable surfaces, reducing runoff into the nearby creek. It also creates shaded lawn areas for visitors on either side of the bridge.

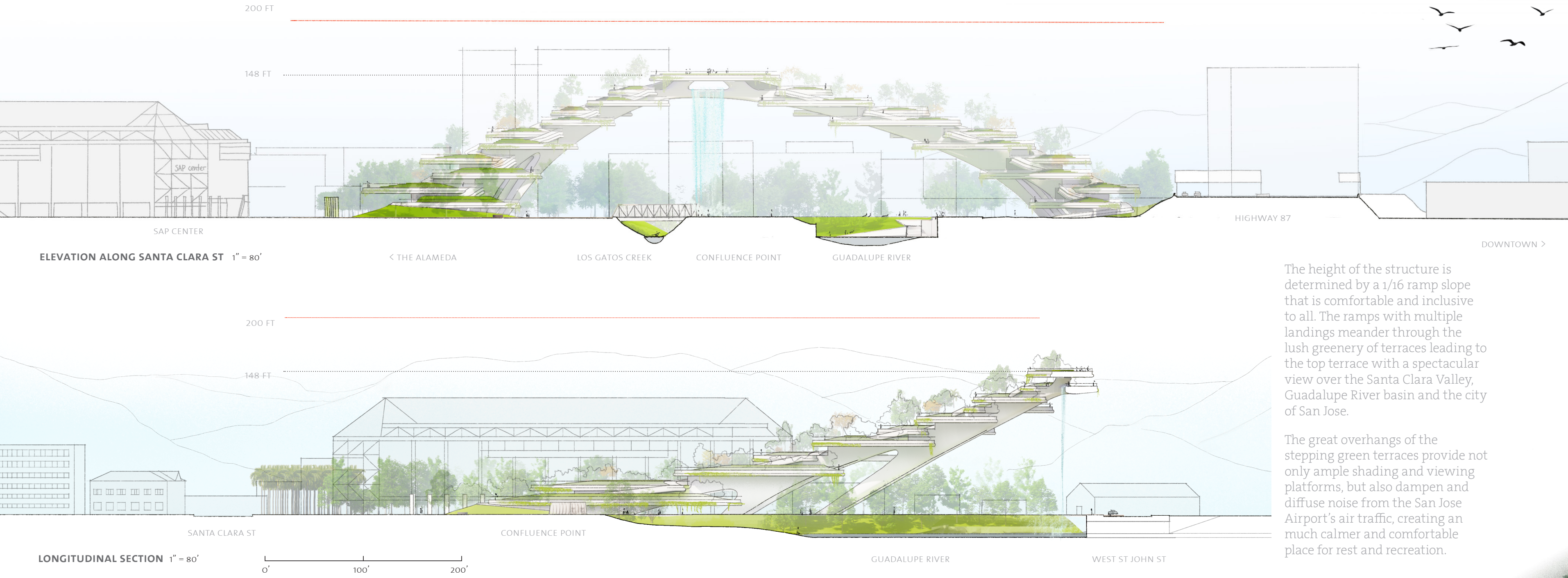

ELEVATION ALONG SANTA CLARA ST 1" = 80'

LONGITUDINAL SECTION 1" = 80'

The height of the structure is determined by a 1/16 ramp slope that is comfortable and inclusive to all. The ramps with multiple landings meander through the lush greenery of terraces leading to the top terrace with a spectacular view over the Santa Clara Valley, Guadalupe River basin and the city of San Jose.

The great overhangs of the stepping green terraces provide not only ample shading and viewing platforms, but also dampen and diffuse noise from the San Jose Airport's air traffic, creating an much calmer and comfortable place for rest and recreation.

