

highline bikeway flyover  
yacht haven jellybean joyride  
aquarium bart station

Greedy Developers move airport to Moffett Field; replace runways with inlet extending from open water to site; they develop inlet as new city center of a million people in fifty-story free rent fully self-sustaining mixed use structures that house all from beggars to billionaires; front porches on open air walks = neighborliness; maintenance fees prorated to income include health/child/elder care; business activity within feeding on excess incomes = huge profits.

Extraordinary CA sculpture freeway flyover weds NYC highline as bikeway flyover over yacht haven; box girder houses high speed bikes + skateboarding; egg/dart windows = wonderful moving lighting pattern on structure above.

Upriver canal system connects all along 100ft contour for six miles leading to 75ft waterfalls and fish ladder/kayak run; triangle park is untouched; area under carved out for immense elliptical aquarium at BART station; windows view fish ladder from salt to fresh. Falling water = energy generation.

Pagodas replicate various Asian forms; house food/drink, bike shops, arcades, restrooms etc; yacht haven walls contain same plus boat services, artist/craft studio/residences, hostels, staff housing etc.

Freeway removed, traffic dumped on downtown streets reconfigured as lanes on river parks; central flyover main lanes repurposed as theme park using copies of oldest buildings still standing in 200 largest US cities as infrastructure and amazing rides including hotel room Ferris wheel; thru lanes added to fly lanes accommodates traffic needs.

All buildings required to separate grey water, clean to potable and drain to nearest canal.

High speed rail Santa Maria/Boise route stops at site and airport.

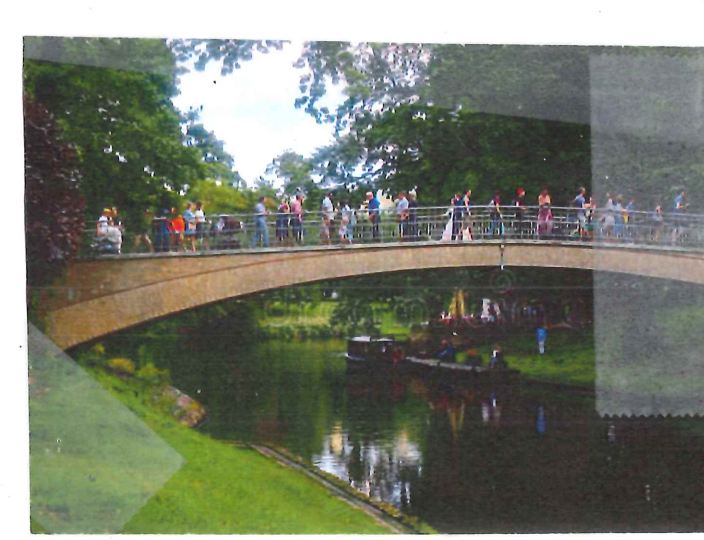
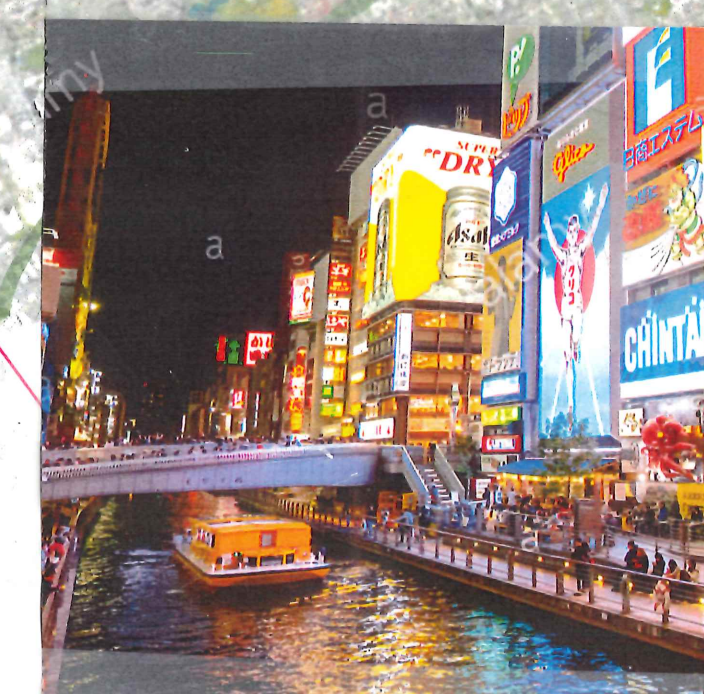
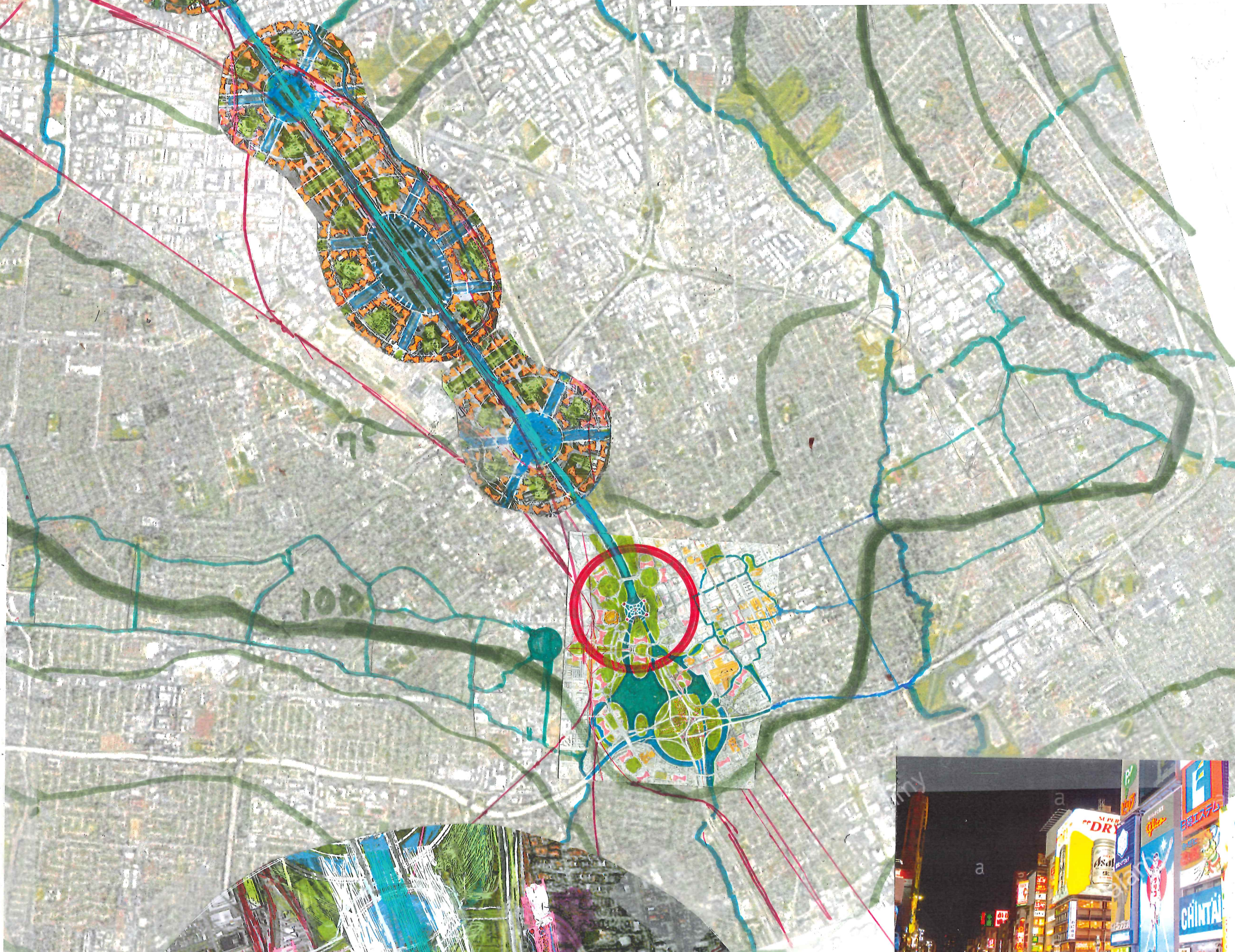
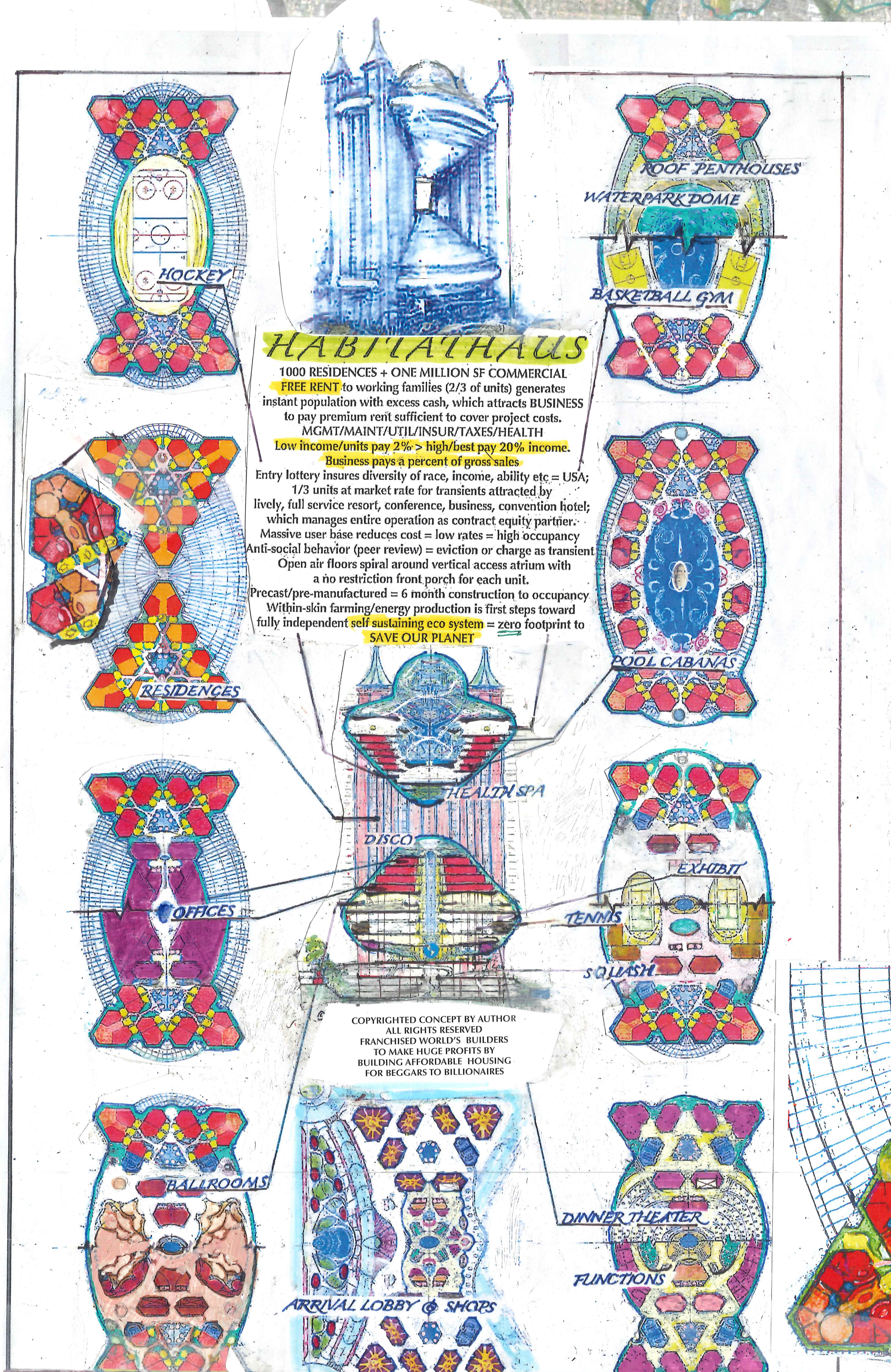



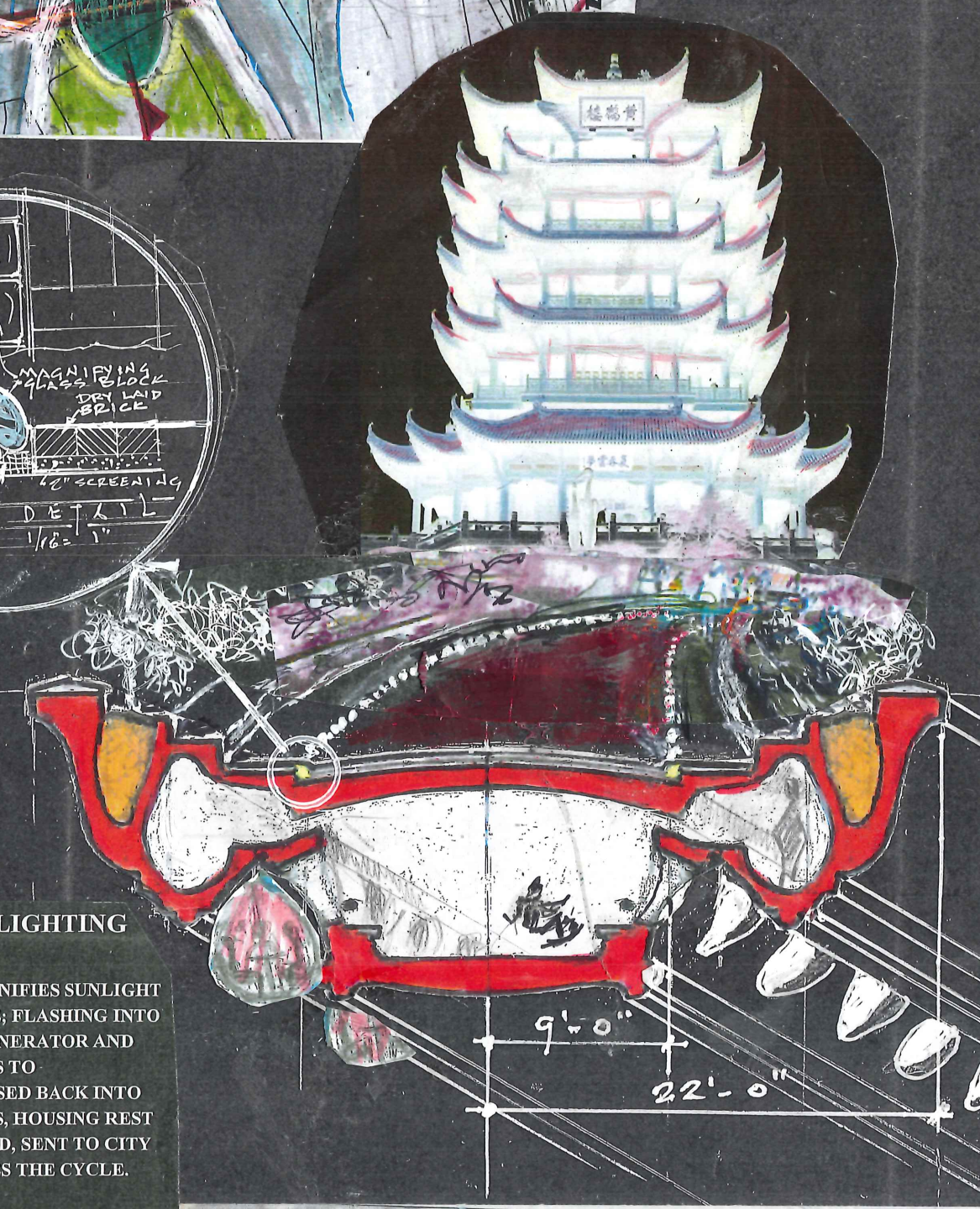
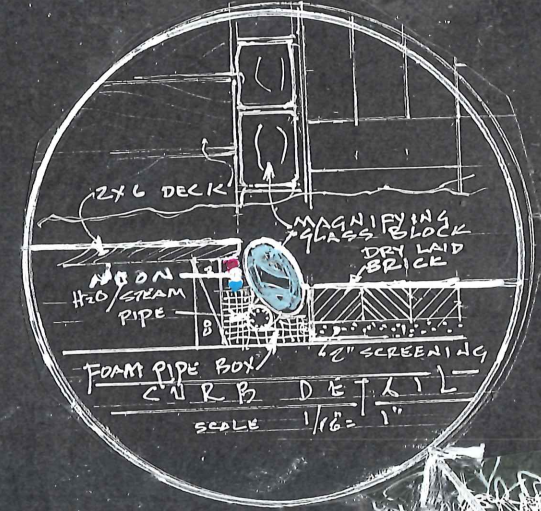

#### NET ZERO ENERGY AND LIGHTING

CUSTOM GLASS BLOCK CURBING MAGNIFIES SUNLIGHT ONTO NANO "GRASS" SEA WATER PIPE, FLASHING INTO STEAM THAT DRIVES ELECTRIC GENERATOR AND FLYWHEELS; THEN RISES TO ROOF AREAS OF PAGODAS; CONDENSED BACK INTO DRINKING WATER FOR RESTAURANTS, HOUSING REST ROOMS ETC; GREY WATER IS CLEANED, SENT TO CITY CANALS; WATERFALLS COMPLETES THE CYCLE.

WATERWHEELS BEHIND WATERFALLS DRIVE FLYWHEELS AND DYNAMOS; ALSO DRIVEN BY AIR COMPRESSED BY TIDE PUMPS.

GLASS BLOCK CURBS ARE BACKLIT BY RED, WHITE, BLUE NEON TUBES WHICH RESULTS IN MAGICAL NIGHT LIGHTING OF BIKEWAY - SAFE RIDING UNDER THE STARS;

INTERNAL HIGH SPEED WAY HAS CEILING LIT INDIRECTLY, MOVING SHADOWS THROUGH - DART OPENINGS SPARKLE QUIETLY.

