

DARK STARS

URBAN CONFLUENCE SAN JOSE 2020

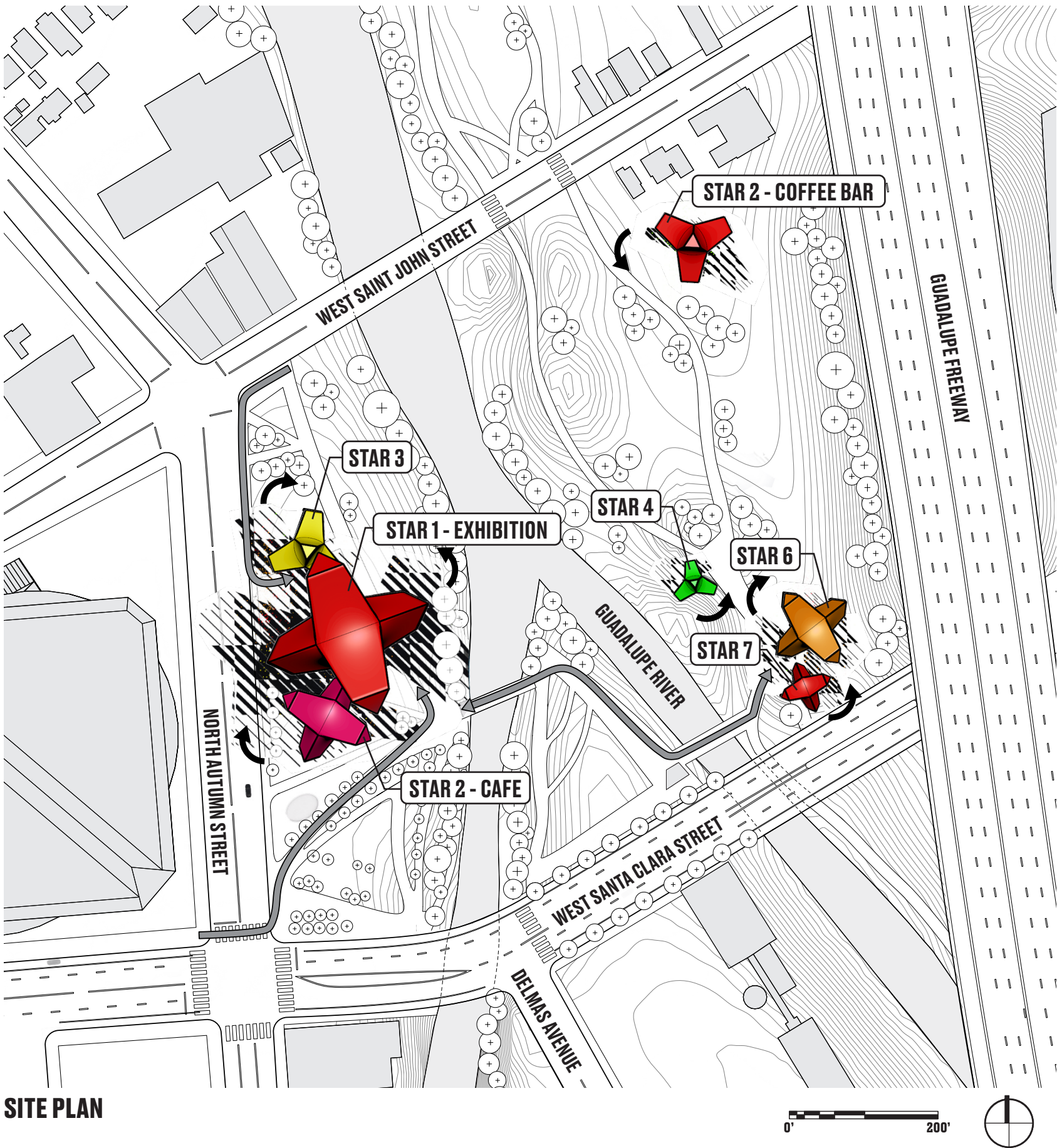

VIEW FROM GUADALUPE FREEWAY LOOKING WEST



SITE PLAN



INSIDE THE THICK WALL WITH VIEWS TO THE CITY

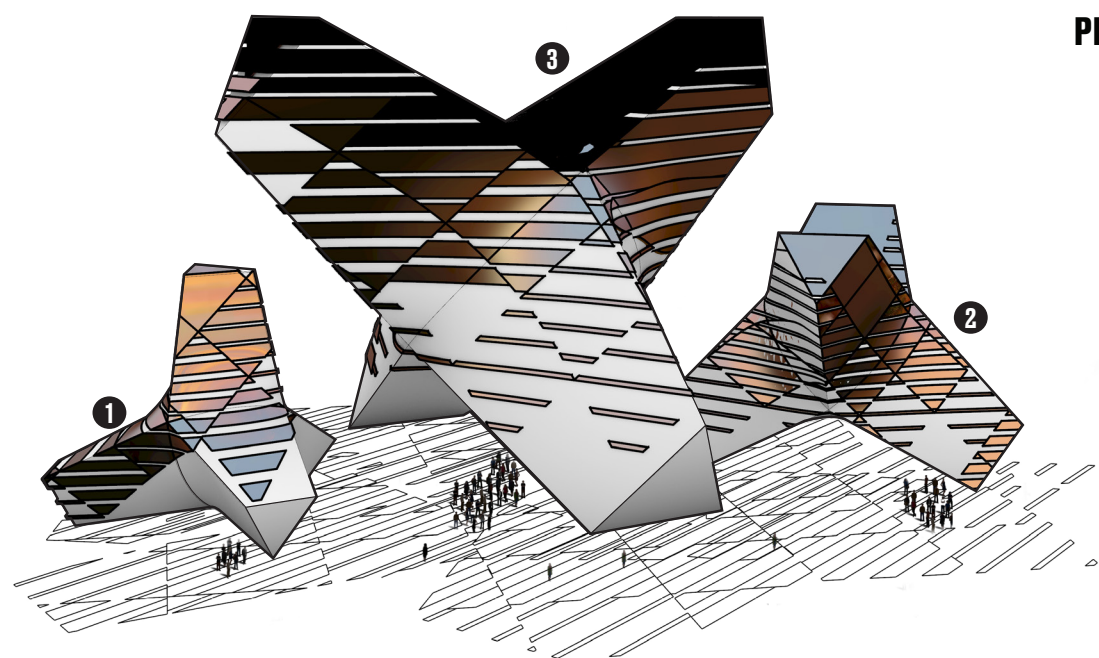

PLANETARY ENERGY

- 1. 3,500 SF PHOTOVOLTAIC PANELS
 - 2. 6,500 SF PHOTOVOLTAIC PANELS
 - 3. 18,000 SF PHOTOVOLTAIC PANELS
- TOTAL: 40,000 SF PHOTOVOLTAIC PANELS (INCLUDING SATELLITE STARS)
- 1. 40,000 SF X 16 W/SF = 640 KW (DC RATING) - 1000 KW (AC RATING)
 - 2. 640 KWH X 7 HOURS PER DAY X 365 DAYS = 1,635,200 KWH
 - 3. TYPICAL HOUSE KWH PER YEAR CONSUMPTION = 10,000 KWH
 - 4. DARK STARS PROVIDE ENOUGH POWER FOR 165 HOUSES ANNUALLY

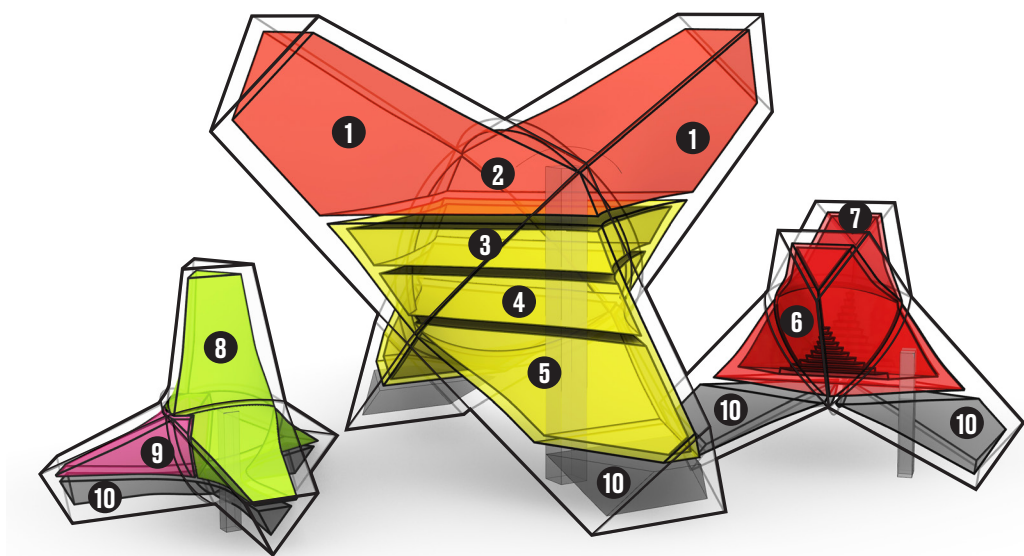

DESTINATION

- 1. SKY DECK
- 2. RESTAURANT
- 3. SUSTAINABLE TECHNOLOGY EXHIBITION
- 4. IDEAS AND INVENTIONS EXHIBITION
- 5. TEMPORARY EXHIBITION
- 6. THEATER 1
- 7. THEATER 2
- 8. CAFE WITH ACCESS TO RIVERS
- 9. KITCHEN
- 10. HVAC / SUPPORT

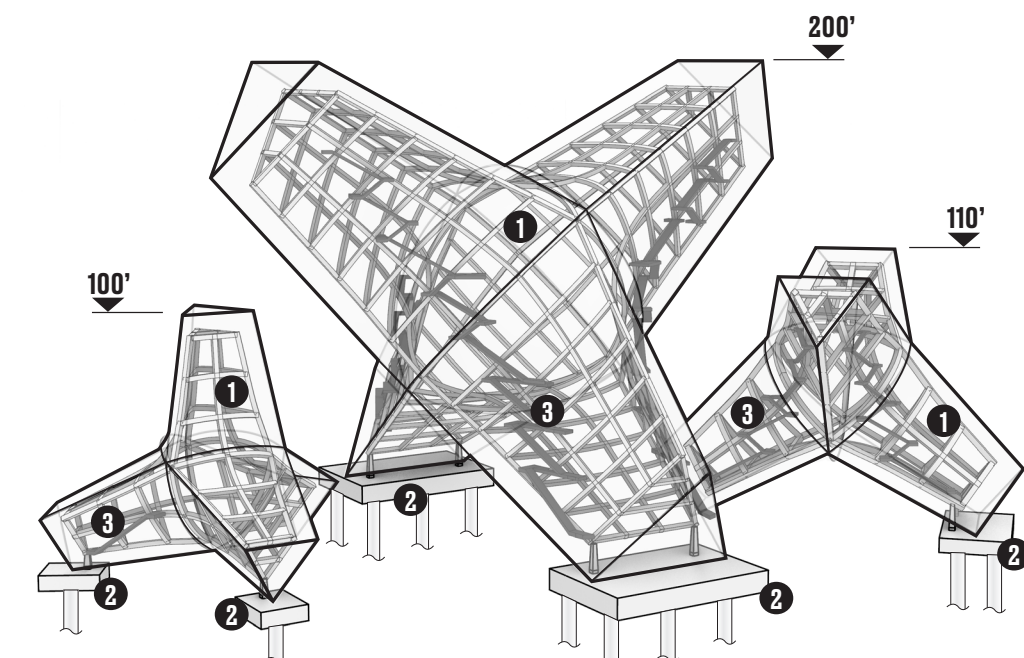

CONCEPT DIAGRAMS

STRUCTURE + EGRESS

- 1. 18"X18" STEEL FRAME
- 2. CONCRETE PILE CAPS AND DEEP FOUNDATIONS
- 3. EGRESS

FEATURE LEGEND

- 01 - LED EMBEDDED SURFACE
- 02 - LOUVER FACADE
- 03 - SOLAR PANELS
- 04 - THICKENED WALLS
- 05 - ELEVATOR
- 06 - PUBLIC CIRCULATION
- 07 - EXHIBITION SPACE
- 08 - HELIX

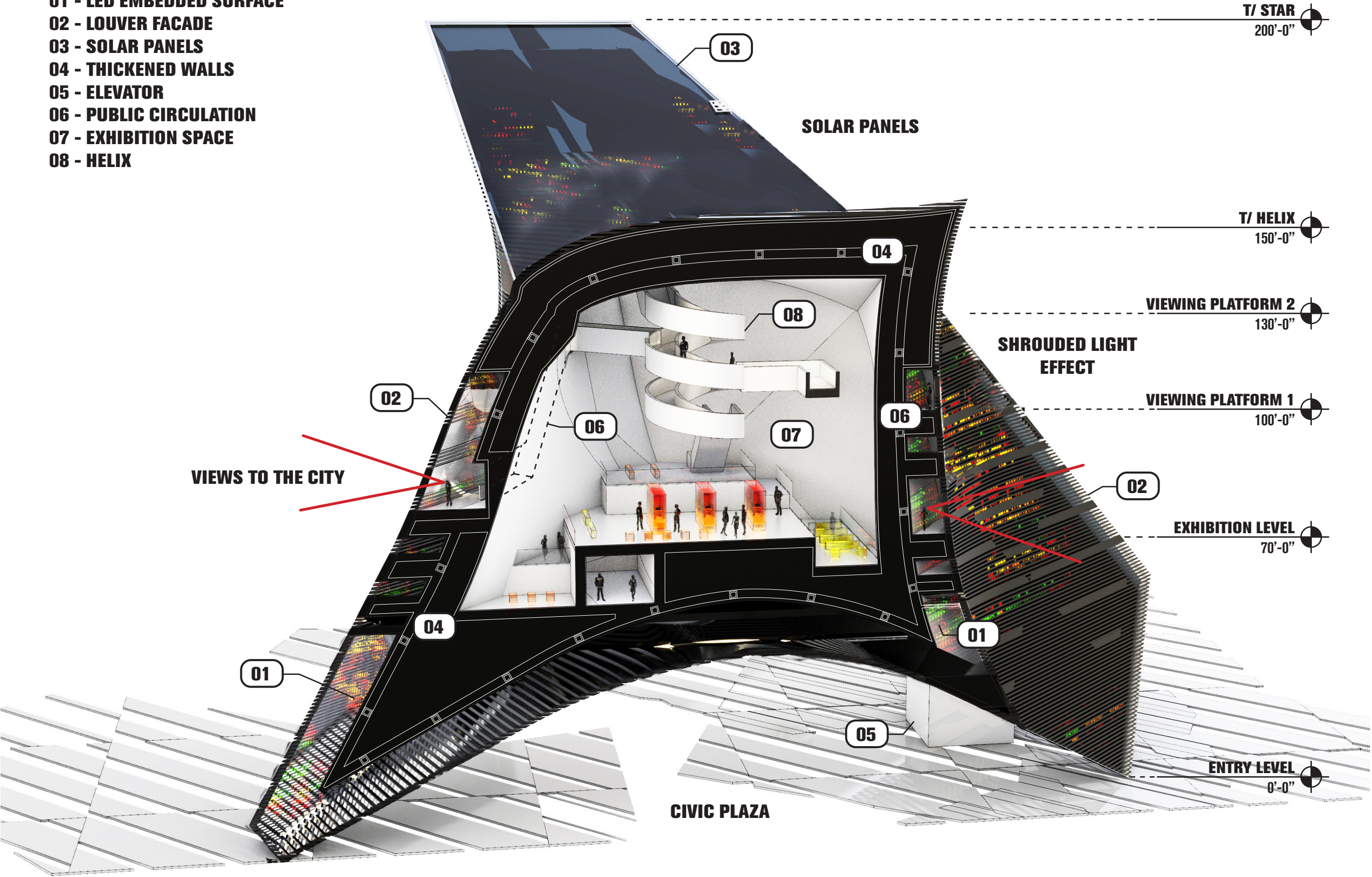

INSIDE THE STAR

An ensemble of mysterious technical objects creates a new form of icon: a destination packed with public programs, situated in an enchanting civic plaza.

DARK STARS

URBAN CONFLUENCE SAN JOSE 2020

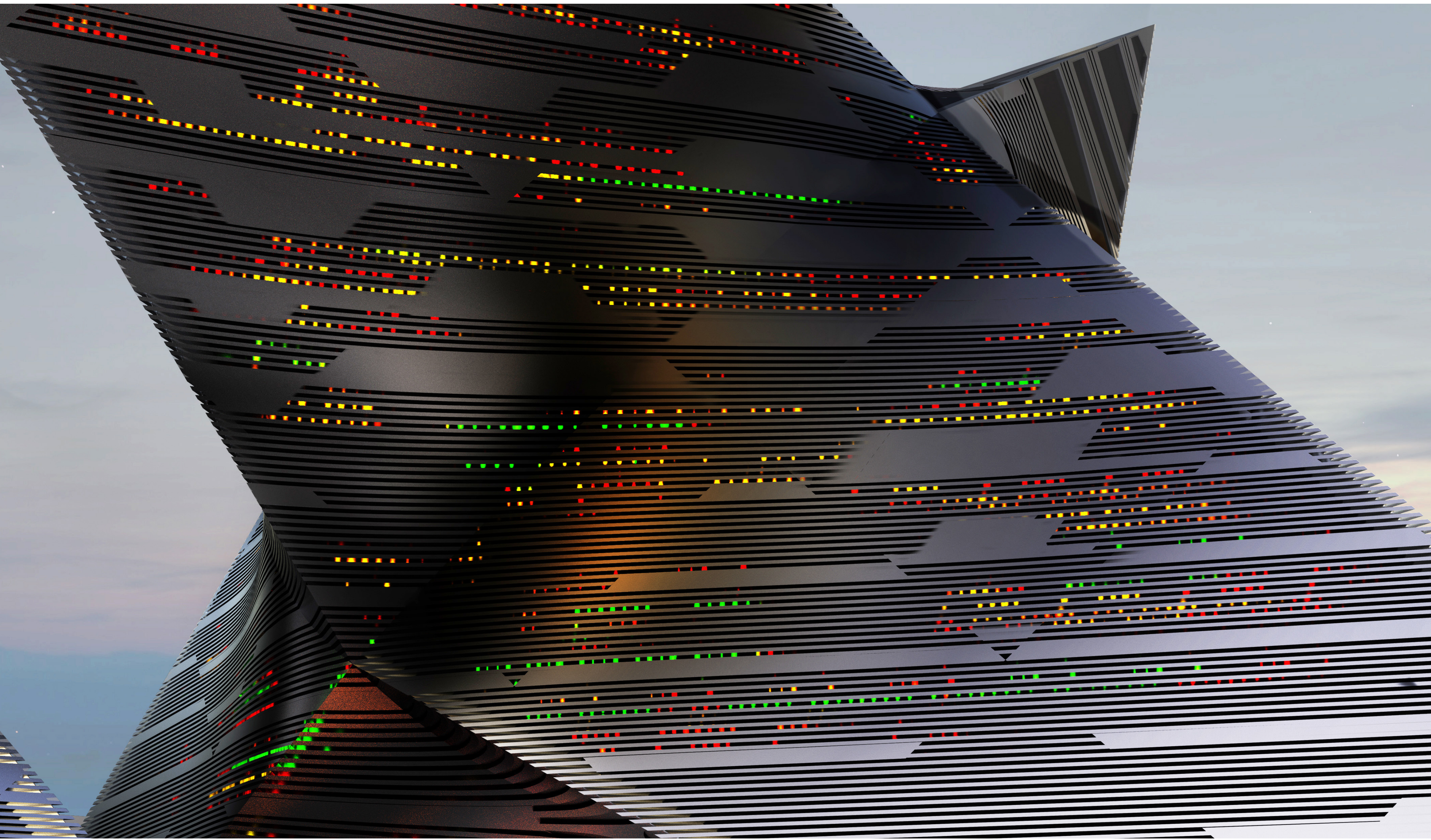
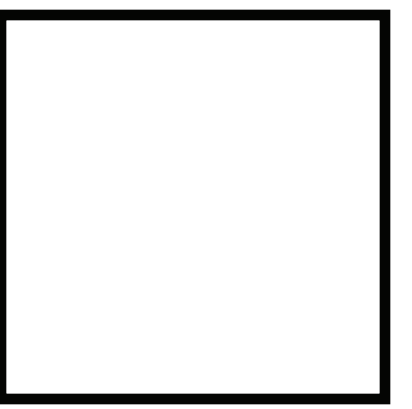

MYSTERIOUS TECHNICAL OBJECTS SEEM TO CONTAIN THE SECRETS OF SILICON VALLEY



DARK STARS CREATE AN ALLURING CIVIC PLAZA BENEATH

These enigmatic forms bring wonder and playfulness together in this land of disruption, celebrating discovery and engagement with the unknown.