

# Multiverse

## Your Vision, Our Future.

### Concept

The southern part of San Francisco has got the highest technology and innovative center in the world. The Silicon Valley is the home to iconic technology companies like Apple, Google and Facebook. This Center has connected the world together as one and turned earth to be a small village. Judging by the human experience, Tech. has had an effect on time and place. In the past, the earth was divided into totally separate regions each has its own identity and culture. Traveling from one place to the other could take months. There was limited interaction between human beings, this relation was controlled by the borders of places. Nowadays after technology, the world

turned smaller. The effect of one human being on the others has increased. One virus could spread in the whole world in few weeks. In the future, the world will be a small town, making a journey from one continent to the other take a few minutes. The border of time versus place will totally be collapsed. Creating a landmark in San Jose has to focus on how this city changed the whole world to be connected together and enabled the people around earth to know each other better. The high inventions achieved in San Jose created a new united world in cultures and traditions.

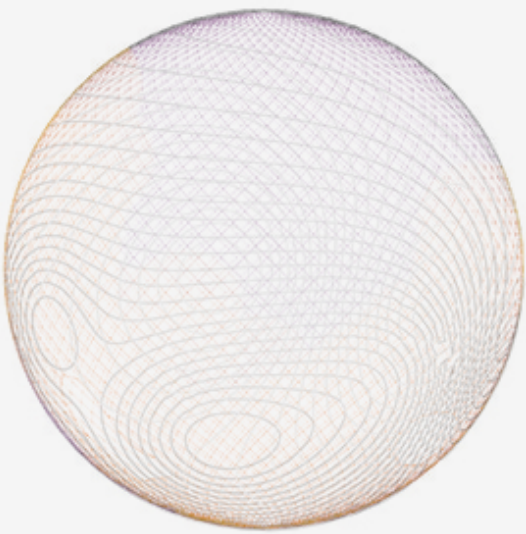
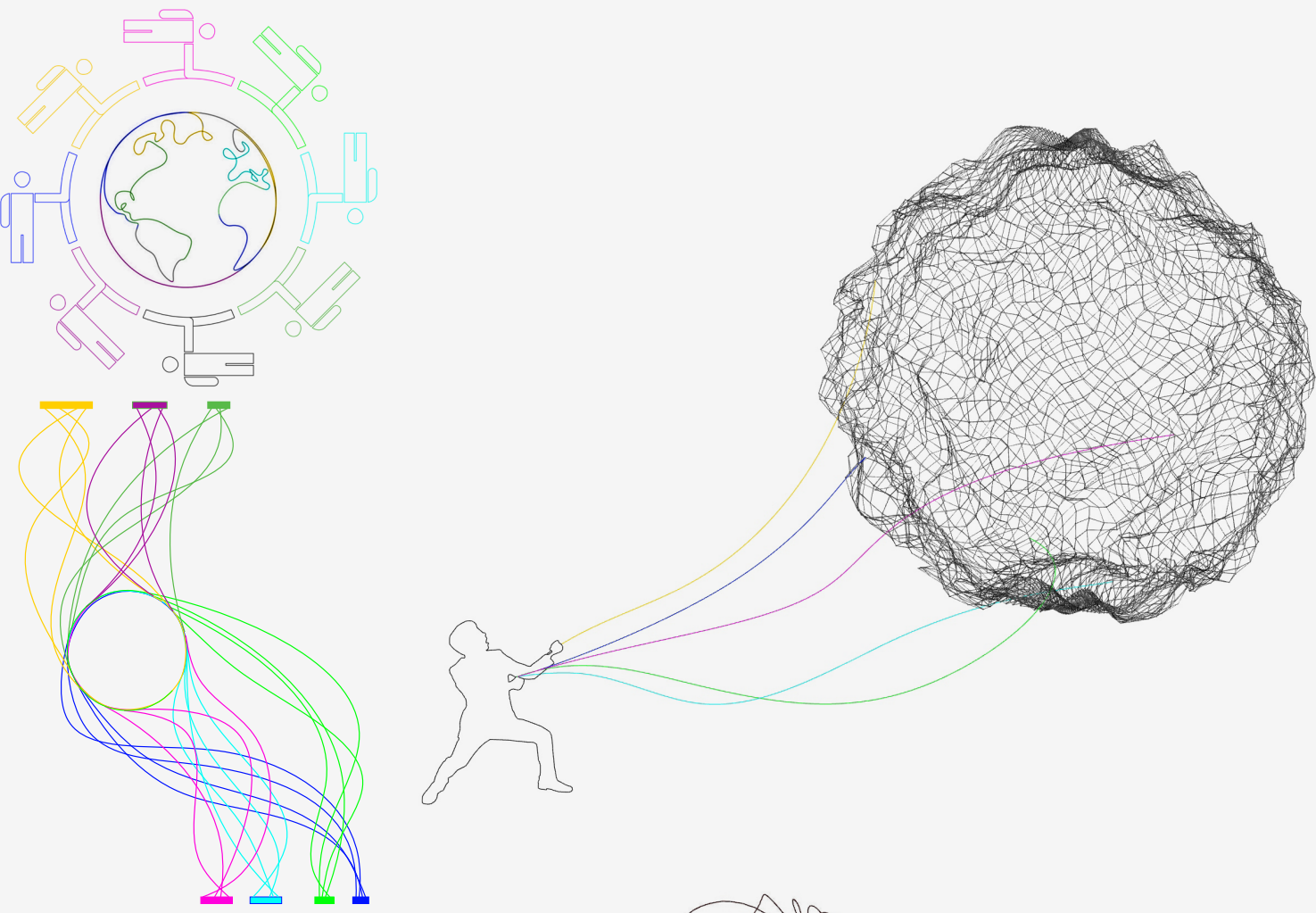

Deformation 0.0%

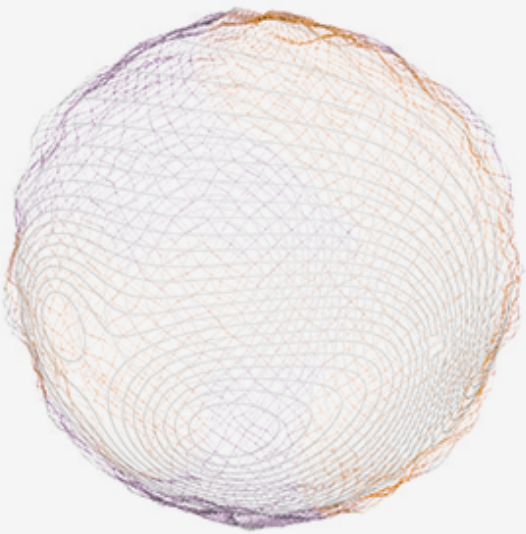

Deformation 25%

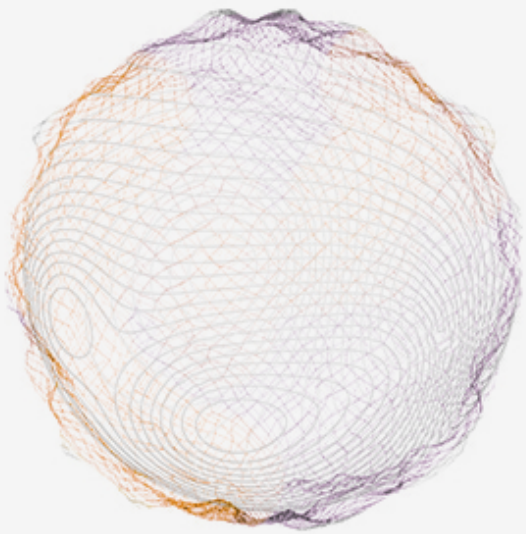

Deformation 50%

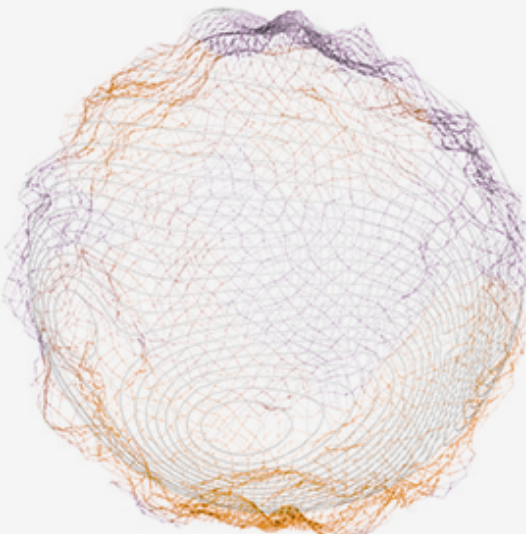

Deformation 100%

### Activities

This concept represents a transformed landmark that the visitors of San Jose arena will share to create. The arena's main volume is a multi-functional sphere with diameter 40 meters. The sphere could work as an exhibition, event space, watchtower and hologram display. The visitors enter inside the main volume through two ramps, one from the main entrance at Santa Clara street beside SAP center which mainly serves the train station. The second ramp is from St. John street that directly connects the other side of the river to the main sphere. Walking through the ramp the visitor can see a display of the history of San Jose and Silicon Valley. As well as, an imagination for the future

of the most innovative cities. The sphere skin is controlled by the strings which the visitors move to open and close. Also, to change the form of the sphere. The controlling strings are going down to create activities, seats and playgrounds in the Arena's landscape. The structural system of the sphere is a shell structure resting on pillars from three sides. Pillars are surrounded by the controlling strings to distract the image to keep the sphere floating in the air. To summarize the idea, our new earth is affected by all of us regardless of our colors, nationalities or races. Every human is putting his impact to create a united world which we all complete each other in.

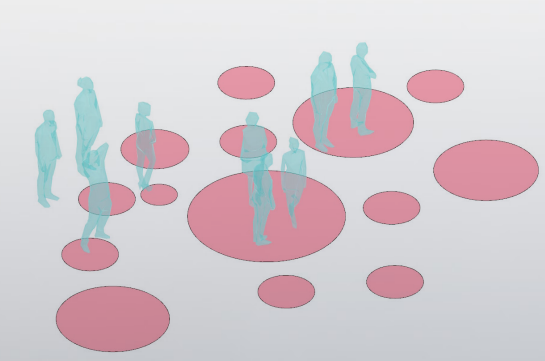

Activity areas

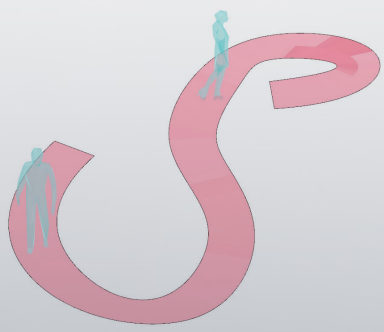

Ramps

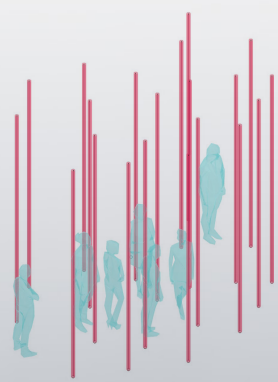

Rope Climbing



Gathering Space

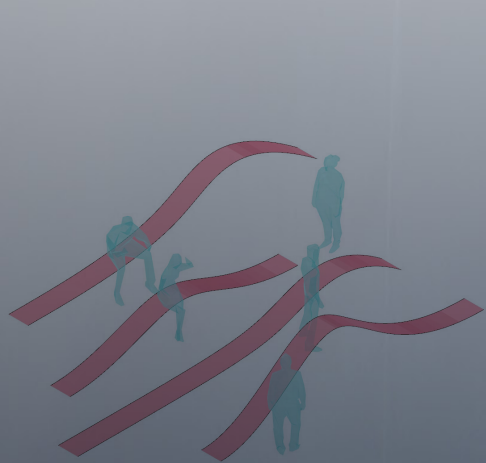

Seating Areas



Seating Canopies

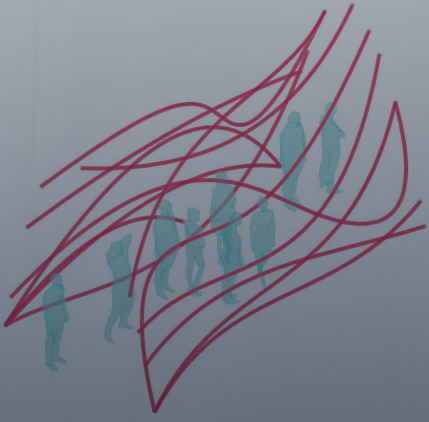

Shading

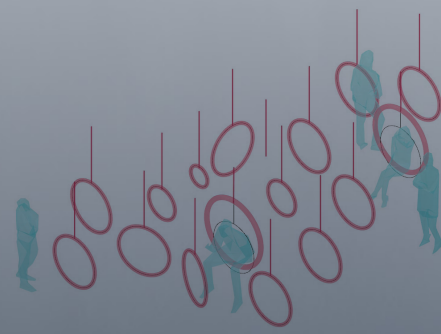

Swinging Jungle

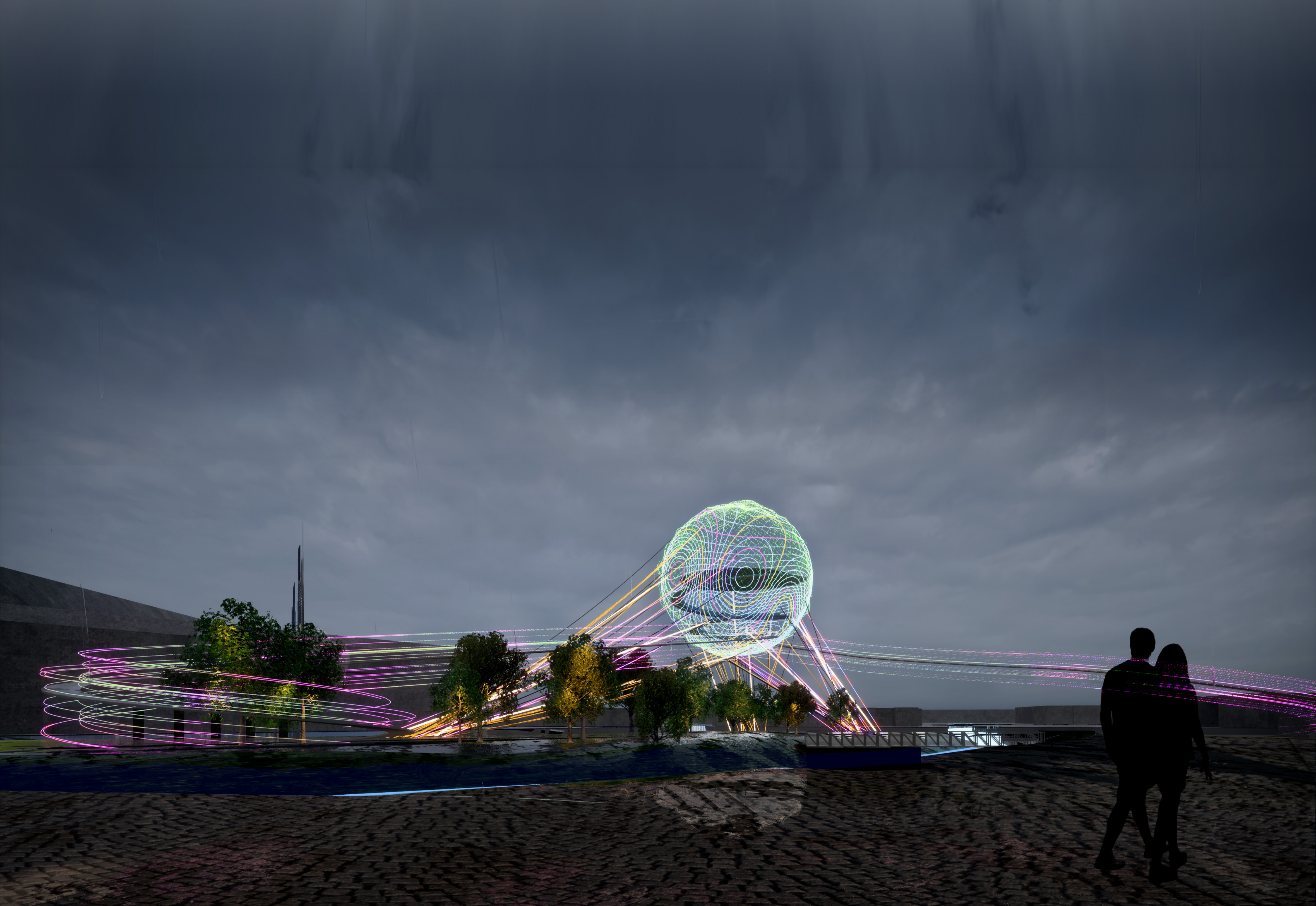
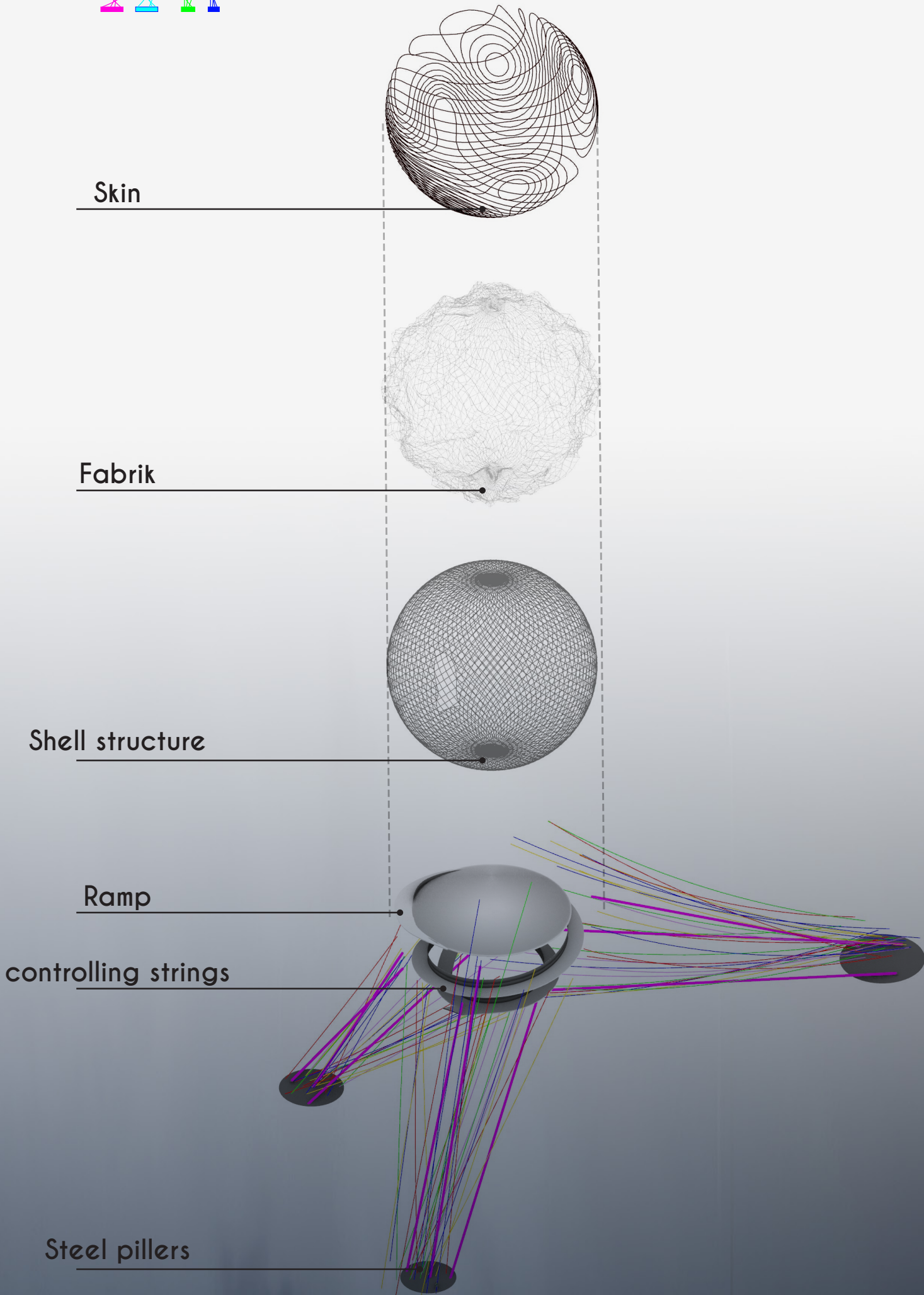



# Multiverse

Your Vision, Our Future.

## Form Finding

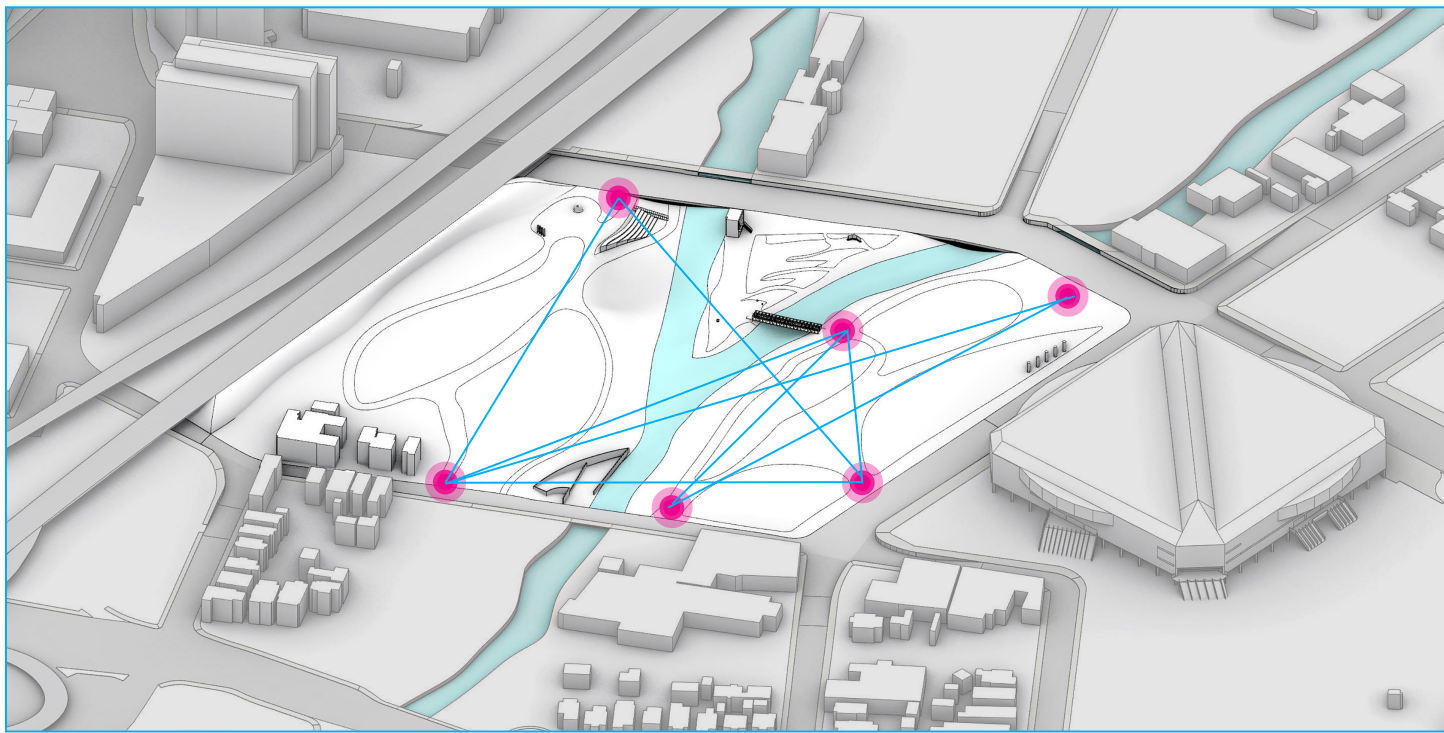

1-Visitors entrance points and Axis.

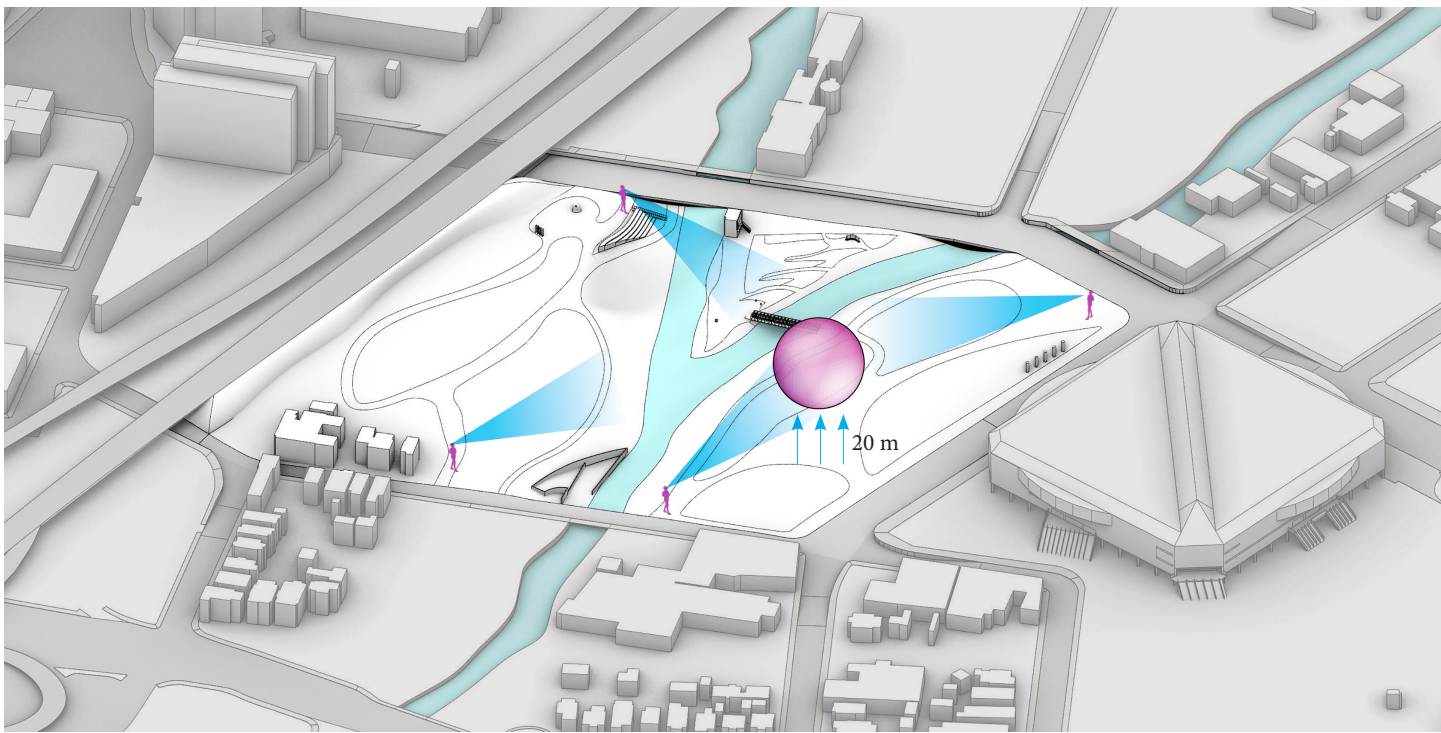

2-Sphere represents the Virtual Earth.

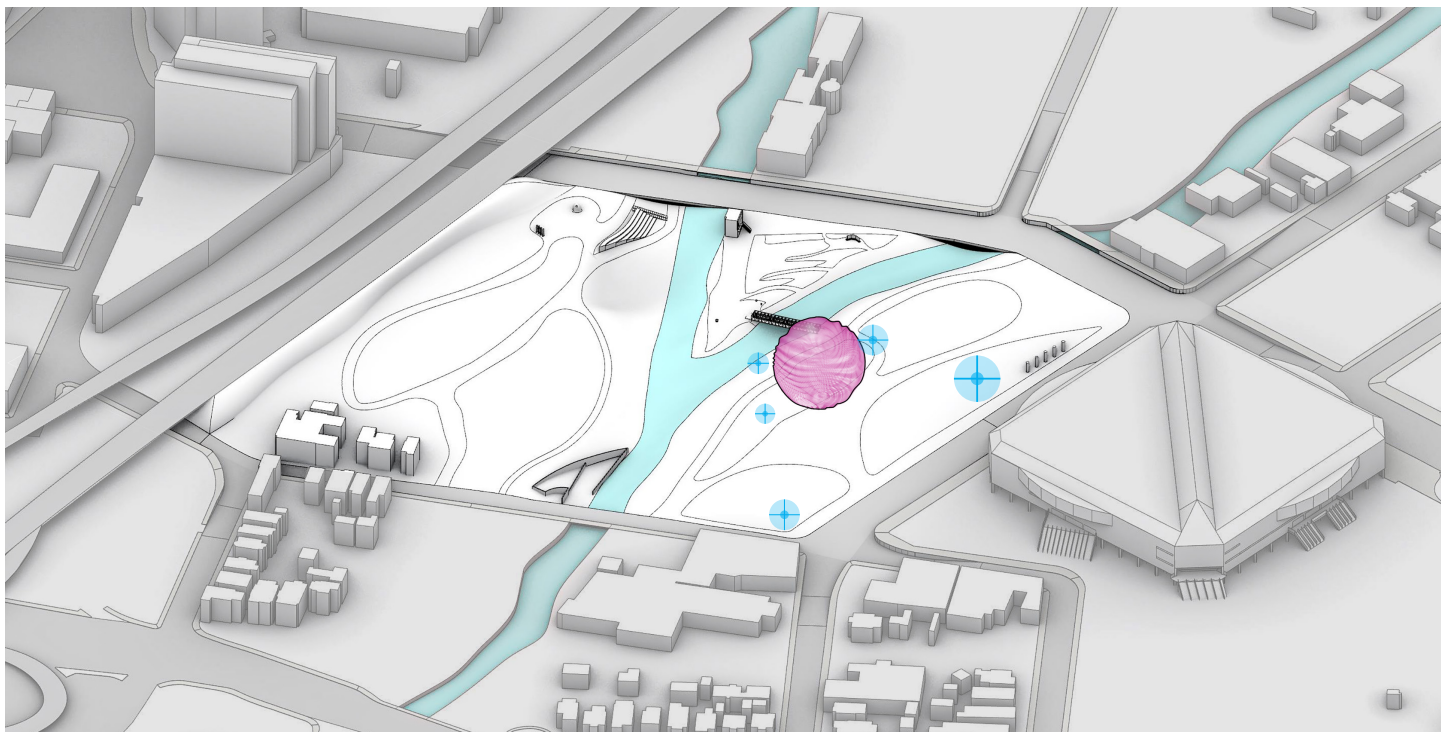

3- Sphere deformation according to main supports and the two entrances.

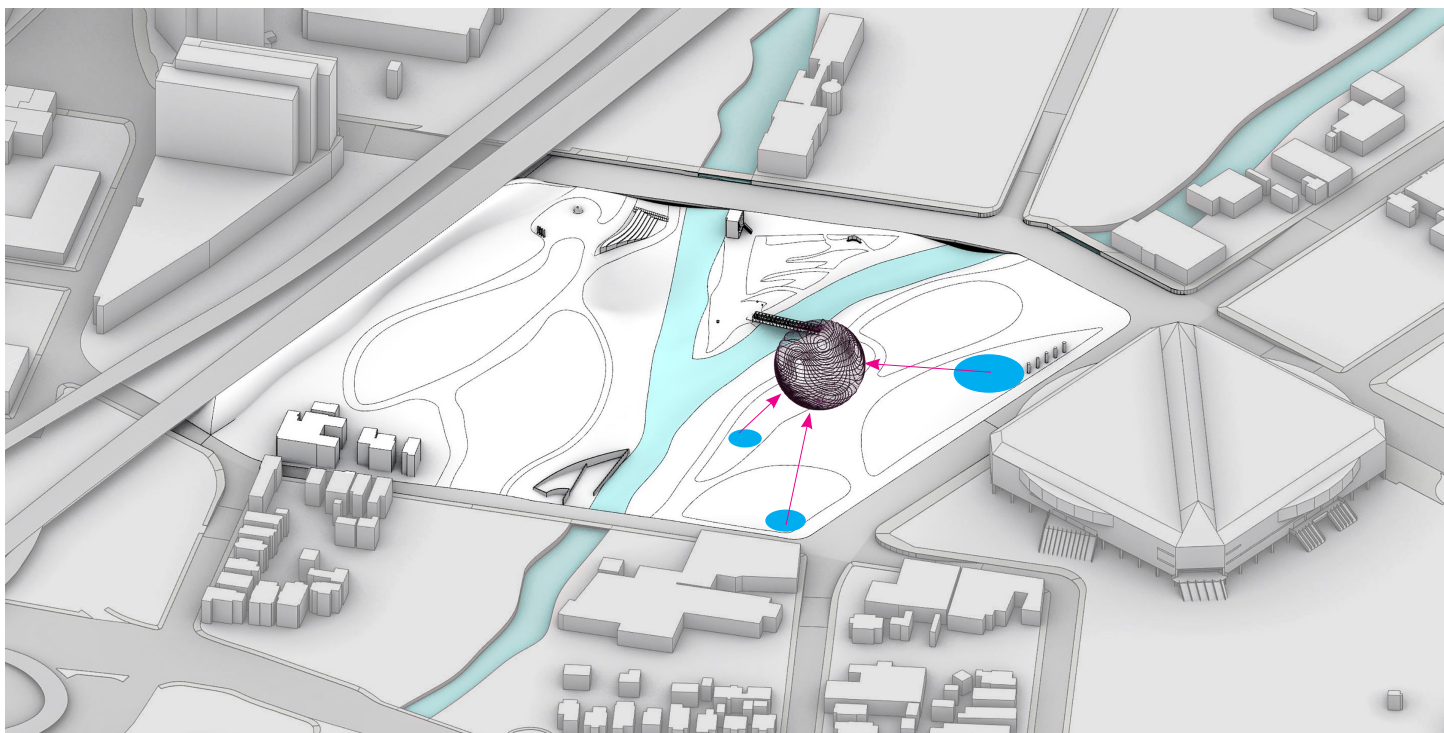

4- Sphere fabric and the three main rancor points .

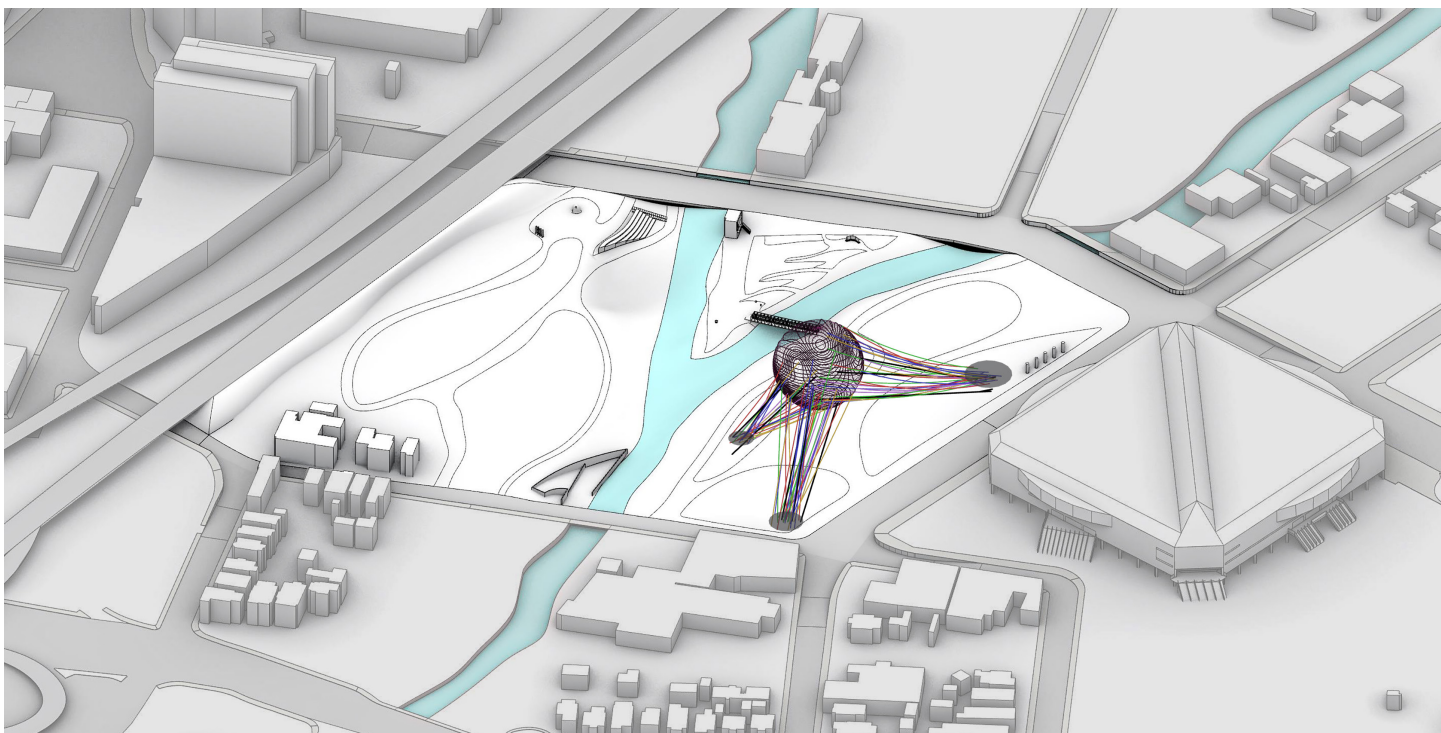

5- Structure hidden between the strings and sphere fabric deformed by visitors .

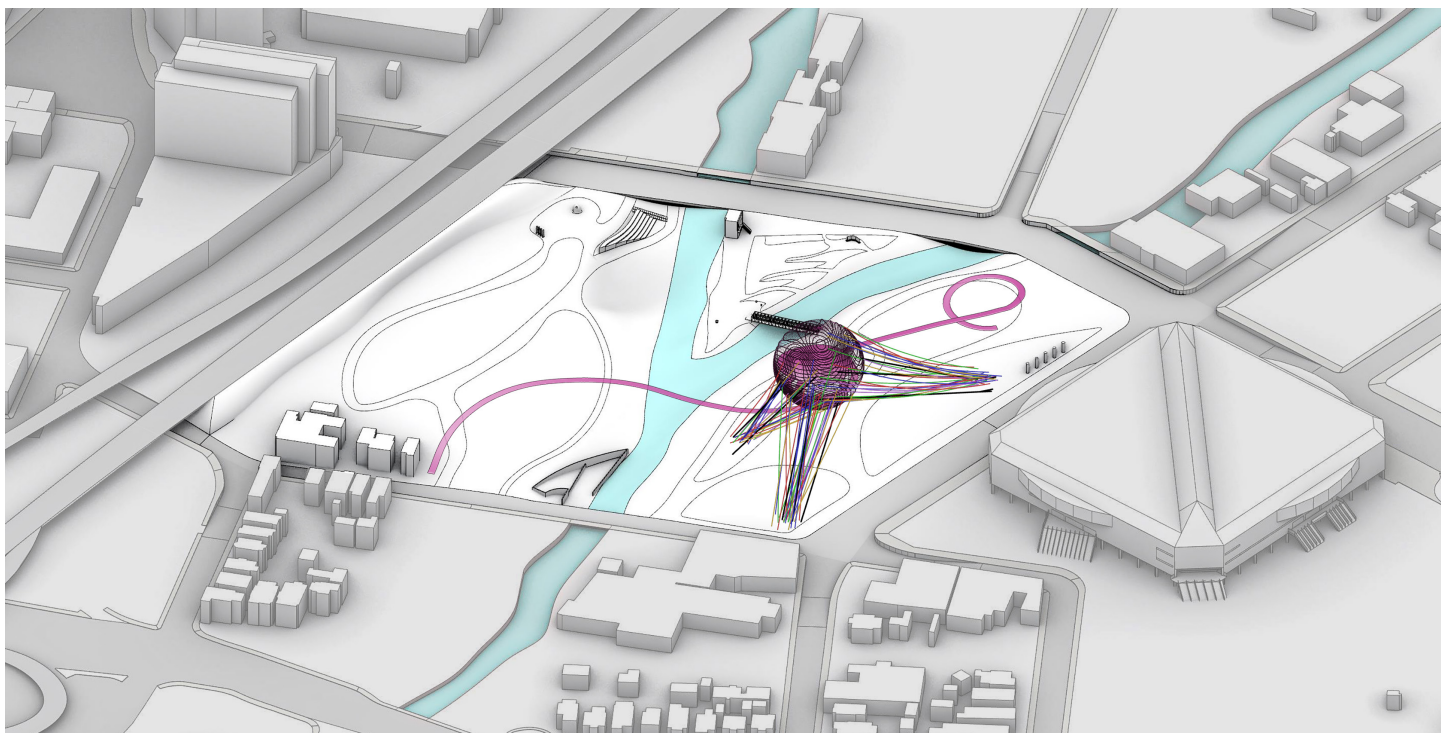

6-Adding the circulation ramps.

## Site Map

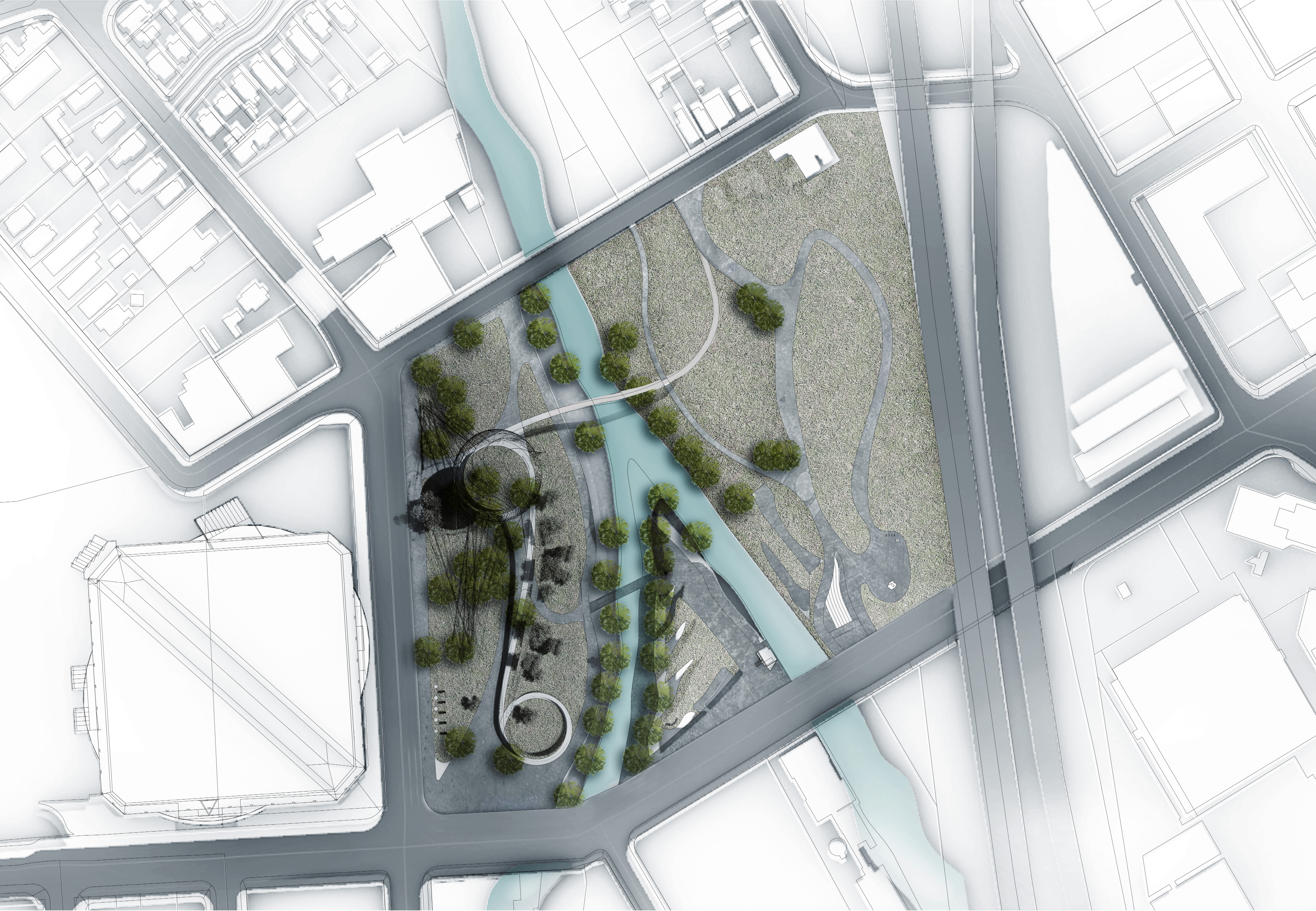

## Section

