

TOTEM TOWER

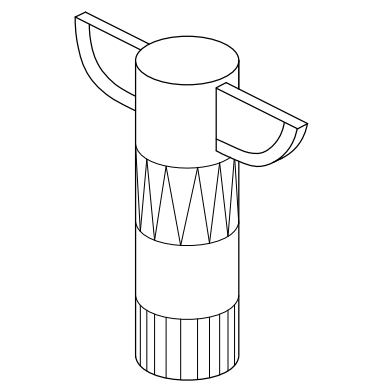

totem - identitarian landmark

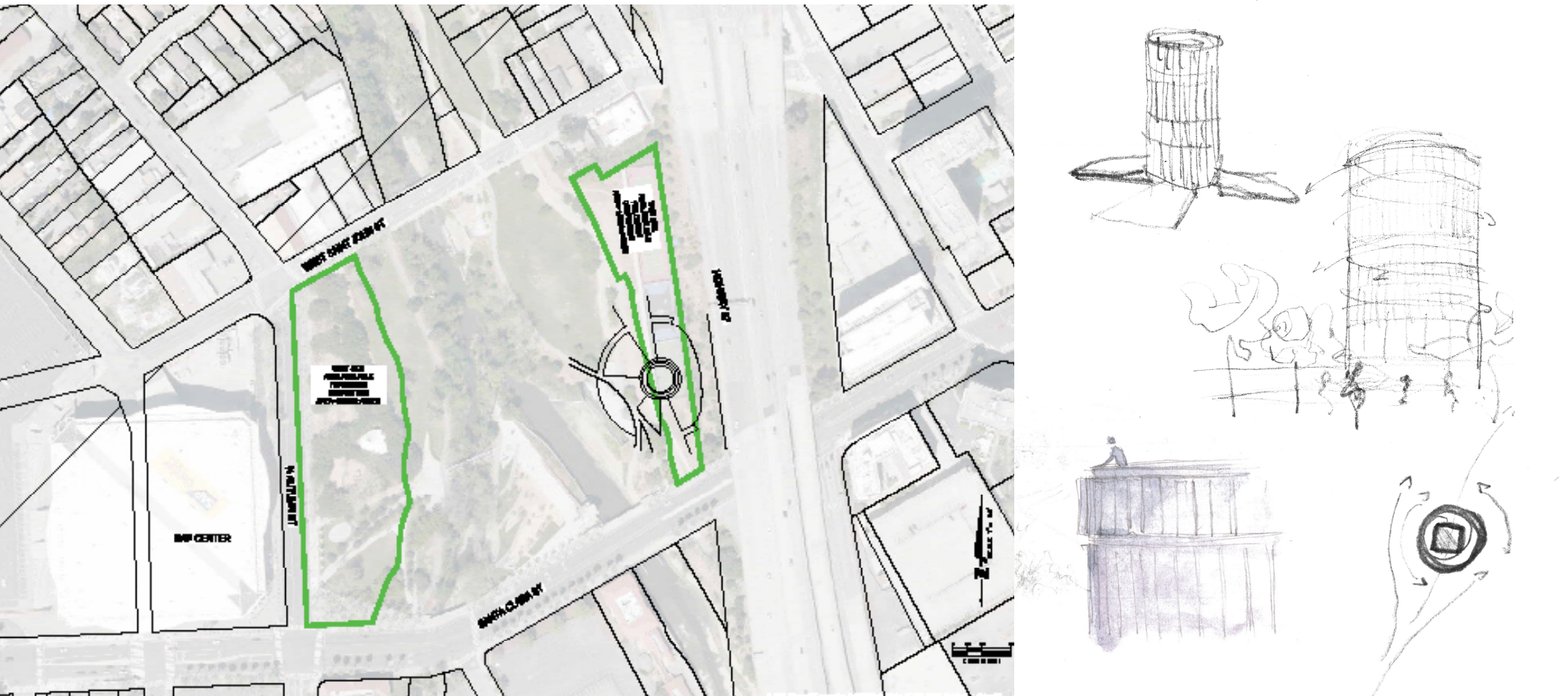
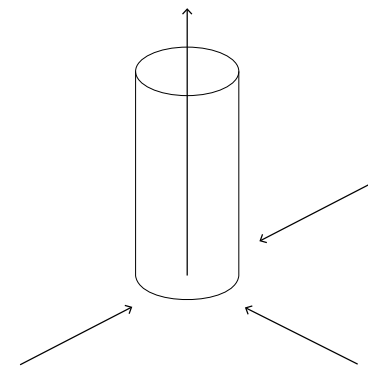

high point - observatory

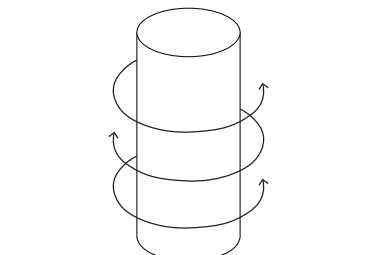

kinetic architecture - dynamism

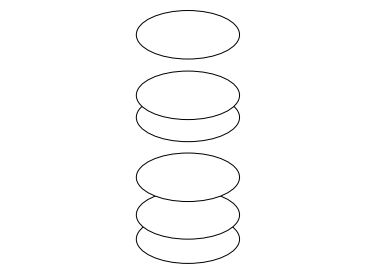

stratification of layers - time/history tower

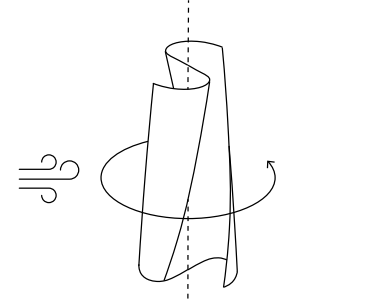

vertical wind turbine - sustainability

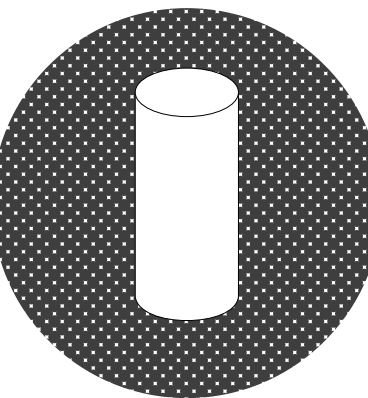

lantern - light tower landmark

Landmark as memory / The stratification of time has been brought to a physical scale, bringing key dates for San Jose and the Silicon Valley in the space.

Landmark as mentor / Movement is what makes us live, it's the engine of progress. The tower acts like a wind turbine highlighting the topics of sustainability and dynamism.

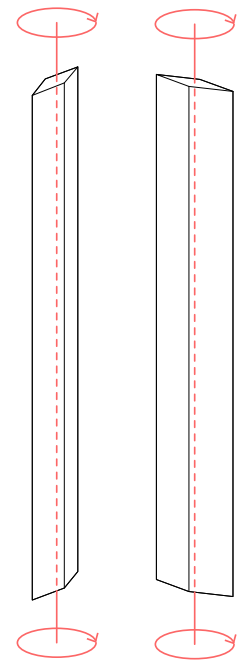

wind turbine's blades

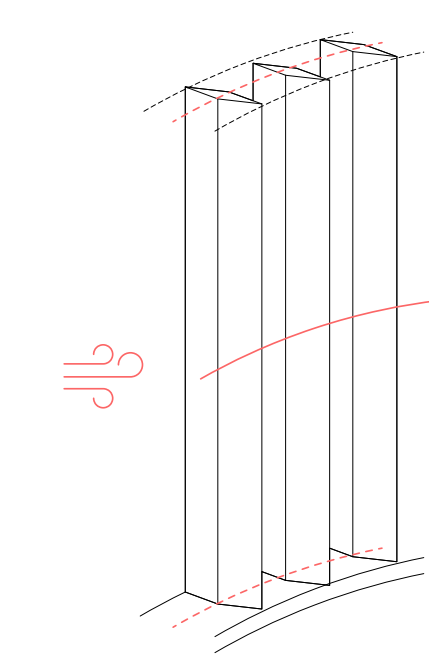

wind turbine's tracks

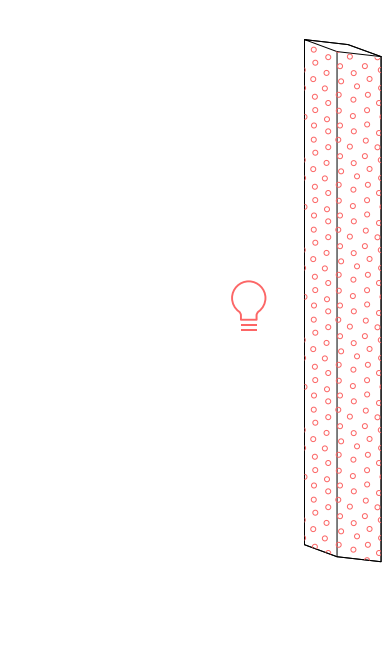

structure



helix ramp and terrace

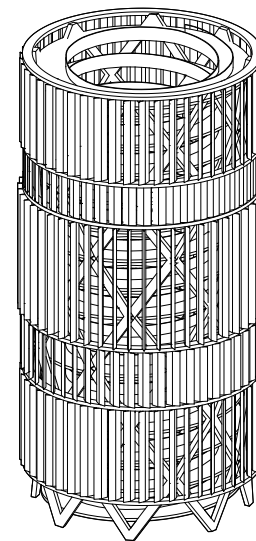

160 ft	2020 - Urban Confluence
128 ft	1972 - 'Silicon Valley' invented
114 ft	1949 - San Jose airport
69 ft	1881 - Electric Light Tower
48 ft	1849 - capitol of California
±0 ft	1777 - San Jose founded

height year - event



TOTEM TOWER

+160 ft
terrace



panoramic terrace

+100 ft
standard
level

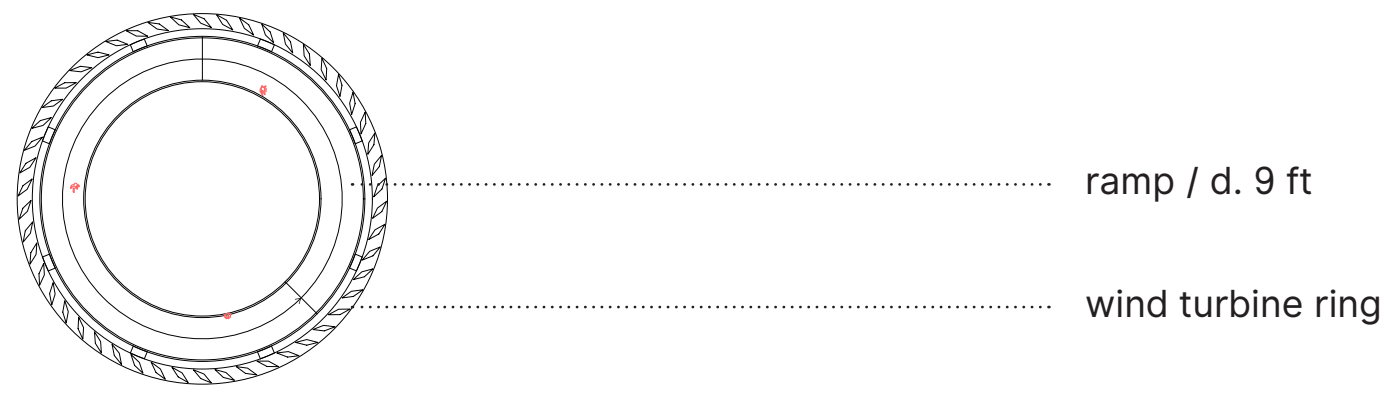

ramp / d. 9 ft

wind turbine ring

±0 ft
tower base



outside d. 82 ft
inside d. 68 ft

±0 ft
ground
work

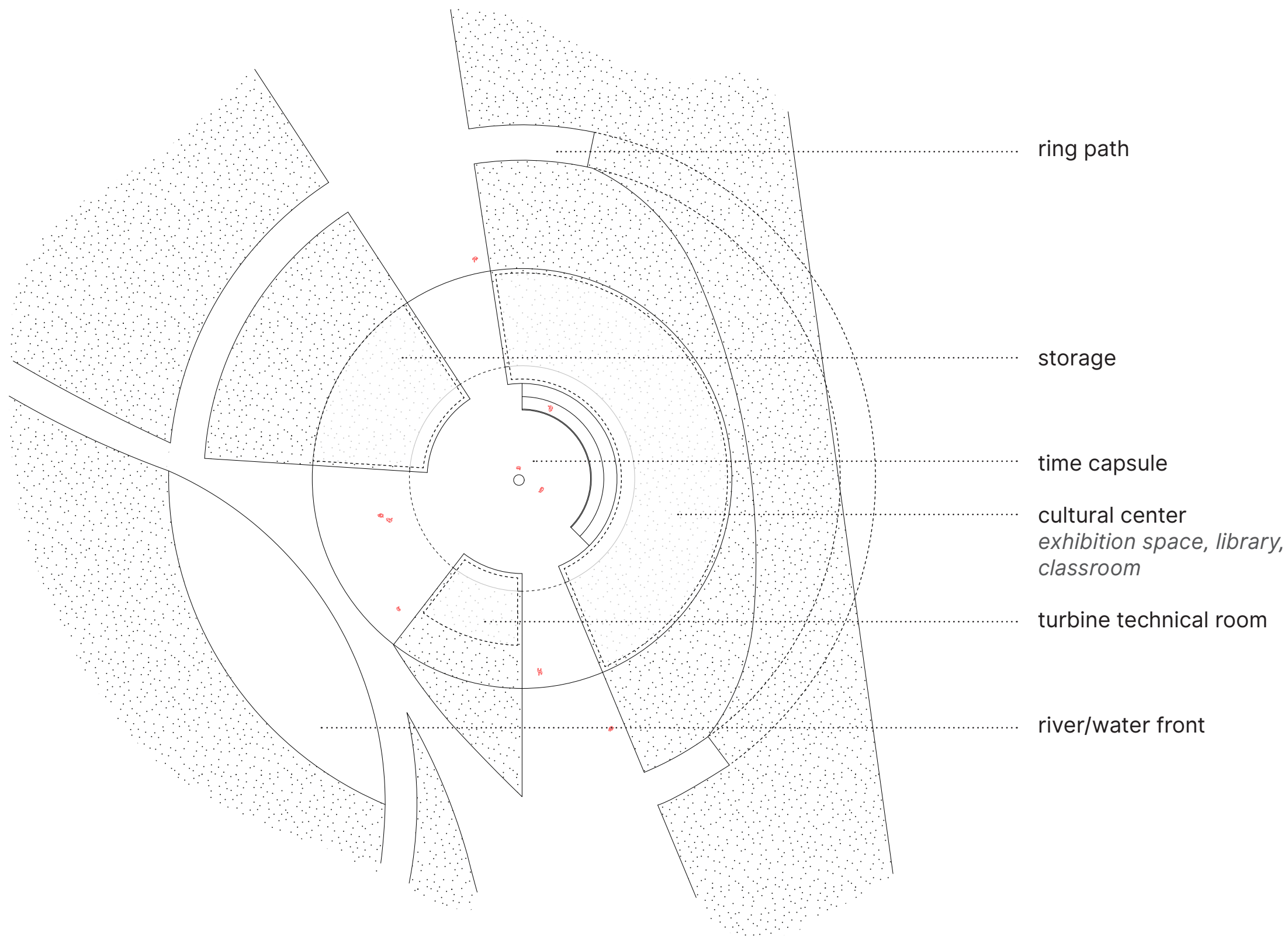

ring path

storage

time capsule

cultural center
exhibition space, library,
classroom

turbine technical room

river/water front

Landmark as facility / From the underground spaces to the panoramic terrace, the tower wants to provide gathering spaces for everybody.

Landmark as a visual presence / The totem will be a large light-performance canvas, allowing complex light combinations to be visible from afar.

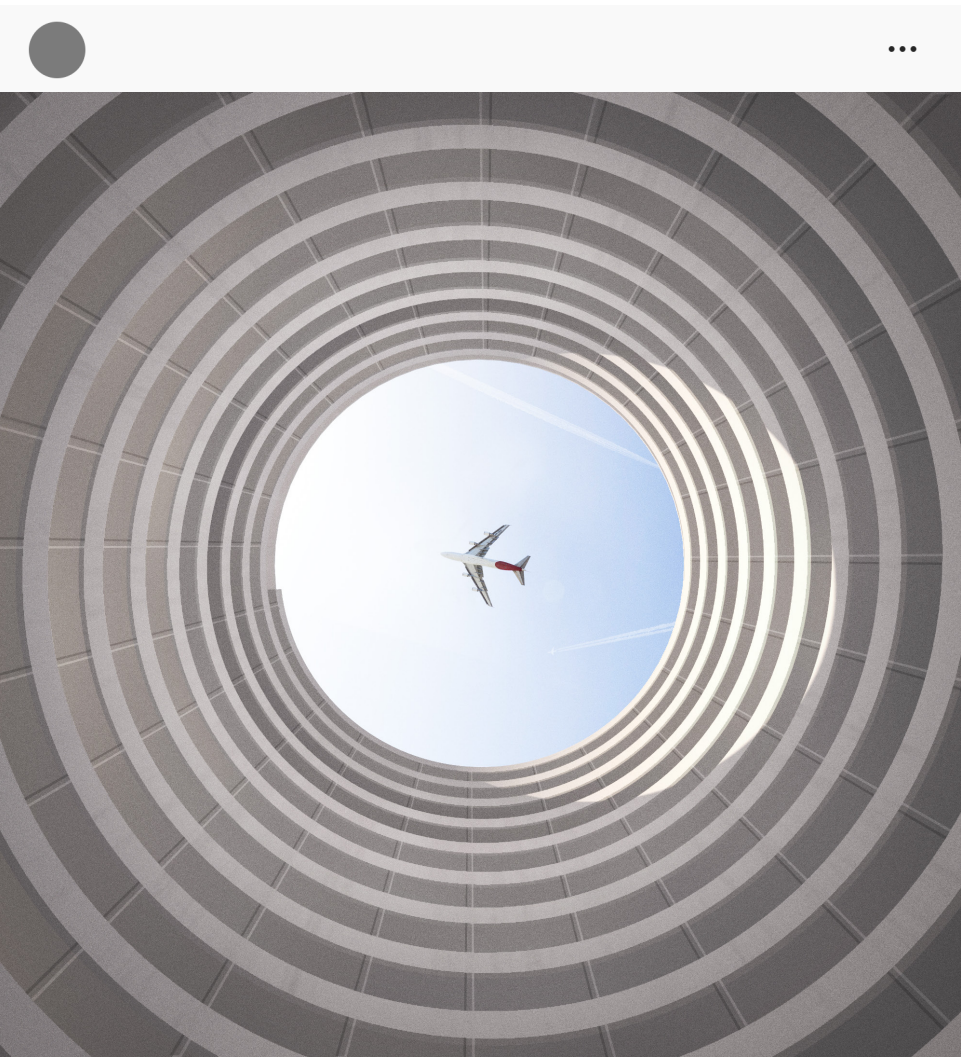

853 likes
"If I have seen further it is by standing on the shoulders of Giants" I.N.



257 likes
Look what we saw while driving on the Guadalupe Fwy!!

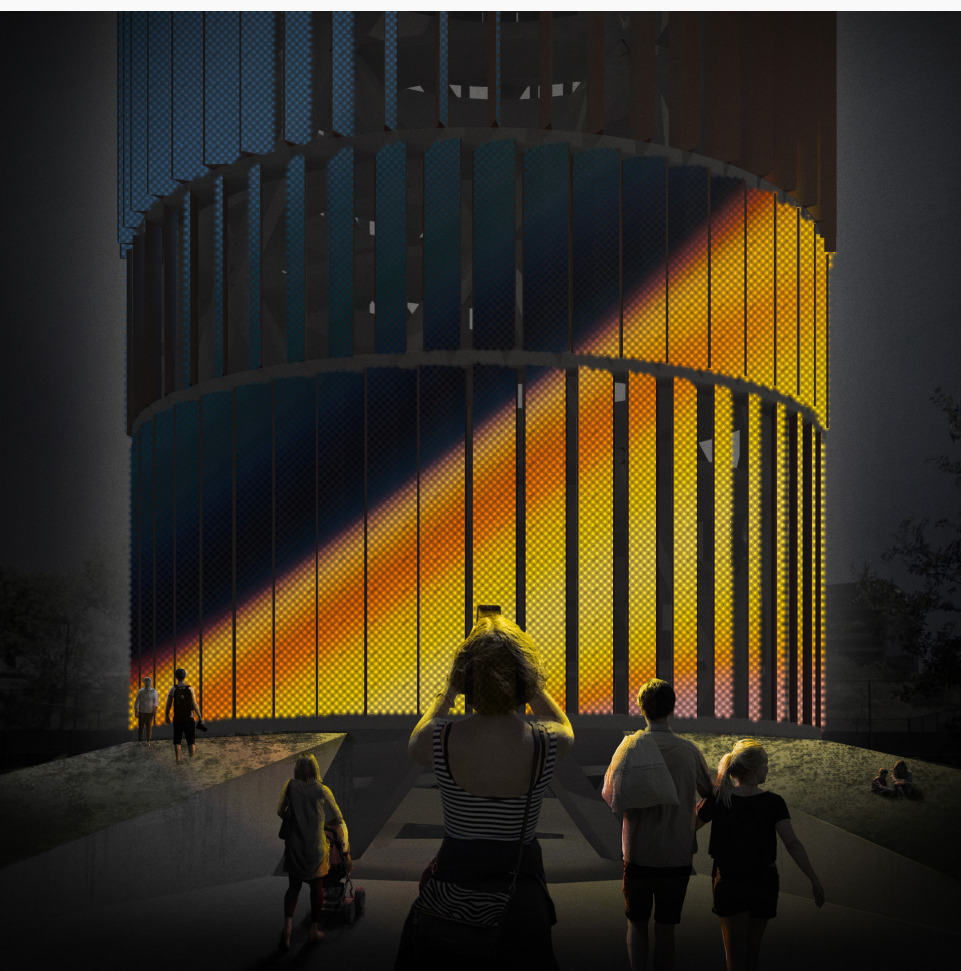

473 likes
#amazing light performance tonight at Arena Green!



outside view
from Guadalupe River Trail towards the project



interior view
from the ramp towards the center