

Convergence and Catalysis

Urban Confluence at Arena Green

Respect and acknowledge the history of San Jose and prepare for the future. Understanding of the past and present is the foundation for the future to build on.

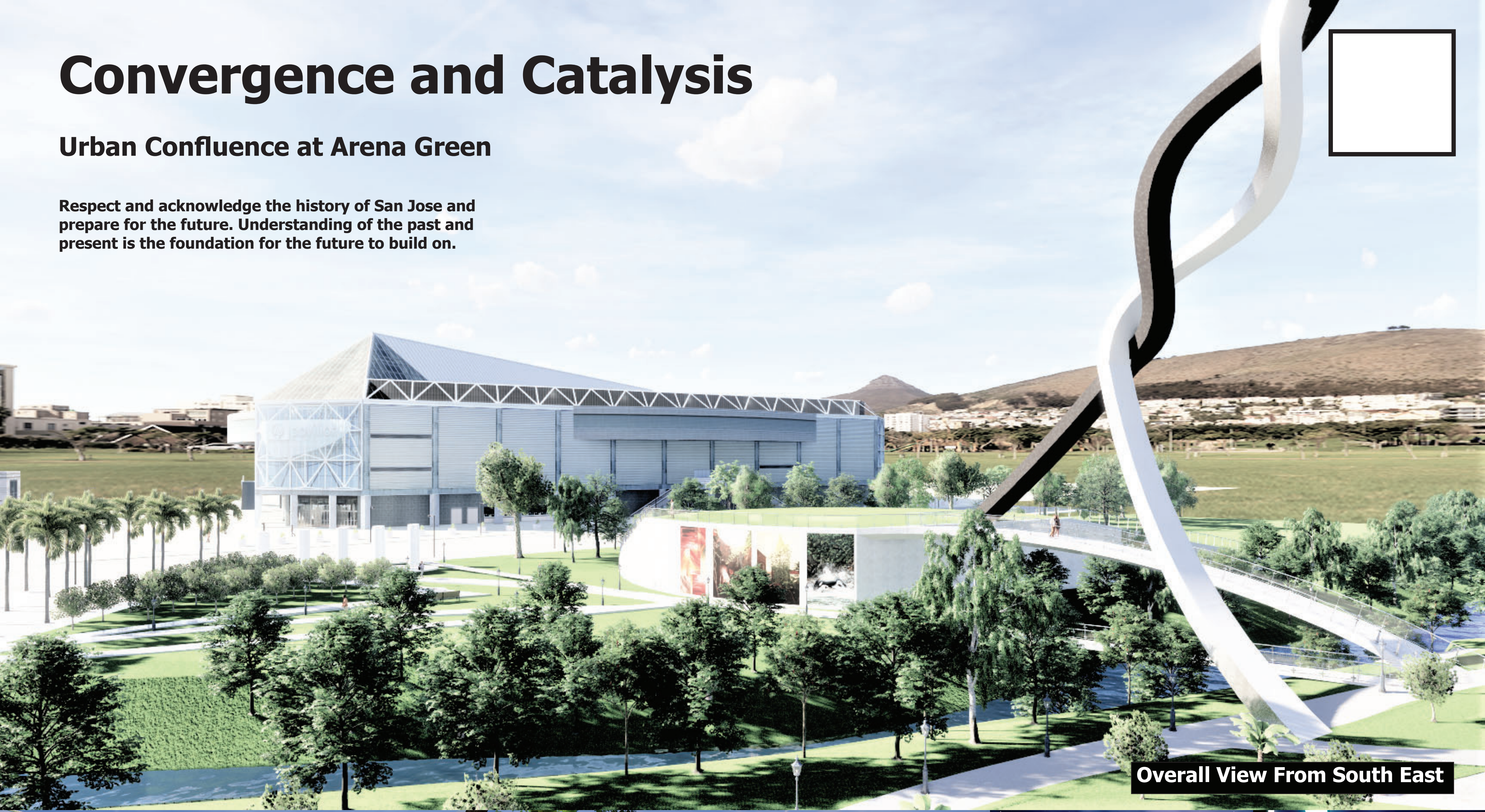

Overall View From South East



The Wall
The south face of the Lookout is for Public Art installation(s). Examples include carved concrete wall and/or applied sculptural elements and/or murals. The Wall contributes to a new Art Walk that includes the Five Skaters, the Lookout Wall, and across the bridge to the Public Art installations and memorials on Confluence Point.



The Lookout
A 20' high hill has been added to the site to accommodate additional people during special events. The Lookout adds an interactive element to the Tower and enables a different view of Confluence Point. The Lookout also provides a separation between the riparian and public areas when the use of the site intensifies. The hill slopes gently down to the north.



The Bridges
The Bridges represent old and new. The 'Old' bridge at the level crossing uses the existing bridge supports and replaces the existing bridge. The Old Bridge connects the Art Walk. The New bridge provides an accessible access to the top of The Lookout while climbing up above the confluence of the Los Gatos Creek and the Guadalupe River and under the New Tower.

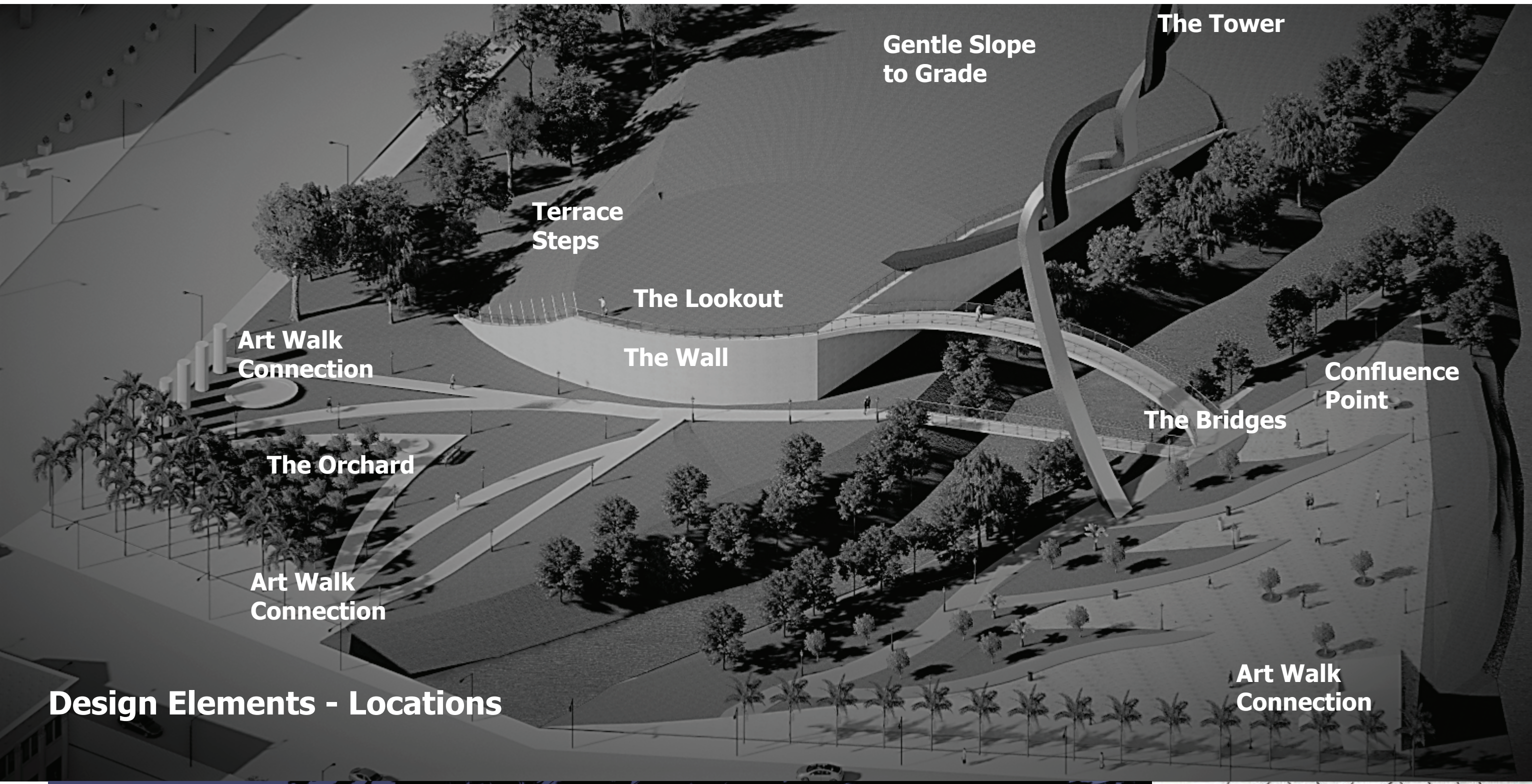

Design Elements - Locations



View From Lookout Toward The Orchard and The Five Skaters



Lighting on the west Terrace Steps on the side of the new Lookout Hill enables safer use at night and provides more ambient lighting that does not affect the wildlife areas.

View from North of Tower and Terrace Steps at Night

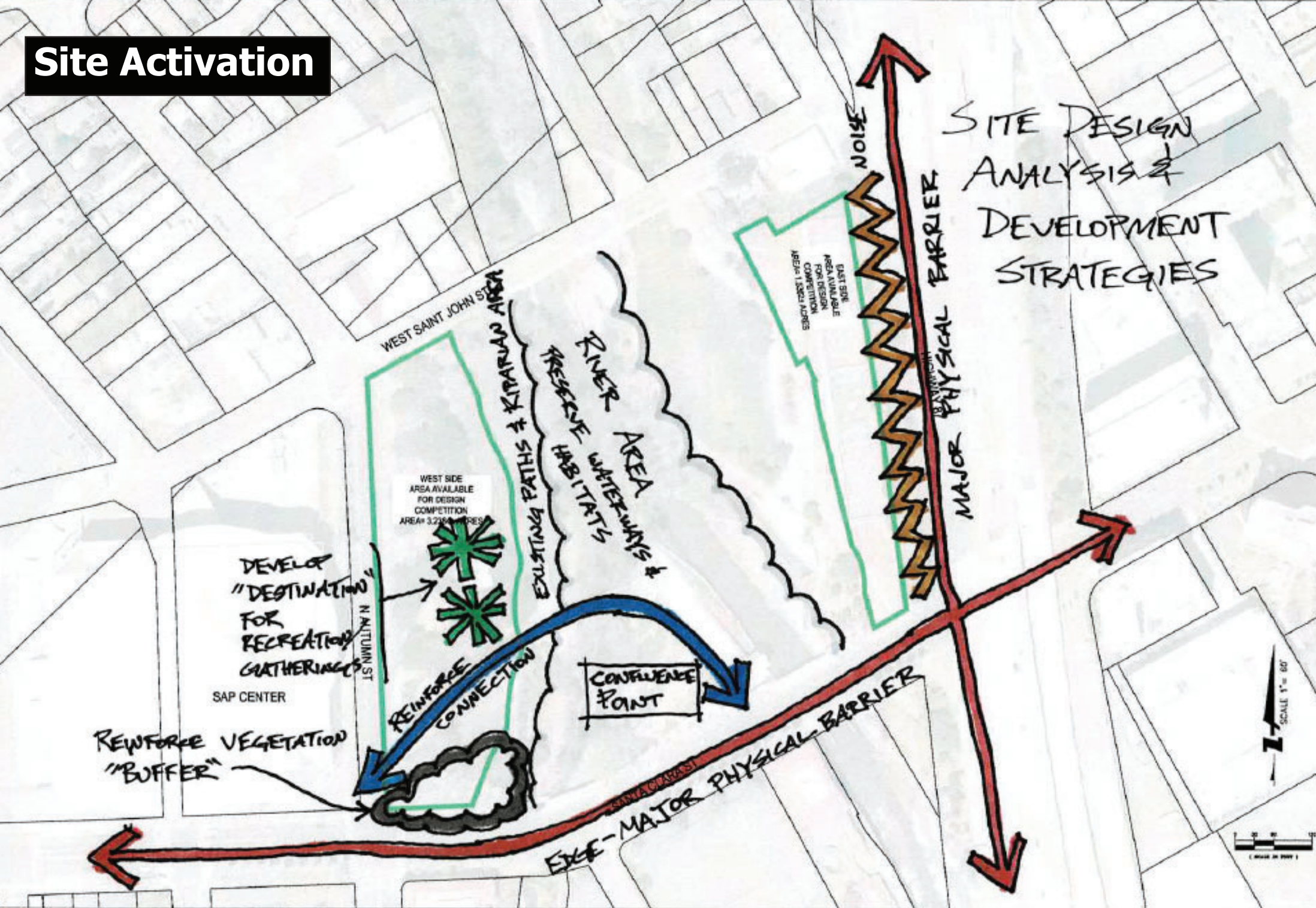

Site Activation



View From East

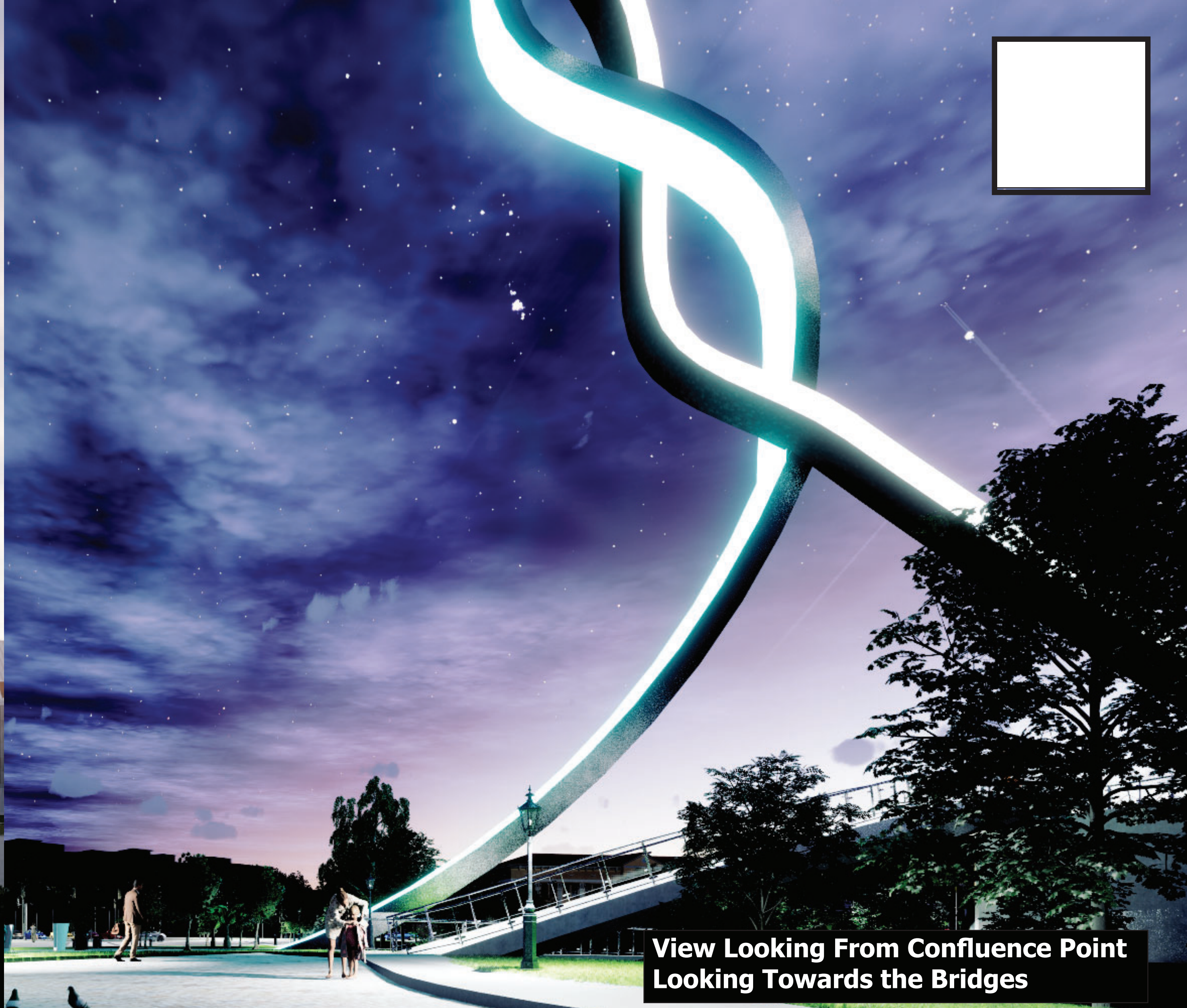

View Looking From Confluence Point Looking Towards the Bridges

Concept Development: Two separate ribbons combining to create something new. Old and New. Low Tech and High Tech. History and Future. Symbolically represented in materials, with Iron representing the Old/Low Tech and Brushed Stainless Steel representing the New/High Tech. The Iron Ribbon is the main structure, anchored on the west side of the watercourse. The Stainless Steel Ribbon only “touches” Confluence Point and metaphorically builds on the past, as the Iron Ribbon provides the structural support for the Tower.

The Icon - Confluence Tower

The form of the Tower is inspired by the confluence of the Los Gatos Creek and the Guadalupe River at the site. The physical angle that the rivers meet is reflected in the two “ribbons” of the tower. Where the ribbons meet symbolizes Confluence Point. The subsequent intertwining of the ribbons represents the combining currents of the water. The Tower materials also reflect the convergence of the past and the present. One of the ribbons is made from iron to honor the construction of the previous major icon – the San Jose Electric Light Tower. The other ribbon is made from brushed stainless steel to reflect more sleek and modern construction methods.

The lighting on the ribbons can be changed based on special events. The type, colour, and location of the lighting creates a visible icon for the skyline while respecting the requirements for dark skies and aircraft navigation. The lighting will also not adversely affect fish, birds, bats, or other wildlife. LED Lighting on the two ribbons of the tower is powered by kinetic charging. As people walk along the bridges, the movement recharges the LED batteries which meets the NET ZERO requirements for the site. Integrated Photovoltaics in the railing glass will also be used to supplement the kinetic charging and to help prevent birds from colliding with the glass in the railings on site.

The Tower is structurally supported only on the west side of the creek and only lightly rests on Confluence Point, as the Stainless Steel Ribbon is supported by the Iron Ribbon.



Overall View From North East

