

# THE VALLEY OF HEART'S DELIGHT

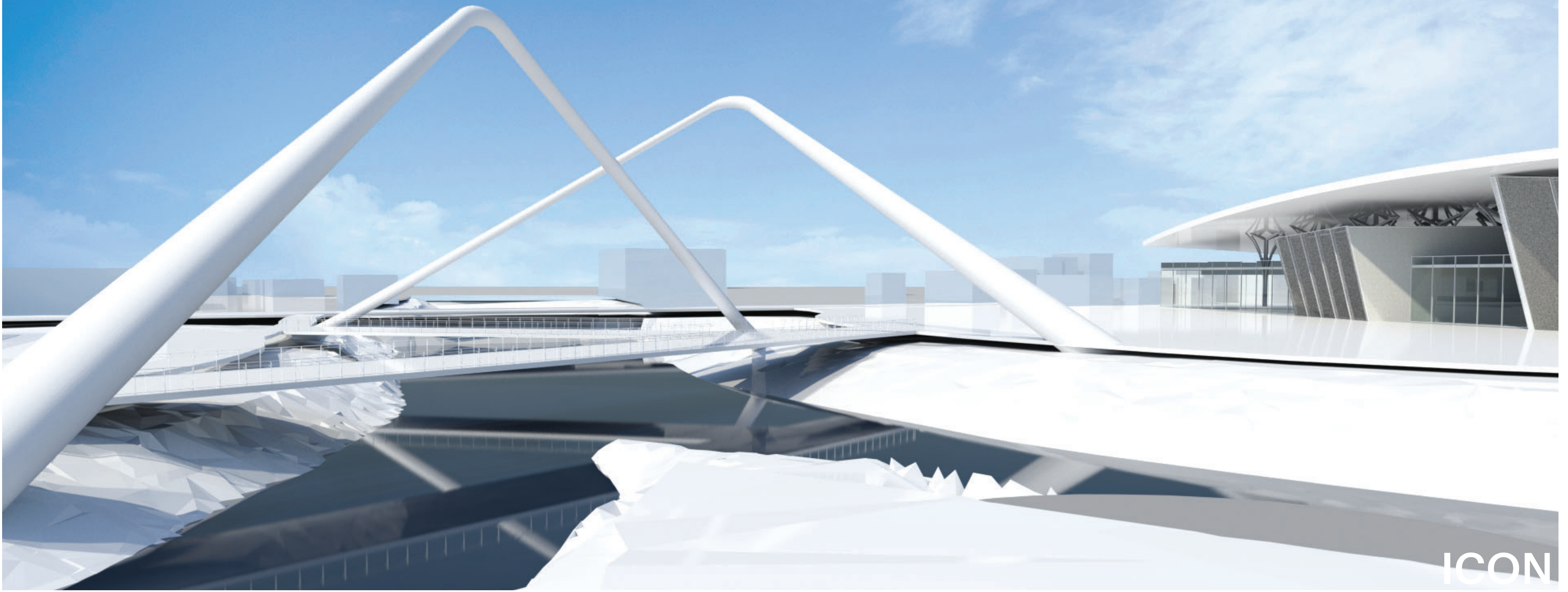

ICON

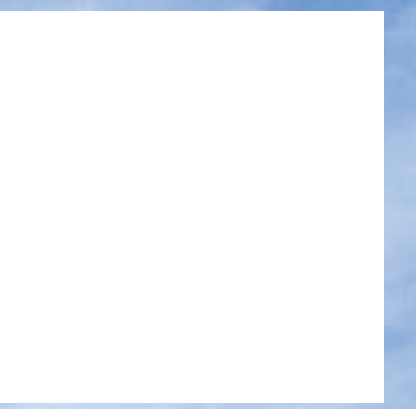
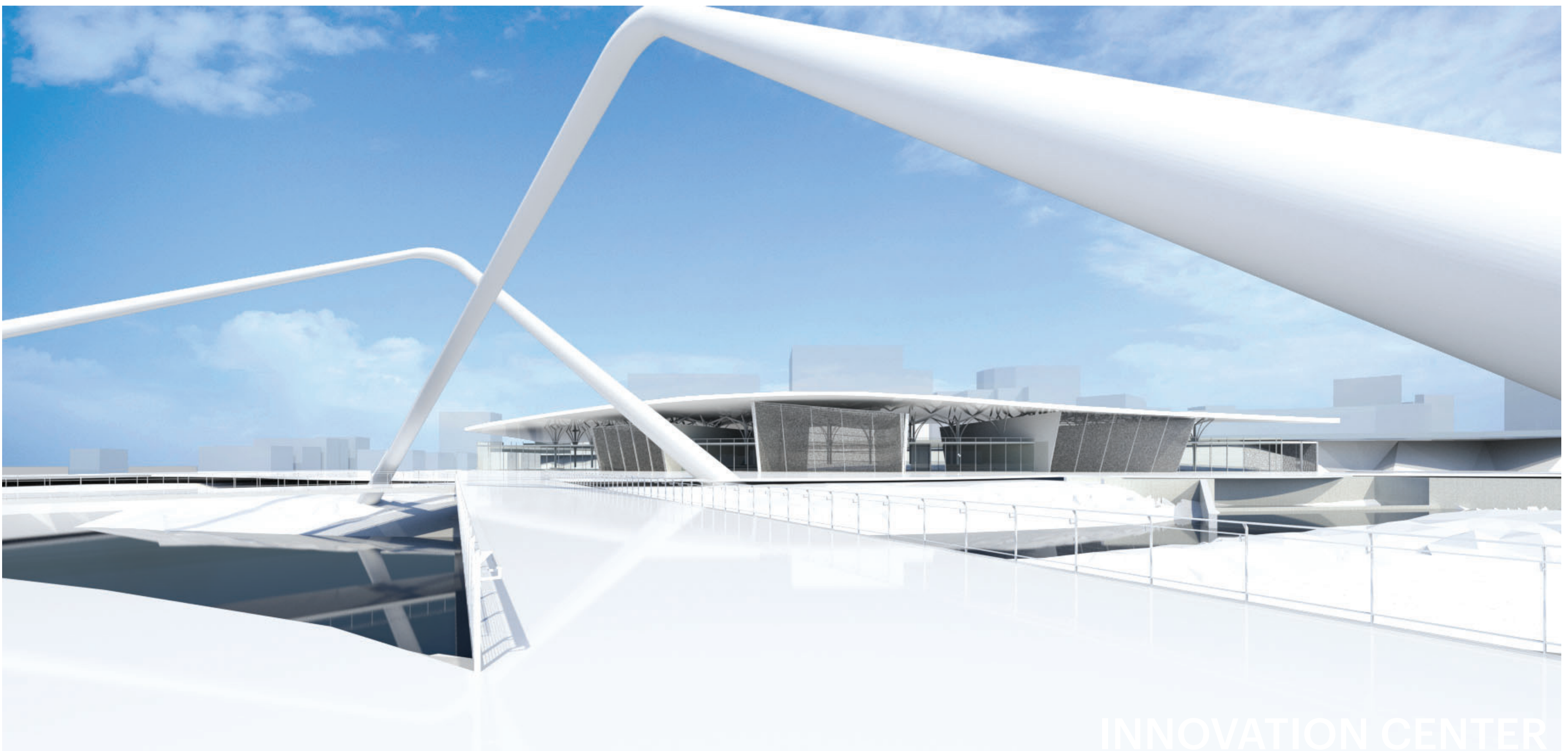
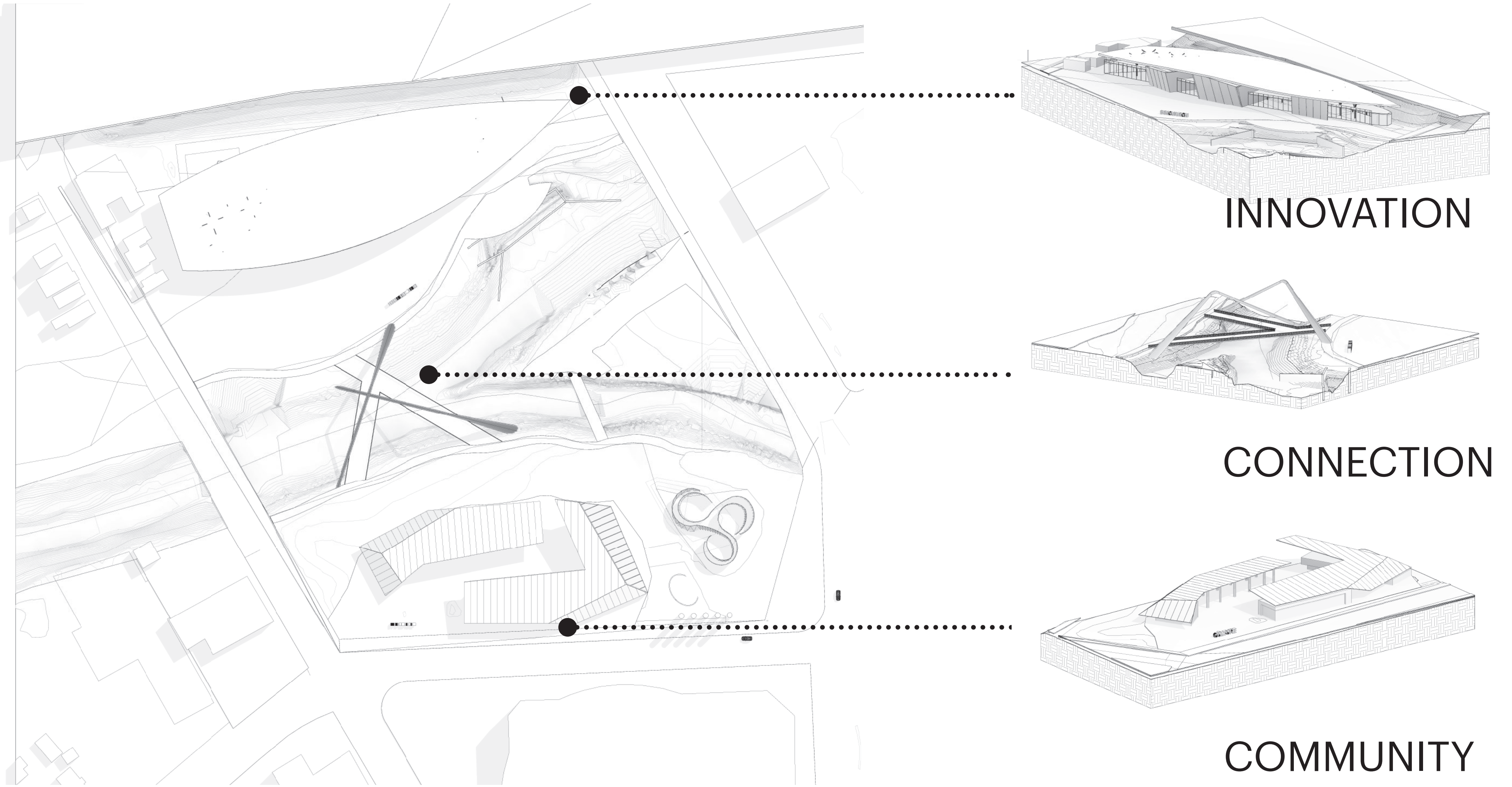

INNOVATION CENTER

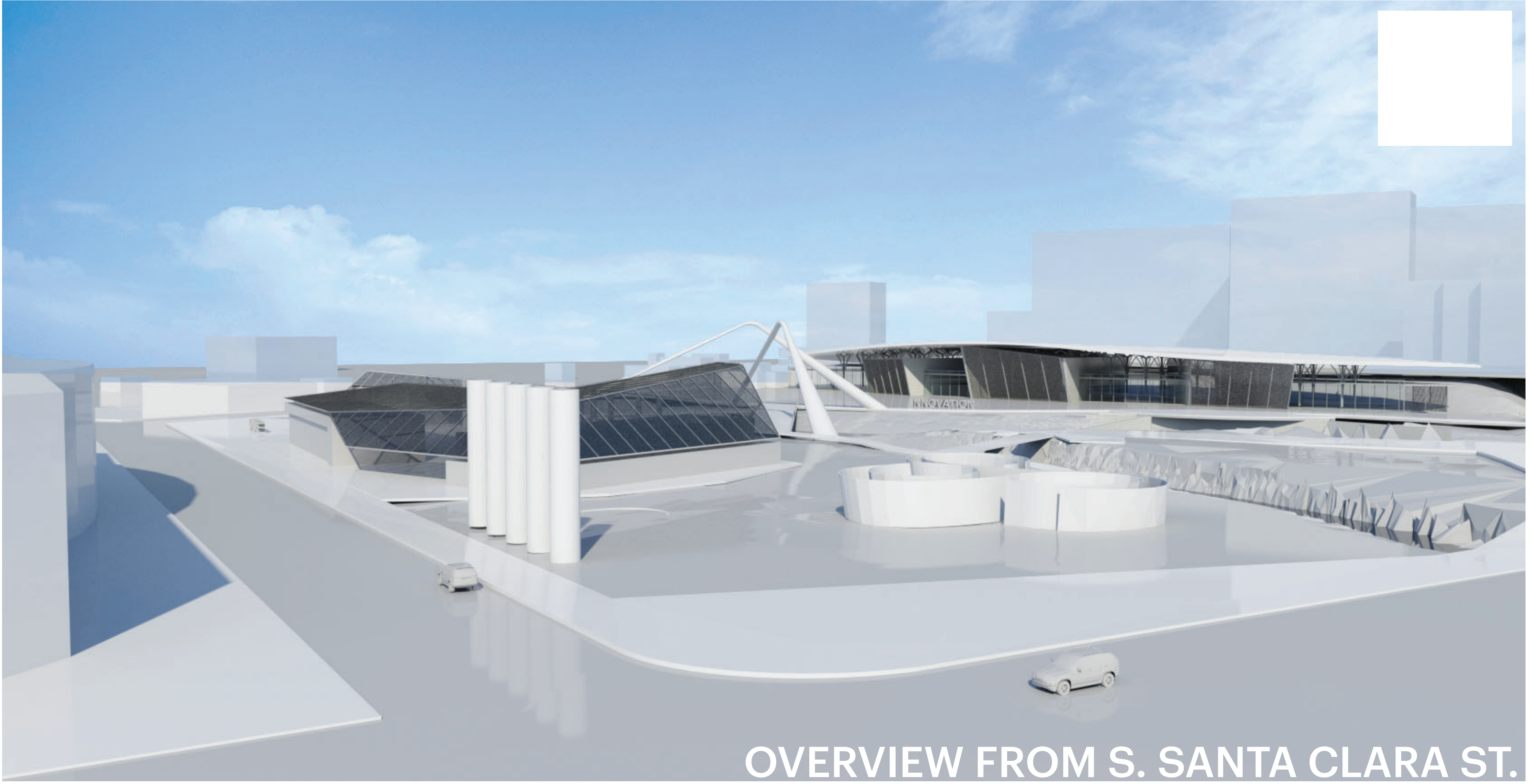

OVERVIEW FROM S. SANTA CLARA ST.

## THE VALLEY'S INSPIRATIONAL SPIRIT

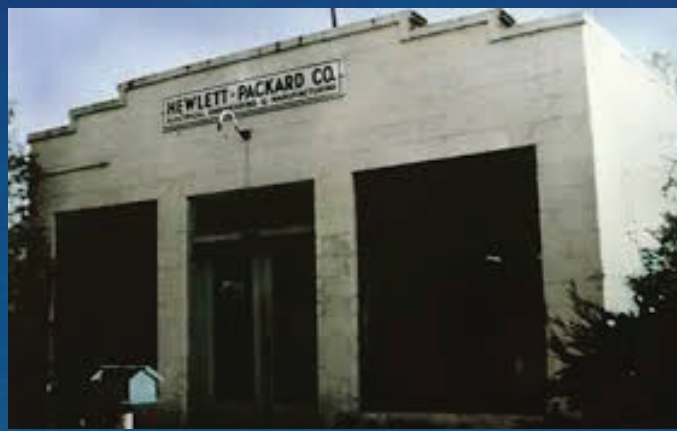
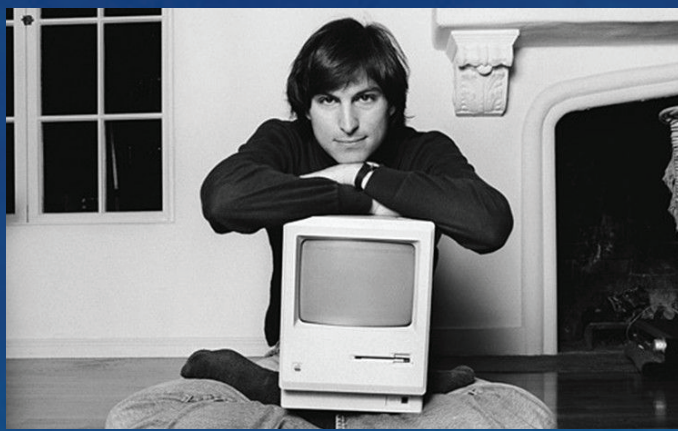
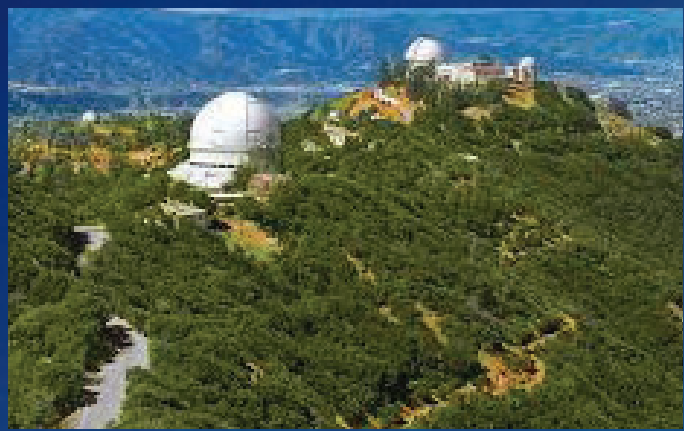

### INNOVATION

THE VALLEY'S BOUNTY WAS FAMOUS NATIONWIDE, EARNING IT THE NICKNAME, "THE VALLEY OF HEART'S DELIGHT." AS THE CAPITAL OF SILICON VALLEY, SAN JOSE HAS ATTRACTED A SPECIAL TYPE OF ENTREPRENEURIAL SPIRIT.

THE VALLEY'S PHYSICAL IDENTITY HAS NOT YET BEEN PRONOUNCED BY A FLASHY ARCHITECTURE, BUT ITS CREATIVE AND DIVERSE WORKFORCE OF INNOVATORS ARE NOT AFRAID TO INDULGE THE WORLD.

THE URBAN AND SUBURBAN COLLECTIVE IN THE VALLEY NEED A NEW PLAYGROUND FOR THE CURIOSITY AND THE EVER-BINDING CULTURE OF THE MIXING OF CULTURES IN THE VALLEY. THE URBAN INTERFACE IS A COMBINATION OF WHAT SAN JOSE IS, AND WHAT IT SHOULD REPRESENT TO THE WORLD. IN THE VALLEY IS A PLACE WHERE EVERYTHING IS PURPOSEFUL, INNOVATIVE AND DISRUPTIVE TO THE REST OF THE WORLD. THE DESIGN PROGRAM UNFOLDS WITH A SPREAD OF IMAGES OF AN INNOVATION CENTER EQUIPPED WITH THE LATEST RESOURCES FOR THE CURIOUS MINDS THAT HAVE OR DO NOT HAVE ACCESS TO THE LATEST TECHNOLOGY AND RESOURCES. THE PROGRAM IS THEN CONNECTED TO AN ICONIC STRUCTURE THAT BECOMES THE IDENTIFIER, SPANNING THROUGH THE GUADALUPE CREEK. THE ICONIC IDENTIFIED CONNECTS THE REGION TO THE CULTURAL CENTER, THUS ILLUSTRATING, REFLECTING, AND CELEBRATING THE CITY'S DIVERSE COMMUNITIES AS IT EMBRACES INTO THE OPEN COURTYARD.

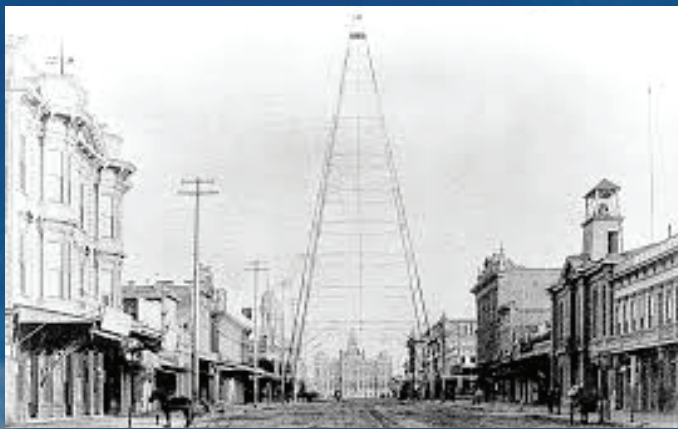

### CONNECTION

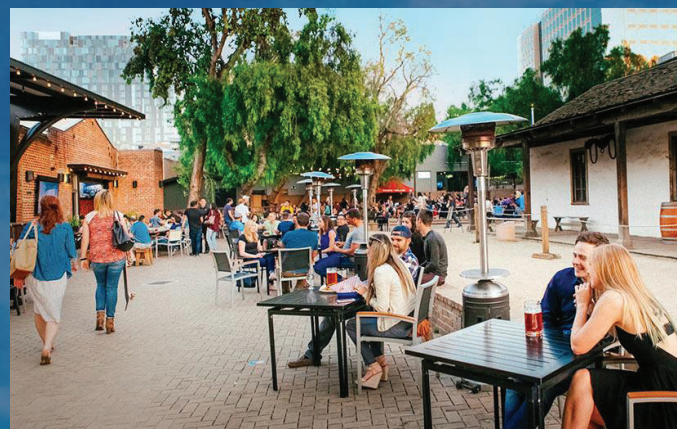

### COMMUNITY

### ARCHITECTURE

THE ARCHITECTURE ENCOMPASSES THE UNIQUE CONDITION OF THE ARENA GREEN GEOGRAPHIC LOCATION AND ITS UNIQUE SITE CONDITIONS. THE GEOMETRY OF THE ARCHITECTURE TAKES INTO CONSIDERATION THE AERIAL NOISE AND VIBRATIONS MITIGATION METHODS. THE ARCHITECTURE'S POSITIONING TAKES ADVANTAGE OF ITS SOLAR EXPOSURE, AND IT IS ANGLED TO PROVIDE OPEN SPACES TO NATURALLY CREATE A PASSIVE ARCHITECTURE THAT WORKS IN THE ARENA GREEN LOCATION.

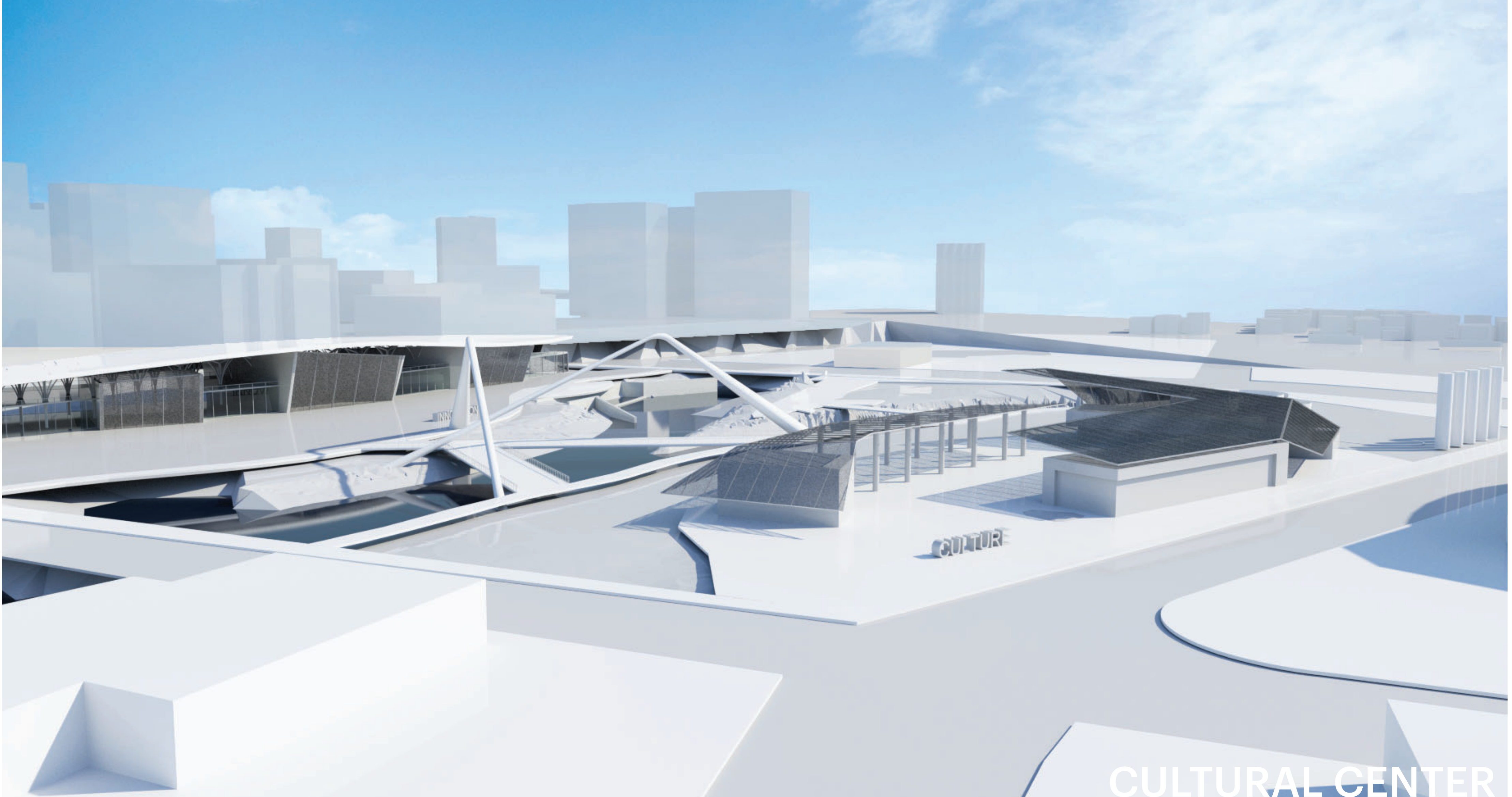

CULTURAL CENTER