

Vicinity Map



Site Plan

Urban Confluence Silicon Valley

Circuits and Platforms: Scaffold for the City

Scaffold, a floating shape – somewhere between ground and sky, between existing site elements and the future forms of a neighborhood in growth and transition. Flow and stasis. Both a place for gathering and resting as well as a moment on a larger river park route. A platform for events and activities planned and yet to be conceived by future citizens. The scaffold becomes a structure for present uses but variable and “open” for future use and evolution of this neighborhood within San Jose – a framework for organic growth over time and by various organizations and communities – an active and participatory icon.

This scaffold can evolve and morph – touching down in places to create access, in others hovering to provide shade and shelter for local vendors and markets, rising up and creating a vertical focus for the park – a vertical ribbon of structure and light visible from the new station district as well as from surrounding highways, buildings and from the air.

Elements of the Scaffold

- Circuits - a structure in which people can run, walk, traverse on, over and under - a connector for the haphazard ground plane and wide variety of uses in the area (or at least those planned) a structure of movement. Also a structure embedded with lighting and technology - conveys information but also can be used as a canvas for performance, display and art.
- Platform - a place for people of the neighborhood to rest, meet, perform, people-watch, play – spaces of intimacy alongside places for public gatherings.

Moments of the Scaffold

- A climbing structure adjacent to the childrens play area. A screen to give a sense of scale and security to this community area.
- Overlooks, hangout spots – related and yet a variant of ground level spaces. Places to hang out in the sun and sky.
- Bridge element becomes place related to treetops and views but also a viewing platform over the river.
- Ribbon tower is both landmark for the area but also accessible via stair and elevator – a vantage point to far away hills, park events and city skyline.

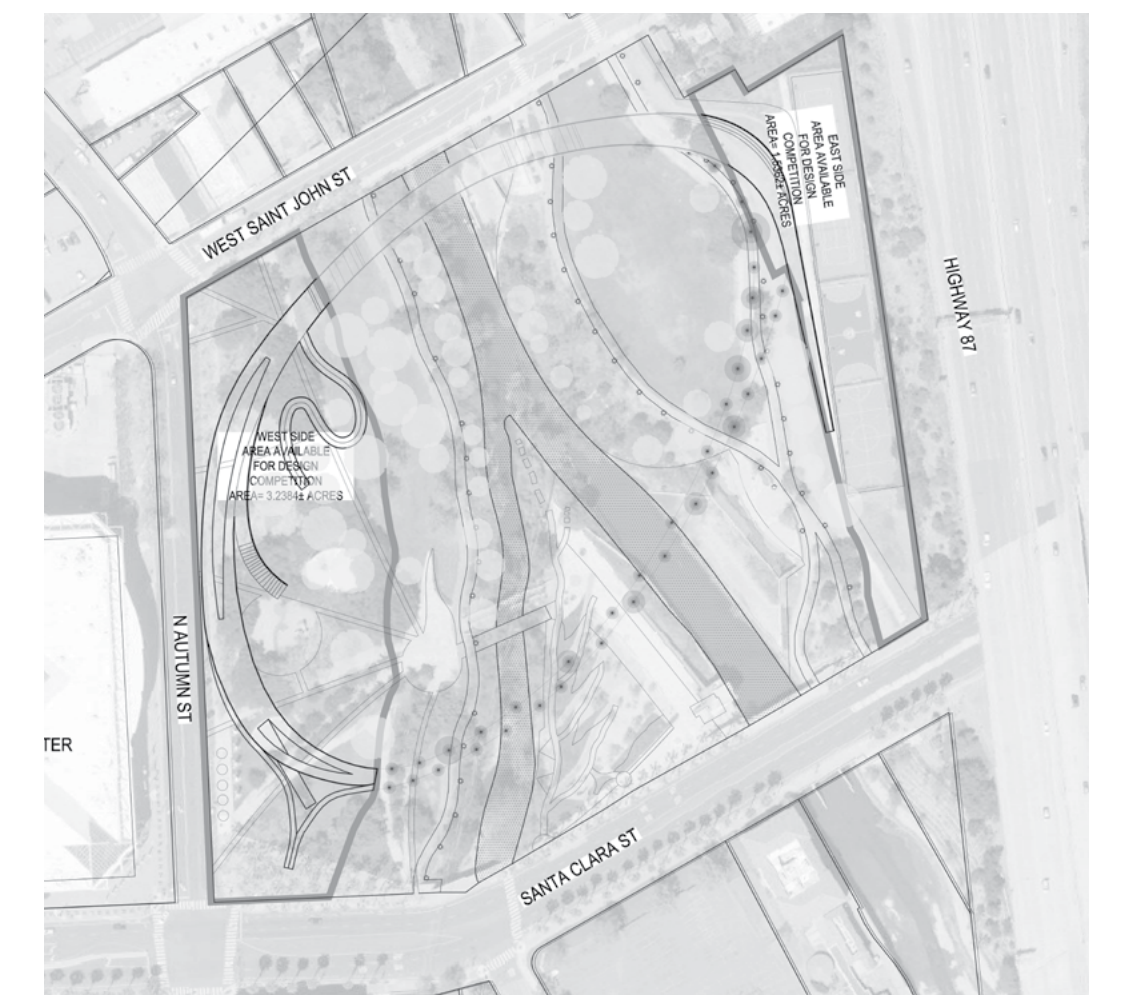

Site Map

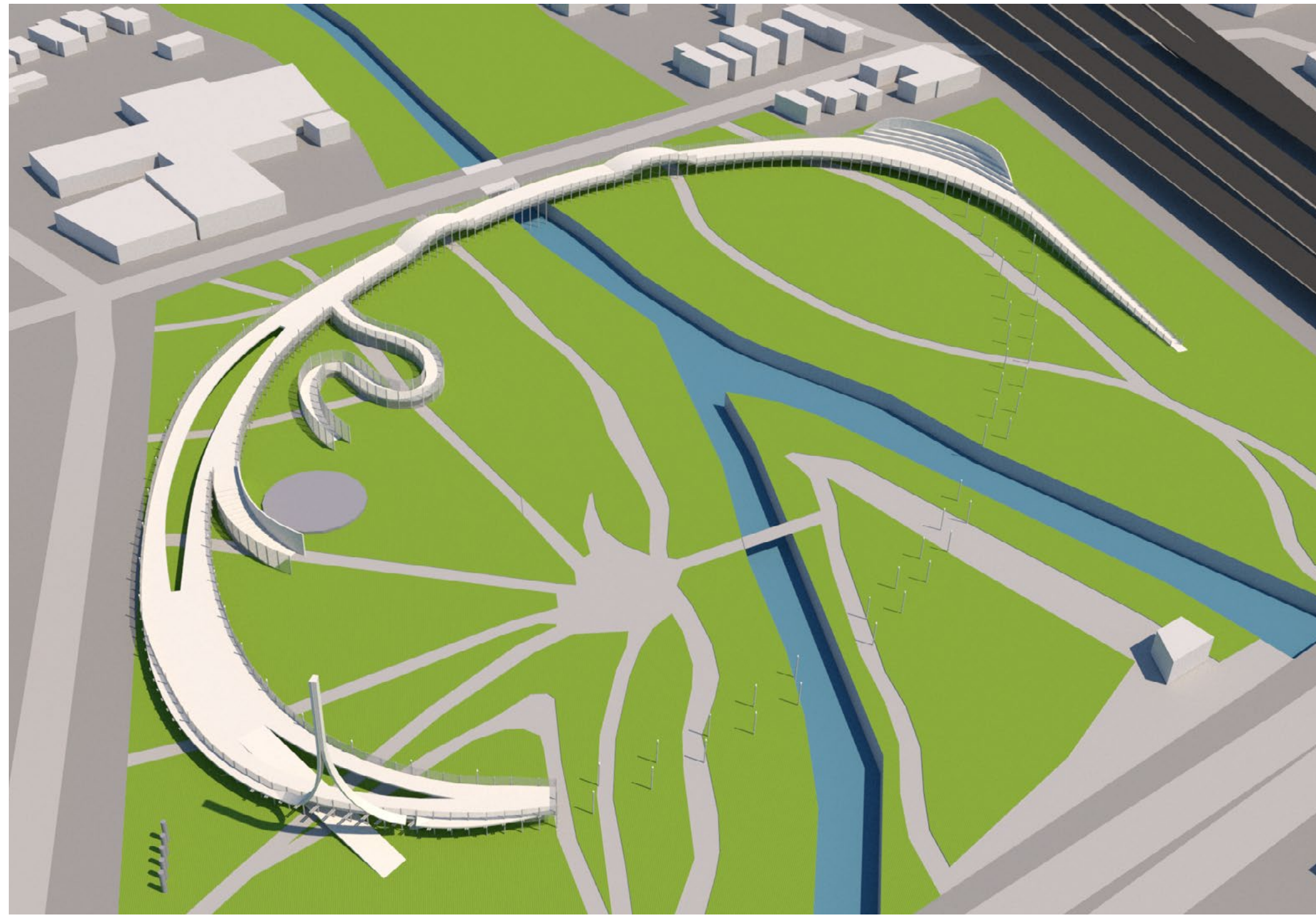

Aerial View

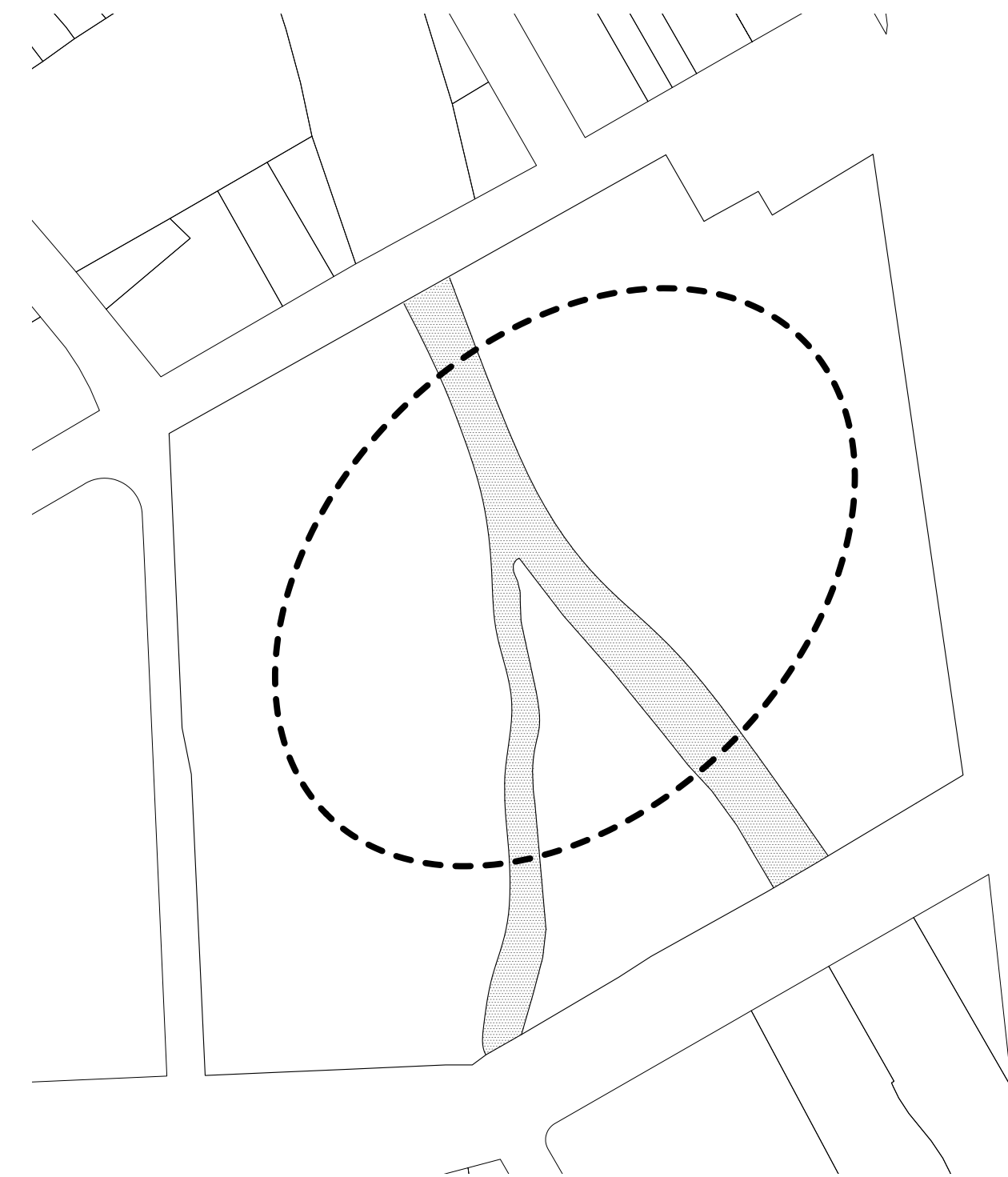

Phase 1_ Main Flow

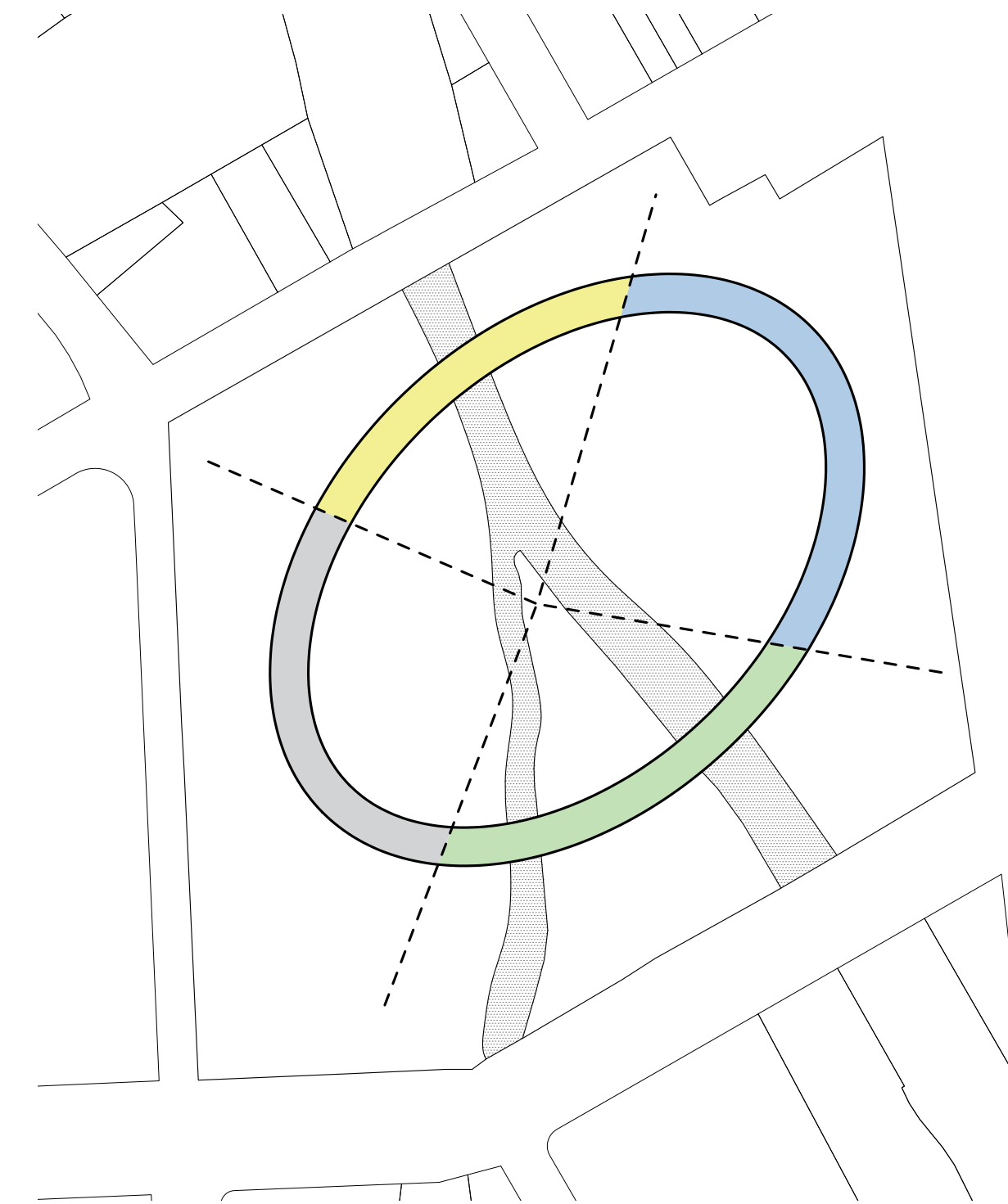

Phase 2_ 4 Programs on the Circuit



Phase 3_ Final Program Allocation

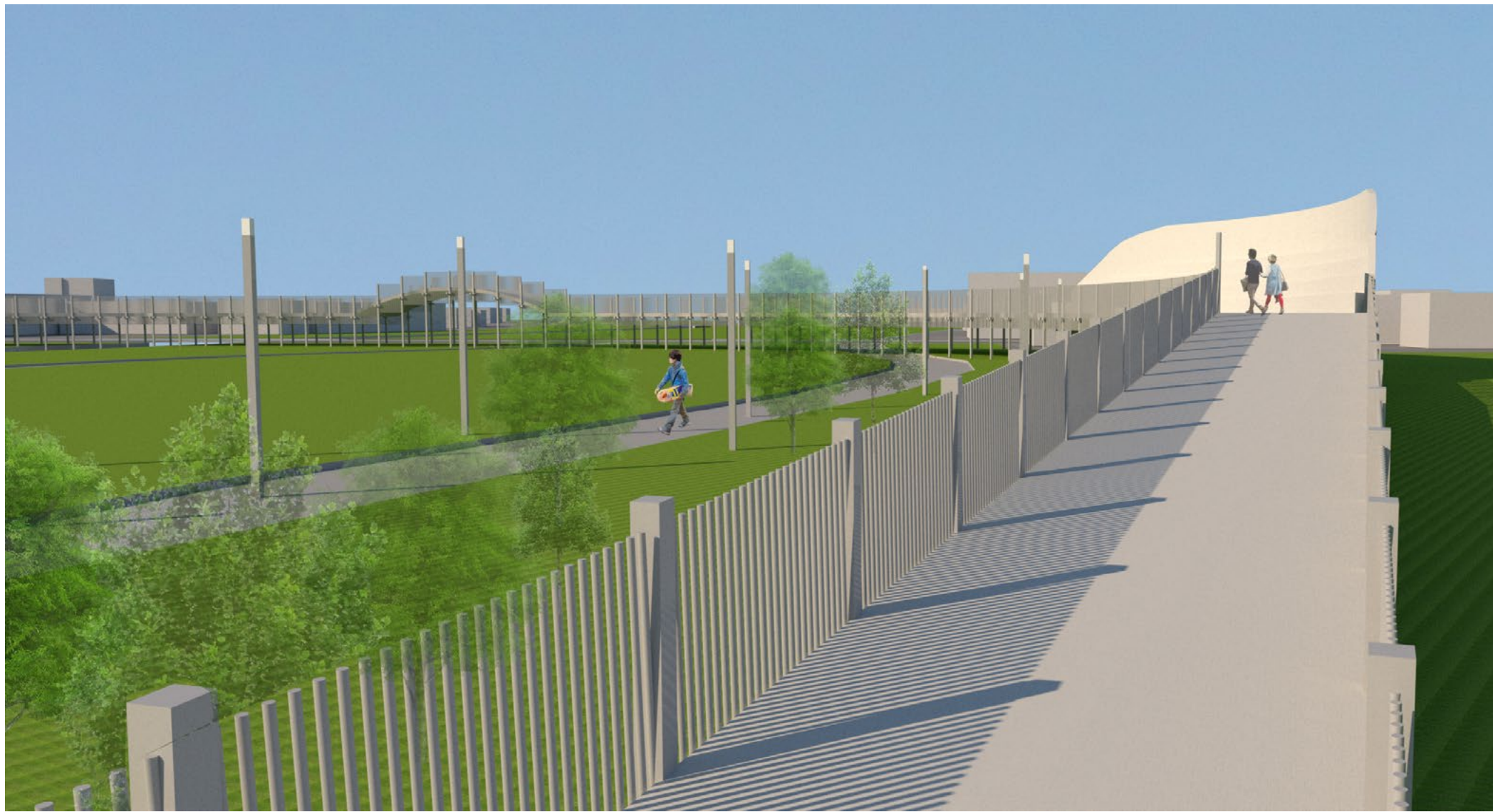

Sun Seat



Carosel & Community Play



Bridge Overlook

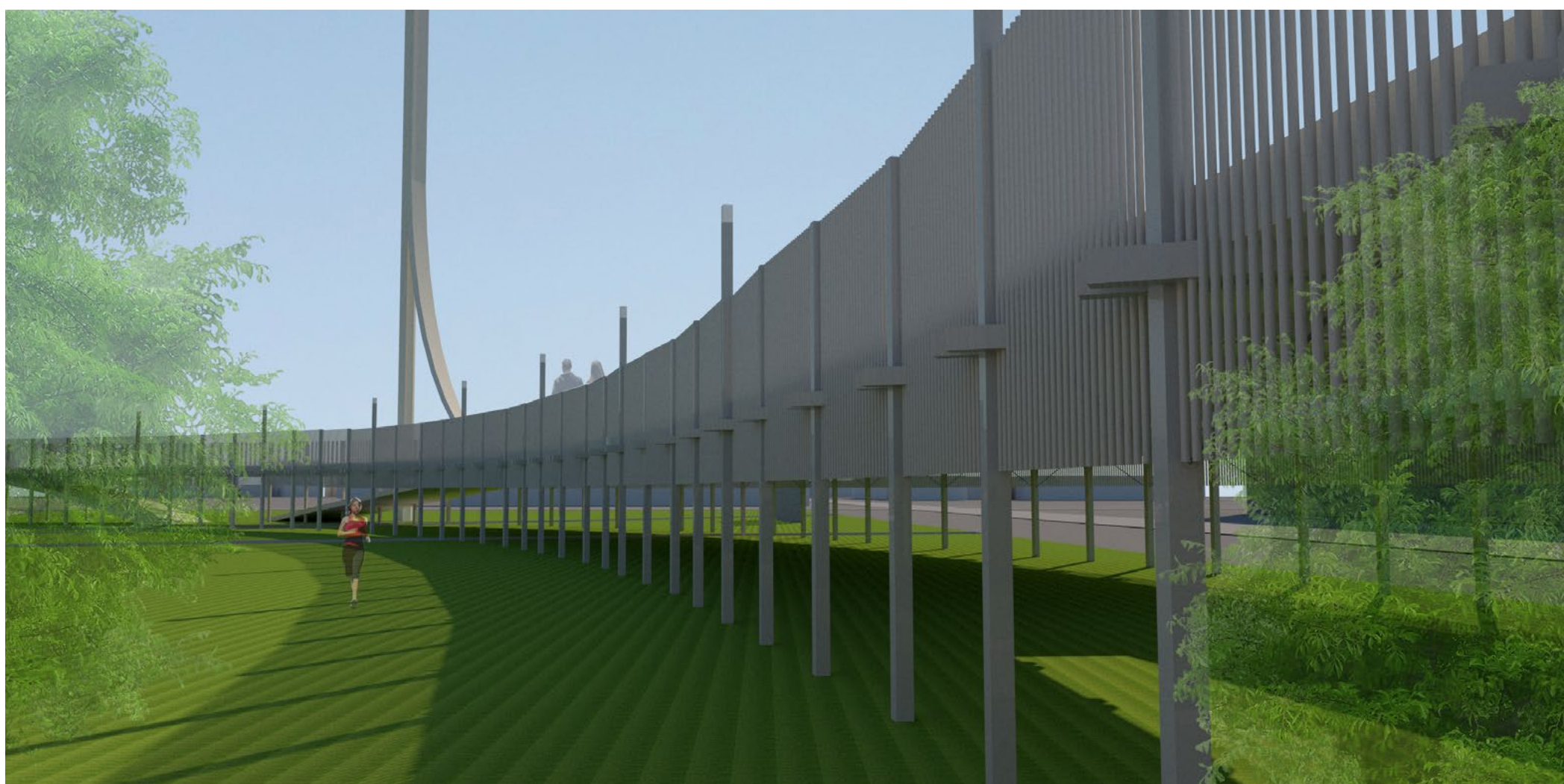

Shade Structure

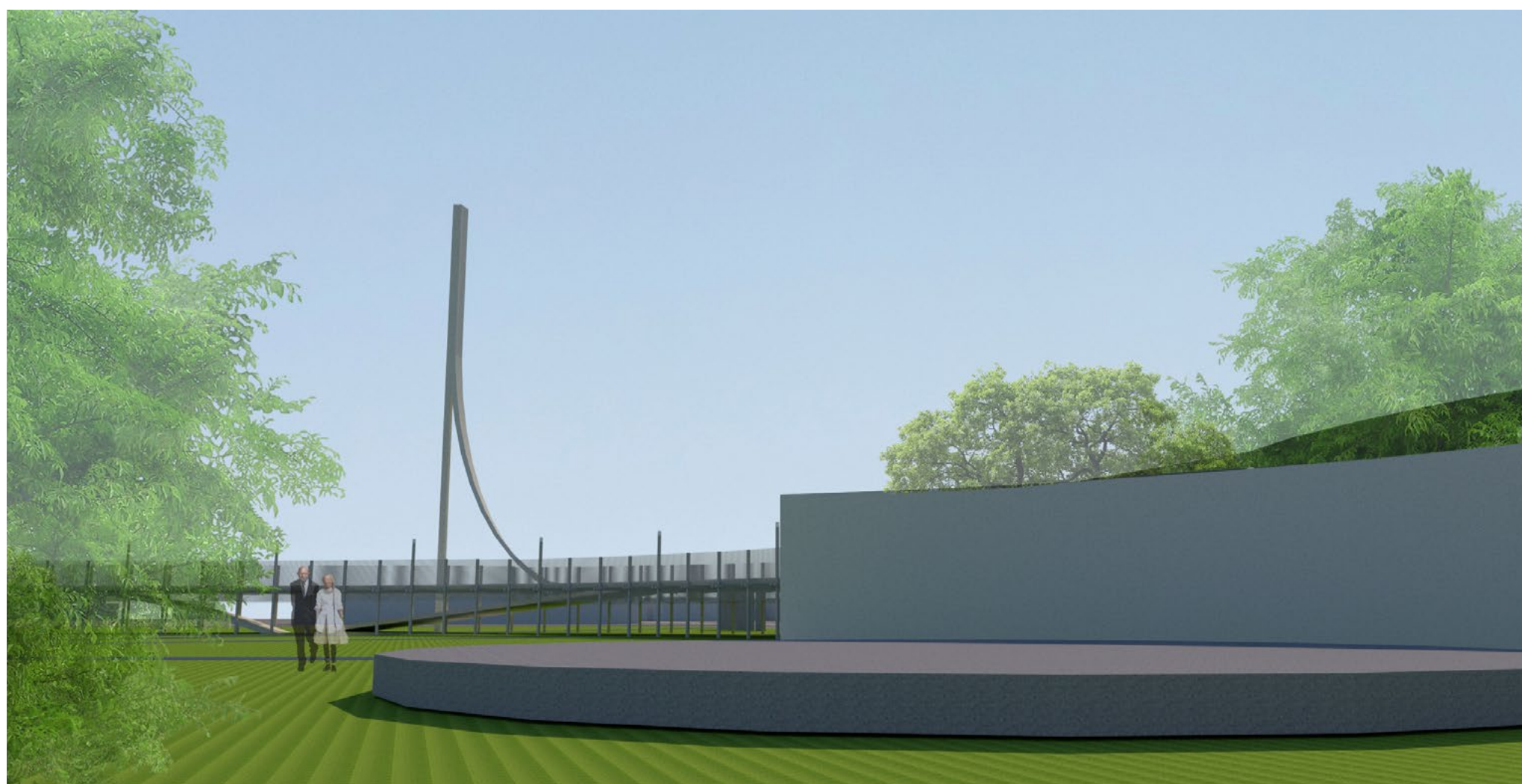

Community Plaza



Tree Canopy