

SILICON VALLEY OF THE HEART'S DELIGHT CULTURAL AND EVENT CENTER

SHORT SUMMARY

The Silicon Valley of the Heart's Delight Cultural and Event Center is a celebration of the valley's history and heritage. The icon's concept is based on one of the oldest and memorable symbols of the Santa Clara Valley - the fruit orchard tree.

The structure is designed to supplement pre and post events at the San Jose Arena with event spaces and amenities, as well as be a tourist, student, and resident educational center portraying important periods in the valley, such as the ancient Native American tribes and cultures, the agricultural period, the industrial period, high tech, and beyond.

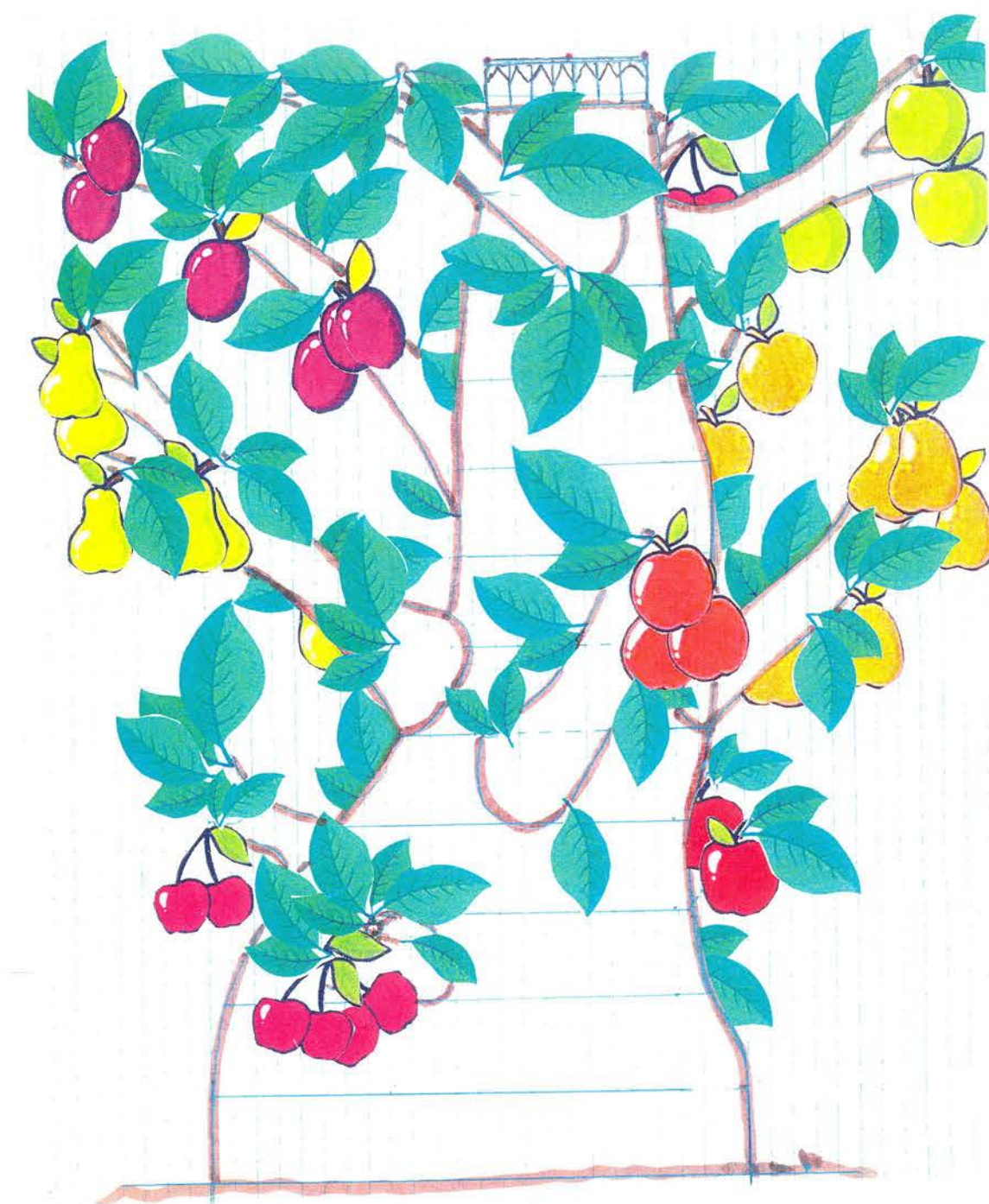

SILICON VALLEY OF THE HEART'S DELIGHT
CULTURAL AND EVENT CENTER
GROUND FLOOR

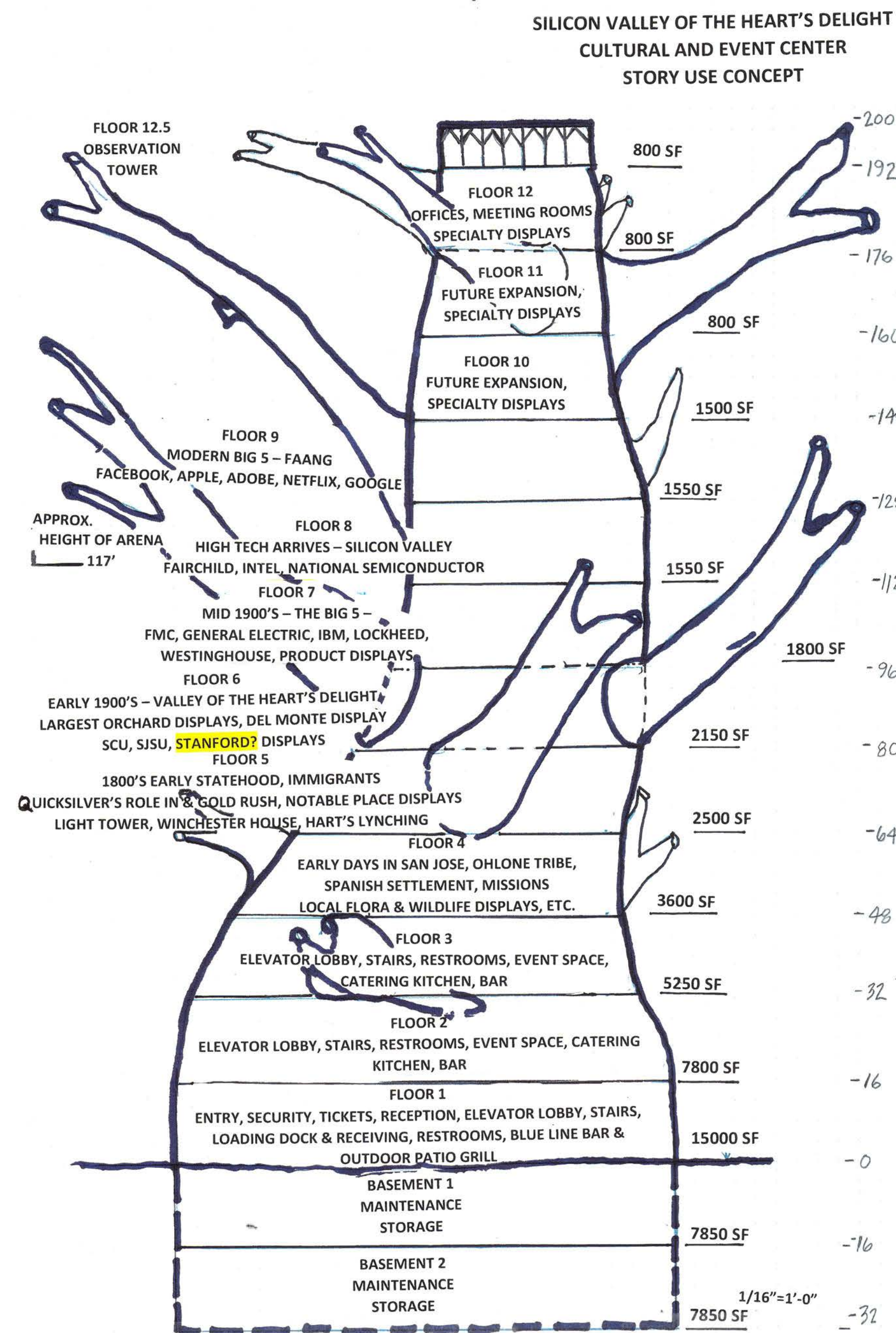
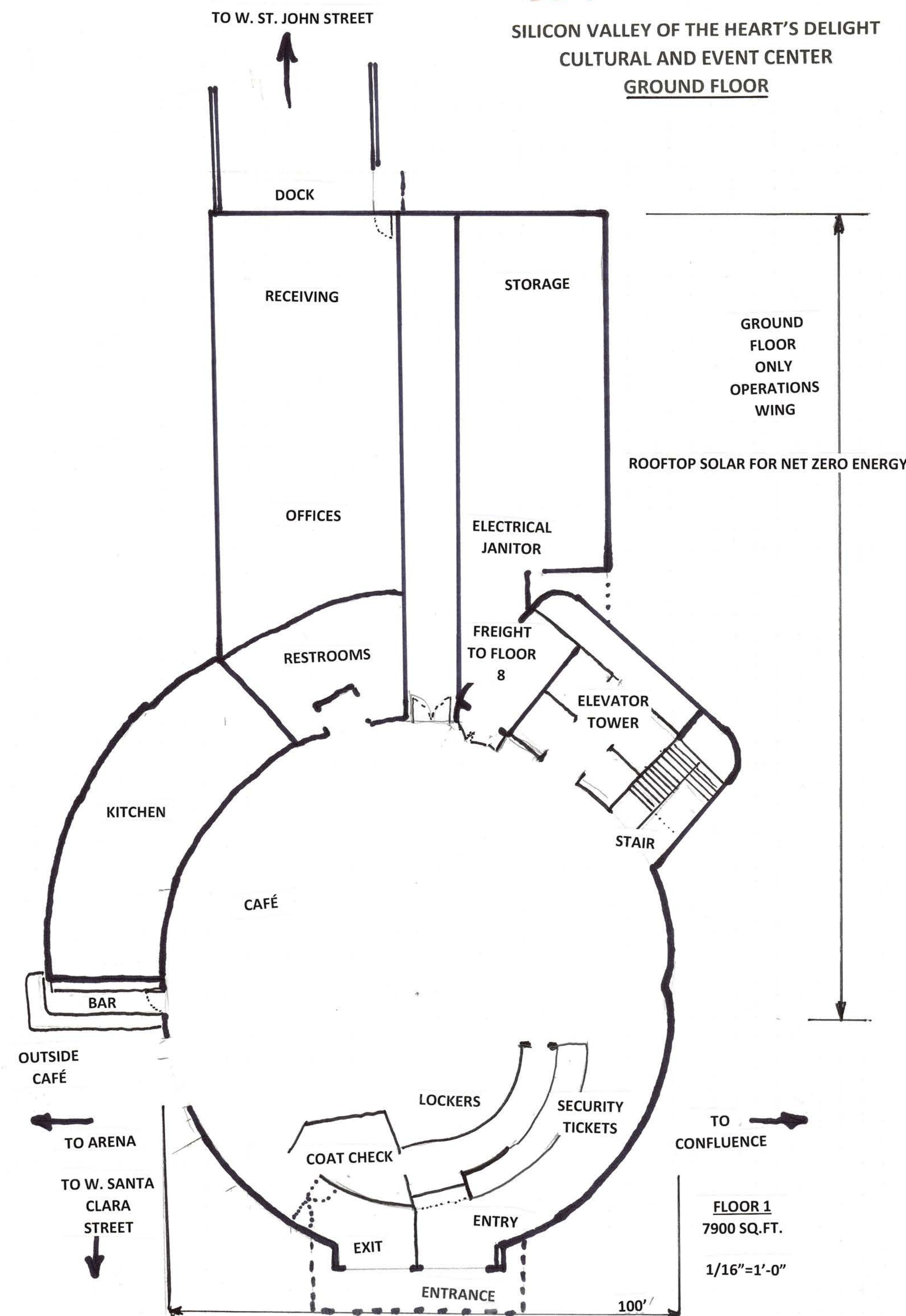

SILICON VALLEY OF THE HEART'S DELIGHT
CULTURAL AND EVENT CENTER
SUBSEQUENT FLOORS

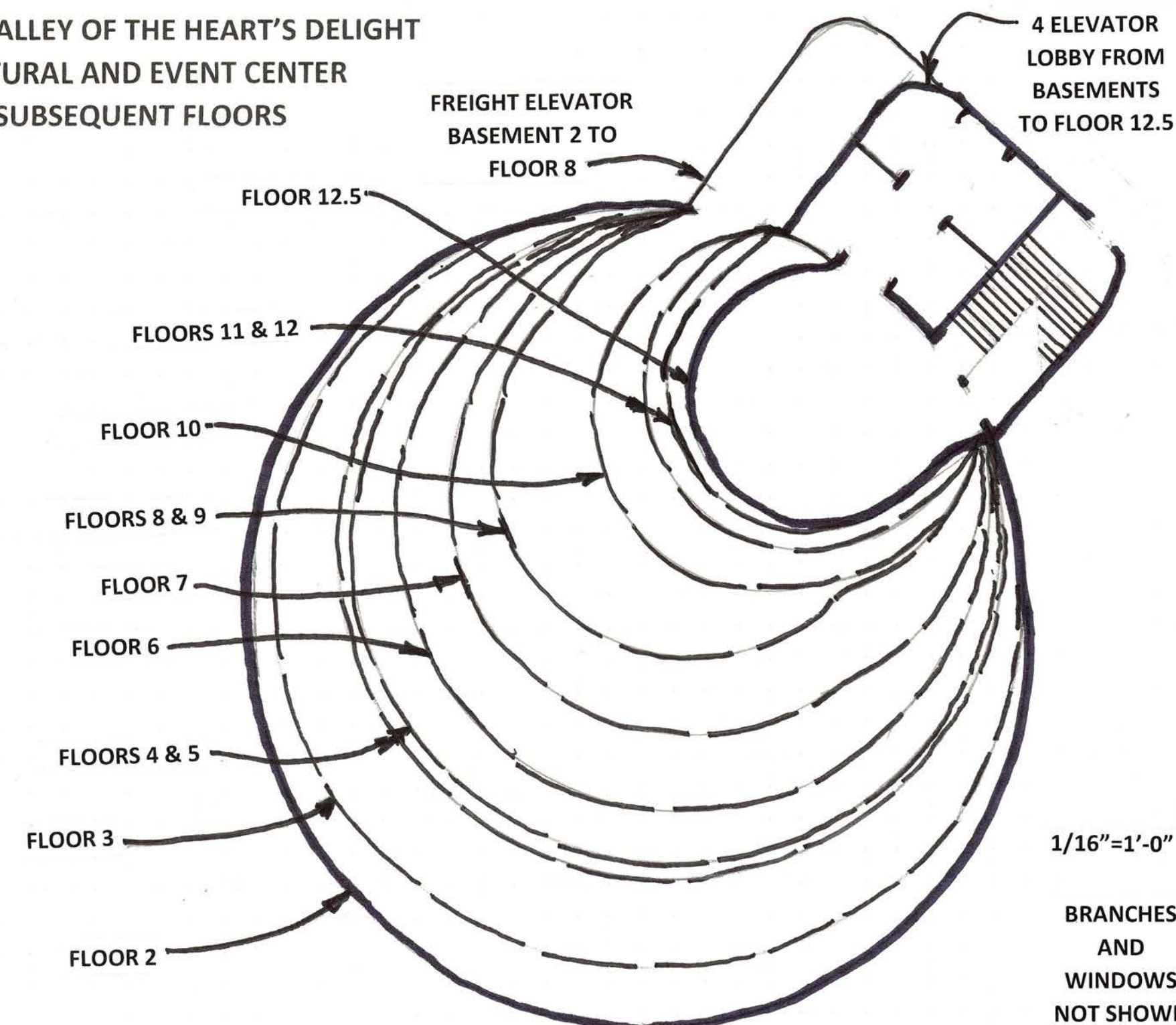

SILICON VALLEY OF THE HEART'S DELIGHT CULTURAL AND EVENT CENTER CONCEPT & DESIGN

The Silicon Valley of the Heart's Delight Cultural and Event Center is a celebration of the valley's rich history and heritage. The concept for the icon is based on one of the oldest and memorable symbols of the Santa Clara Valley - the fruit orchard tree. The structure is designed, as well as be a tourist, student, and resident educational center portraying important periods in the valley on the various floors.

The 12-1/2 story, structure is sited to address the existing East entrance to the San Jose Arena with the ground floor acting as leasable event space for pre and post events at the Arena, and other gatherings, with bar, café and catering kitchens. The ground floor also functions as a lobby and has staff office spaces, display storage, receiving and loading dock, etc. Each of the upper floors displays various important periods in the valley including Native American tribes, flora & fauna, the importance of the local mercury mineral to the California gold rush, the agricultural period, the post-war industrial period, the high-tech period and beyond. The concept is such that tourists, students, and residents will learn the history and heritage of the area from displays of the products and descriptions of the achievements by the outstanding companies, businesses, races, families, people, and natural resources of the area. It is hoped that those entities that are able will assist in the funding, maintenance, and support of the cultural museum aspects of the project.

The conceptual corten clad icon stands 200 feet above the ground as (12) 16-foot floor-to-floor stories, with a small 8-foot observation tower at the top. One or two basement levels are included for maintenance & storage. The fruits on the tree are those that brought early success to the area and are made of a colorful, durable substance to be determined. The leaves on the tree contain solar panels that, as leaves do, supply energy to the system. At night, subtle, kinetic sources of short wavelength green or blue LED light on the underside of the leaves gently bathe the colorful fruits on and off with luminance controlled by time clock controls. The roof of the operations wing contains a solar field for net zero energy use.

The site includes relocated playgrounds and carousel, and perhaps a small sample of the bygone orchard and vineyard eras.

