

DOME SEQUENCE



DOME SEQUENCE

A SERIES OF MULTIPURPOSE GEODESIC DOMES ON THE ARENA GREEN. CLAD IN SEMI-TRANSLUCENT PHOTO-LAMINATED GLASS, THEIR THEMATIC IMAGERY REFLECTS SILICON VALLEY'S HISTORY, ENVIRONMENT AND FUTURE: TECHNOLOGY, AGRICULTURE, PRE-COLONIAL LIFE, NATURAL HISTORY AND CONSERVATION.

IN THE DAYTIME, SUNLIGHT REFRACTS THE PHOTOGRAPH COLORS INTO THE INTERIOR SPACE, DAPPLING THE GROUND AND SURROUNDING VISITORS WITH MULTI-HUED LIGHT.

AT NIGHT, THE DOMES ARE ILLUMINATED FROM WITHIN, CREATING AN ATOMIZED AND INTERCONNECTED SEQUENCE OF COLORFUL VISUAL EXPERIENCES. THE DOMES' HEIGHT AND ILLUMINATED COLORS MAKE THEM APPEAR AS A NEW CONSTELLATION VISIBLE FROM THE HIGHWAY, THE AIR, AND LOCAL STREETS.

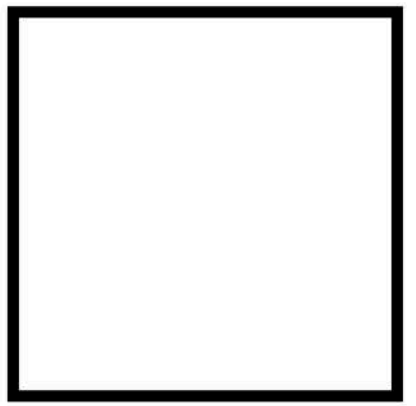

BOARD 2

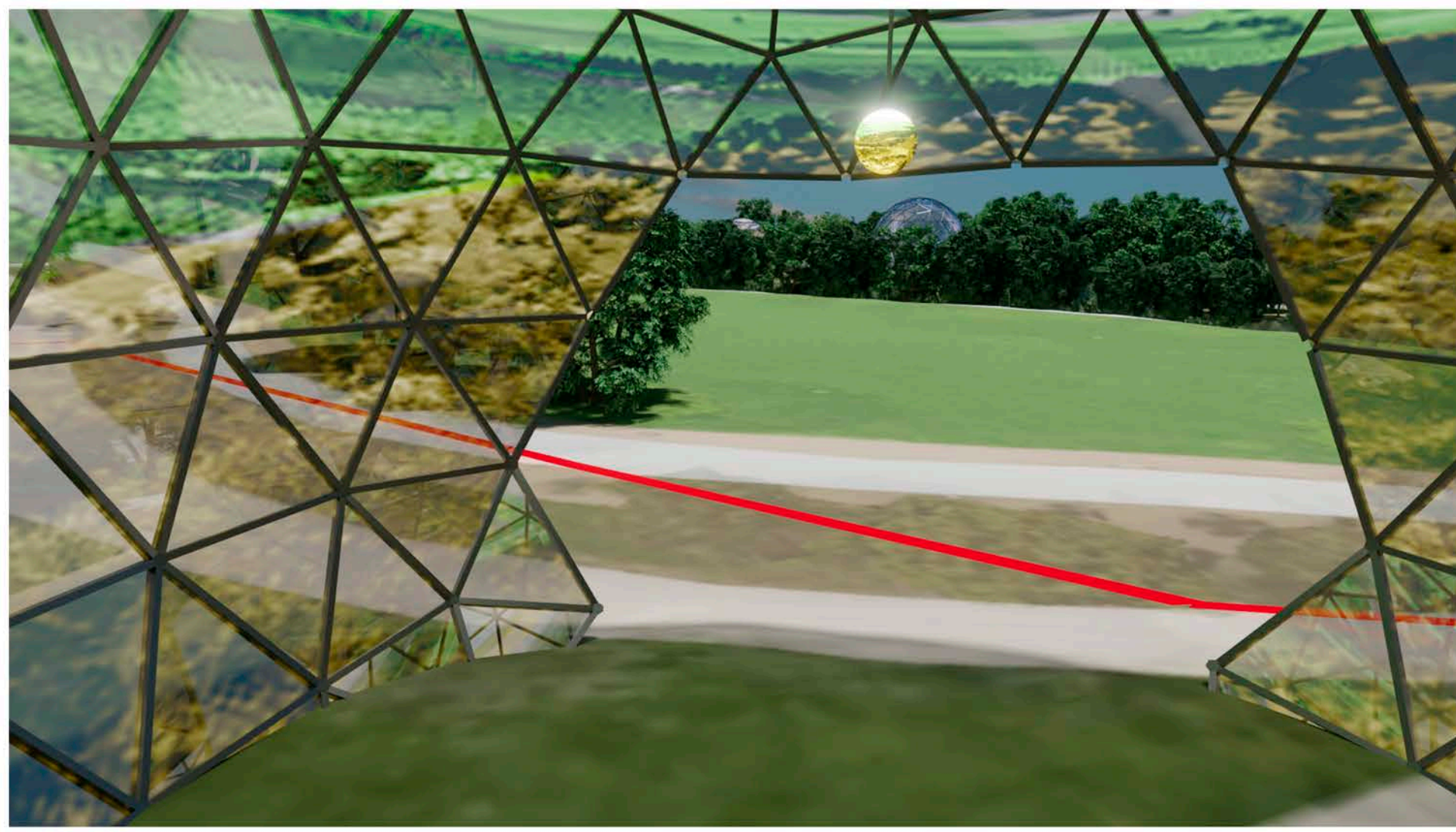

AGRICULTURE

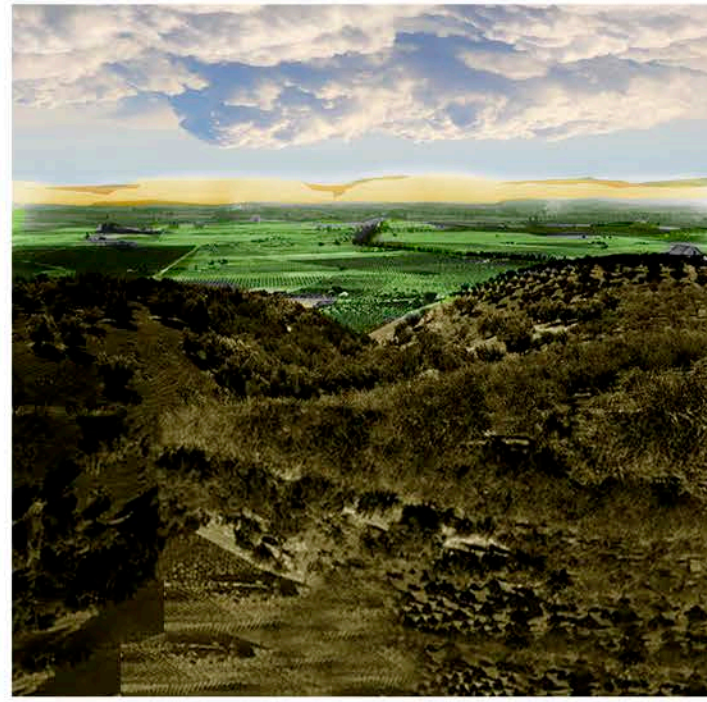

THE AGRICULTURAL DOME ON THE EAST SIDE FACING WOULD BE EQUIPPED WITH A STAGE AND SERVE AS A MULTIFUNCTION COMMUNITY BANDSTAND AND MEETING SITE. ITS LOCATION ALLOWS THE GREENSPACE IN FRONT OF IT TO BE ACCESSED FOR LARGER GATHERINGS AND CULTURAL EVENTS AS WELL AS SETTING THE TONE FOR FUTURE DEVELOPMENT OF THE TENNIS COURT AREA.

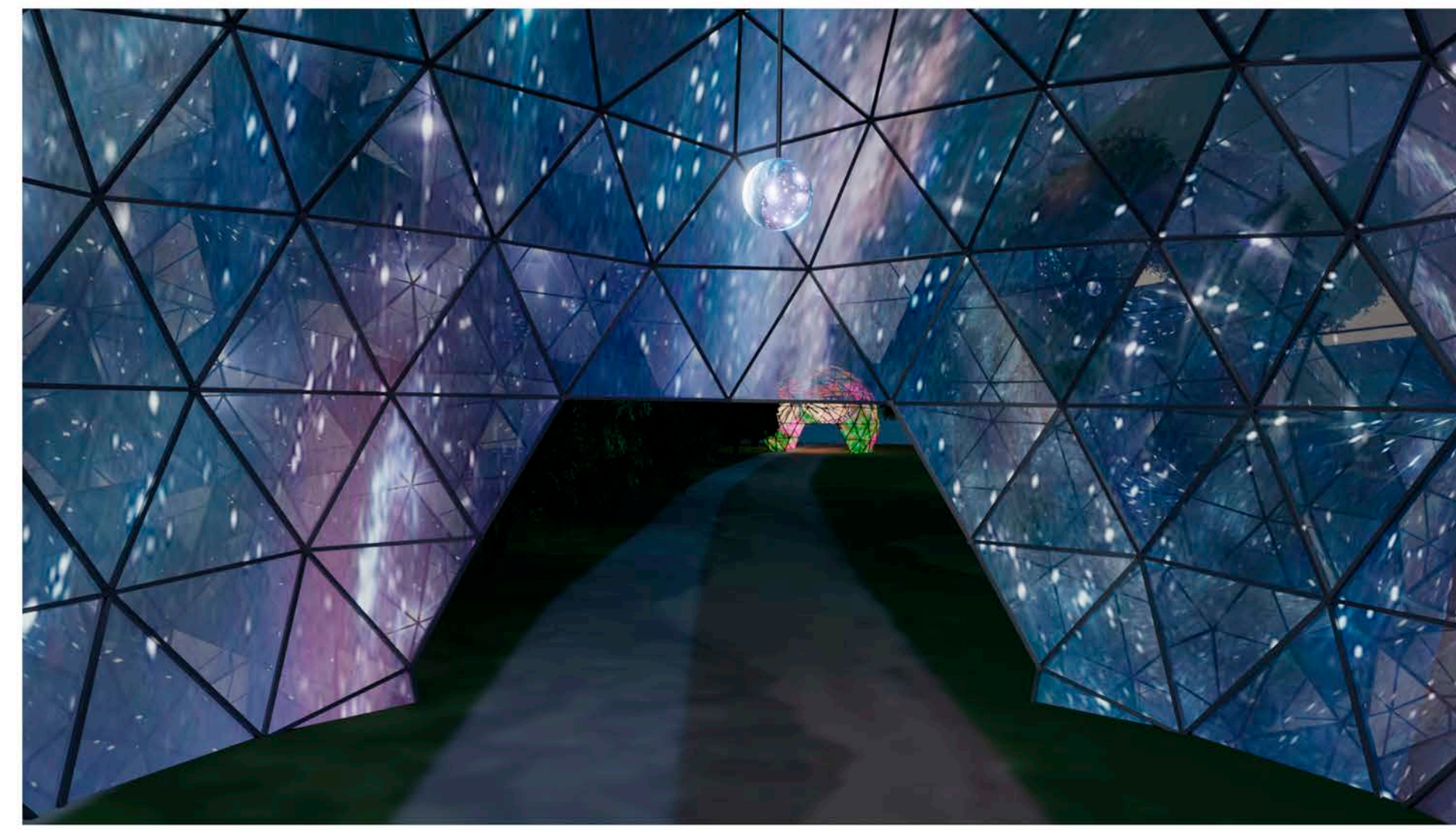

TECHNOLOGY

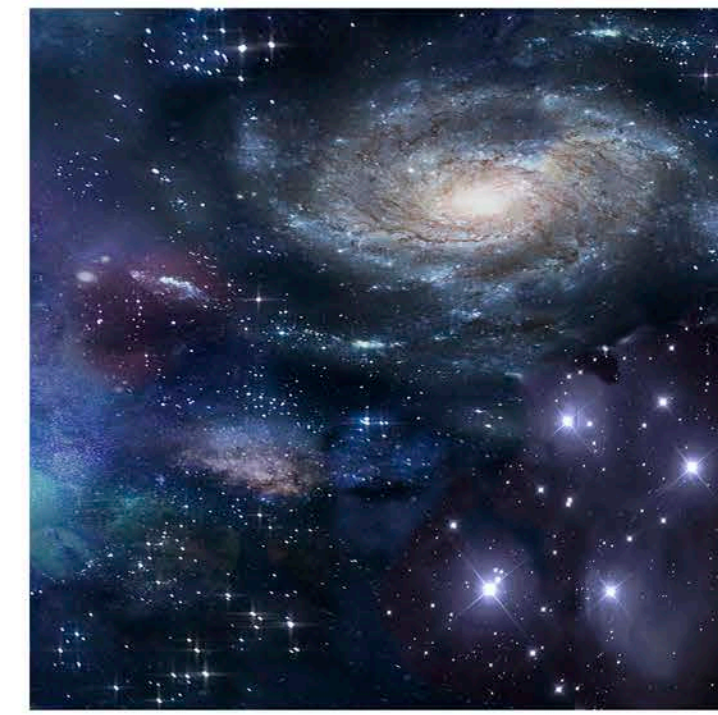

THE SPACE DOME PAYS TRIBUTE TO NASA (AND THE LOCAL AMES RESEARCH CENTER.) IT IS CLAD IN NASA'S PHOTOGRAPHS OF THE HEAVENS.

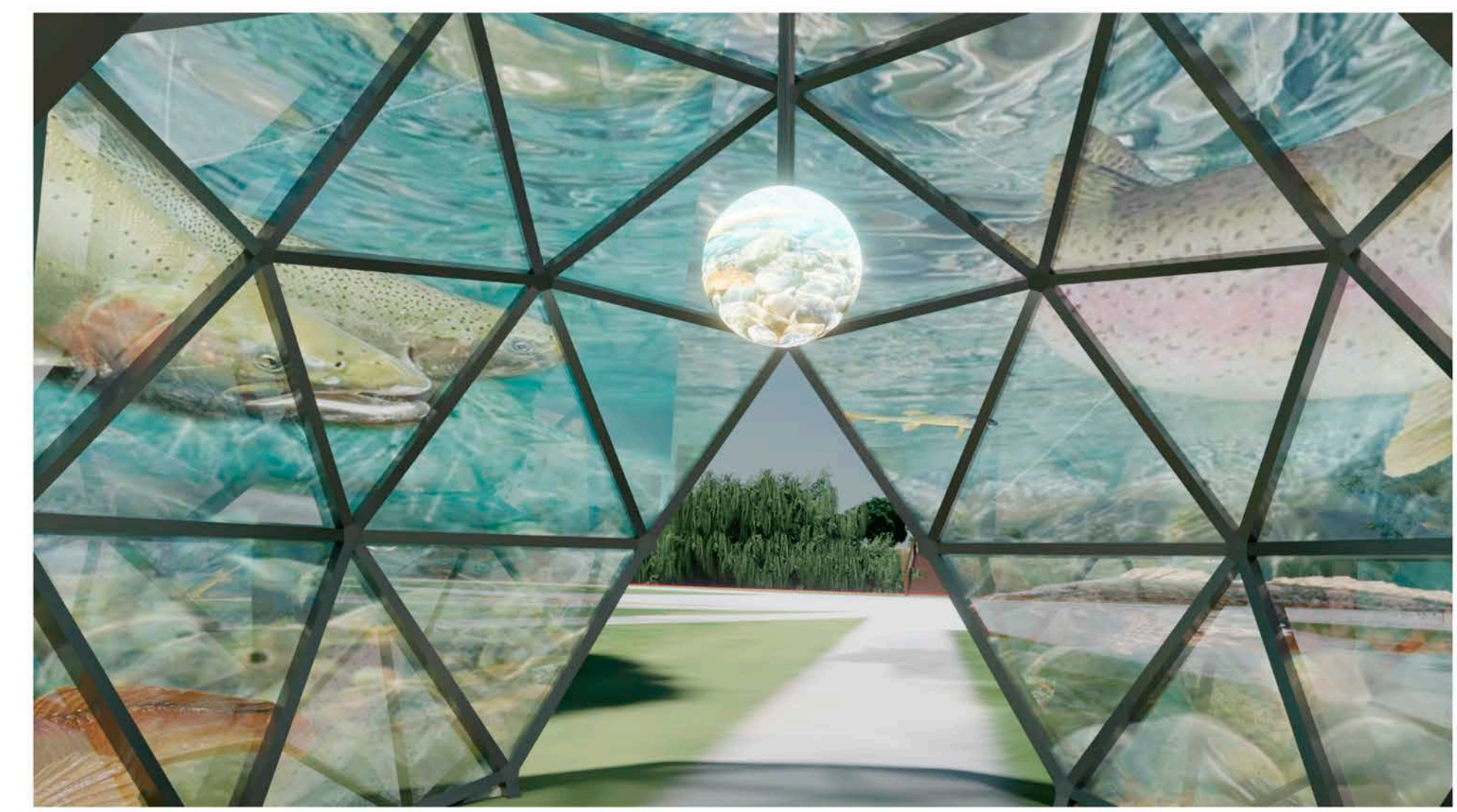

NATURAL HISTORY



THE RIVER DOME IS AN UNDER-RIVER WORLD WHERE VISITORS ARE SURROUNDED BY THE NATIVE FISH AND VEGETATION OF THE GUADALUPE RIVER AND PRODUCED IN CONSULTATION WITH THE GUADALUPE RIVER CONSERVANCY.



PRE-COLONIAL LIFE



THE DOME OF NATIVE PEOPLES WILL BE CLAD IN IMAGES CHOSEN AND PRODUCED BY SAN JOSE'S MUWEKMA OHLONE TRIBE.

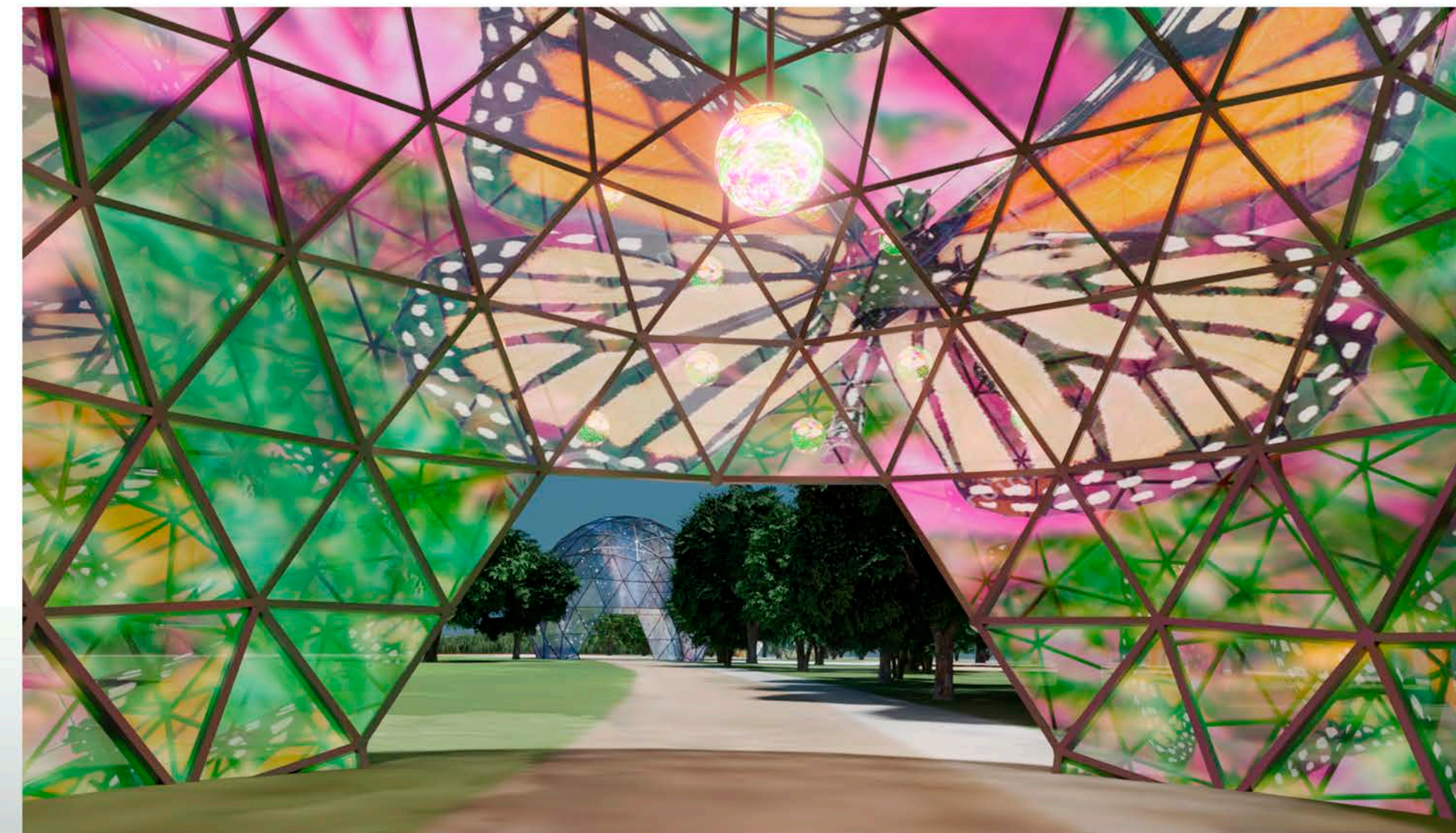

CONSERVATION

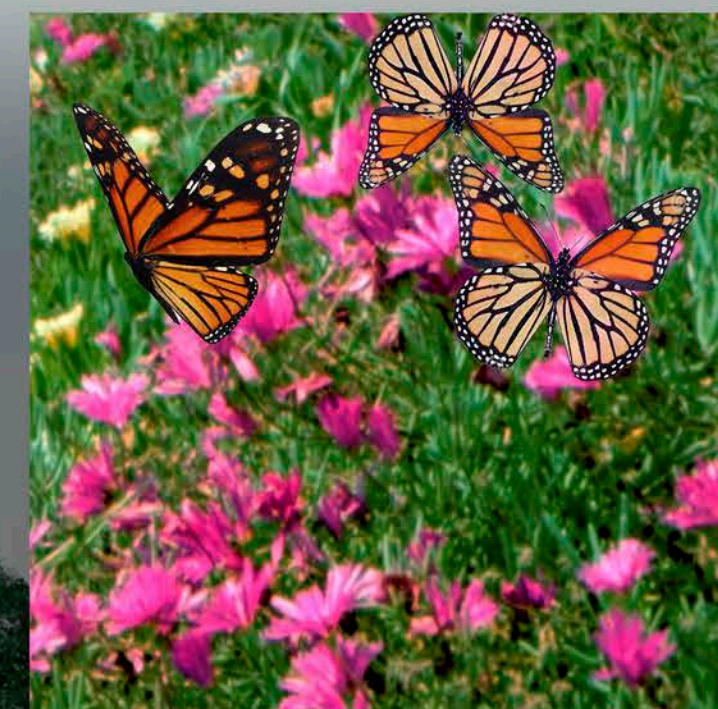

THE BUTTERFLY DOME GLOWS WITH IMAGES OF NATIVE CALIFORNIA BUTTERFLIES, THE REGION IS A GLOBAL EPICENTER FOR RARE BUTTERFLY SPECIES.

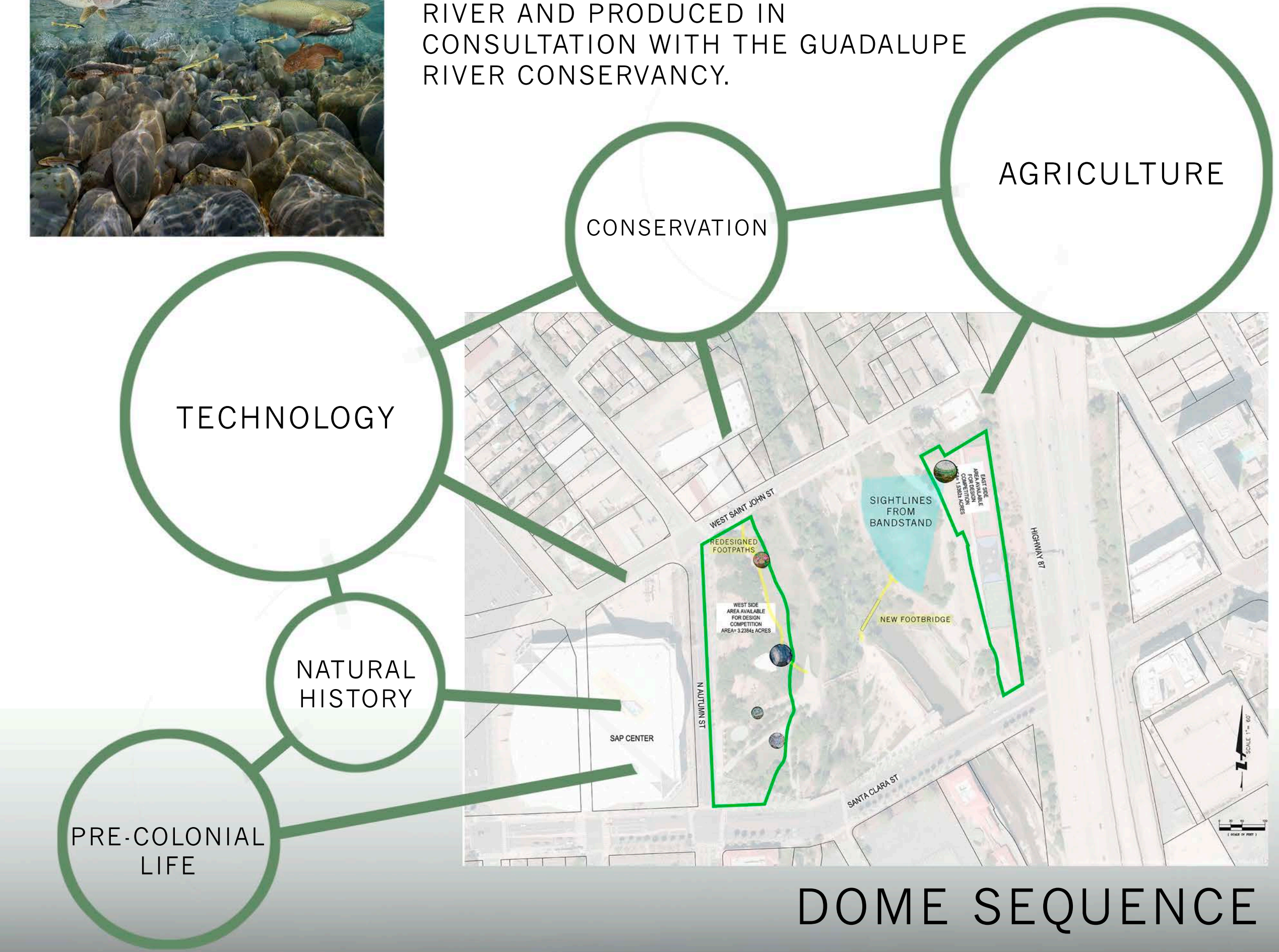

DOME SEQUENCE

