

Cross Section
1:250
20ft

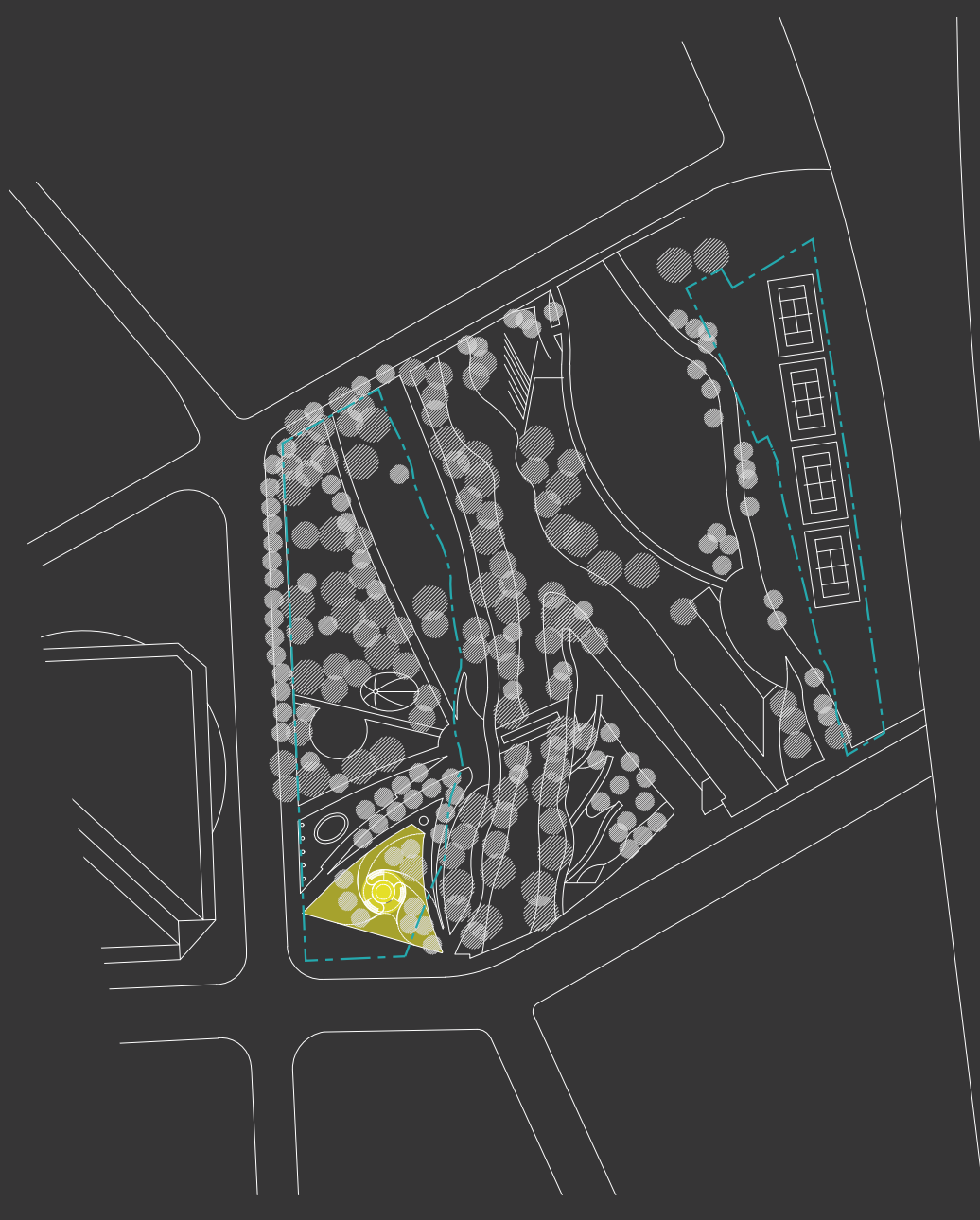
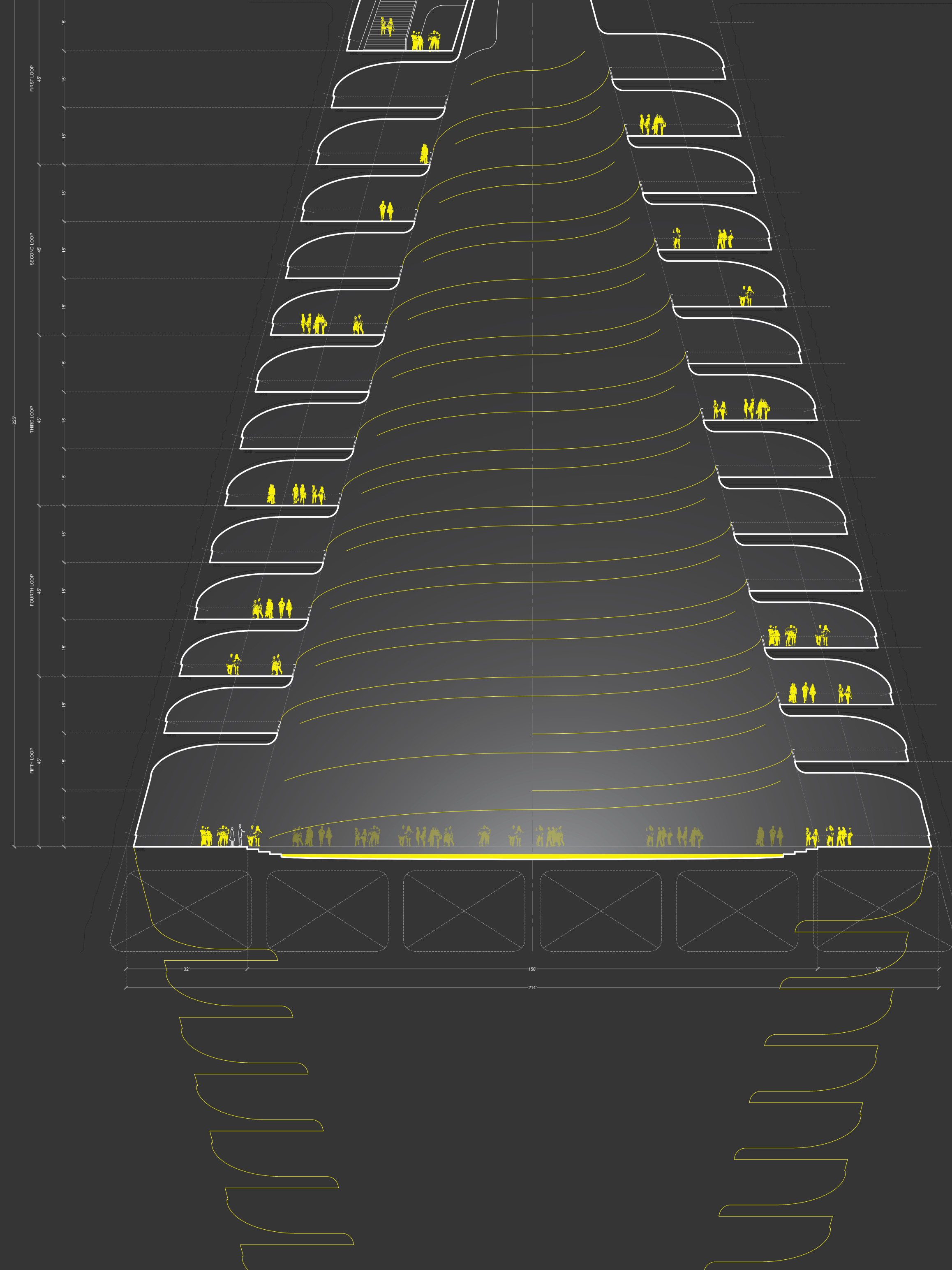

Site plan
1:2,500
200ft

JOURNEY IN

Our vision for Urban Confluences is an immense void in the park. An invitation to an introspective space, subtle in the surface but of great proportions underground. We will journey in to experience, to process, to question and to REFLECT. REFLECT. REFLECT.

The entrance to the space is located in the southernmost tip of Arena Green West, right across the stadium. This location will reduce significantly the impact of any construction in an already consolidated park and will complement the civic activities in the area.

The structure features a central oculus - similar to the Roman Pantheon - from which the visitors will enter into a spiraling ramp down the space. The continuous circulation is an homage to one of the most important American buildings, the Salomon R. Guggenheim Museum in New York City, and will provide access to a public piazza located in the lower level.

The space is envisioned to be a space of reflection. A place where to dream about the moon, but with the feet in the ground. A public plaza that welcomes everyone equitably. A place where to gather, where to walk and contemplate, a place to celebrate and to learn.

The lower level of the structure doubles as a huge mirror, expanding the habitable space beyond the visitors reach and making the experience almost spiritual.

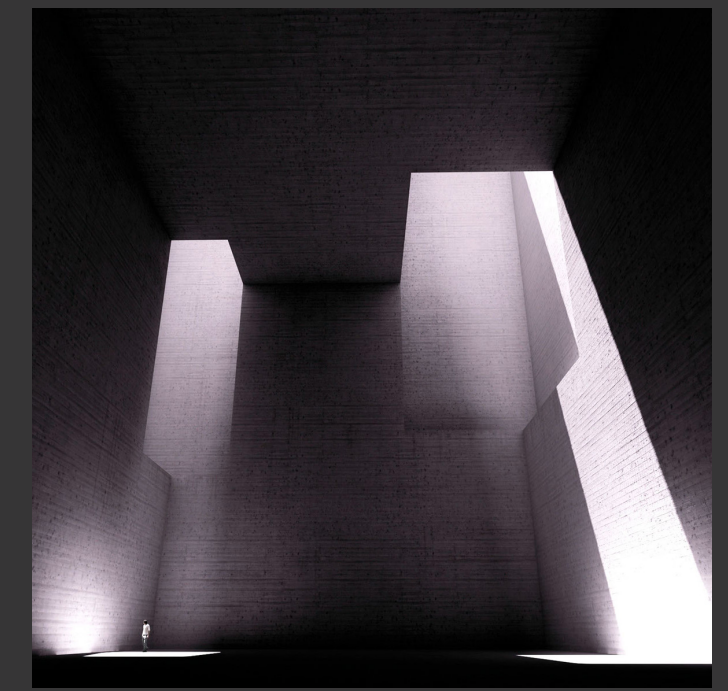
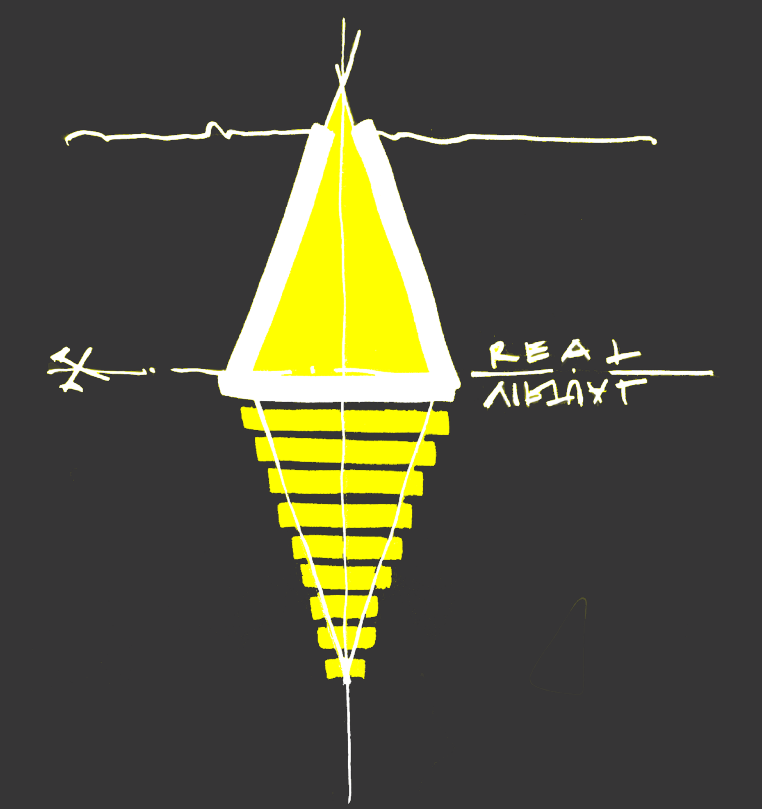

Eduardo Chillida
Tindaya Mountain Project

"Years ago I had an intuition that I believed to be utopic. To create an interior space inside a mountain for humankind of all races and colors, a great sculpture to tolerance."

-Eduardo Chillida

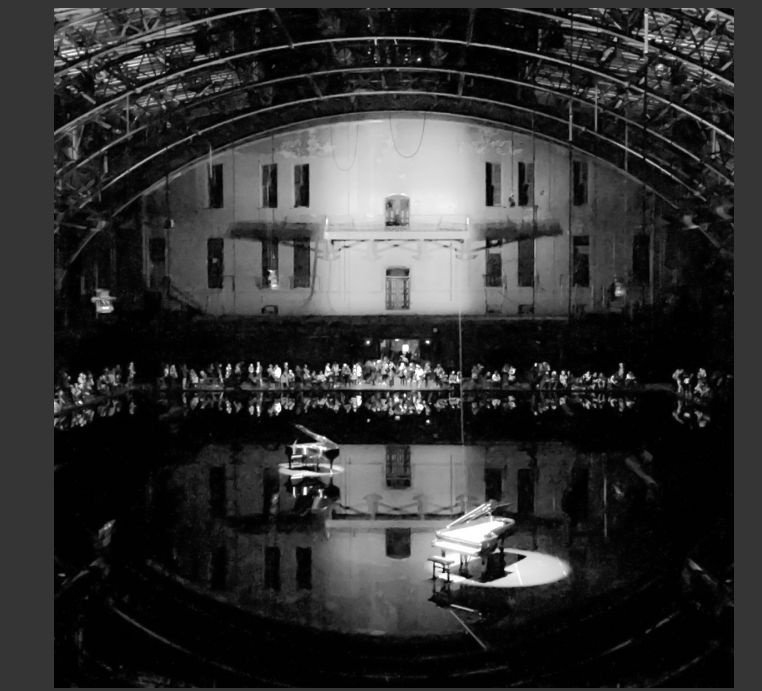

Douglas Gordon
Tears Become... Streams Become...

"A field is endless - it goes on, and on, and on, and on. And as the water collects, the space it inhabits will never be the same again."

-Douglas Gordon



Frank Lloyd Wright
Salomon R. Guggenheim Museum New York

"Make the building and the painting an uninterrupted, beautiful symphony such as never existed in the World of Art before"

-Frank Lloyd Wright

