

# BRAIN STORM The Innovation Monument of Silicon Valley

The monument is a stunning helical structure with a base of "brain" that creates a visual presence of "brain storm" for embracing the theme of innovation in the advancement of humanity.

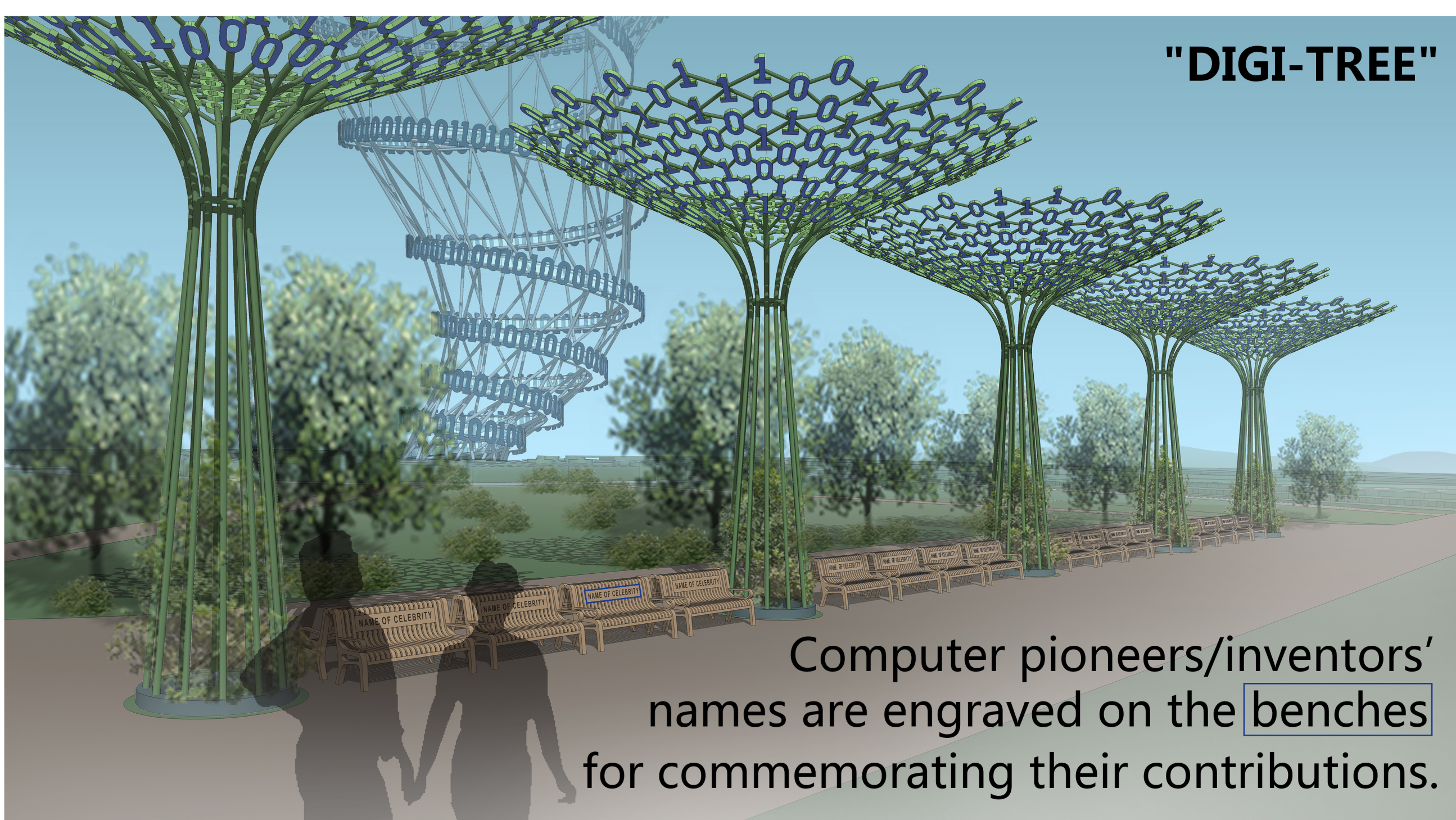

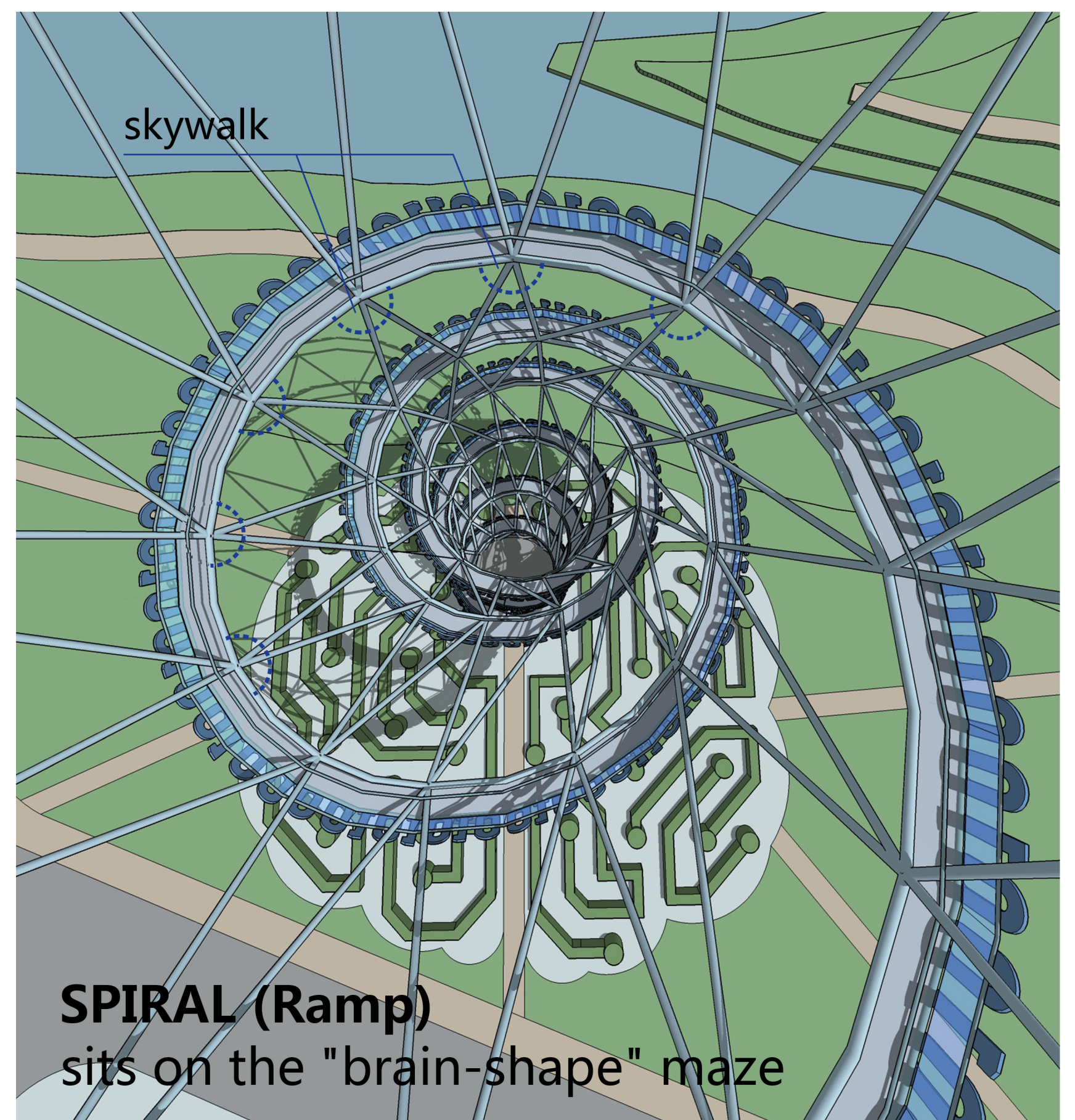
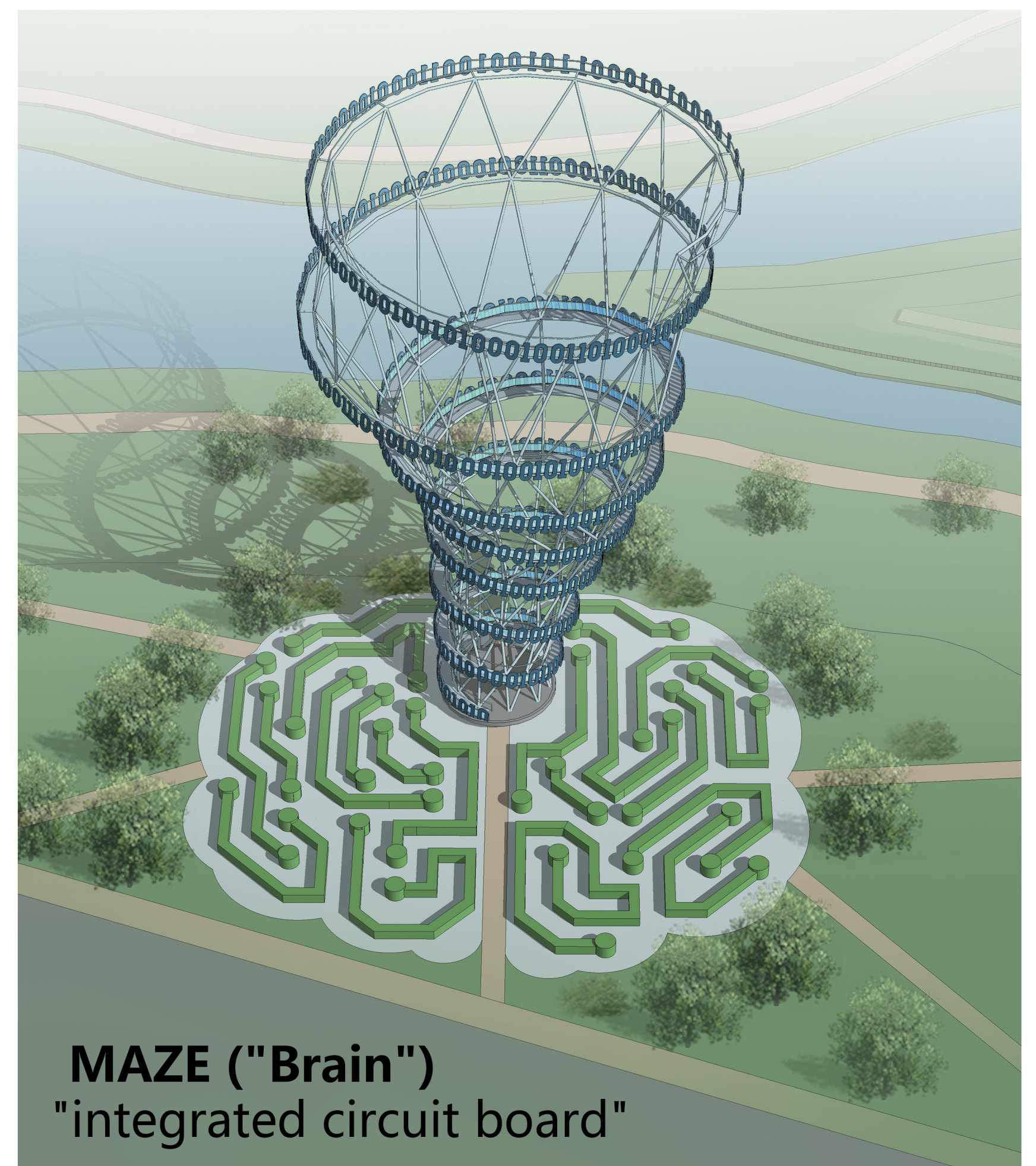
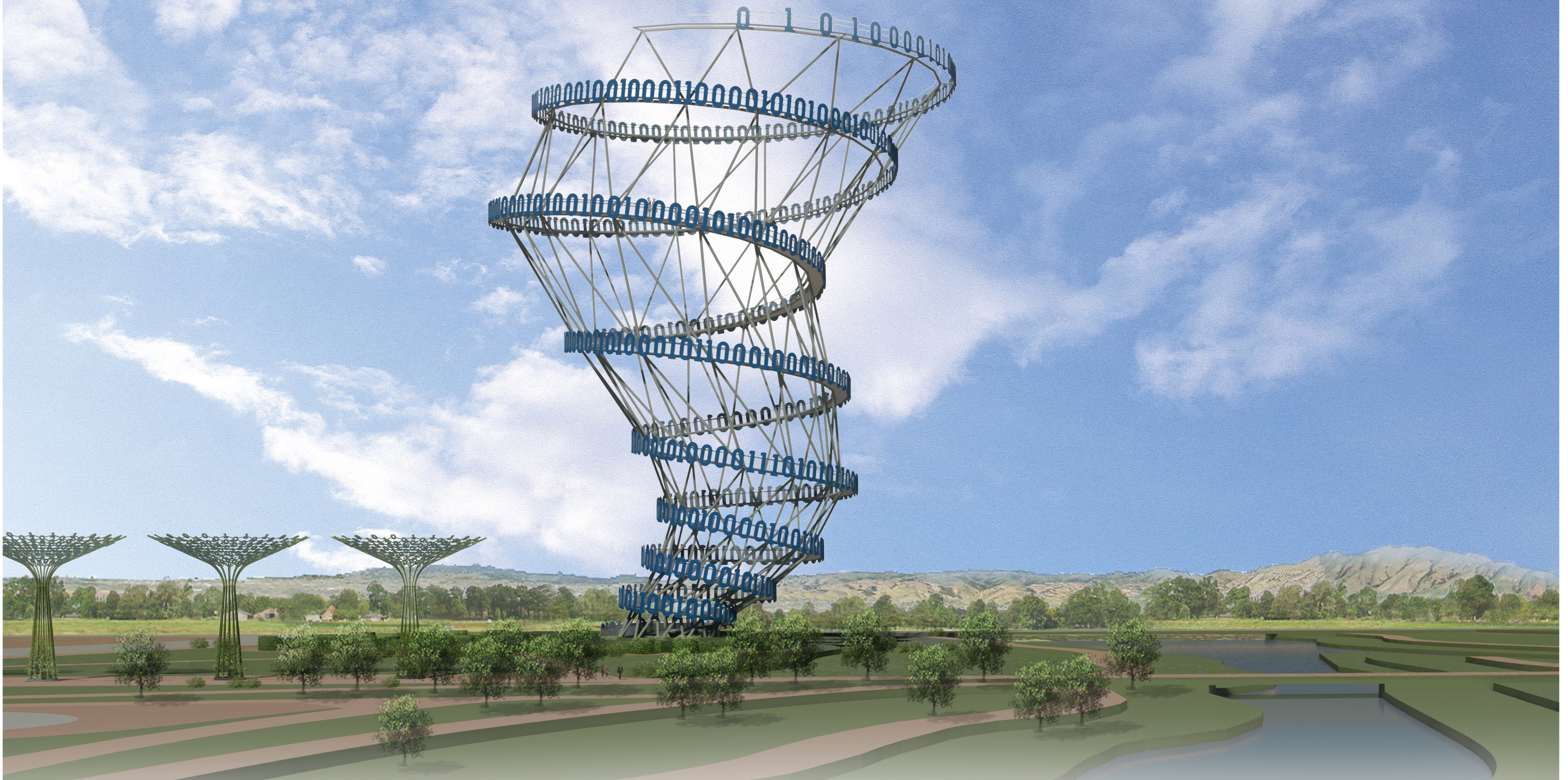
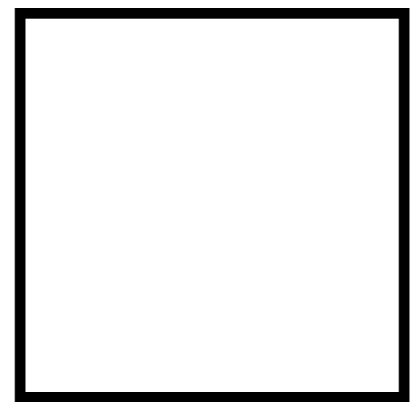

# BRAIN STORM The Innovation Monument of Silicon Valley

Dynamic and rich lighting effects are realized by manipulating the "0" and "1" LED light fixtures on the "storm" tower and "Digi-Trees". Using blue tone as main light source, the lighting is designed to create a sense of science fiction in the future.

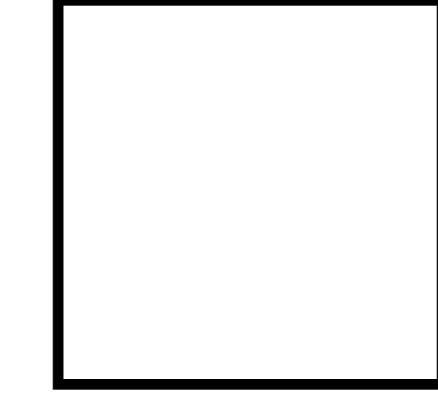

For example, the LED lights on the "storm" tower can be lit from bottom to top or from top to bottom one by one to generate the spiral light band moving up or down.

To minimize the impact on the surrounding natural environment, all lighting features are considered.

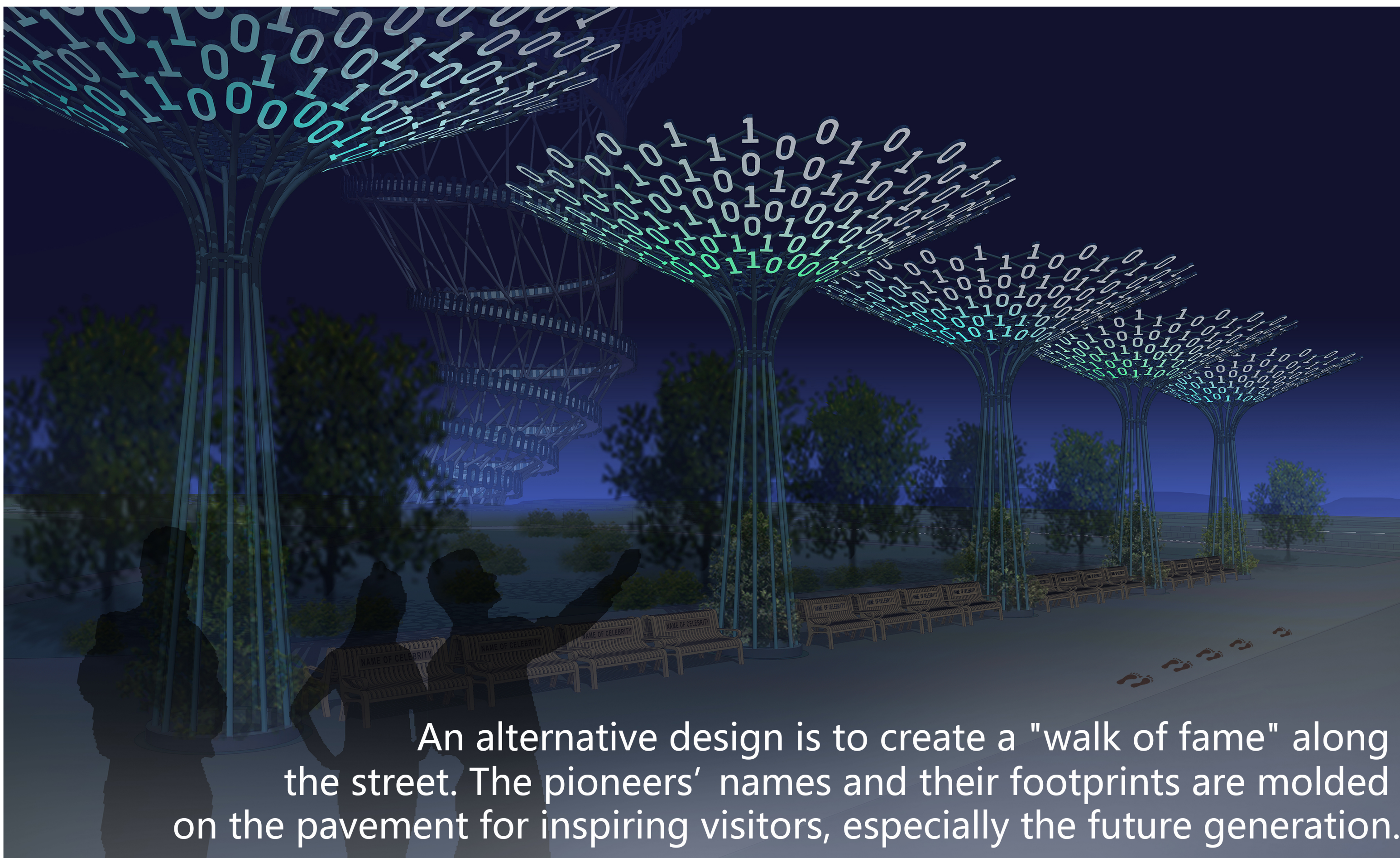

An alternative design is to create a "walk of fame" along the street. The pioneers' names and their footprints are molded on the pavement for inspiring visitors, especially the future generation.

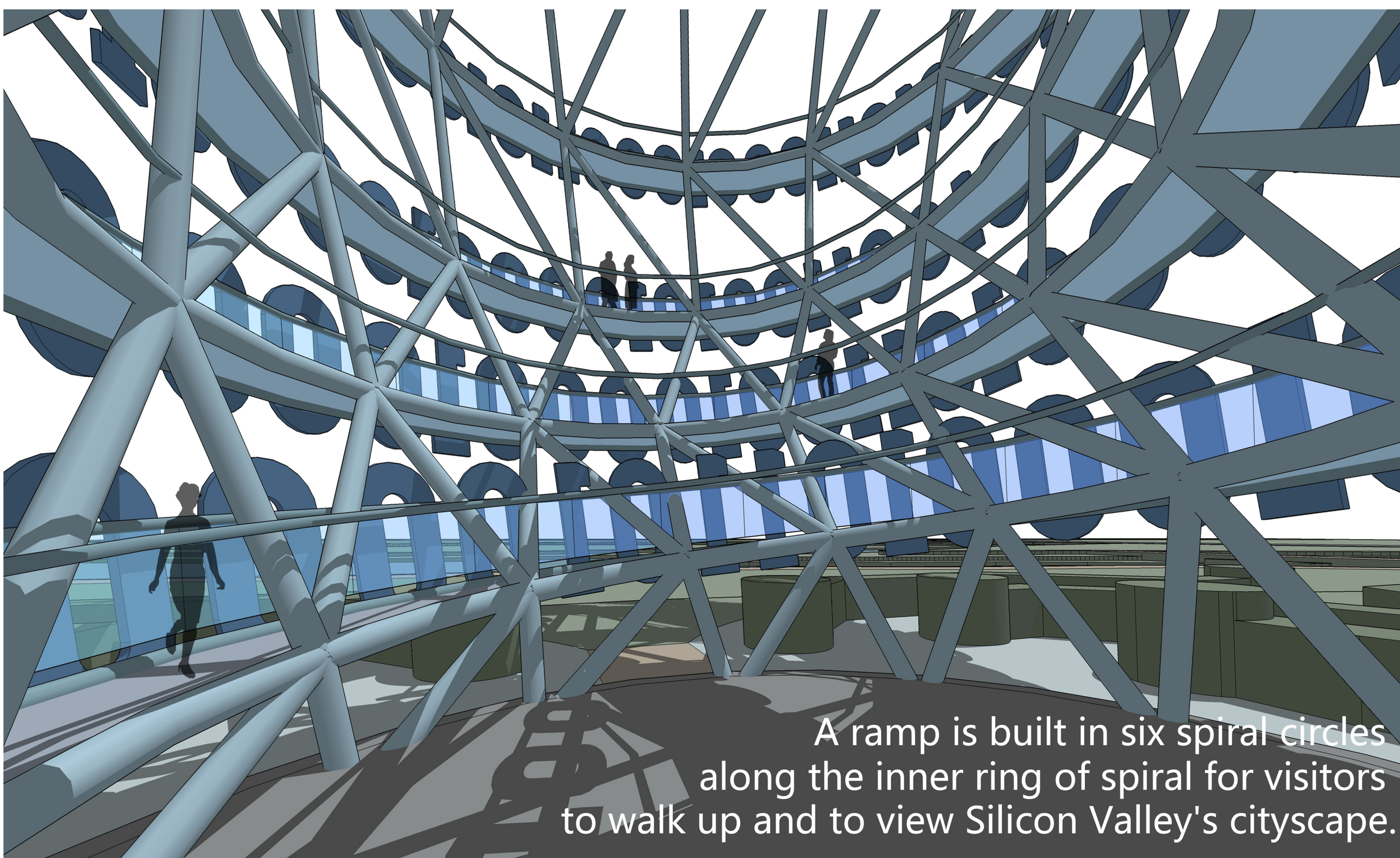

A ramp is built in six spiral circles along the inner ring of spiral for visitors to walk up and to view Silicon Valley's cityscape.

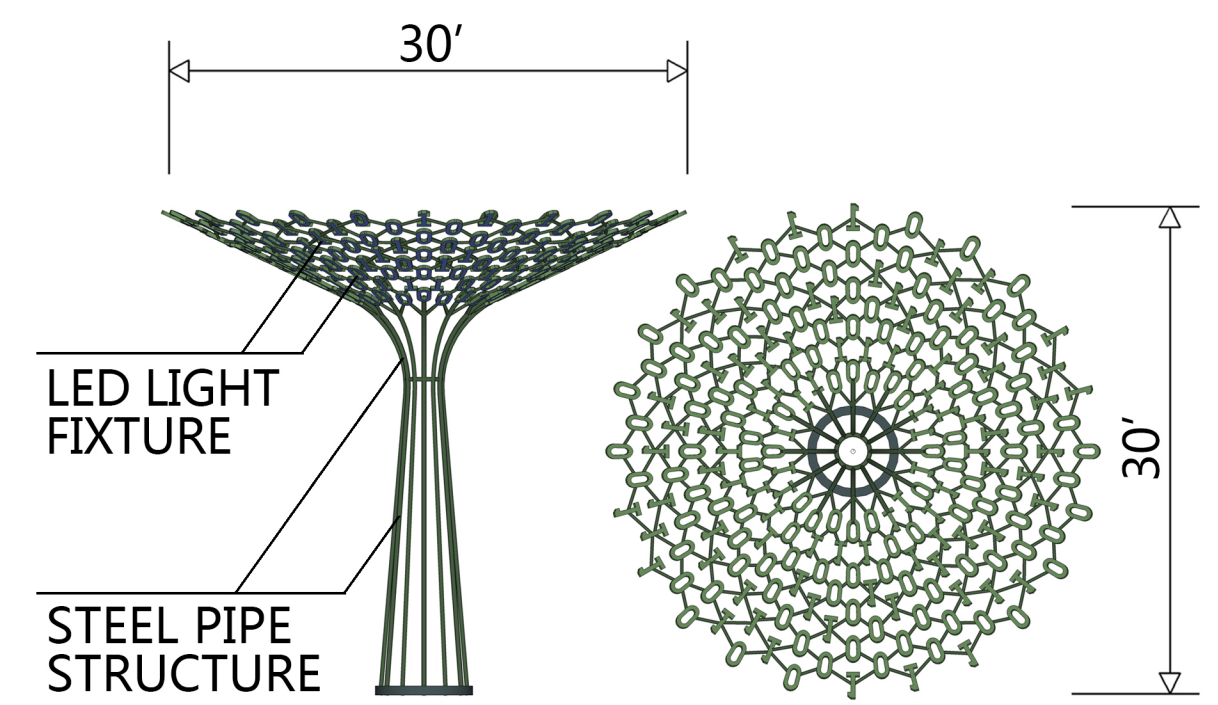

**"DIGI-TREE"**

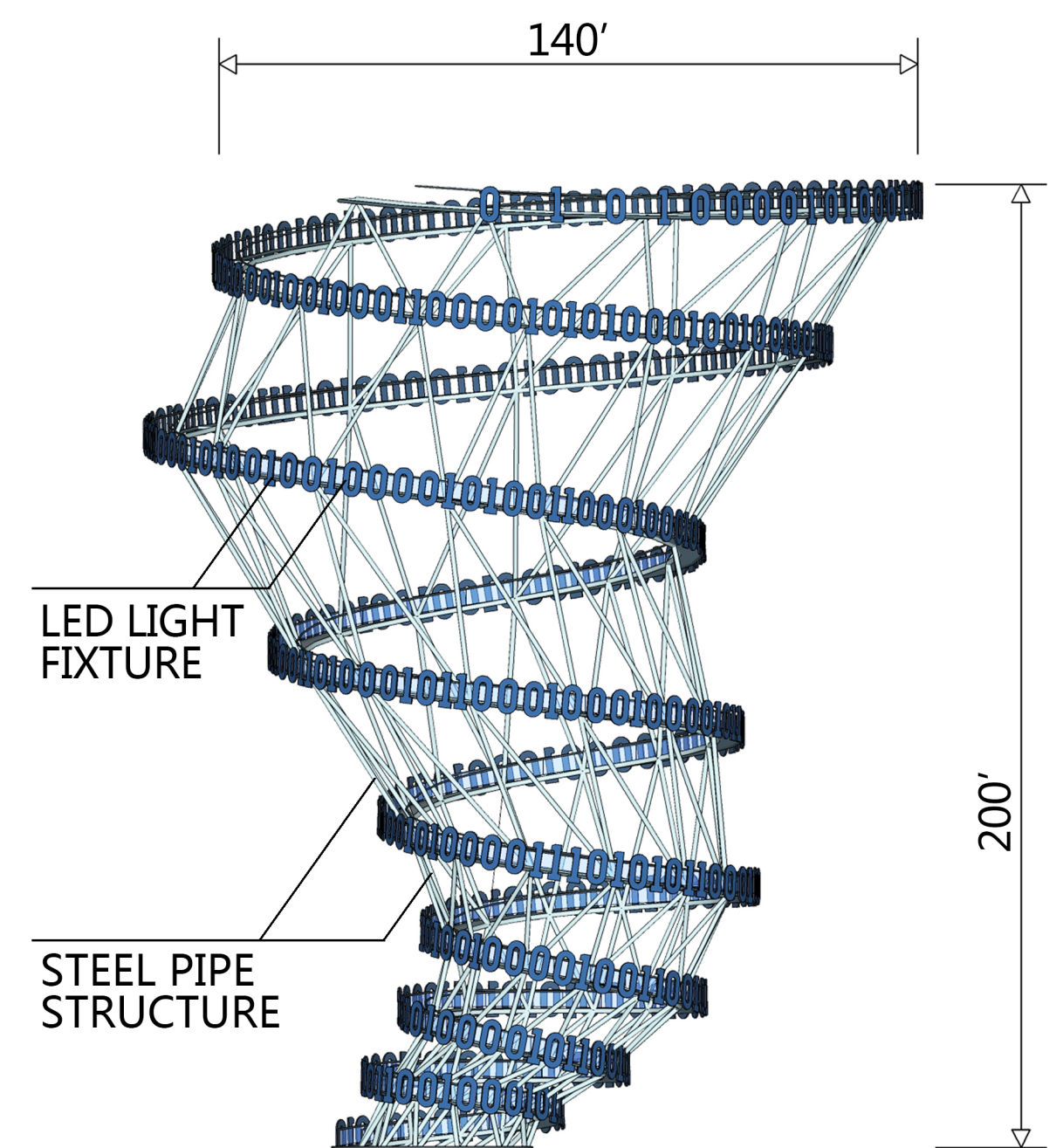

**FRONT VIEW**

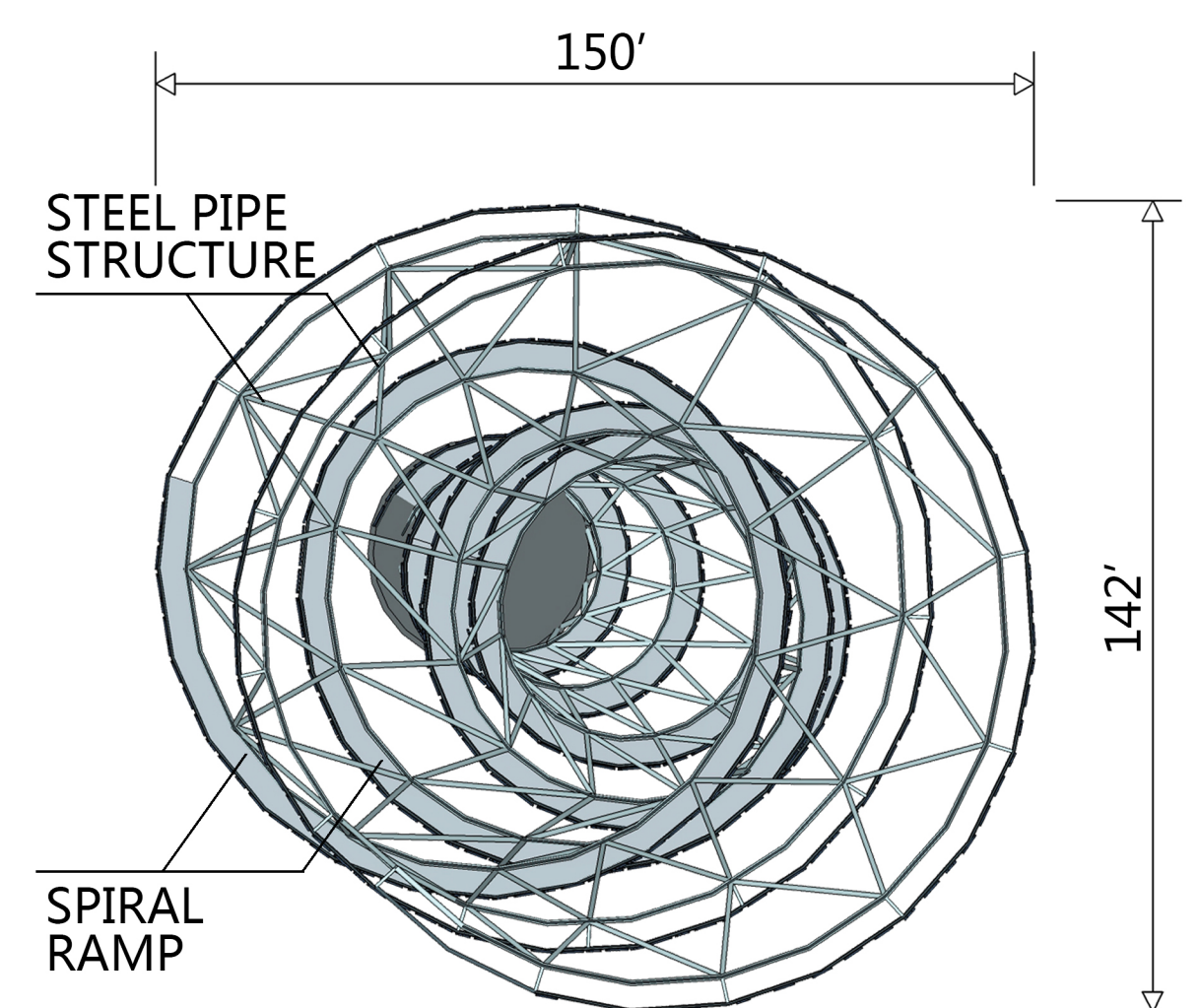

**TOP VIEW**