

# The Valley

## A Green Icon for All



### An Iconic Open Space for San Jose

The Valley is an icon that is shaped by the aspirational values of the 21st century. Situated in the center of the contemporary cradle of innovation, the twin peaks of The Valley are the urban landmarks that San Jose's skyline lacks.

The Valley is a critical asset to the local community that re-frames how residents interact with the city's urban fabric, its history, its natural amenities, and with each other. Together, it represents the dynamic spirit of the people of San Jose and provides them with a platform to view their city in a way that they have never been able to before.

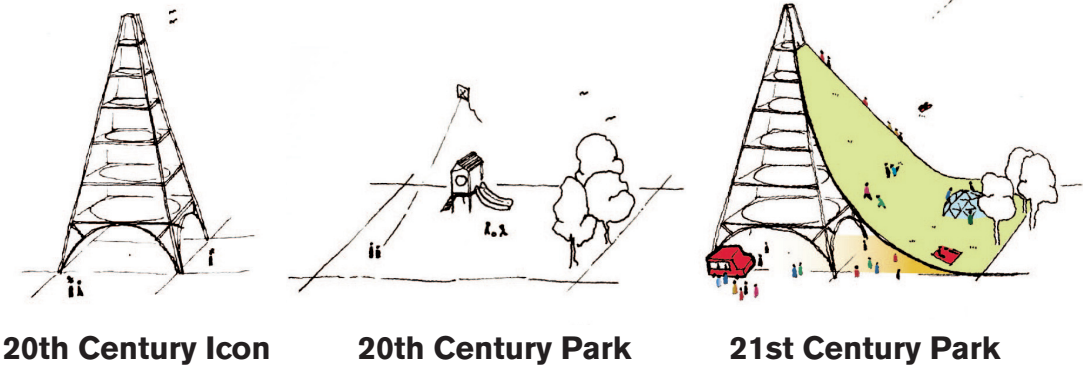

The Valley is comprised of two landforms emerging from the eastern and western edges of Arena Green. Named after prominent women leaders from San Jose's civic history, Vice Mayor Lola Williams and Mayor Janet Gray Hayes, Mount Lola and Hayes Hill provide new space for gathering, active leisure, biodiversity, and the sharing of history and art.

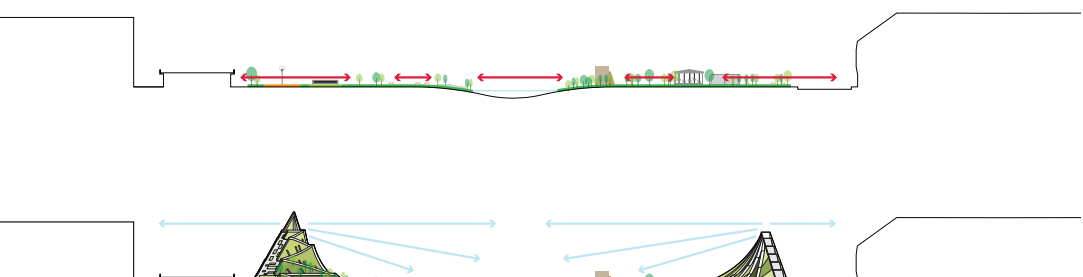

**Connecting Arena Green Together**  
Currently, Arena Green feels both isolated and disjointed. By adding vertically, visitors will feel a much stronger connection to other parts of the park as well as the surrounding city.

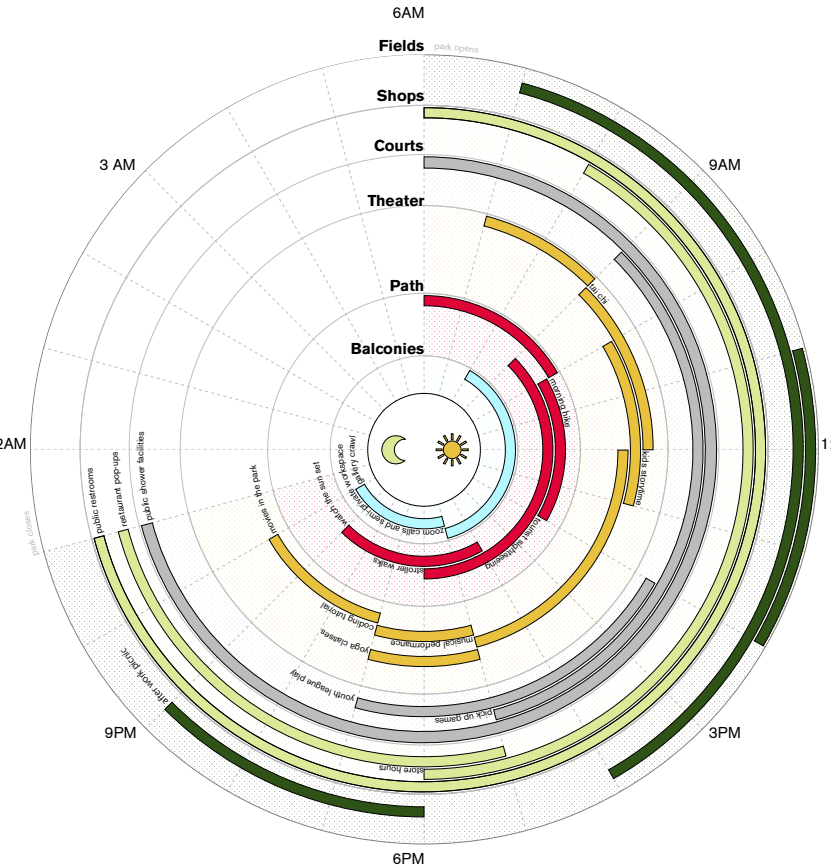

### This Icon is Active All Day, Everyday

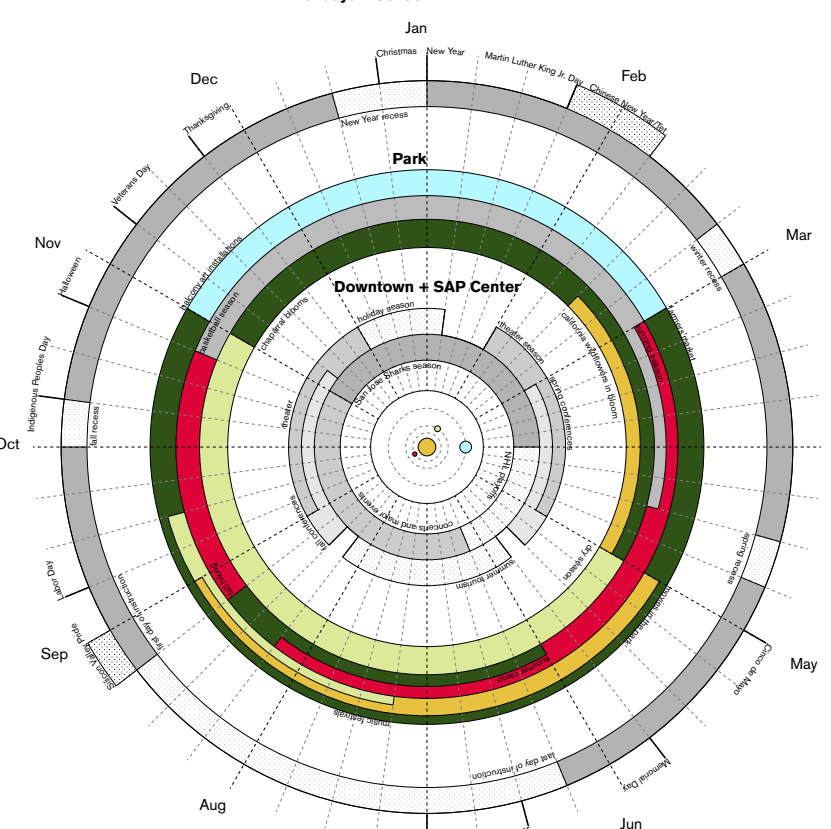

**A Center of Activity**  
The programs offered in the Valley both augment and compliment San Jose's existing schedule of events.

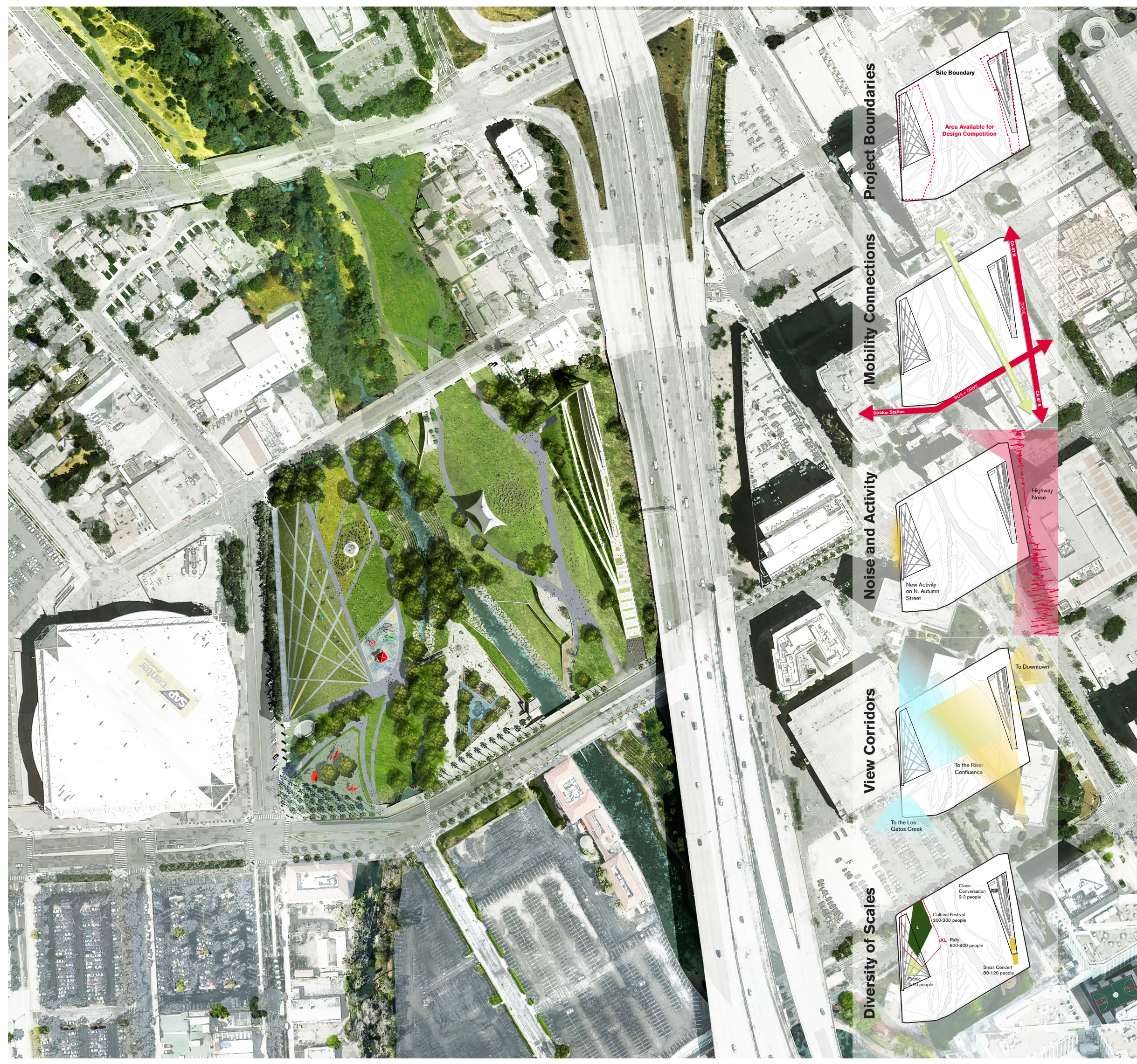

**An Urban Adventure**  
The Valley presents visitors with the opportunity to experience something new each visit.

**Weaving the Life of the City Together**



# Two Peaks, One Transformative Public Amenity



The project can be constructed to take advantage of net-zero energy principles by using the ample area of the mountains for photovoltaic panels, capturing stormwater runoff, and making use of building products which minimize their carbon footprint.



Hayes Hall



View from Downtown

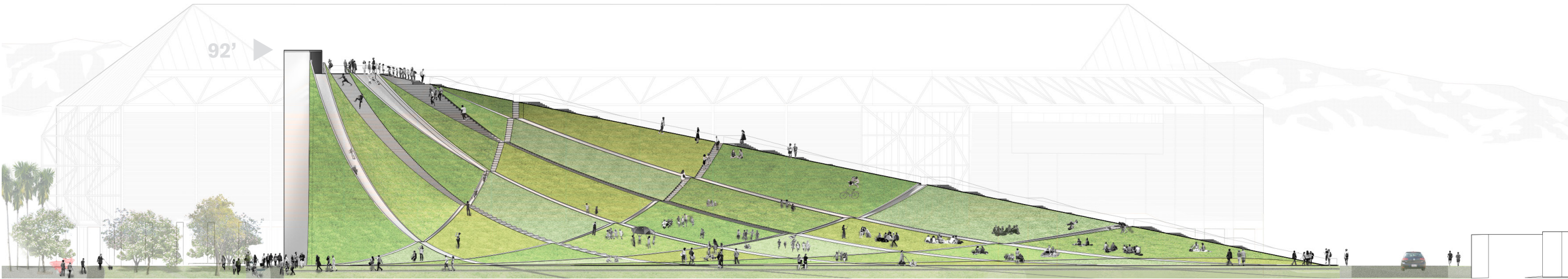

## Hayes Hill

Situated directly across from the SAP Center, Hayes Hill provides a marquee attraction for people of all ages. The western portion of the Valley is named after Janet Gray Hayes, former mayor of San Jose and the first female mayor of a major US city. Hayes Hill represents Mayor Hayes' love of the outdoors by creating a sloped lawn that can be enjoyed by anyone. The slope is divided into individual patches of lawn by a network of chutes and ladders which form the best playground you've ever seen. Families can post up for a picnic while kids climb up and slide down the play features, allowing them to constantly move up and down the hill. On the underside of the structure, a new public indoor hall provides space for local stores and food vendors and connects Arena Green with the year-round activities of the neighboring SAP Center.

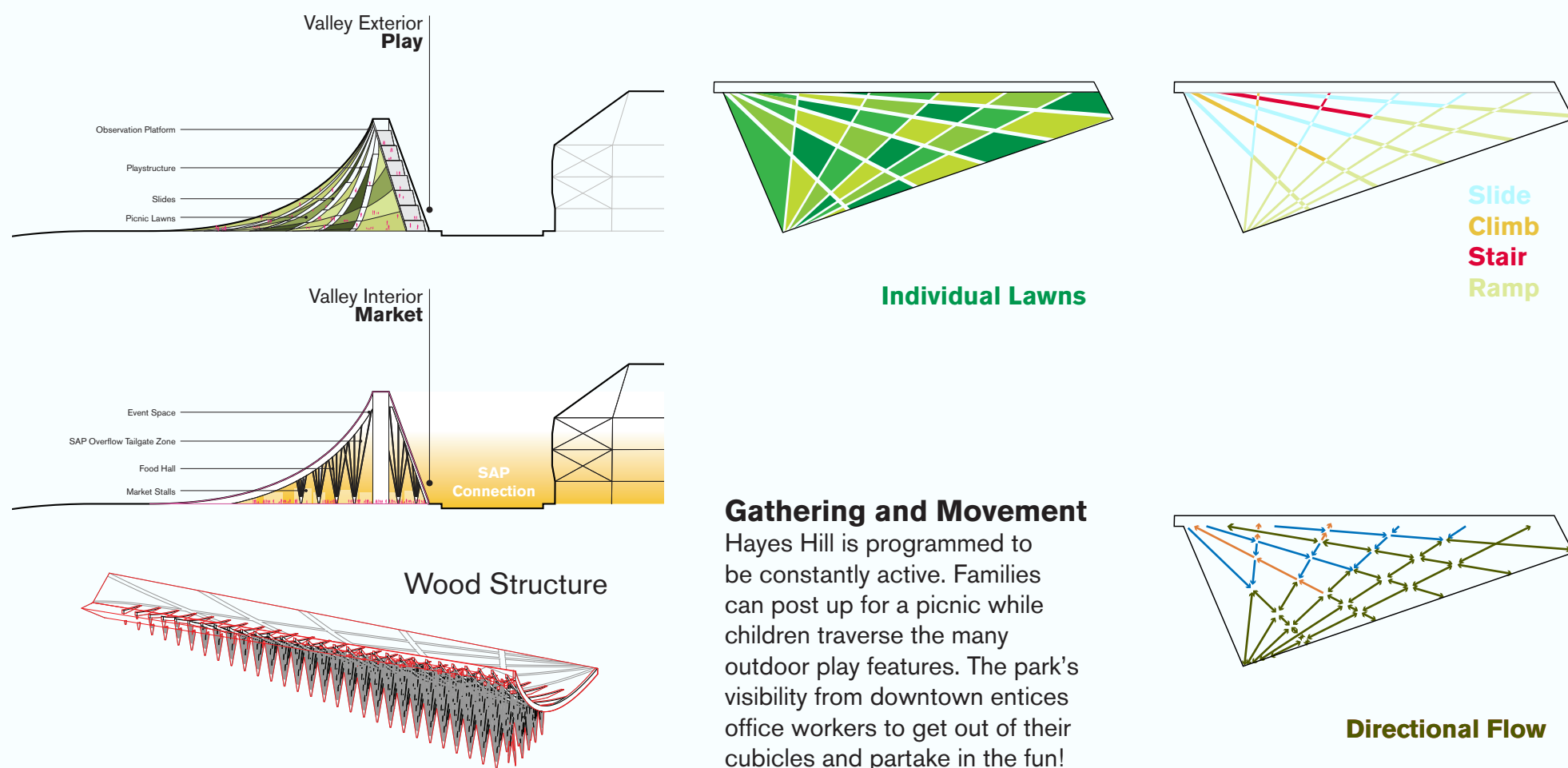

## A Park for the People

Everyone deserves access to healthy and inclusive public spaces, but the COVID pandemic has highlighted that access is not attainable for many. Arena Green's central location, connections to public transportation and roads, and adjacency to major urban nodes allows The Valley to fill a need for a must-see attraction downtown. Instead of simply using the existing park as a site, it reimagines what Arena Green could be as a public open space. Currently, Arena Green lacks a sense of cohesion and its many features remain socially and physically disconnected. In establishing hills on either side of the Guadalupe River, the project refocuses the park towards the water at the park's center. By lifting up the ground to form either slope, the Valley also provides quality facilities fitting the energy and growth of Downtown San Jose.

Fundamental to the proposal is that Arena Green's existing facilities do not have to be removed. Instead, we can improve what exists in the park moving bathrooms and commercial space under Hayes Hill, creating a more active street in front of the SAP Center. Simultaneously, lifting up the ground at Mount Lola allows us to keep the sports that bring people together underneath and allowing play - rain or shine. Additionally, we feel strongly that these spaces should provide improved amenities such as public washrooms and shower facilities for the homeless and vulnerable members of the community who currently rely on Arena Green for their basic needs.

## Mount Iola

Named after Iola Williams, San Jose's first black City Council member, Franklin McKinley School District board member, and Vice Mayor, Mount Iola provides visitors the opportunity to hike to the top of the city. Planned around an ADA accessible path that crisscrosses the slope, Mount Iola brings the California hiking experience to the heart of downtown San Jose, making the staple Northern Californian pastime accessible all. Hikers ascend through a series of California's iconic landscapes and the rich variety of plant life that thrives at different elevations. Along their way, visitors may rest at one of several lookout balconies, from where they may experience the hanging installation art and athletic courts which take advantage of the structure's underside to provide a contrasting space of activity and culture. At the summit, visitors are welcomed by immediate views of downtown San Jose, where Iola Williams worked to improve the lives of all San Jose residents, regardless of race, sex, or religion.

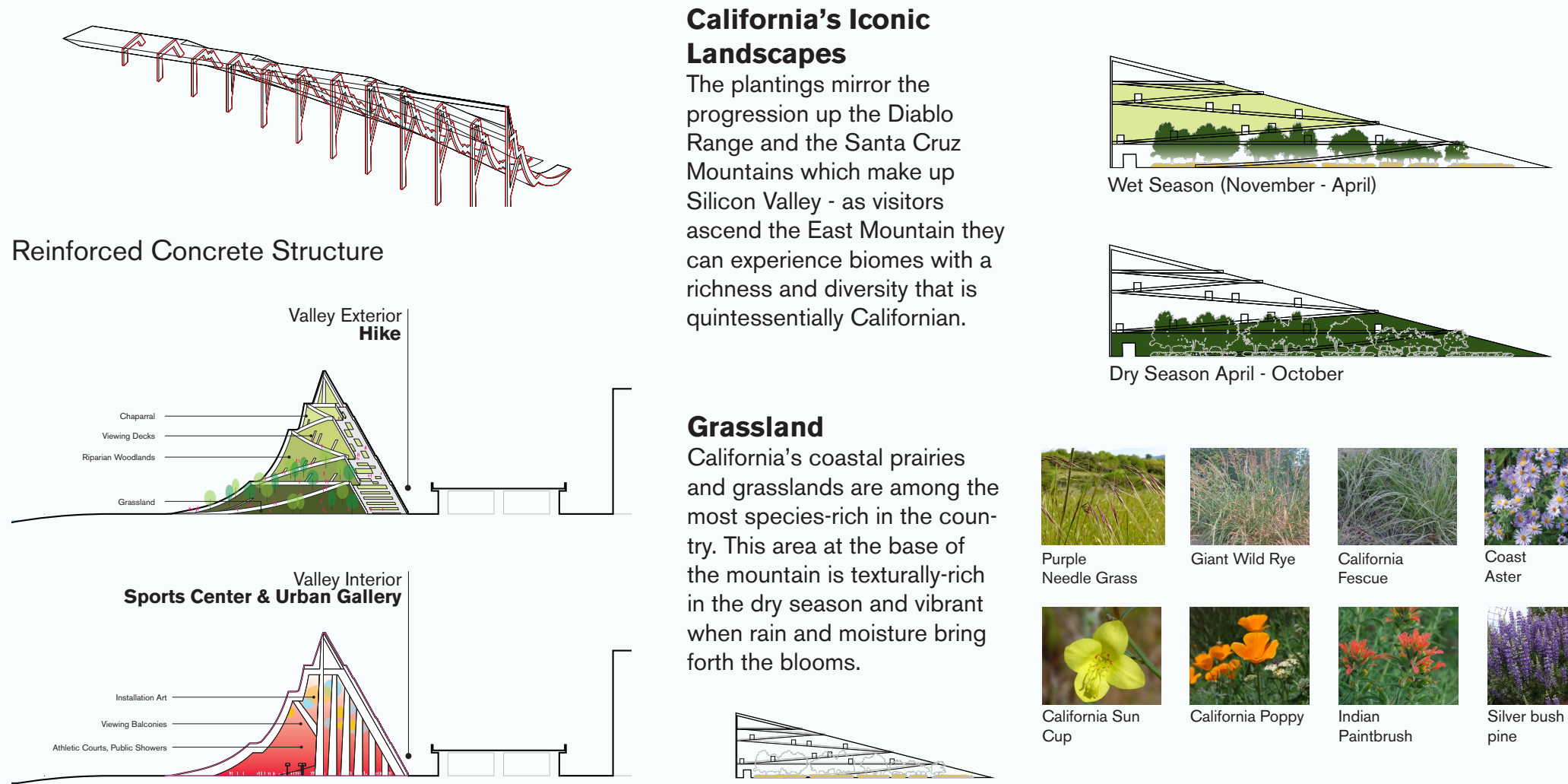

### Riparian Woodlands

Arena Green, and the banks of the river confluence were once extensive riparian woodlands. Restoring the woodland creates a shady respite at the base of the mountain for those starting or ending their journeys.

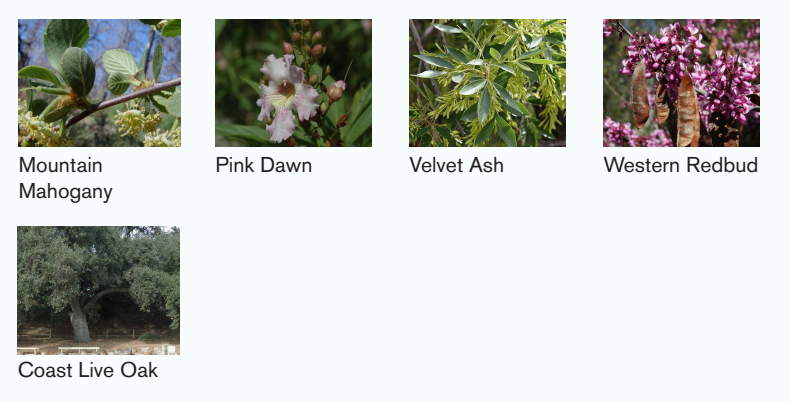

### Chaparral

Chaparral is most commonly seen on the side of the highway but by lifting this ubiquitous environment up above the park, visitors can get a firsthand experience of the exceptional textures and colors of chaparral.

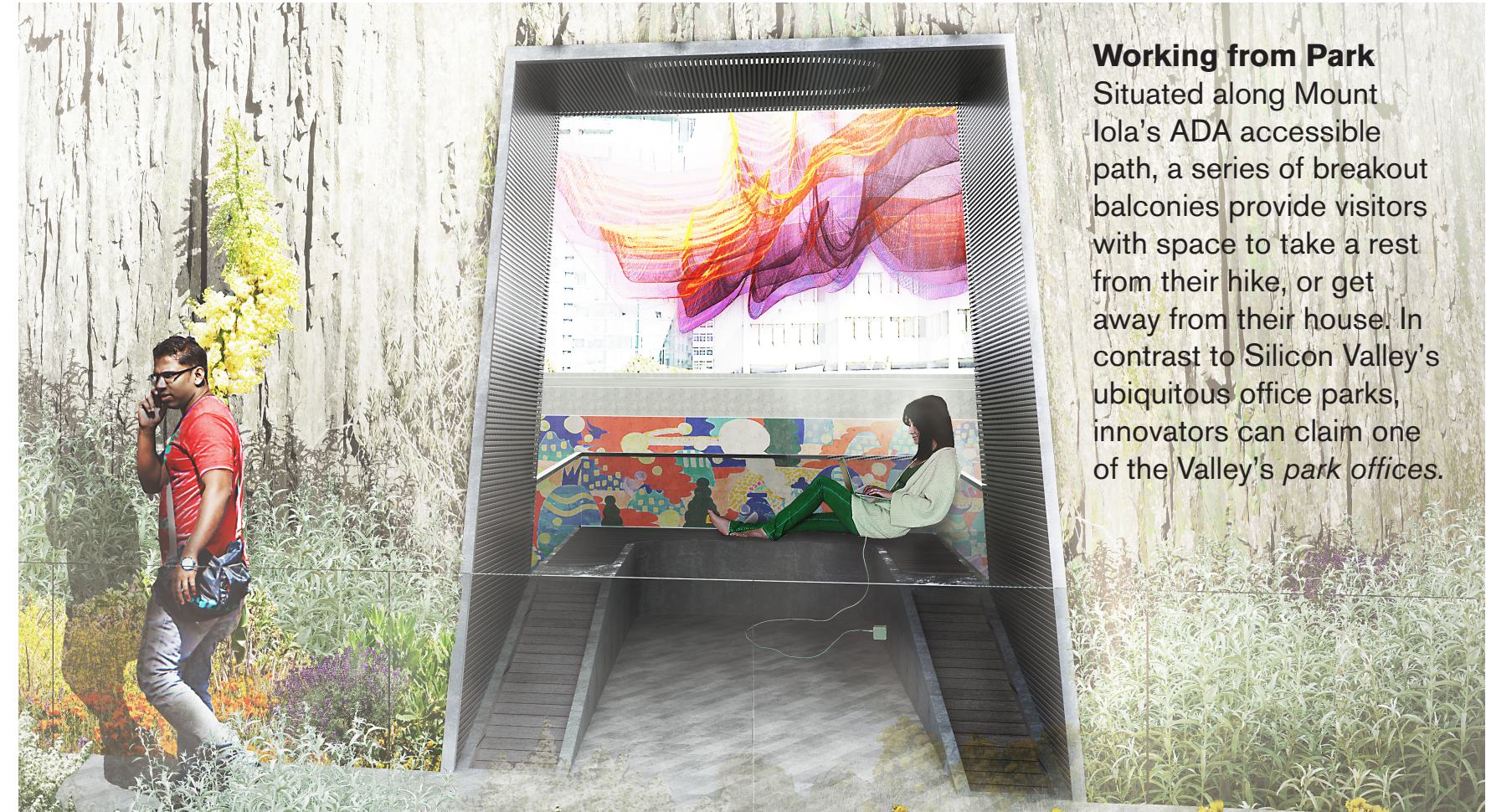
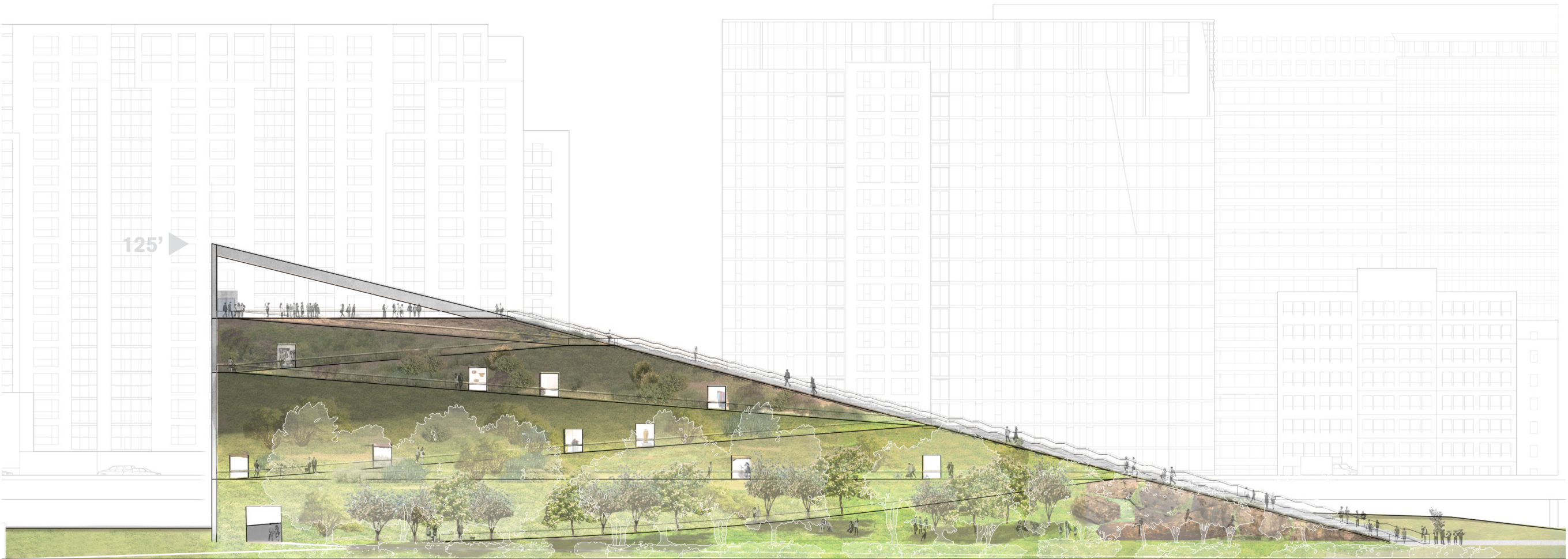
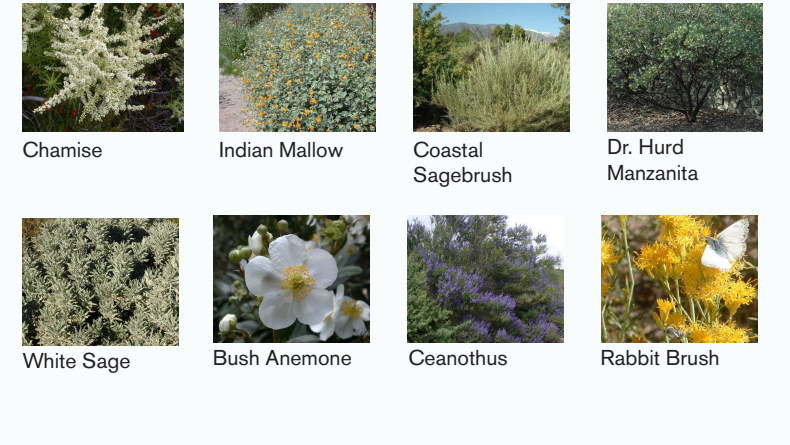

**Working from Park**

Situated along Mount Iola's ADA accessible path, a series of breakout balconies provide visitors with space to take a rest from their hike, or get away from their house. In contrast to Silicon Valley's ubiquitous office parks, innovators can claim one of the Valley's park offices.



**The Steps to the City**

Visitors to Mount Iola have the choice of traversing along the ridge, along the slope, or by elevator. Regardless of how one decides to reach the top, everyone is met with views of the region previously only visible from private property.

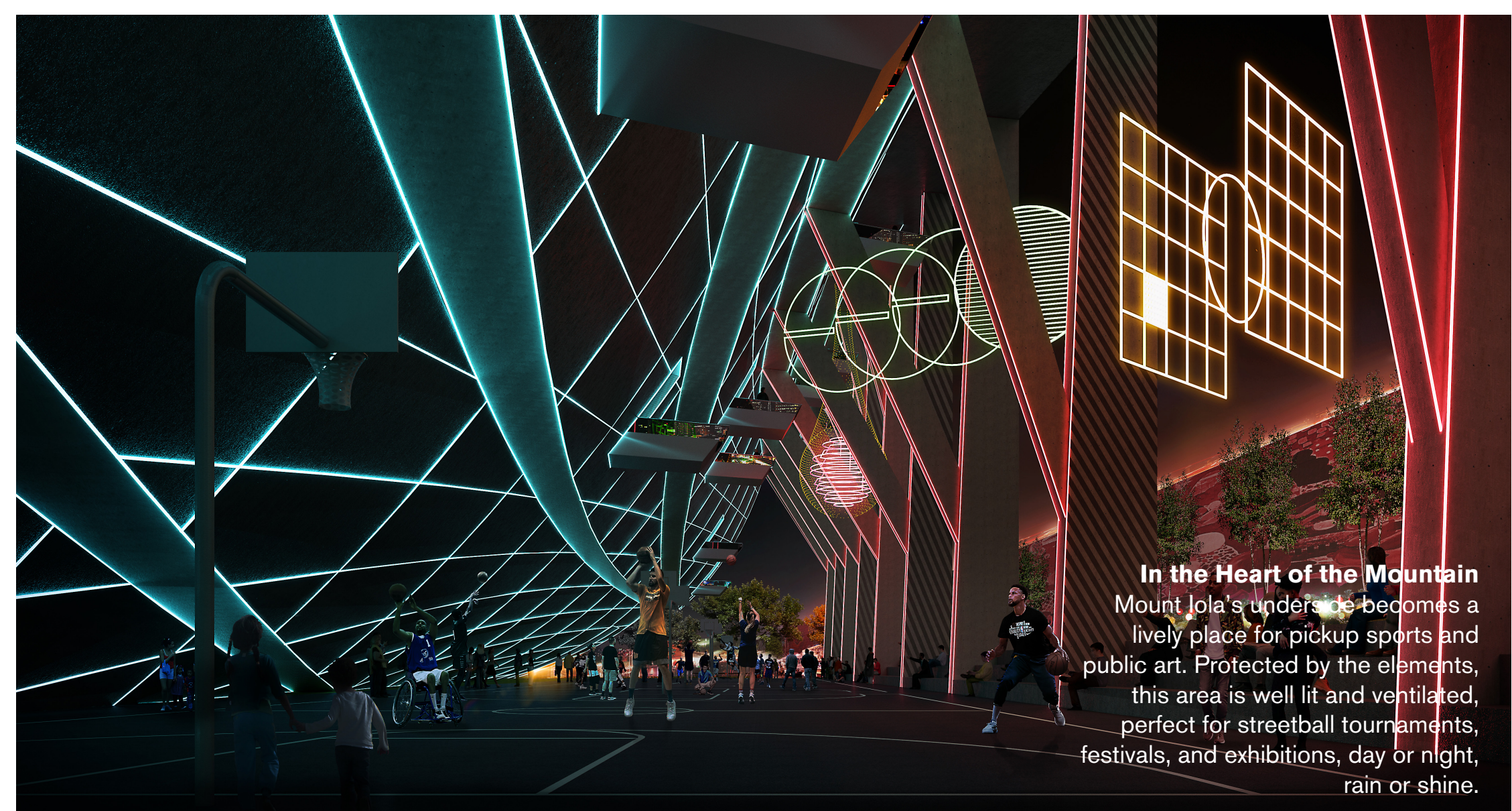

**In the Heart of the Mountain**

Mount Iola's underside becomes a lively place for pickup sports and public art. Protected by the elements, this area is well lit and ventilated, perfect for streetball tournaments, festivals, and exhibitions, day or night, rain or shine.