

INFLUERE TOWER

"Influence" comes from the Latin, "influe" which means "to flow into". Post-Roman Era Latin introduced the term "influentia" which became "influence" in the French, which is where the English language took it.

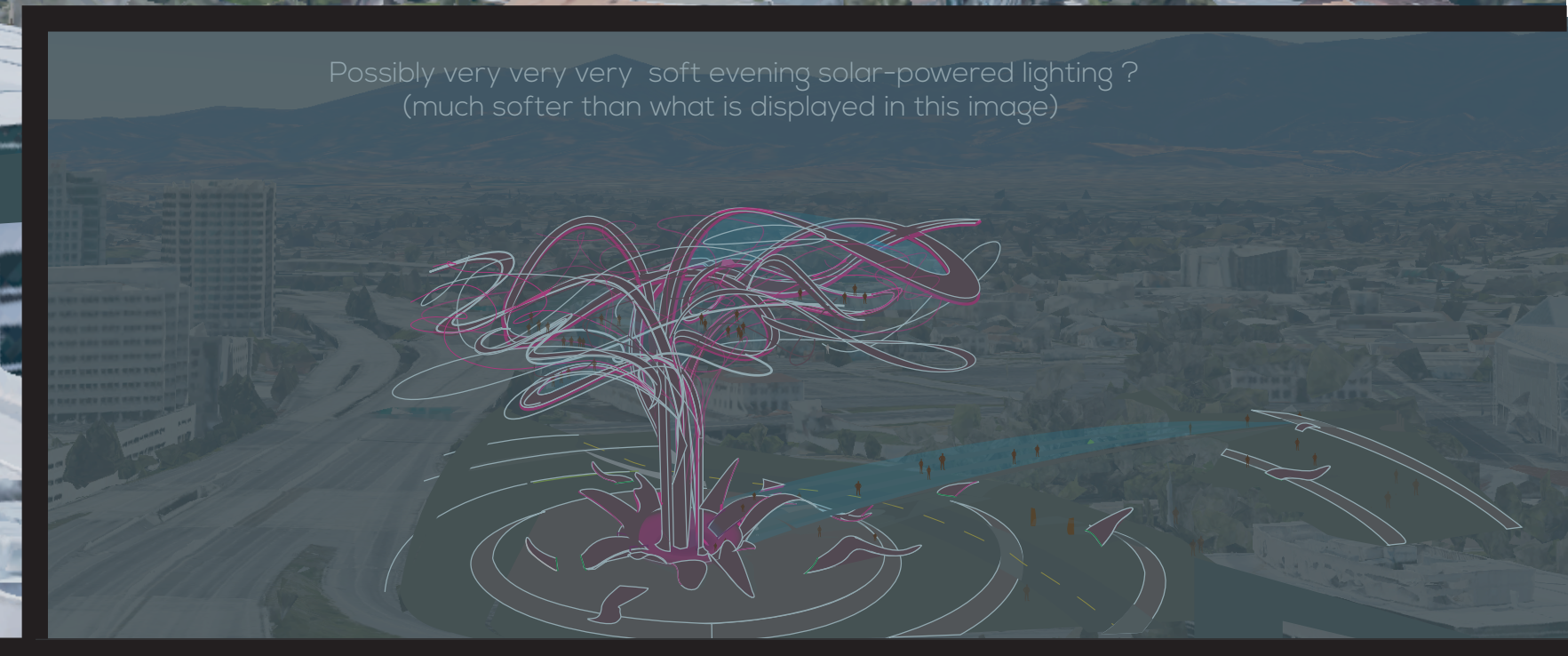

CONCEPTUAL IDEA (Ideal situation)

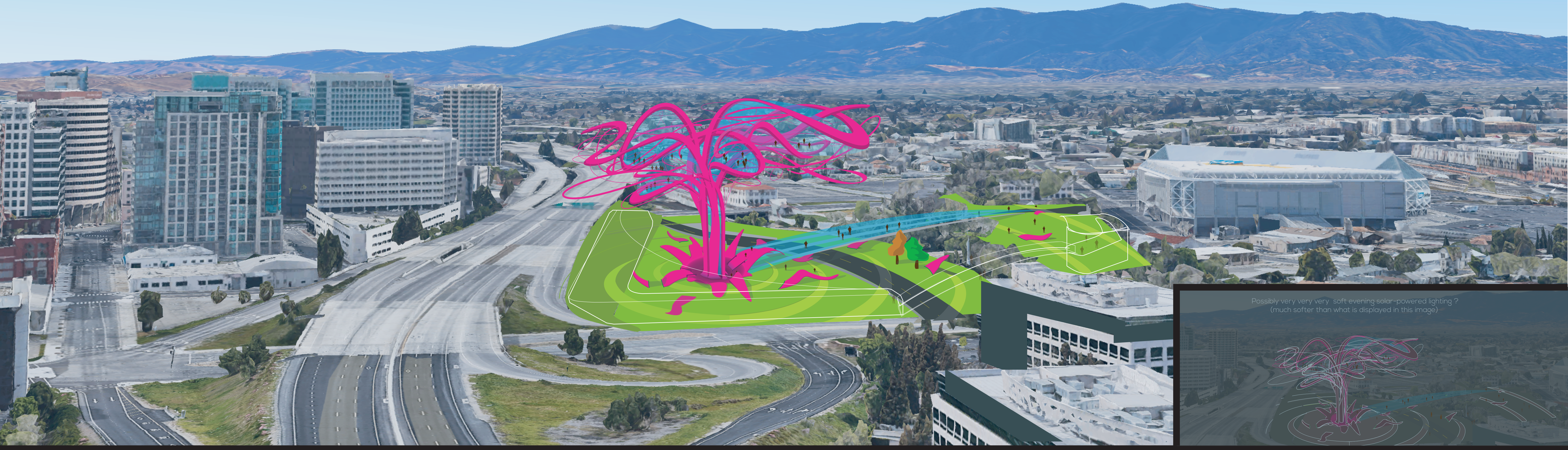
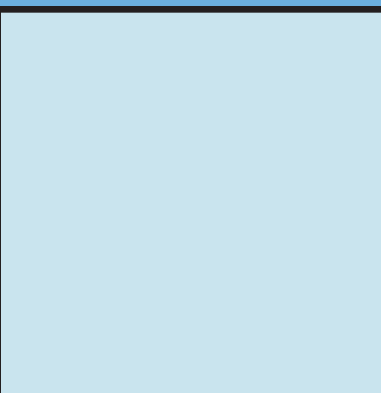
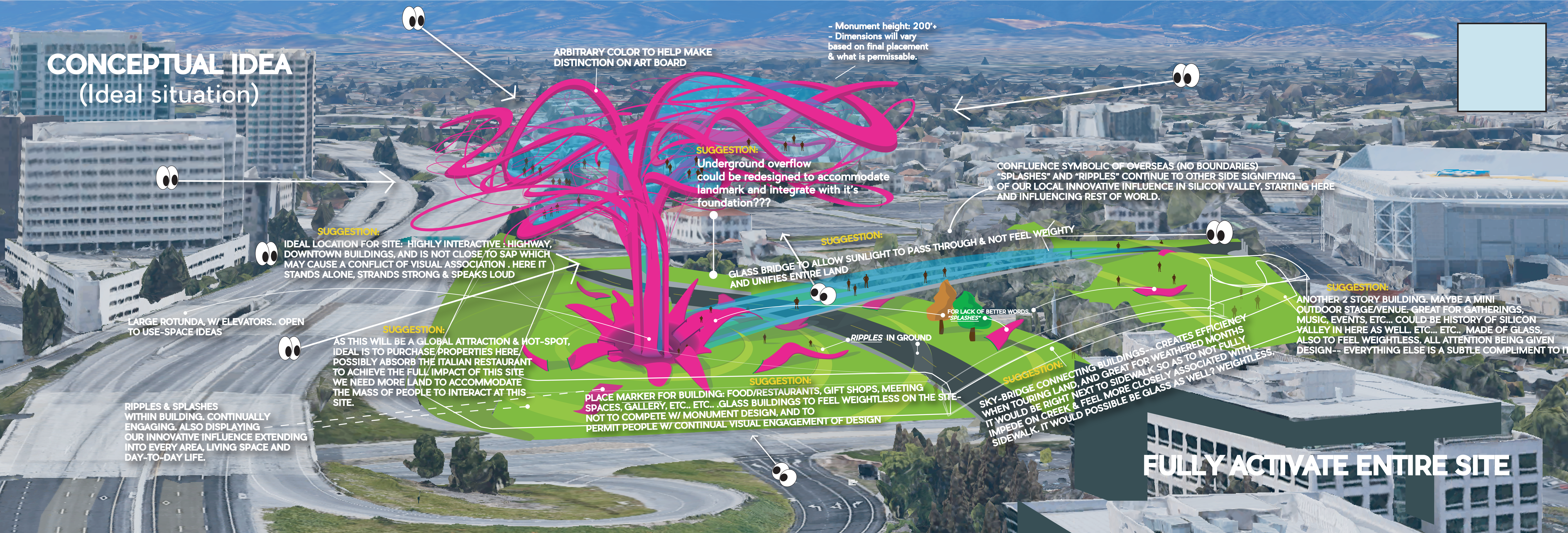

- Monument height: 200'+
- Dimensions will vary based on final placement & what is permissible.

ARBITRARY COLOR TO HELP MAKE DISTINCTION ON ART BOARD

SUGGESTION:
Underground overflow could be redesigned to accommodate landmark and integrate with it's foundation???

CONFLUENCE SYMBOLIC OF OVERSEAS (NO BOUNDARIES) "SPLASHES" AND "RIPPLES" CONTINUE TO OTHER SIDE SIGNIFYING OF OUR LOCAL INNOVATIVE INFLUENCE IN SILICON VALLEY, STARTING HERE AND INFLUENCING REST OF WORLD.

SUGGESTION:
IDEAL LOCATION FOR SITE: HIGHLY INTERACTIVE: HIGHWAY, DOWNTOWN BUILDINGS, AND IS NOT CLOSE TO SAP WHICH MAY CAUSE A CONFLICT OF VISUAL ASSOCIATION. HERE IT STANDS ALONE, STRANDS STRONG & SPEAKS LOUD

SUGGESTION:
GLASS BRIDGE TO ALLOW SUNLIGHT TO PASS THROUGH & UNIFIES ENTIRE LAND

SUGGESTION:
ANOTHER 2 STORY BUILDING. MAYBE A MINI OUTDOOR STAGE/VENUE. GREAT FOR GATHERINGS, MUSIC, EVENTS, ETC... COULD BE HISTORY OF SILICON VALLEY IN HERE AS WELL. ETC... ETC... MADE OF GLASS, ALSO TO FEEL WEIGHTLESS. ALL ATTENTION BEING GIVEN DESIGN-- EVERYTHING ELSE IS A SUBTLE COMPLIMENT TO IT

LARGE ROTUNDA, W/ ELEVATORS.. OPEN TO USE-SPACE IDEAS

SUGGESTION:
AS THIS WILL BE A GLOBAL ATTRACTION & HOT-SPOT, IDEAL IS TO PURCHASE/PROPERTIES HERE, POSSIBLY ABSORB THE ITALIAN RESTAURANT TO ACHIEVE THE FULL IMPACT OF THIS SITE WE NEED MORE LAND TO ACCOMMODATE THE MASS OF PEOPLE TO INTERACT AT THIS SITE.

SUGGESTION:
PLACE MARKER FOR BUILDING: FOOD/RESTAURANTS, GIFT SHOPS, MEETING SPACES, GALLERY, ETC.. ETC.. .GLASS BUILDINGS TO FEEL WEIGHTLESS ON THE SITE- NOT TO COMPETE W/ MONUMENT DESIGN, AND TO PERMIT PEOPLE W/ CONTINUAL VISUAL ENGAGEMENT OF DESIGN

SUGGESTION:
SKY-BRIDGE CONNECTING BUILDINGS-- CREATES EFFICIENCY WHEN TOURING LAND, AND GREAT FOR WEATHERED MONTHS IT WOULD BE RIGHT NEXT TO SIDEWALK SO AS TO NOT FULLY IMPEDE ON CREEK & FEEL MORE CLOSELY ASSOCIATED WITH SIDEWALK. IT WOULD POSSIBLE BE GLASS AS WELL? WEIGHTLESS.

RIPPLES & SPLASHES WITHIN BUILDING. CONTINUALLY ENGAGING. ALSO DISPLAYING OUR INNOVATIVE INFLUENCE EXTENDING INTO EVERY AREA, LIVING SPACE AND DAY-TO-DAY LIFE.

FULLY ACTIVATE ENTIRE SITE

FULLY OPEN TO COLLABORATIVE RE-DESIGN-- THIS IS JUST A CONCEPTUAL ROUGH DESIGN-IDEA & RENDERING
LOCATION: DESIGN CAN BE PLACED ANYWHERE ON PROPERTY- I PLACED IT IN WHAT I BELIEVE TO BE THE IDEAL LOCATION
LANDSCAPE & BUILDINGS: COLLABORATION & DESIGN BY PROFESSIONAL AGENCIES- THIS TO BE MAGICAL, MEMORABLE & IMPACTING
GROUND: OPEN TO MATERIALS & DESIGN & LANDSCAPE
MONUMENT DESIGN MATERIALS & COLOR: OPEN TO MATERIALS AND COLOR, TEXTURE. POSSIBLY HYDRO-FORMED ALUMINUM OR CONCRETE & MIXED MEDIA
RIPPLES: PHYSICALLY ENGAGING ON FOOT AND VISUALLY ENGAGING FROM AIRPLANE
DESIGN SPLASH & RIPPLES: ACROSS SITE. TOTAL ENGAGEMENT WITH DESIGN FROM ALL POINTS, EVEN WITHIN BUILDINGS. SPLASHES ACT ARE SCULPTURES ACROSS LANDSCAPE
GREEN: I'M FULLY ON BOARD TO MAKE THIS PIECE & ENTIRE SITE FULLY GREEN, SELF-SUSTAINING WITH "NET-ZERO ENERGY STRATEGY DESIGN"
TIMELESS: I WOULD SUGGEST THE SITE BE CONSTRUCTED WITH TIMELESSNESS IN MIND & NOT CAUGHT UP IN TECH SO MUCH IT COULD BECOME ARCHAIC IN FUTURE YEARS CONSIDERING OUR CONTINUAL PROGRESSION IN TECH.

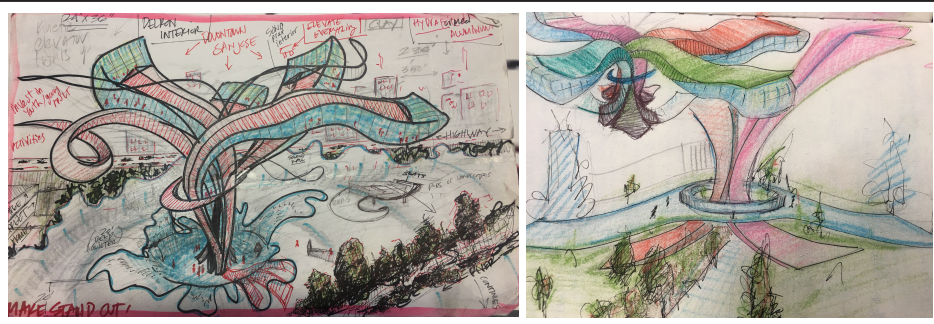

Couple random provoking ideas

THE ABSTRACT REALM OF: INFINITE, IMPOSSIBLE, INTANGIBLE, BEYOND, UNIMAGINABLE, UNCOMPREHENDING, INARTICULABLE, CREATIVE, BOUNDLESS, BORDER-LESS, HEAVENLY, NEVER SEEN, IMPROBABLE, ETC...

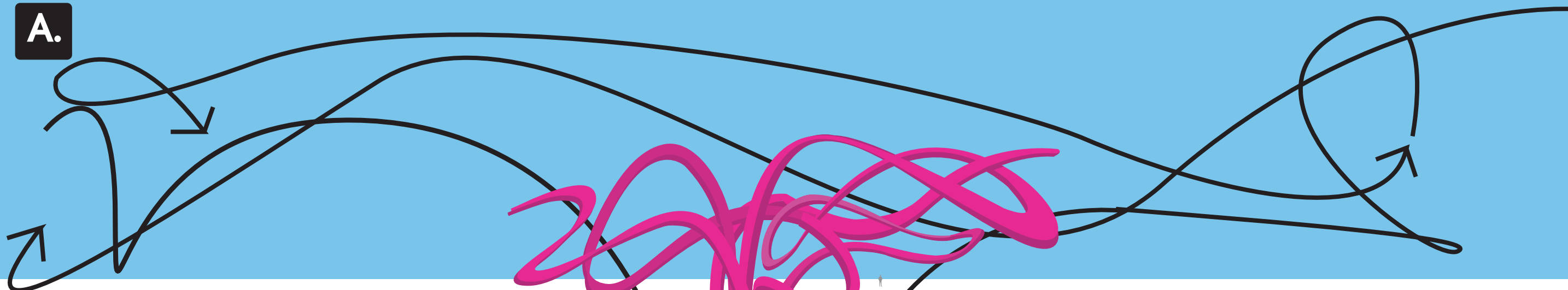

THE UNSEEN MEMBRANE THAT SEPARATES WHAT IS MEMBRANE & PULLING INNOVATIVE IDEAS FROM THE POSSIBLE FROM WHAT ISN'T. BREAKING THROUGH THIS IMPOSSIBLE INTO THE POSSIBLE

THE NATURAL REALM: PRAGMATIC, SYSTEMATIZED, UNDERSTOOD, DOABLE ETC..

ARTICULABLE, TANGIBLE, HUMANLY, POSSIBLE, MANAGEABLE, ATTAINABLE,

INNOVATIVE INFLUENCE RIPPLING TO THE 4-CORNERS OF EARTH

C. SILICON VALLEY THE MECCA OF GLOBAL INNOVATIVE INFLUENCE

E. CONFLUENCE
SYMBOLIC OF OVERSEAS: BORDER-LESS INFLUENCE

F. RIPPLES CONTINUE AS OUR INNOVATIVE INFLUENCE REACHES TO THE REMOTEST REGIONS OF EARTH

ANATOMY OF DESIGN

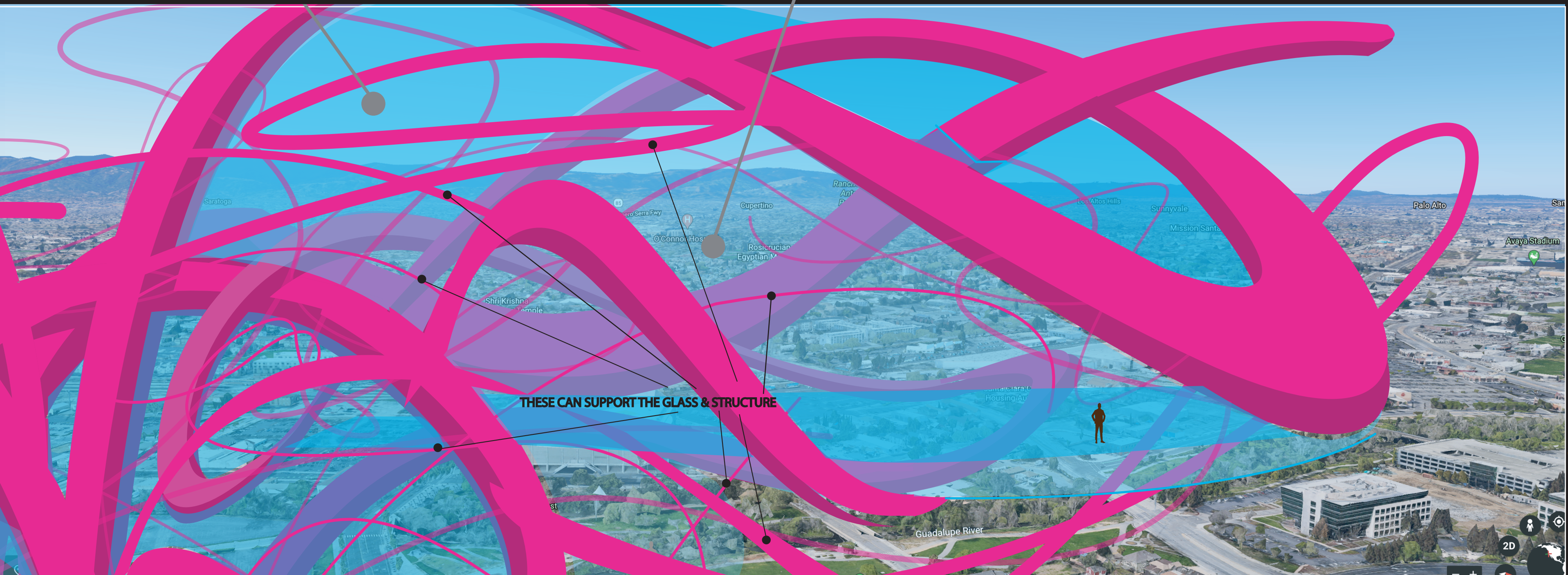

THESE CAN SUPPORT THE GLASS & STRUCTURE