

▲ INTERIOR OF THE LANDMARK

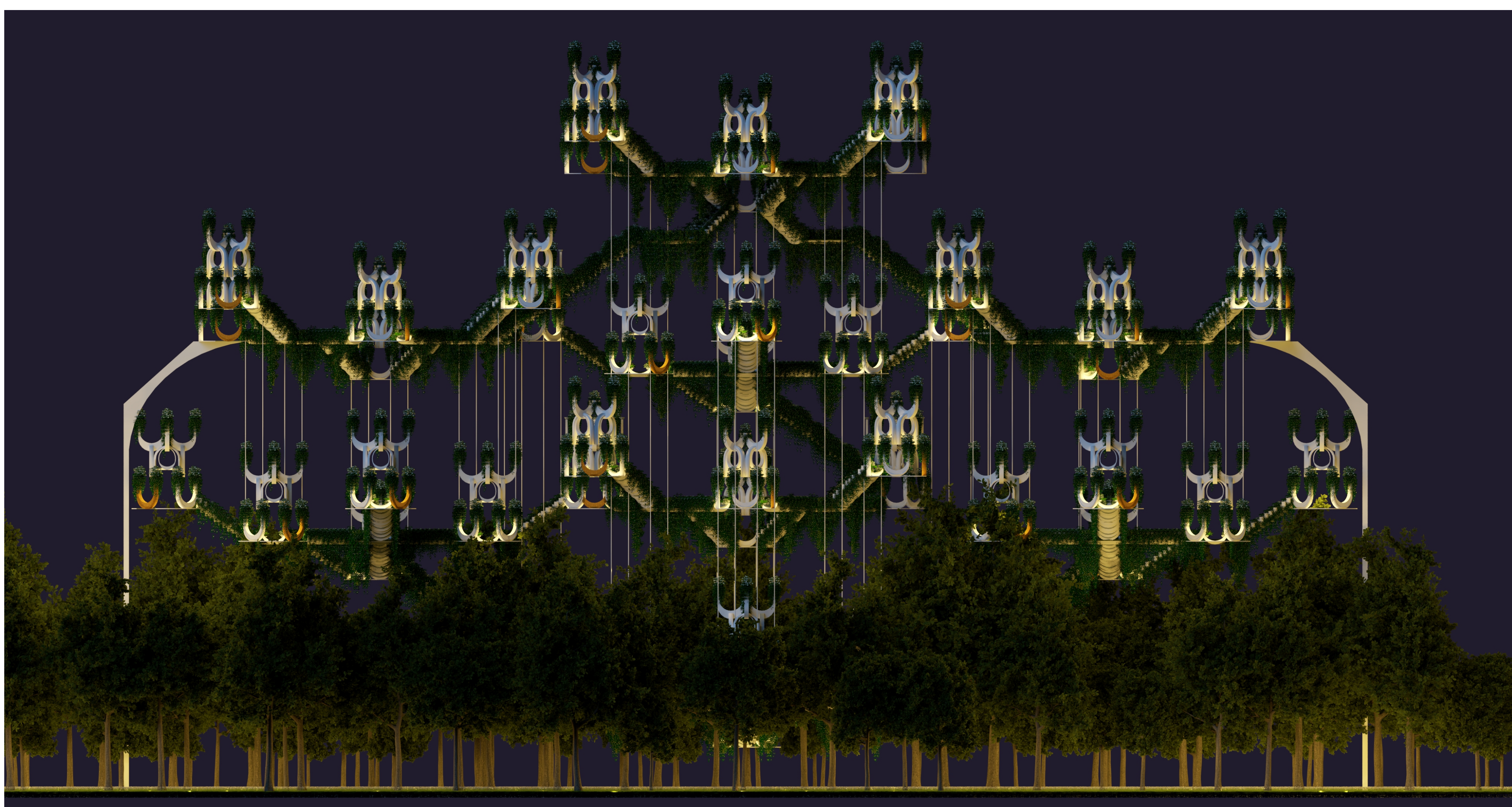

165'

▲ ELEVATION

TOGETHER WITH 8 NOS. OF MODULE 2, REPEATED AT VARIOUS LEVELS, WE GET THE LANDMARK



▲ MODULE 1



▲ TOGETHER WITH 9 MODULES, MODULE 2 IS FORMED

CONCEPT

Suspended inverted arches. Inverted arches represent the valley not only in the form but also in the open mind set of the community here - open to explore the unknown and take chances, open to innovation, open to interaction and form meaningful relations with people, open to diverse community with open arms just like the inverted arches open ended.

ABOUT THE PROJECT

The landmark is an inspirational and meaningful structure by its ability to invite people - locals, tourists and employees working nearby, to unwind and connect and network with a diverse community. Also, the site forms a central point of the future development plan. The flexibility of the usage of space makes it more viable an option for various events and exhibitions. This resonates with Silicon Valley, since the valley is a place of innovation and a place for connection and networking with a diverse community. The landmark is not only beautiful to look at, but equally enchanting to be a part of it, with its inverted arches, and climbers, which give its a rustic surreal beauty.

The landmark is 10ft above the ground, making it appear to be a floating structure, with an access from stairs wrapped around the trees. Use of Dye Sensitized Solar Cells for energy. The Dye is of natural pigments. Here, green dye shall be used, which camouflages with the plants which are on the landmark. Dye Sensitized Solar Cells do not cause glare and does no harm to the migratory birds

The landmark is an open structure. Thus, birds can also fly through and through without any harm. Structural support system is of mirror glazing to merge it with the surrounding efficiently.

As for the existing trees on the site, there shall be no need to cut the trees. The trees provide the cover for the structural elements and also provide an access to the landmark by the means of stairs wrapped around the them.

The landmark is designed in the West area of the Arena green. The Five Skater's area is respected and remains untouched.



