



MISSION FLOOR PLAN DESIGNS



MISSION FLOOR PLANS



SANTA CLARA | PAGE 4

2,933 Approx. Square Feet
4 – 5 Beds 2 – 3-Car Garage
3 Baths 2-Story Home



PALMA | PAGE 8

2,301 Approx. Square Feet
4 – 5 Beds 2-Car Garage
2.5 – 3 Baths 2-Story Home



CATALINA | PAGE 20

1,659 Approx. Square Feet
3 Beds 2-Car Garage
2 Baths 1-Story Home



CABRERA | PAGE 24

1,505 Approx. Square Feet
3 Beds 2-Car Garage
2 Baths 1-Story Home



MENORCA | PAGE 12

1,945 Approx. Square Feet
3 – 4 Beds 2-Car Garage
2 Baths 1-Story Home



IBIZA | PAGE 16

1,808 Approx. Square Feet
4 Beds 3-Car Garage
2 Baths 1-Story Home



ALEGRANZA | PAGE 28

1,406 Approx. Square Feet
3 Beds 2-Car Garage
2 Baths 1-Story Home

For a collection of photography
and virtual tours of our floor plans,
visit our Gallery at gehanhomes.com.



Plans, options and features may vary by
community. See Sales Associate for details.

SANTA CLARA

2,933 Approx. Square Feet

4 – 5 Beds
3 Baths

2 – 3-Car Garage
2-Story Home

Options

5th Bedroom



Spanish Colonial

ELEVATION OPTIONS



Tuscan



Craftsman

SANTA CLARA | FIRST FLOOR PLAN



Optional Bedroom 5

SANTA CLARA | SECOND FLOOR PLAN



PALMA

2,301 Approx. Square Feet

4 – 5 Beds 2-Car Garage
2.5 – 3 Baths 2-Story Home

Options

5th Bedroom with 3rd Bathroom



Spanish Colonial

ELEVATION OPTIONS



Tuscan



Craftsman

PALMA | FIRST FLOOR PLAN



PALMA | SECOND FLOOR PLAN



MENORCA

1,945 Approx. Square Feet

3 – 4 Beds
2 Baths

2-Car Garage
1-Story Home

Options

4th Bedroom



Spanish Colonial

ELEVATION OPTIONS



Tuscan



Craftsman

MENORCA | FIRST FLOOR PLAN



MENORCA | FLOOR PLAN OPTIONS



*Optional
Bedroom 4*

IBIZA

1,808 Approx. Square Feet

4 Beds 3-Car Garage
2 Baths 1-Story Home

Options

Pocket Office



Spanish Colonial

ELEVATION OPTIONS



Tuscan



Craftsman

IBIZA | FIRST FLOOR PLAN



IBIZA | FLOOR PLAN OPTIONS

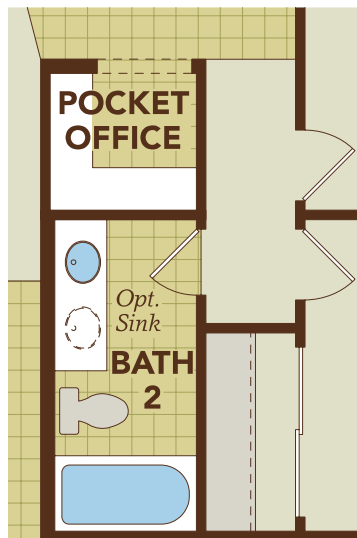

*Optional
Pocket Office*

CATALINA

1,659 Approx. Square Feet

3 Beds 2-Car Garage
2 Baths 1-Story Home



Spanish Colonial

ELEVATION OPTIONS



Tuscan



Craftsman

CATALINA | FIRST FLOOR PLAN



CABRERA

1,505 Approx. Square Feet

3 Beds
2 Baths

2-Car Garage
1-Story Home

Options

Pocket Office



Spanish Colonial

ELEVATION OPTIONS



Tuscan



Craftsman

CABRERA | FIRST FLOOR PLAN



CABRERA | FLOOR PLAN OPTIONS

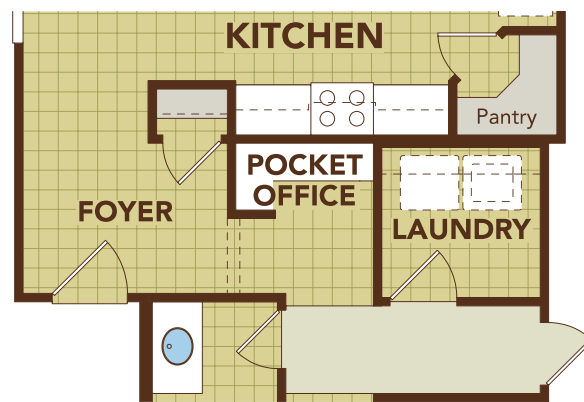

Optional Pocket Office

ALEGRANZA

1,406 Approx. Square Feet

3 Beds
2 Baths

2-Car Garage
1-Story Home

Options

Pocket Office



ELEVATION OPTIONS



Spanish Colonial



Tuscan



Craftsman

ALEGRANZA | FIRST FLOOR PLAN



ALEGRANZA | FLOOR PLAN OPTIONS

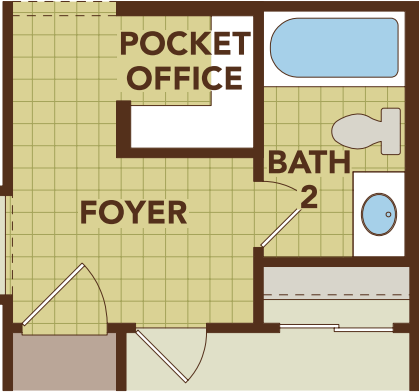

*Optional
Pocket Office*

HAPPINESS LIVES ✨ HERE

©2021 Gehan Homes. All rights reserved.

Pricing, features, options, amenities, floor plans, elevations, designs, materials and dimensions are subject to change without notice. Square footage and dimensions are estimated and may vary in actual construction. Pictures and other images are representative and may depict or contain floor plans, square footages, elevations, options, upgrades, landscaping, furnishings, appliances and features that are not included as part of the home and/or may not be available in all communities. Architectural dimensions shown are nominal interior dimensions; room sizes, window placement and other dimensions may vary from these drawings. This brochure is for illustration purposes; it is not part of a legal contract. We reserve the right to change product features, brand names, architectural design and details. The floor plans and elevations of all Gehan Homes are copyrighted. We have enforced and will continue to enforce our Federal Copyrights to protect the investment of our homebuyers. Gehan Homes of Arizona, LLC, AZ ROC # 281891. **REV 04.13.21**