

Escape 5.0

BASE FEATURES & OPTIONS CONFIGURATION GUIDE



Escape
TRAILER Built for you.



Escape 5.0 CONFIGURING YOUR ESCAPE

Our team at Escape Trailer is customer-centric, proud of our products, service, and most of all the experience you have while building your Escape. This guide will help you get started in configuring your trailer exactly the way you want it. You can use this guide to help decided on placement of the base features and options. You can also personalize your trailer by choosing between Oak, Maple, or Contemporary options for your cabinetry, and seven standard choices of countertops, upholstery, and flooring to create your perfect style.

All sample swatches shown are for illustration purpose only. Actual product may vary.

CABINETS



YOU decide on the style of cabinets throughout your trailer. Choose from Oak, Maple, or Contemporary options.

CABINET CHOICES



Please note: Both Maple and Contemporary cabinet options come with clear frosted acrylic inserts for the upper cabinet doors.

UPHOLSTERY



YOU pick your fabric from our selection of standard choices **OR** supply a custom fabric from your own source for installation.

STANDARD FABRIC CHOICES



COUNTERTOPS



YOU choose the Formica for your countertops from our seven standard selections **OR** choose from a range of Formica laminate options as well.

STANDARD COUNTERTOP CHOICES



FLOORING



YOU select your high-grade vinyl flooring from our standard choices **OR** make an optional choice.

STANDARD FLOORING CHOICES

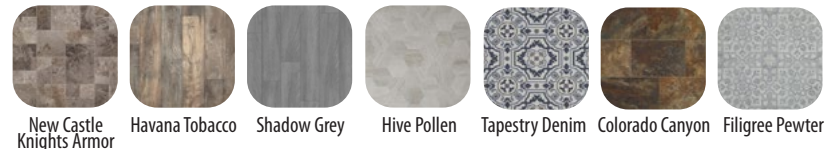

E5.0 FLOOR PLAN

REAR



FRONT

U-Shaped Dinette shown above is optional (bench seat is standard)

Escape 5.0 WINDOWS & EXTERIOR HATCH LOCATIONS

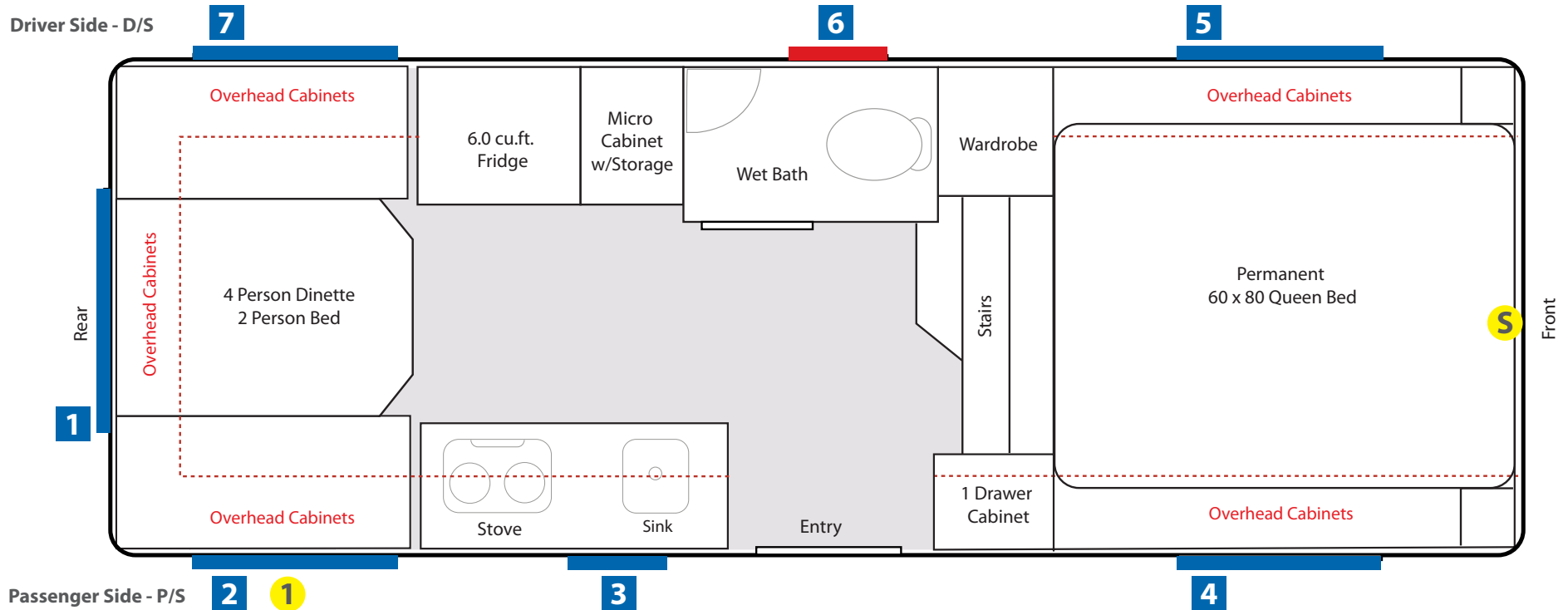

STANDARD WINDOWS

All standard windows are Thermal Double-Glazed Framed Windows with Screens.

- 1 Rear – fixed, does not open
- 2 P/S rear – dinette area, slides to open
- 3 P/S kitchen – slides to open
- 4 P/S front – bed area, slides to open
- 5 D/S front – dinette area, slides to open
- 6 D/S bathroom – slides to open **(OPTIONAL)**
- 7 D/S rear – tilts to open **(emergency exit)**

EXTERIOR ACCESS HATCHES

One standard exterior access hatch included. Storage below dinette benches is accessible under bench seats or with the two optional exterior hatch locations.

- S** Front standard – below nose of trailer
- 1** P/S rear option – allows access into the dinette bench storage from outside

THROUGHOUT THIS GUIDE

P/S = Passenger Side | D/S = Driver Side

Driver Side - D/S

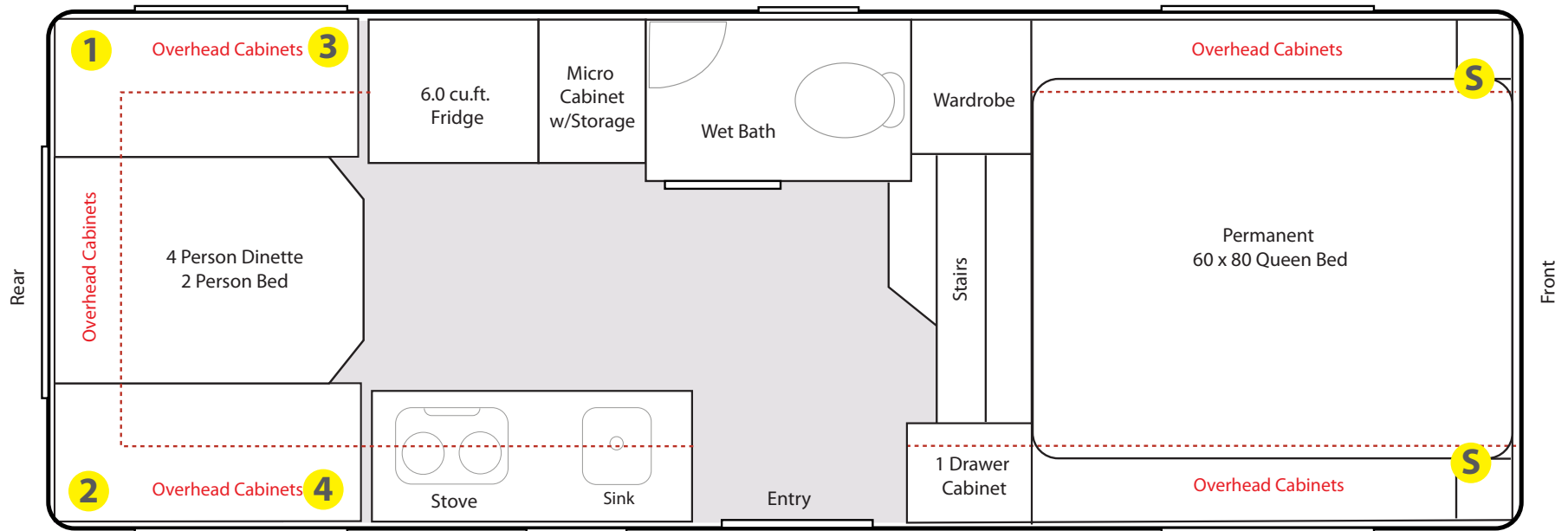

Passenger Side - P/S

● CAPTAIN'S READING LIGHTS

The optional Captain's Reading Lights mounted on the underside of the upper cabinets add additional lighting to the bed and dinette areas.

S D/S bed option – rear of bed

S P/S bed option – rear of bed

1 D/S dinette option – rear of dinette

2 P/S dinette option – rear of dinette

3 D/S dinette option – front of dinette

4 P/S dinette option – front of dinette

Escape 5.0 12V/USB & 120V OUTLET LOCATIONS

Driver Side - D/S

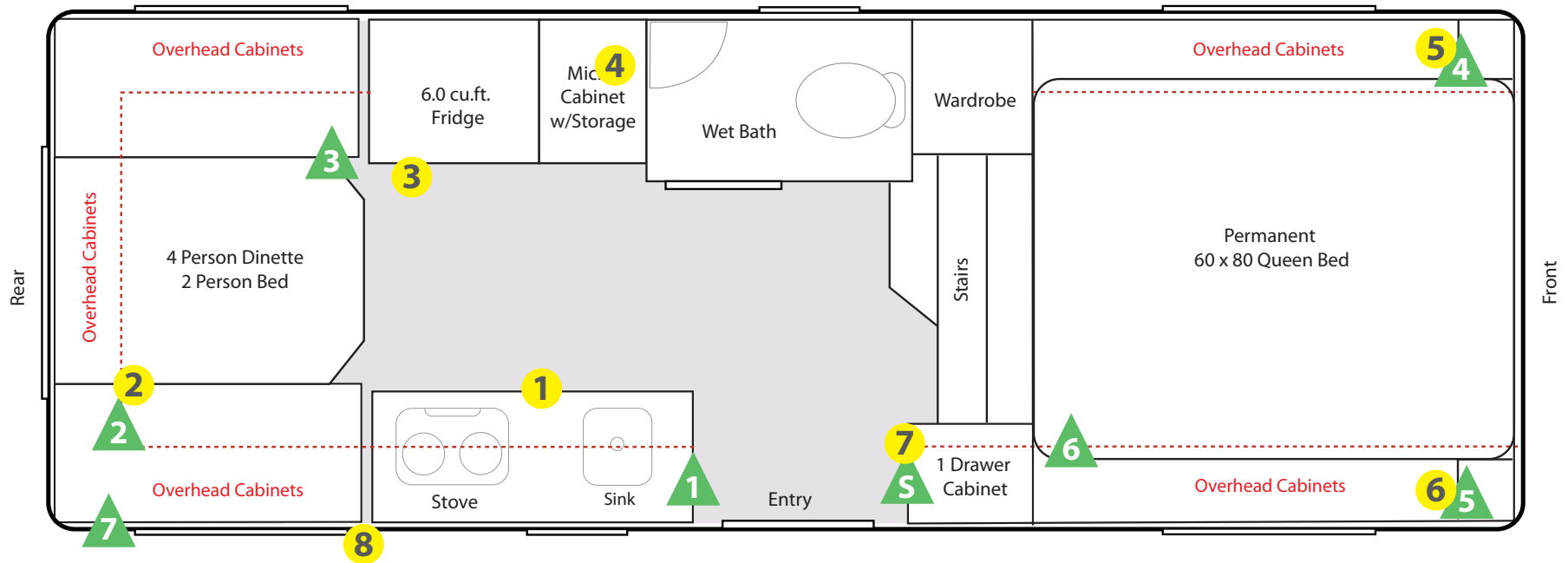

Passenger Side - P/S

▲ 12V/USB OUTLETS

- 5 Standard location – face of drawer stack to the right of the entry door just below the counter
- 1 End of P/S kitchen counter – on side of lower cabinet
- 2 Face of P/S bench face – close to rear wall
- 3 Face of D/S bench face – near fridge wall
- 4 Head of D/S bed – bottom face of beside cubby
- 5 Head of P/S bed – bottom face of beside cubby
- 6 Face of P/S overhead cabinet – at foot of bed
- 7 Exterior P/S rear – below marker light

● STANDARD 120V OUTLETS

- 1 Face of kitchen counter – below countertop
- 2 Face of P/S dinette bench – below bench seat
- 3 Face of fridge wall D/S – below fridge
- 4 In D/S microwave cabinet – inside cabinet
- 5 Head of D/S bed – bottom face of beside cubby
- 6 Head of P/S bed – bottom face of beside cubby
- 7 Face of P/S cabinet – face of drawer stack to right of entry door just below the counter beside standard 12V/USB outlet
- 8 Exterior P/S – towards rear of trailer

Driver Side - D/S

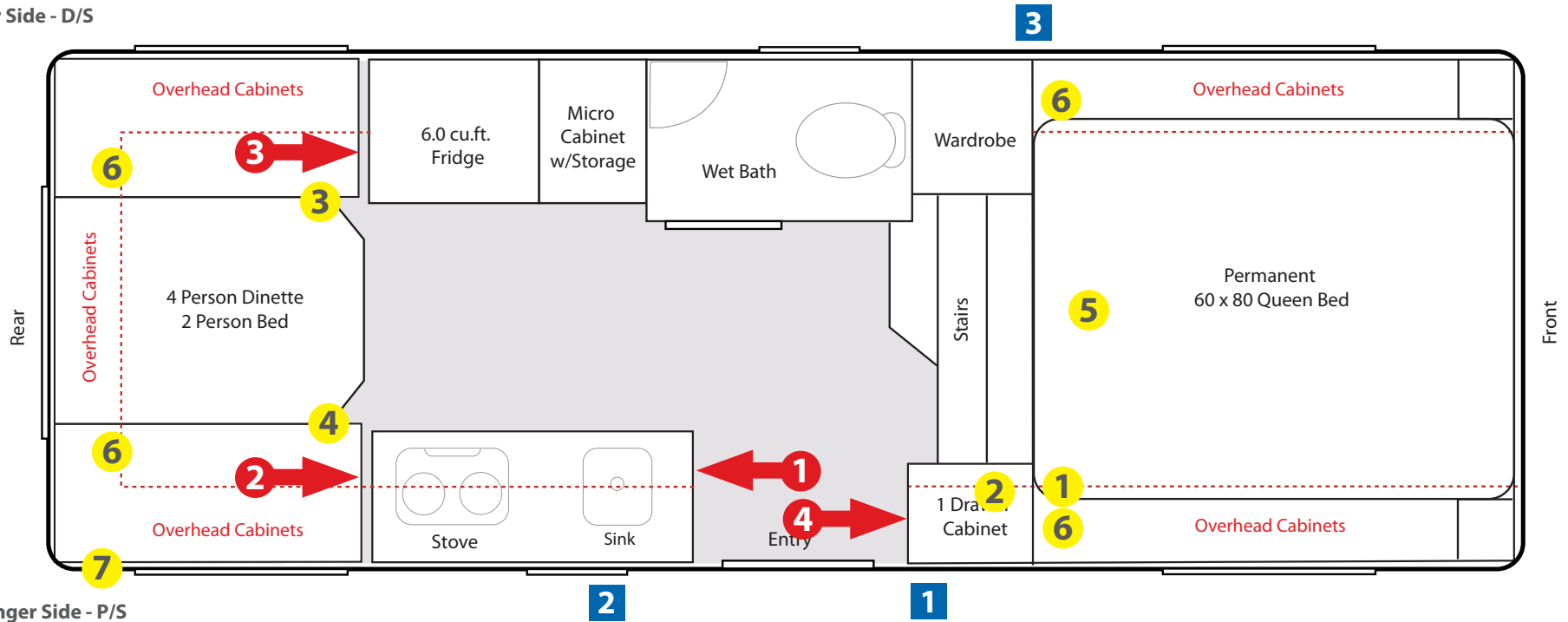

Passenger Side - P/S

● OPTION LOCATIONS

- 1 TV Coaxial with 120V – face of overhead cabinet P/S at foot of bed
- 2 Stereo – beneath overhead cabinet P/S above drawer stack
- 3 Surge Protector Monitor E.M.S. – face of D/S dinette bench seat
- 4 Solar Panel Monitor – face of P/S dinette bench seat
- 5 TV Antenna – ceiling near foot of bed
- 6 Four Speakers – installed in rear of dinette on face of upper cabinets & mounted below D/S & P/S overhead cabinets near foot of bed
- 7 Exterior Solar Port – P/S at rear of trailer (only available with solar panel option)

➔ COUNTER EXTENSION LOCATIONS

- 1 End of kitchen counter P/S – beside sink left of entry
- 2 Dividing wall P/S – on wall in dinette 16" above bench platform
- 3 Dividing wall D/S – on wall in dinette 16" above bench platform
- 4 Side of cabinet wall P/S – on wall of drawer stack right of entry (only available with full-height cabinet)

■ EXTERIOR PROPANE & EXTERIOR SHOWER

- 1 Exterior Propane – below trailer right of entry door step on P/S
- 2 P/S Hot/Cold Exterior Water – above wheel well left of entry door
- 3 D/S Hot/Cold Exterior Water – towards the front of trailer

Escape 5.0 STANDARD INTERIOR & EXTERIOR LIGHT LOCATIONS

Driver Side - D/S

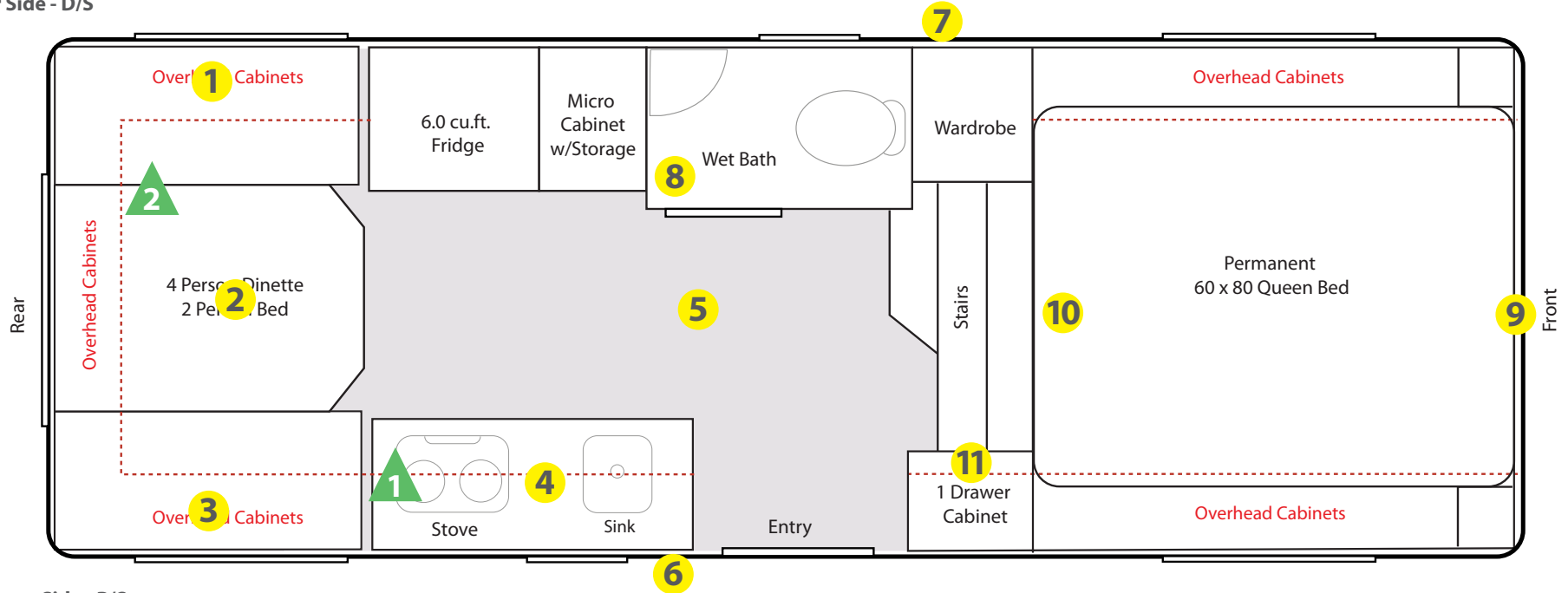

Passenger Side - P/S

● STANDARD INTERIOR & EXTERIOR LIGHTS

- 1 Single dome D/S dinette – bottom of overhead cabinet
- 2 Double dome dinette center – ceiling centered above table
- 3 Single dome P/S dinette – bottom of overhead cabinet
- 4 Double dome P/S kitchen – bottom of overhead cabinet
- 5 Double dome kitchen center – ceiling centered in aisle
- 6 Exterior dome P/S – porch light
- 7 Exterior dome D/S – above discharge valves
- 8 Single dome bathroom – on bathroom ceiling
- 9 Exterior dome front – under nose
- 10 Double dome bed center – top of stairs at foot of bed
- 11 Single dome above cabinet – bottom of upper cabinet (not available if stereo option is chosen)

▲ MONITOR PANEL & CONVERTER

- 1 Standard location of Monitor Panel – on face of upper cabinet in kitchen P/S. Monitor Panel displays current levels for: Battery, Fresh Water Tank, Grey Water Tank, Black Tank. Includes Water Pump On/Off Switch & Hot Water Tank On/Off Switch
- 2 Standard location of Converter – face of dinette bench seat D/S. Converts 120V power to 12V power and houses Breakers and Fuses

Driver Side - D/S

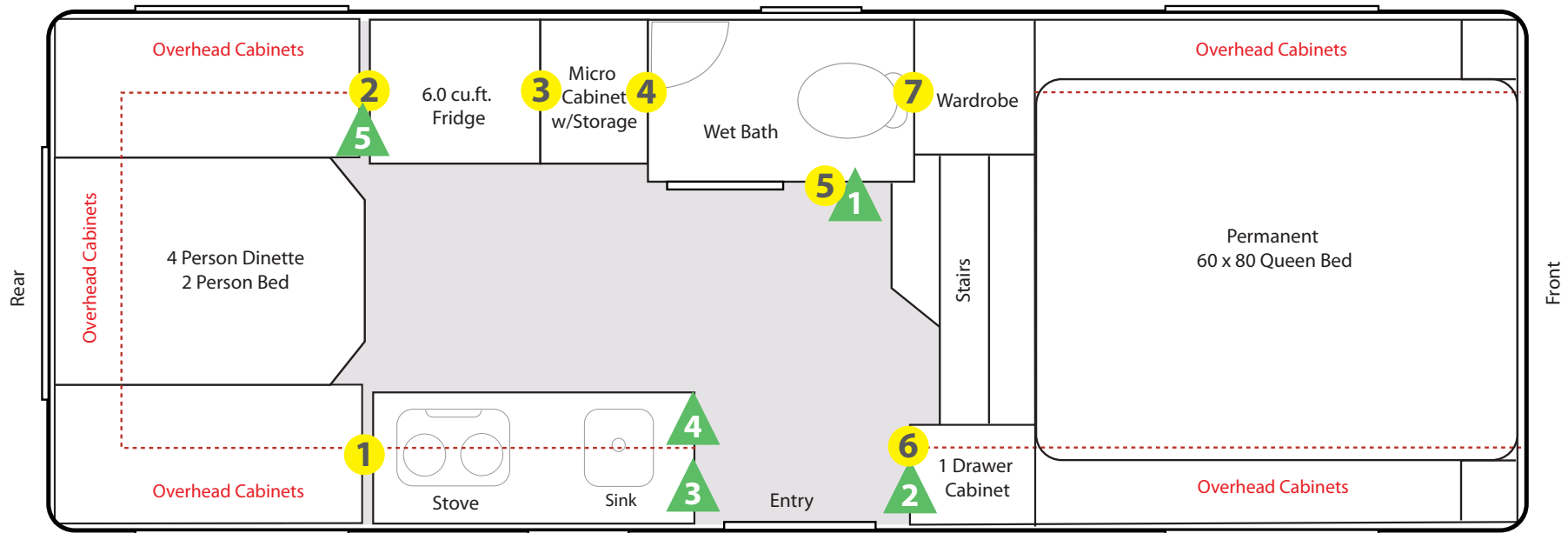

Passenger Side - P/S

● OPTIONAL REINFORCED WALLS

The interior walls are not reinforced but they can be as an option. If you plan on mounting items such as a TV, any sort of storage system, the wall will need to be reinforced.

- 1 Reinforced Wall** – P/S kitchen wall, dinette side (25 lbs)
- 2 Reinforced Wall** – D/S fridge wall, dinette side (25 lbs)
- 3 Reinforced Wall** – D/S fridge wall, microwave cabinet side (25 lbs)
- 4 Reinforced Wall** – D/S bathroom wall, microwave cabinet side (25 lbs)
- 5 Reinforced Wall** – D/S bathroom wall, face side (25 lbs)
- 6 Reinforced Wall** – P/S drawer wall, door side. **ONLY** available if full height cabinet is selected and only the upper portion of the cabinet reinforced (25 lbs)
- 7 Reinforced Wall** – D/S wardrobe wall, bathroom side (25 lbs)

▲ RETRACTABLE WALL HOOKS

The Retractable Wall Hooks include 3 hooks per set.

- 1 Wall Hooks** – D/S outside bathroom wall
- 2 Wall Hooks** – P/S right of entry on end of overhead cabinet
- 3 Wall Hooks** – P/S left of entry on end of overhead cabinet
- 4 Wall Hooks** – P/S end of kitchen counter left of entry door (can not be combined with counter extension in this location)
- 5 Wall Hooks** – D/S fridge wall in dinette

Escape 5.0 INTERIOR DIMENSIONS

Driver Side - D/S

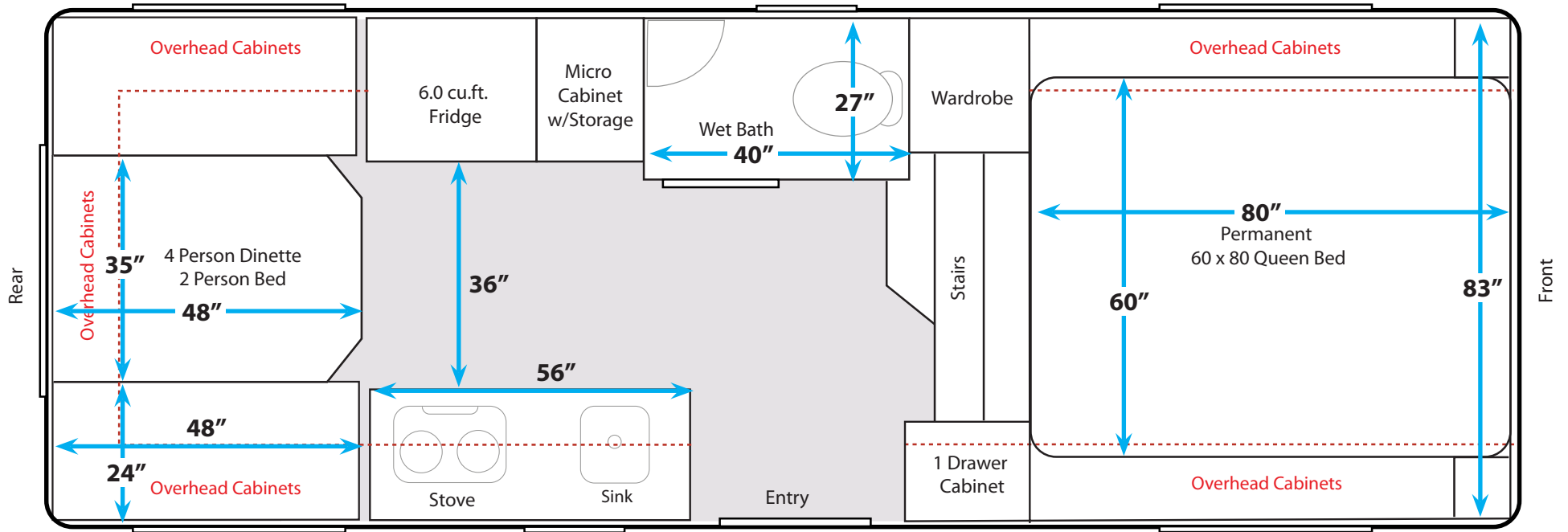

Passenger Side - P/S

Dimensions are approximate and not drawn to scale