

pi-top^[4]



ROBOTICS KIT

ALEX

Build Instructions

What can **Alex** do?

Alex is a configuration designed for autonomous driving and AI projects.

It incorporates a Pan-tilt Servo Motor mechanism mounted on the front which gives the wide-angle camera sensor two degrees of freedom - a full 180° of range in both axes. Its Ultrasonic Sensor is also attached to the Pan-Tilt Servo Motor mechanism which enables Alex to perform full 180° scans to look for possible obstacles. Finally, the two high accuracy, high power Encoder Motors are positioned at the front of the vehicle; allowing for more accurate positioning for projects such as line-following.

The pi-top [4] Robotics Kit offers ultimate modularity and expandability, allowing you to customise or design any configuration to suit your needs. Alex provides a large range of sensor mounting points so you can adapt and change it rapidly to suit the needs of your projects.



Need help?

[pi-top.com
/support](https://pi-top.com/support)

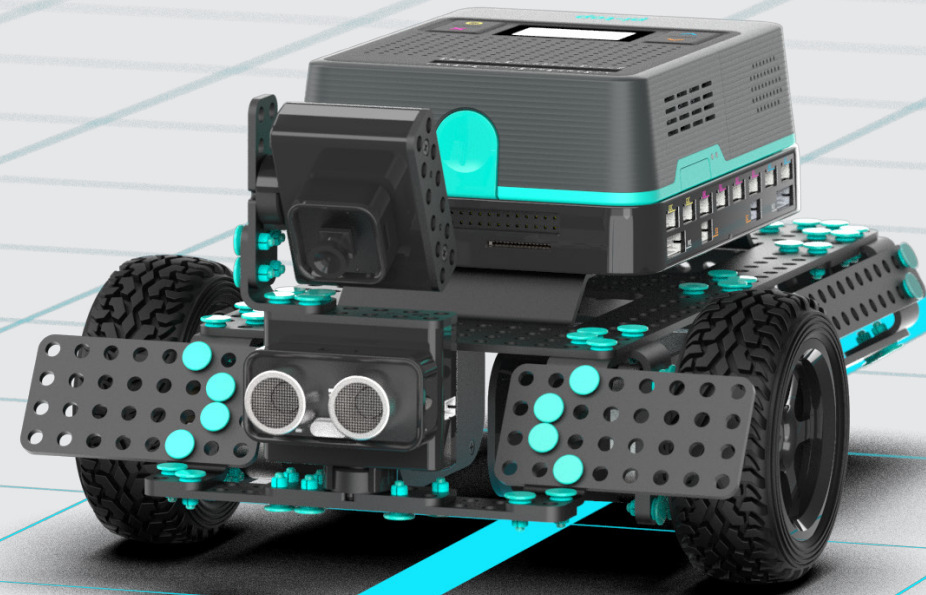

Contents



What parts do you need?	4
How to use the rivets	5
Build guide	6
Get making	7
What's next?	36



What parts do you need?

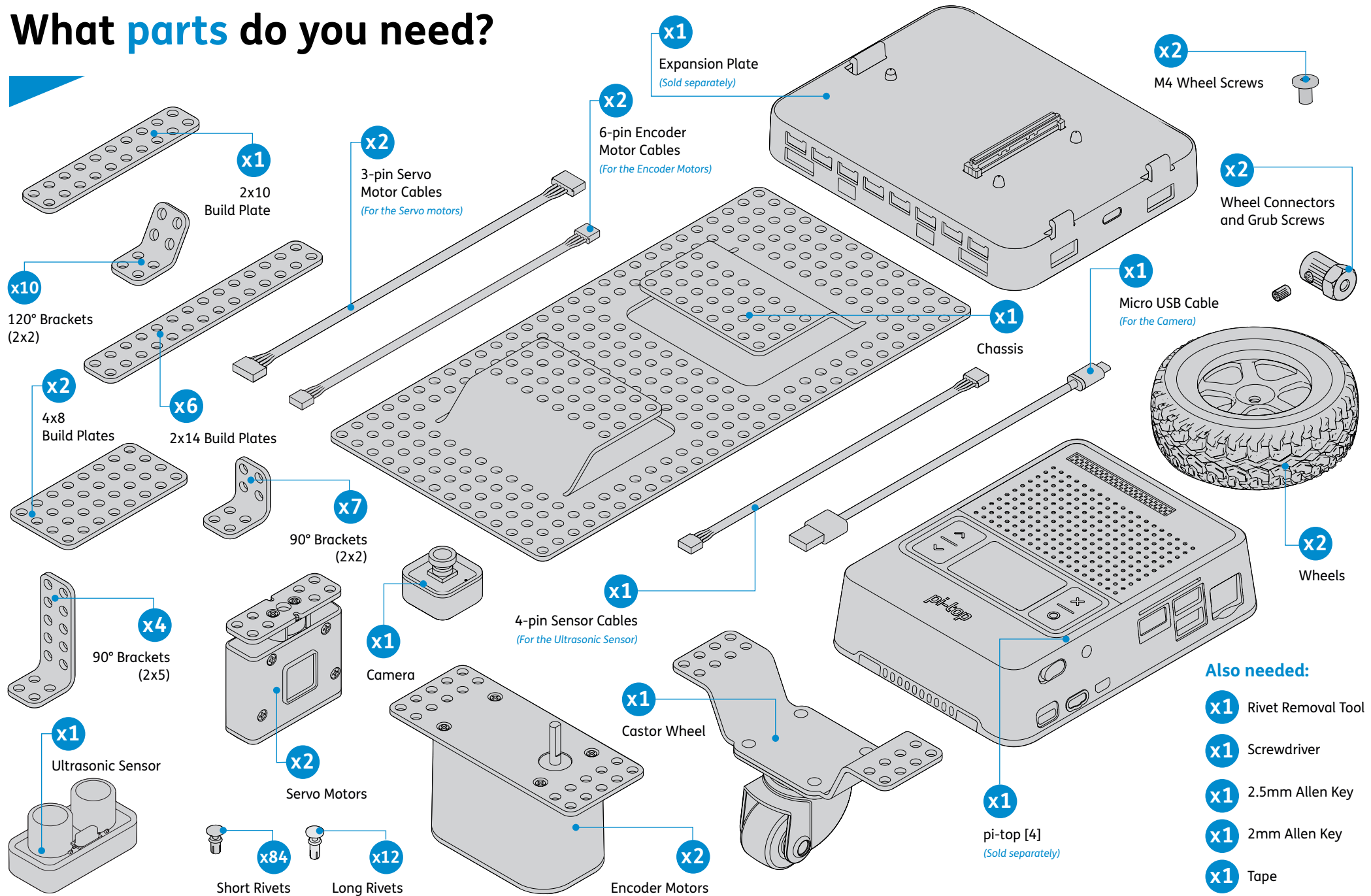

How to use the rivets

The Robotics Kit contains
two types of rivet:

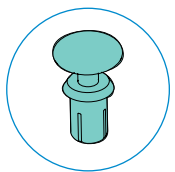

Short Rivets

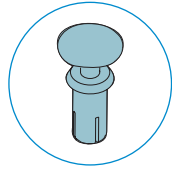

Long Rivets

Connecting 2 Build Plates

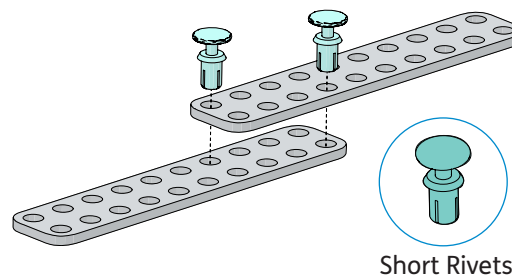

- 1.
- 2.
- 3.
- 4.

Connecting 3 Build Plates

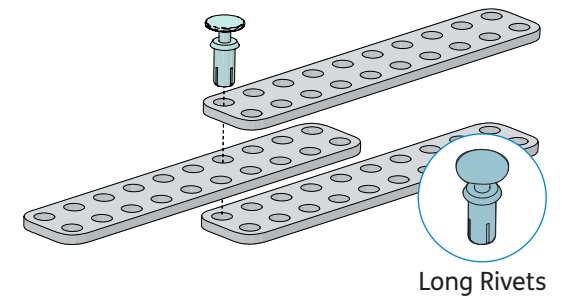

- 1.
- 2.
- 3.
- 4.

Build guide

a. Rear Bumper	7
b. Chassis	9
c. Castor Wheel.....	10
d. Side Bumpers.....	11
e. Front Bumper	14
f. Expansion Plate	17
g. Left Motor	18
h. Right Motor	20
i. Wheels.....	23
j. Pan-tilt Servo mechanism	24
k. Camera.....	27
l. Ultrasonic Sensor.....	28
m. pi-top [4].....	29
Connecting cables	30

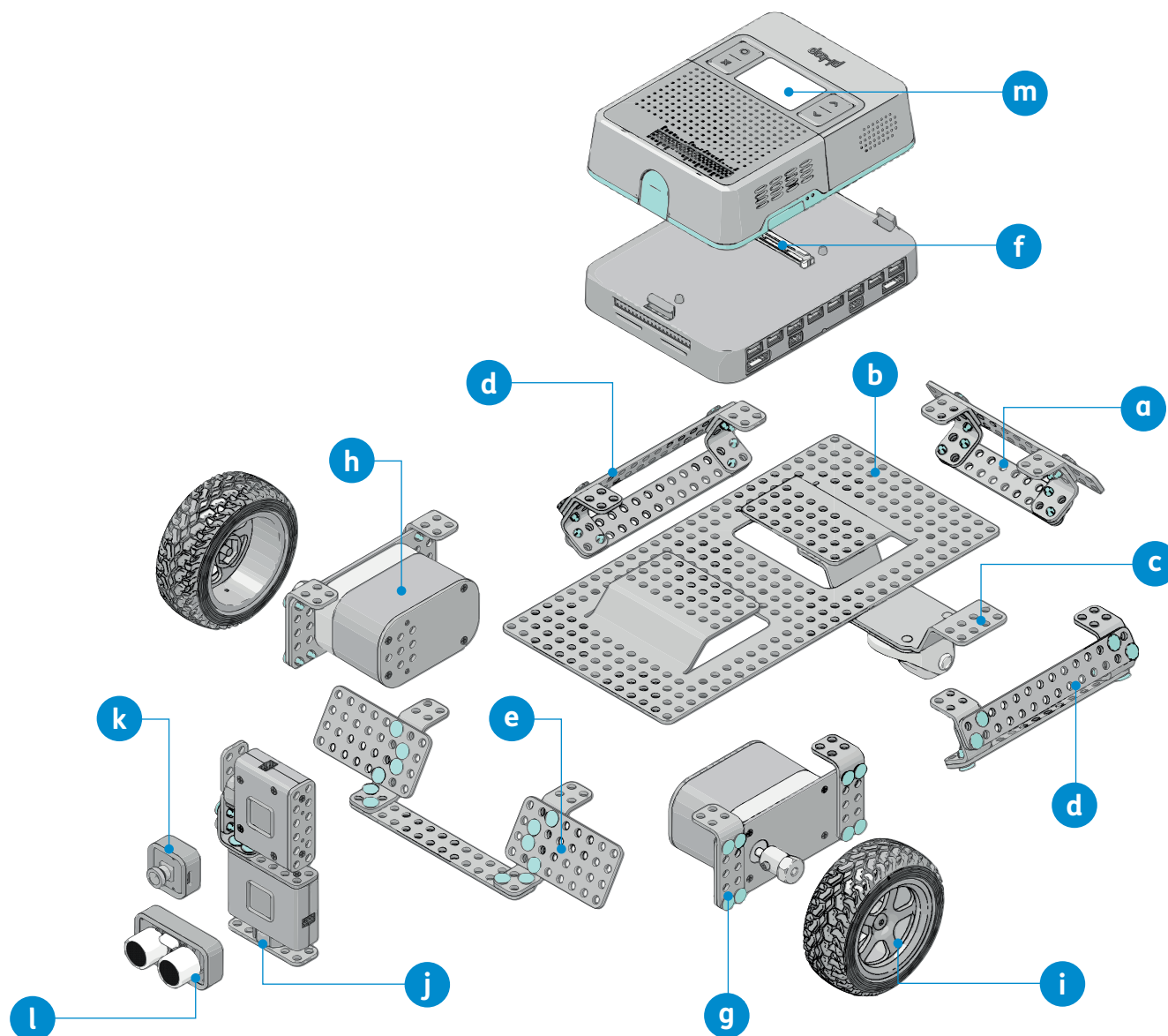

Rear bumper

Part 1

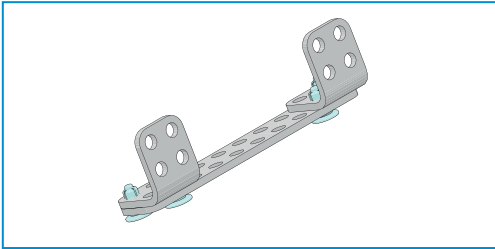
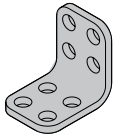
**x2**90° Brackets
(2x2)**x1**

10x2 Build Plate

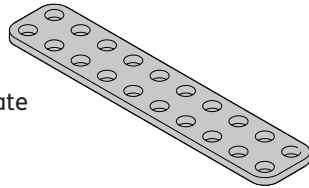
**x4**

Short Rivets

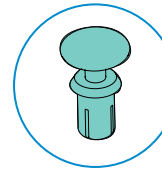
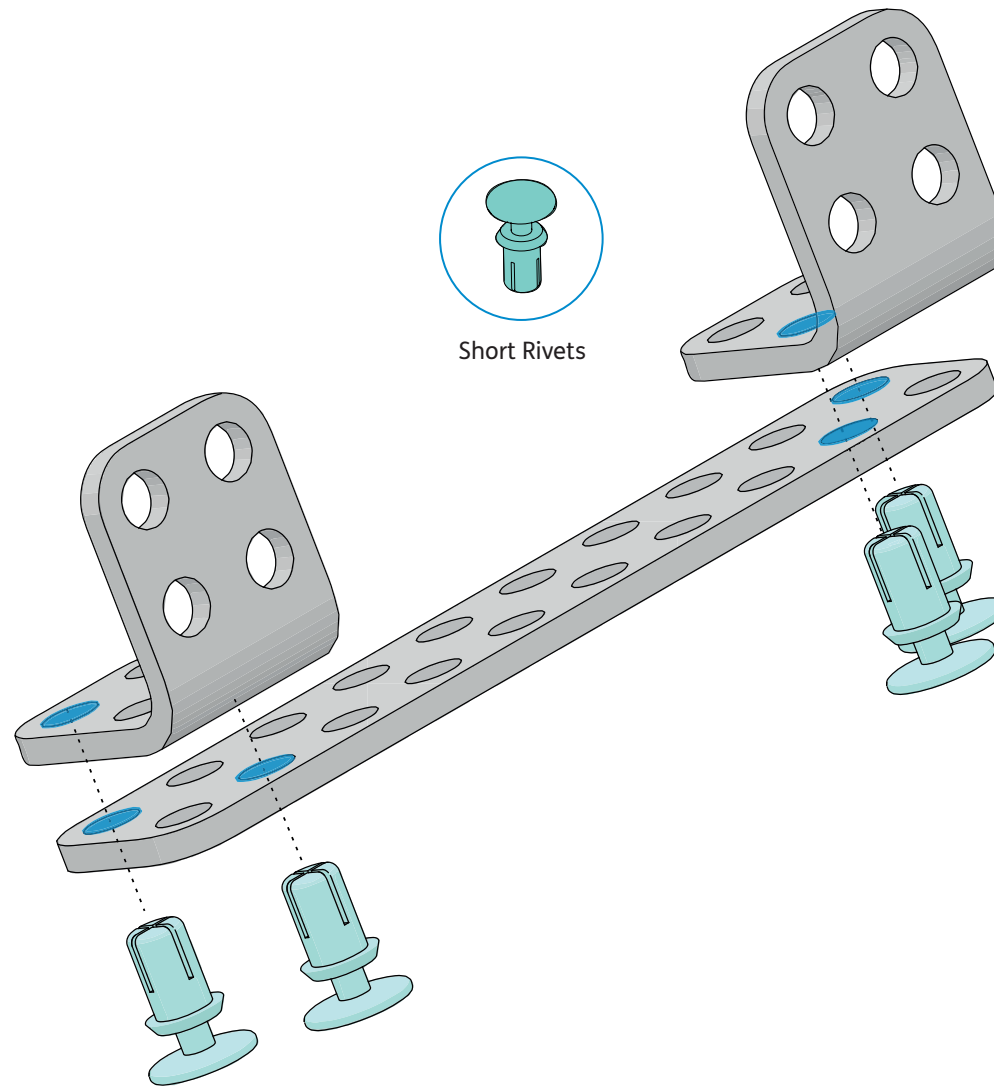

Short Rivets

Rear bumper

Part 2

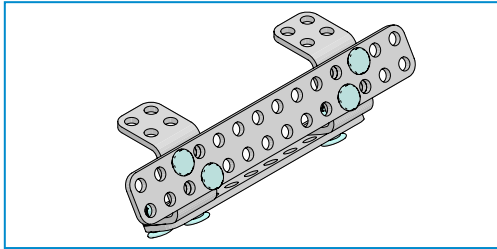
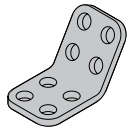
**x2**120° Brackets
(2x2)**x1**

2x14 Build Plate

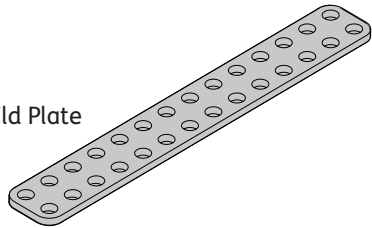
**x4**

Long Rivets

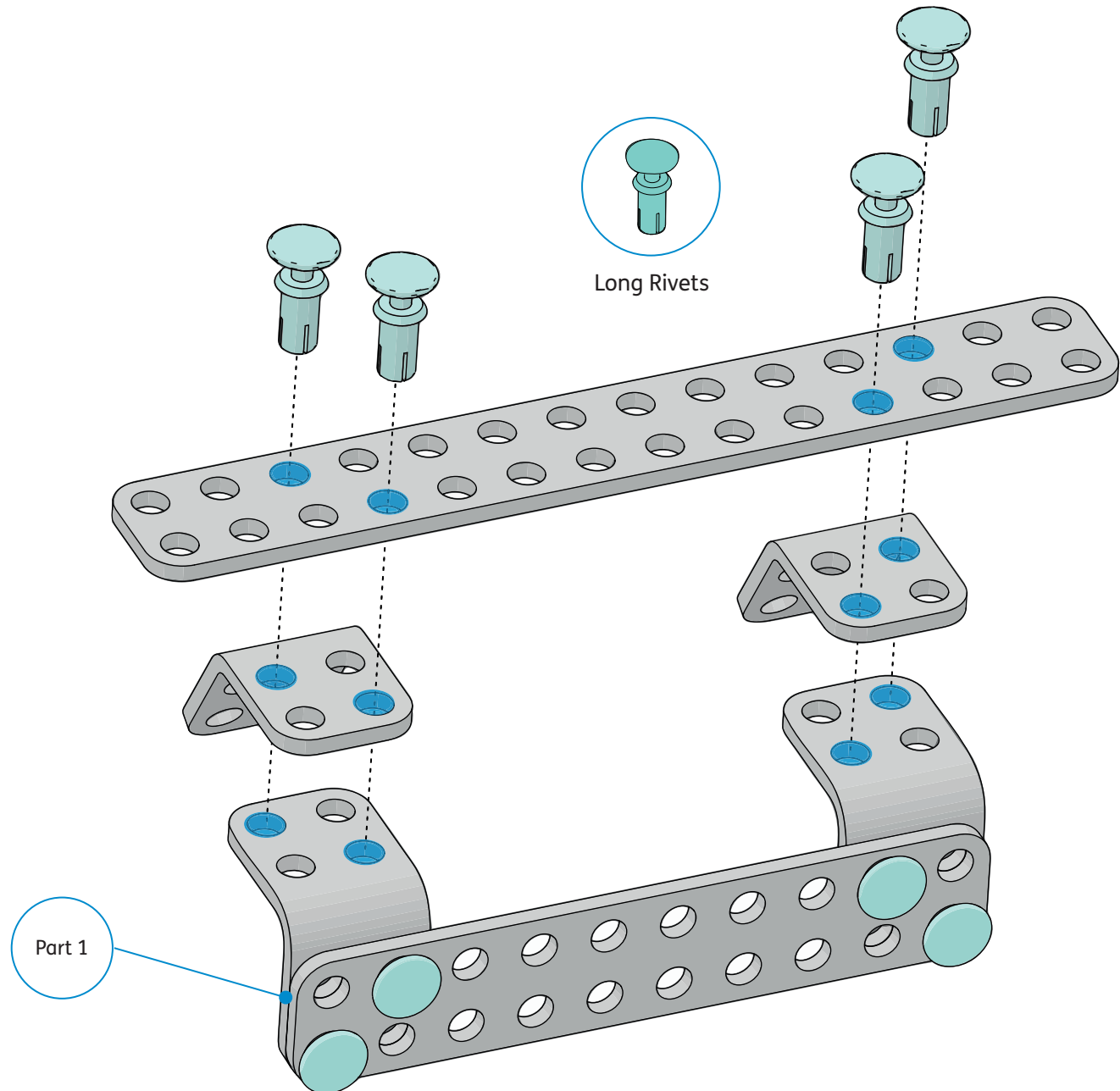

Chassis

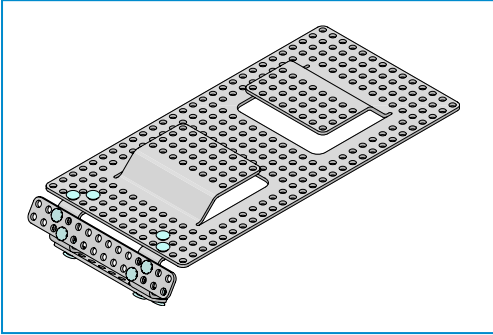
**x1**

Chassis

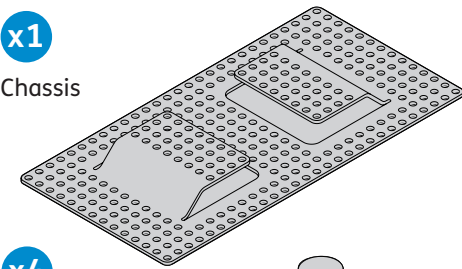
**x4**

Short Rivets

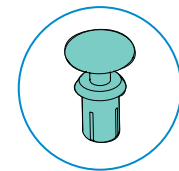
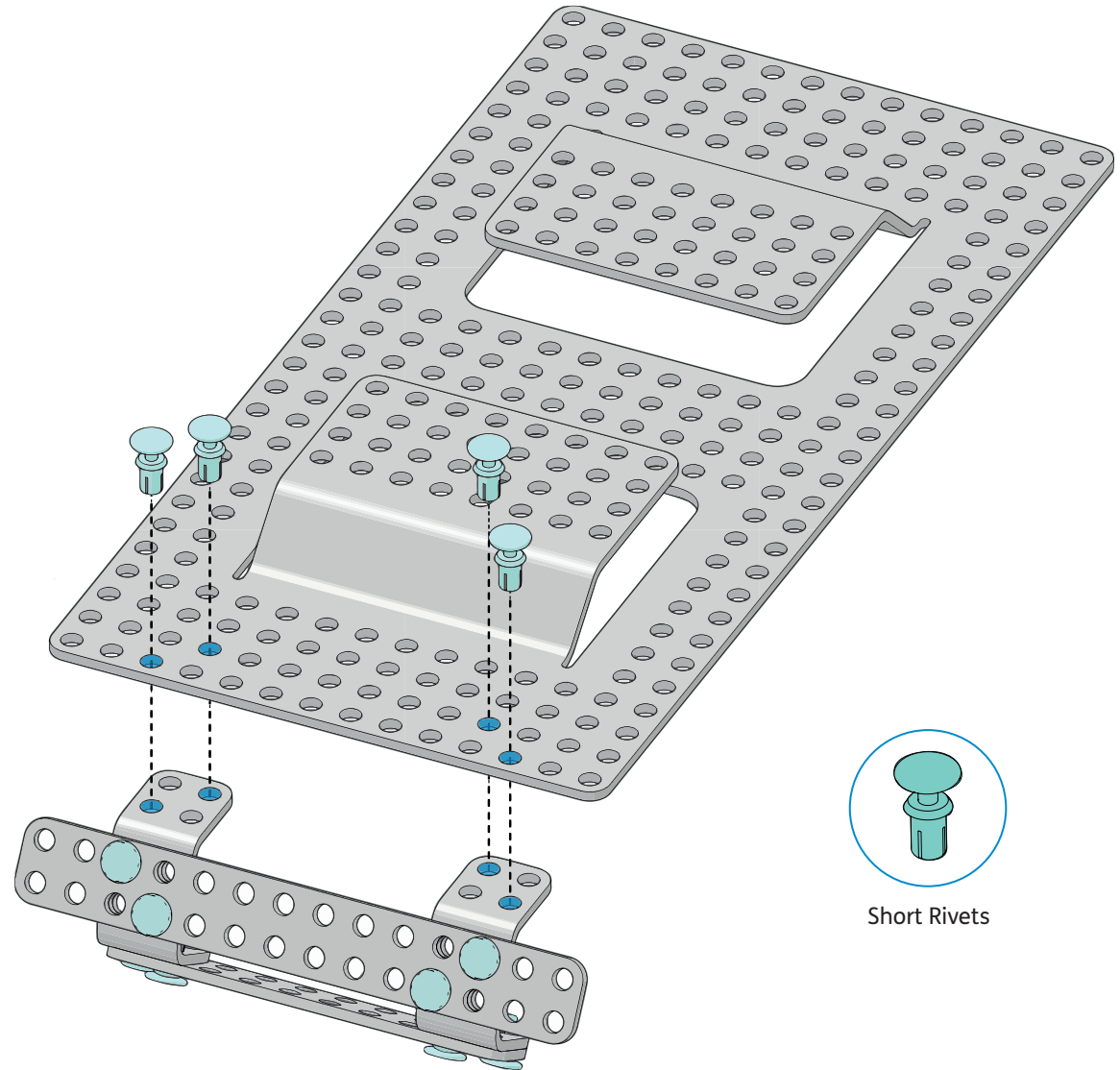

Short Rivets

Castor wheel

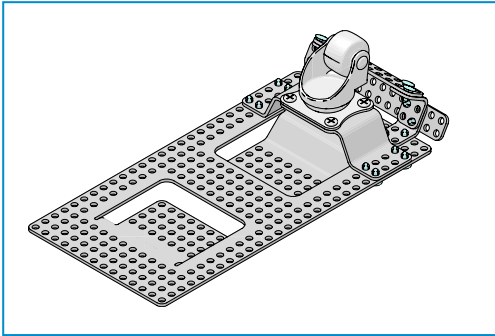
**x1**

Castor Wheel

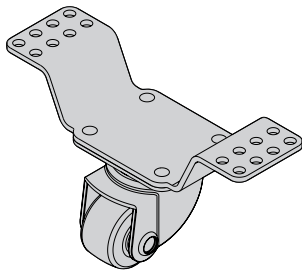
**x8**

Short Rivets

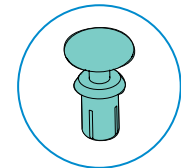
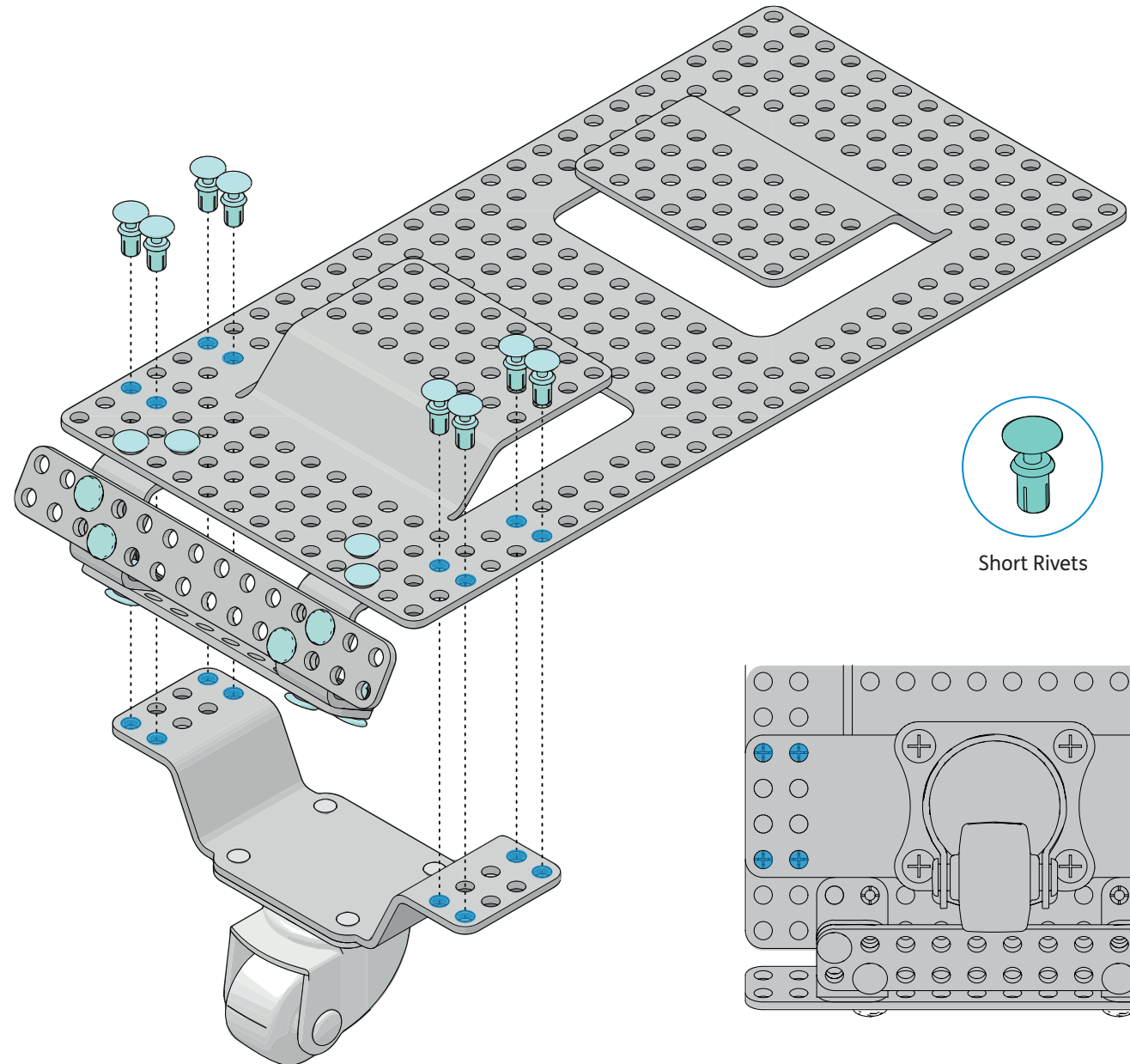

Short Rivets

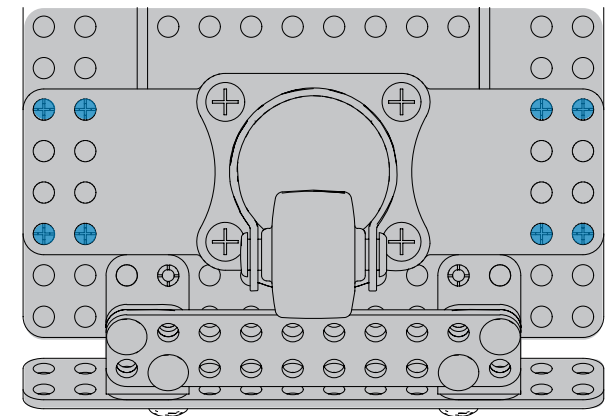

Side bumpers

Part 1

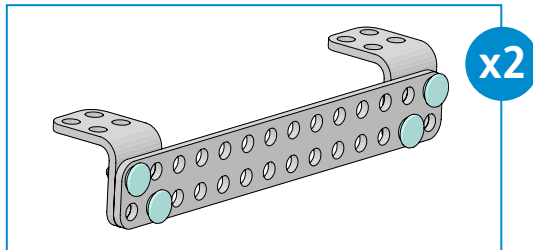
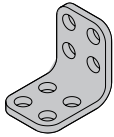
**x2**90° Brackets
(2x2)**x1**

2x14 Build Plate

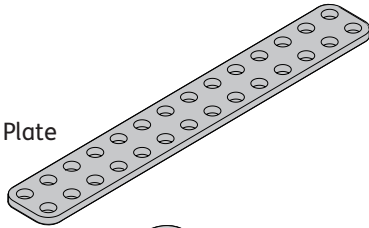
**x4**

Short Rivets

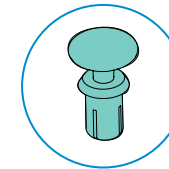

Short Rivets

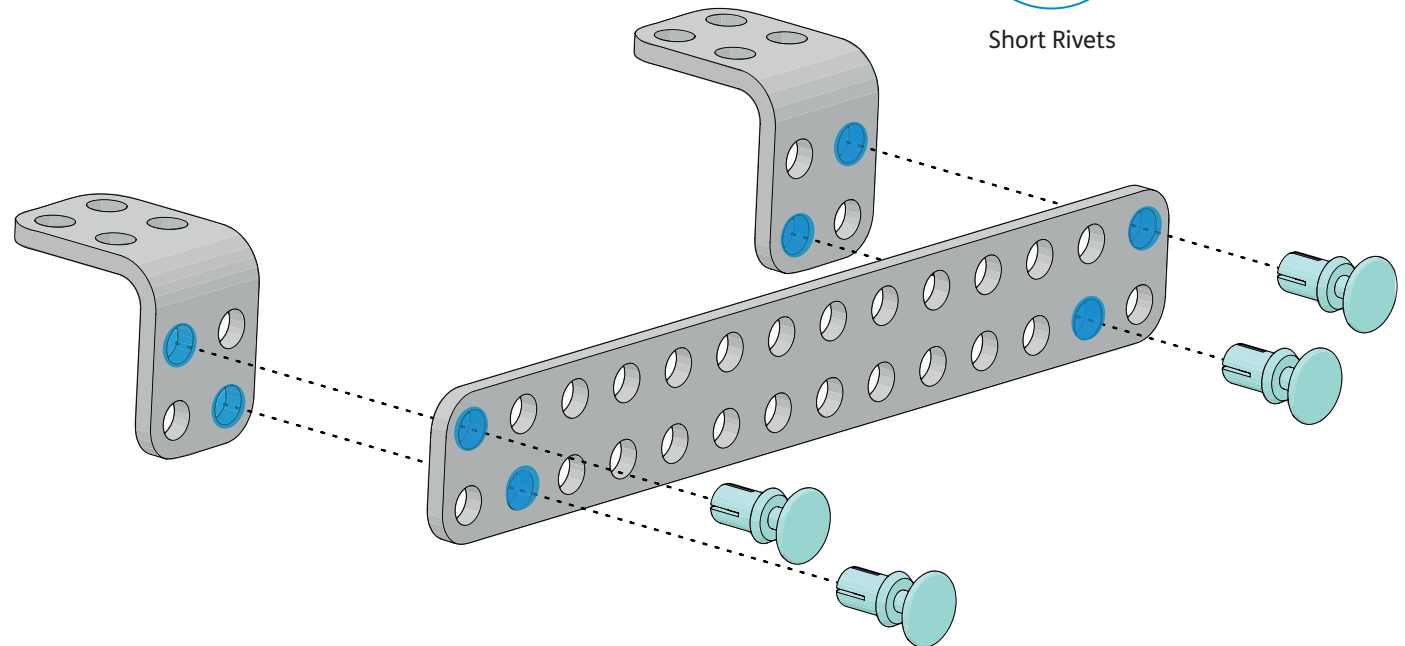

Side bumpers

Part 2

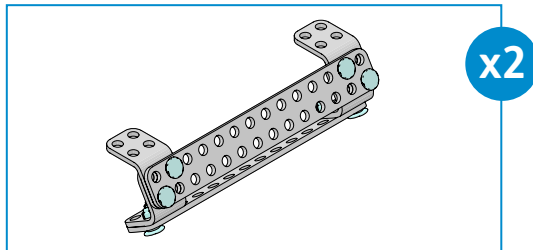
**x2**120° Brackets
(2x2)**x1**

2x14 Build Plate

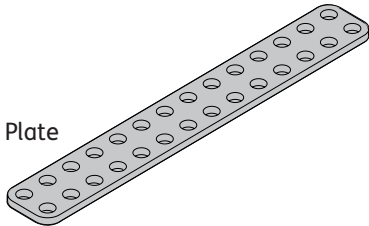
**x4**

Long Rivets

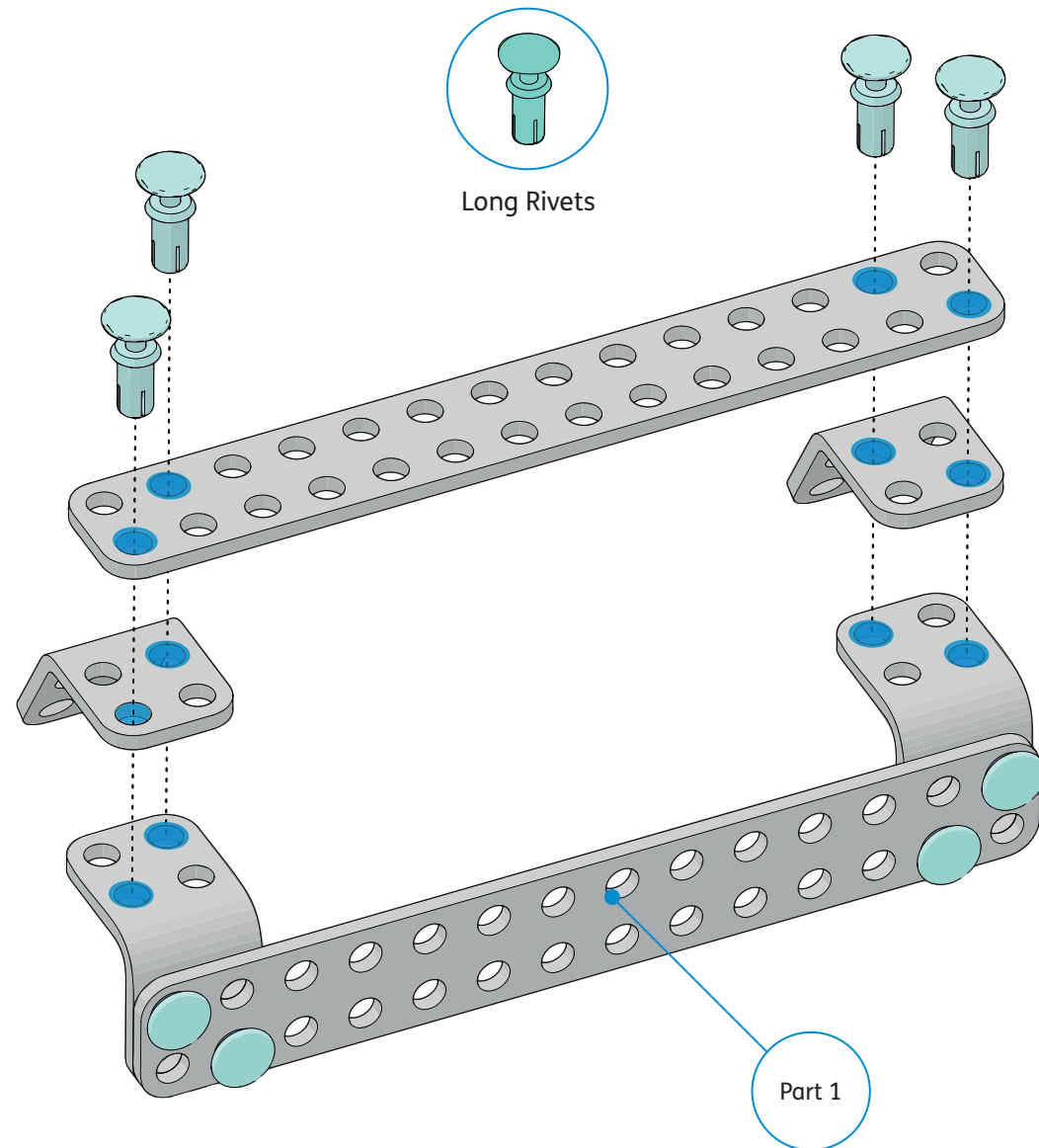

Side bumpers

Part 3

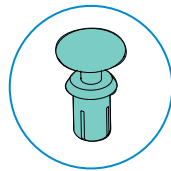
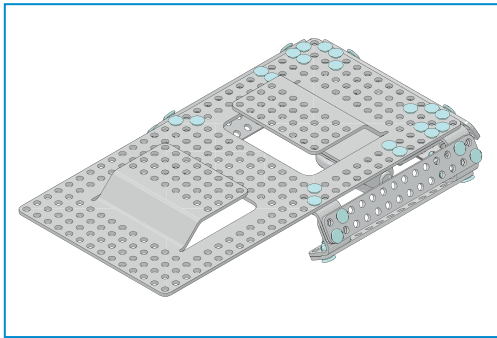

Short Rivets

x8

Short Rivets

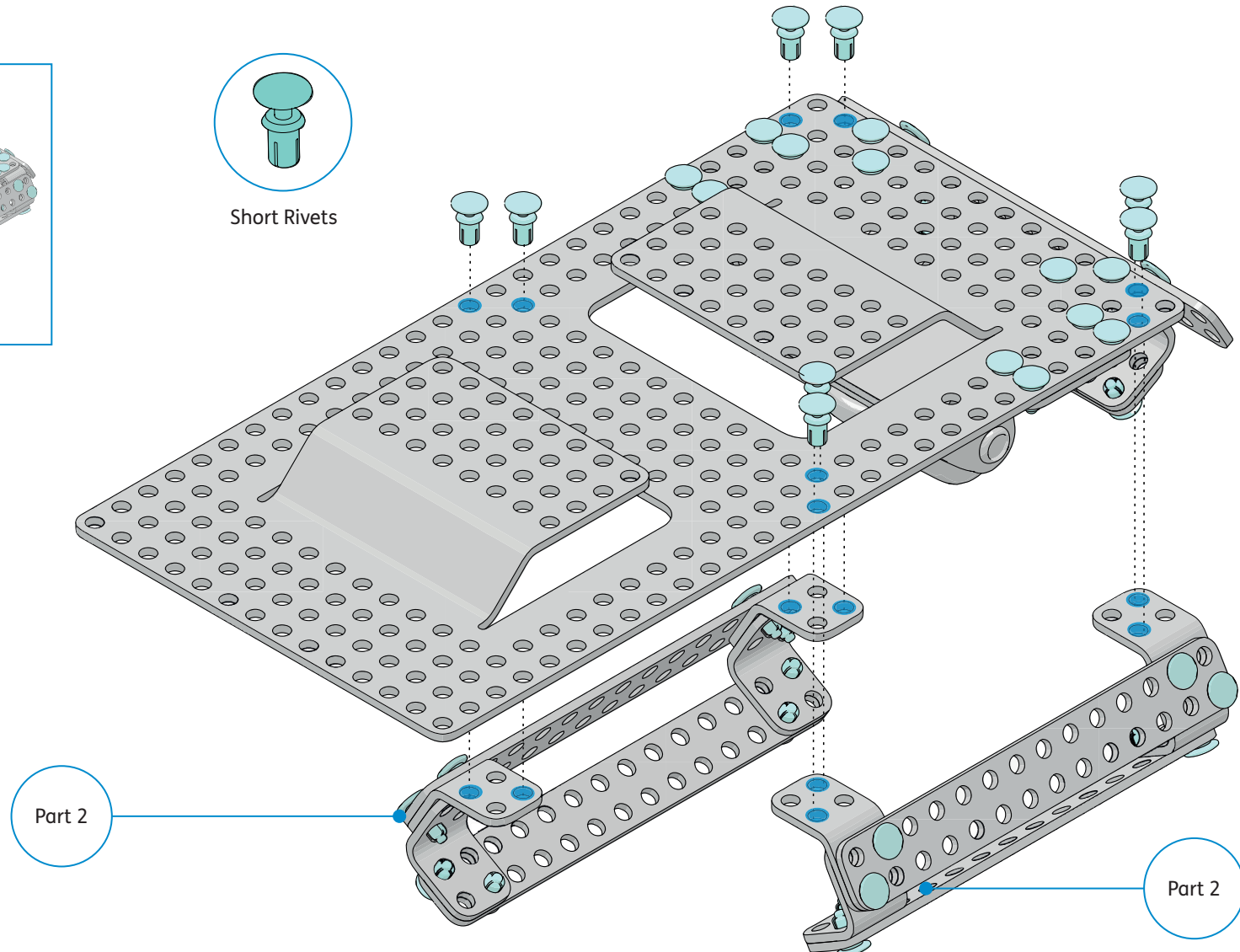

Front bumper

Part 1

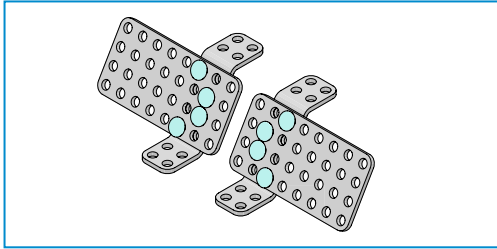
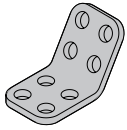
**x4**120° Brackets
(2x2)**x2**

4x8 Build Plate

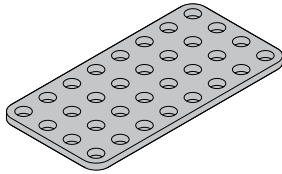
**x8**

Short Rivets

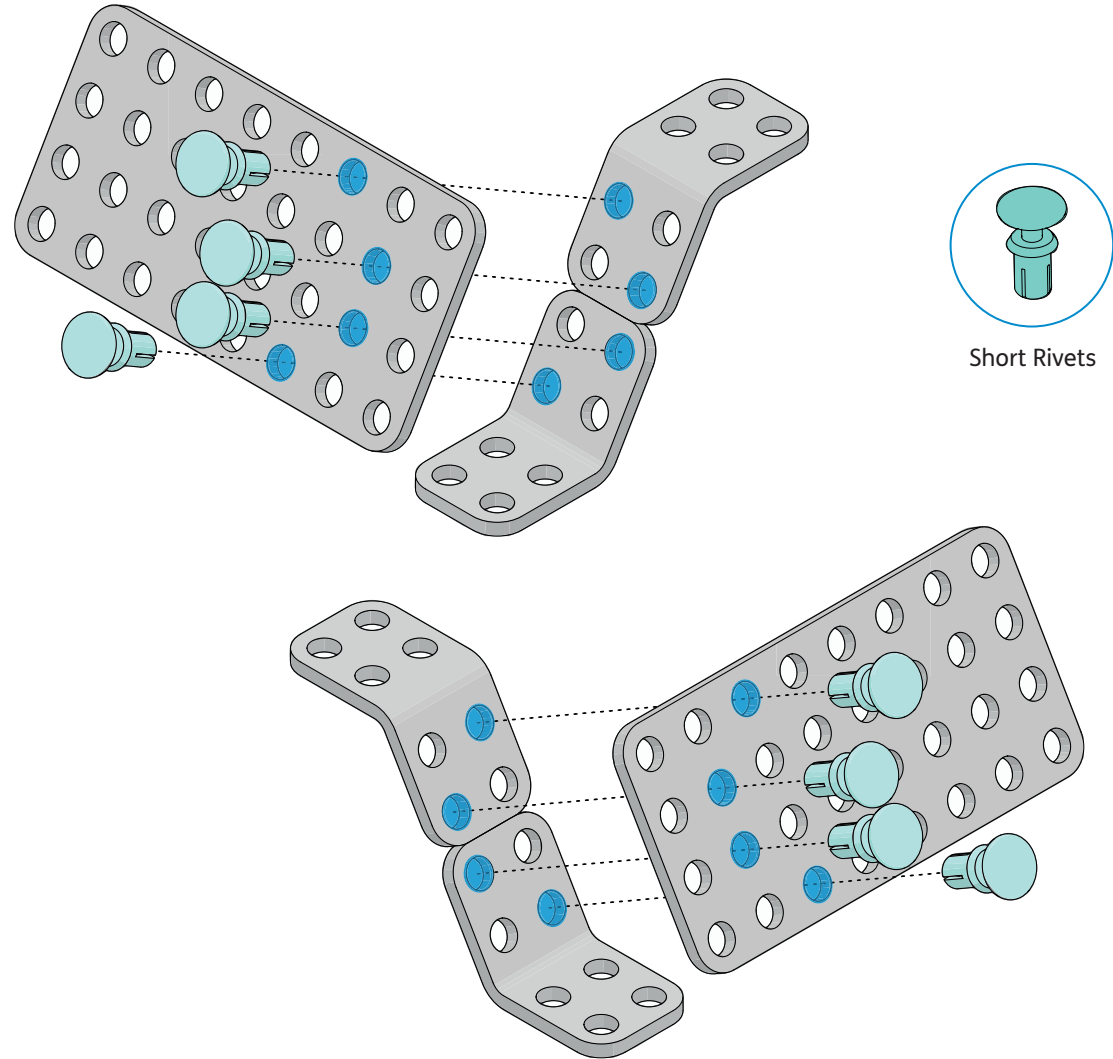

Front bumper

Part 2

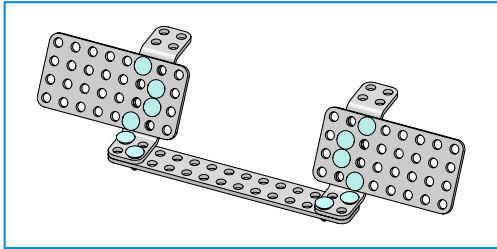
**x4**

Short Rivets

**x1**

2x14 Build Plate

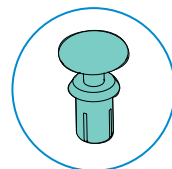
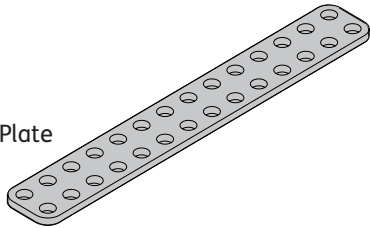

Short Rivets

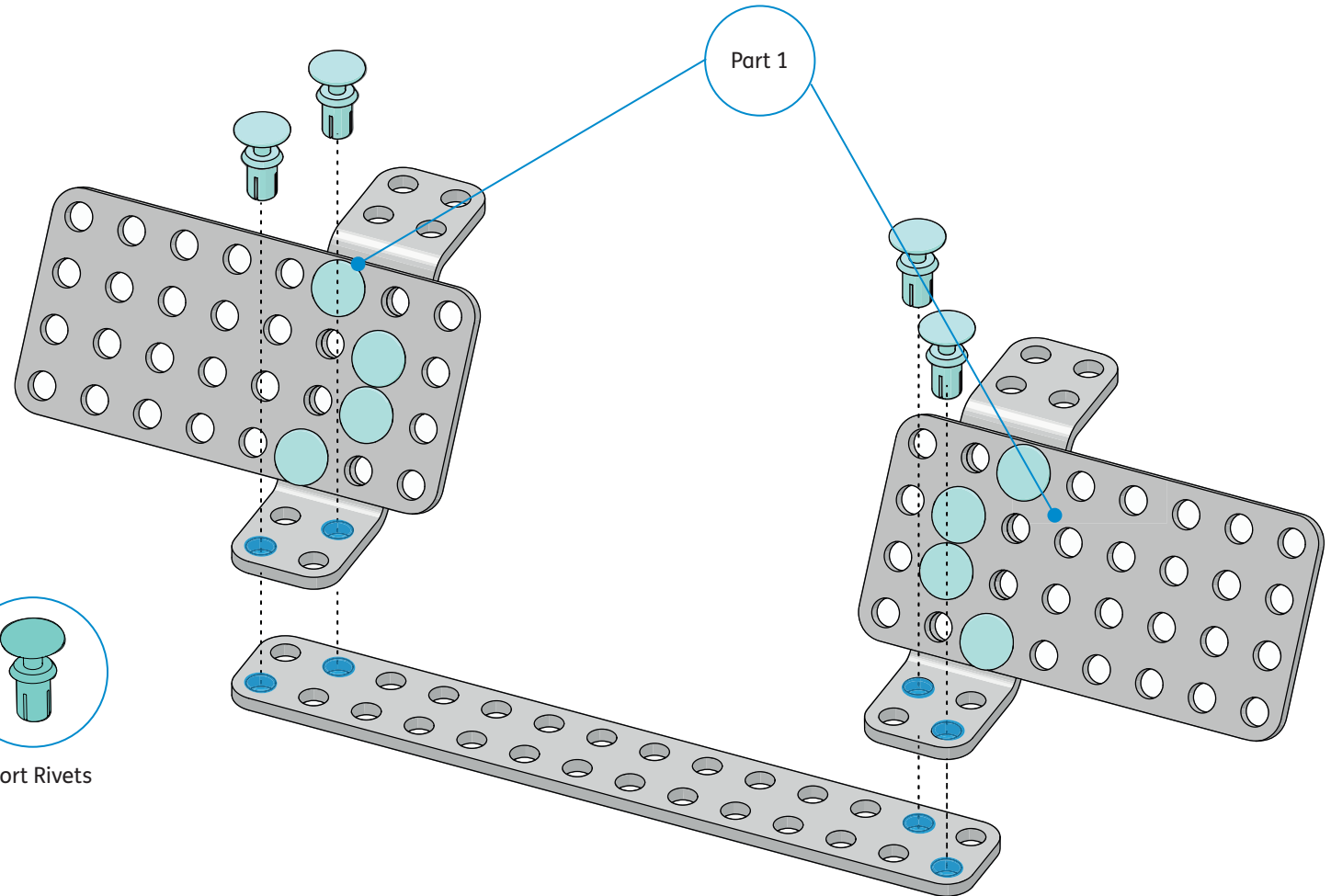

Front bumper

Part 3

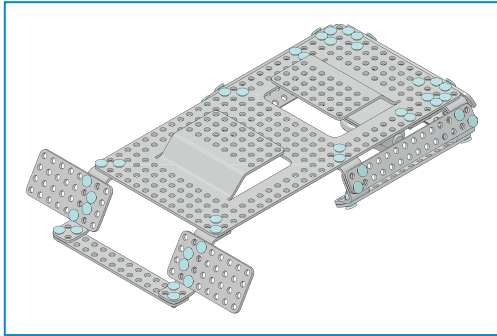
**x4**

Short Rivets

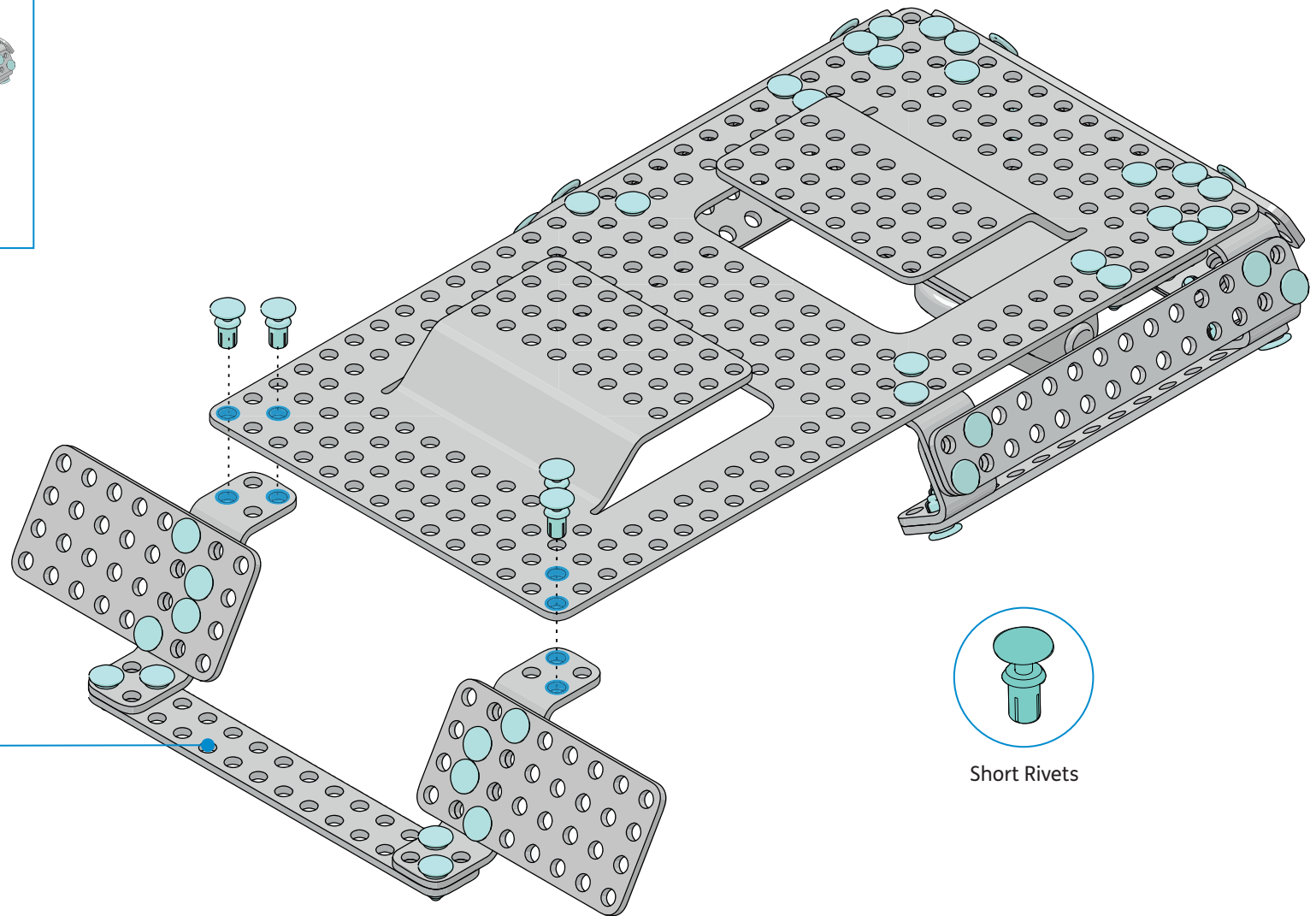

Part 2

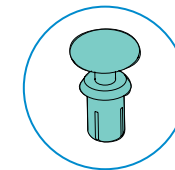

Short Rivets

Expansion Plate

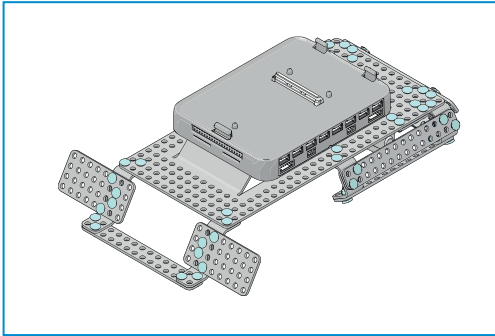
**x1**

Expansion Plate

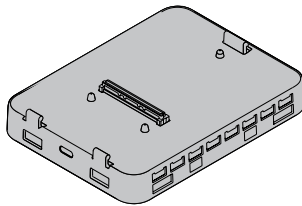
**x4**

Short Rivets

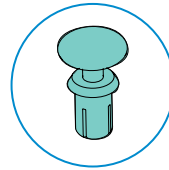

Short Rivets

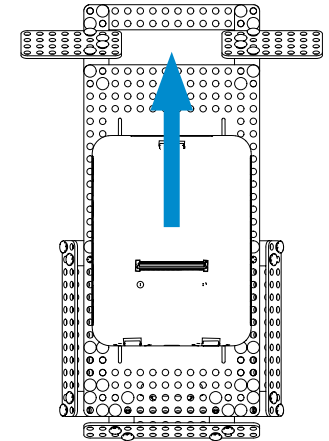
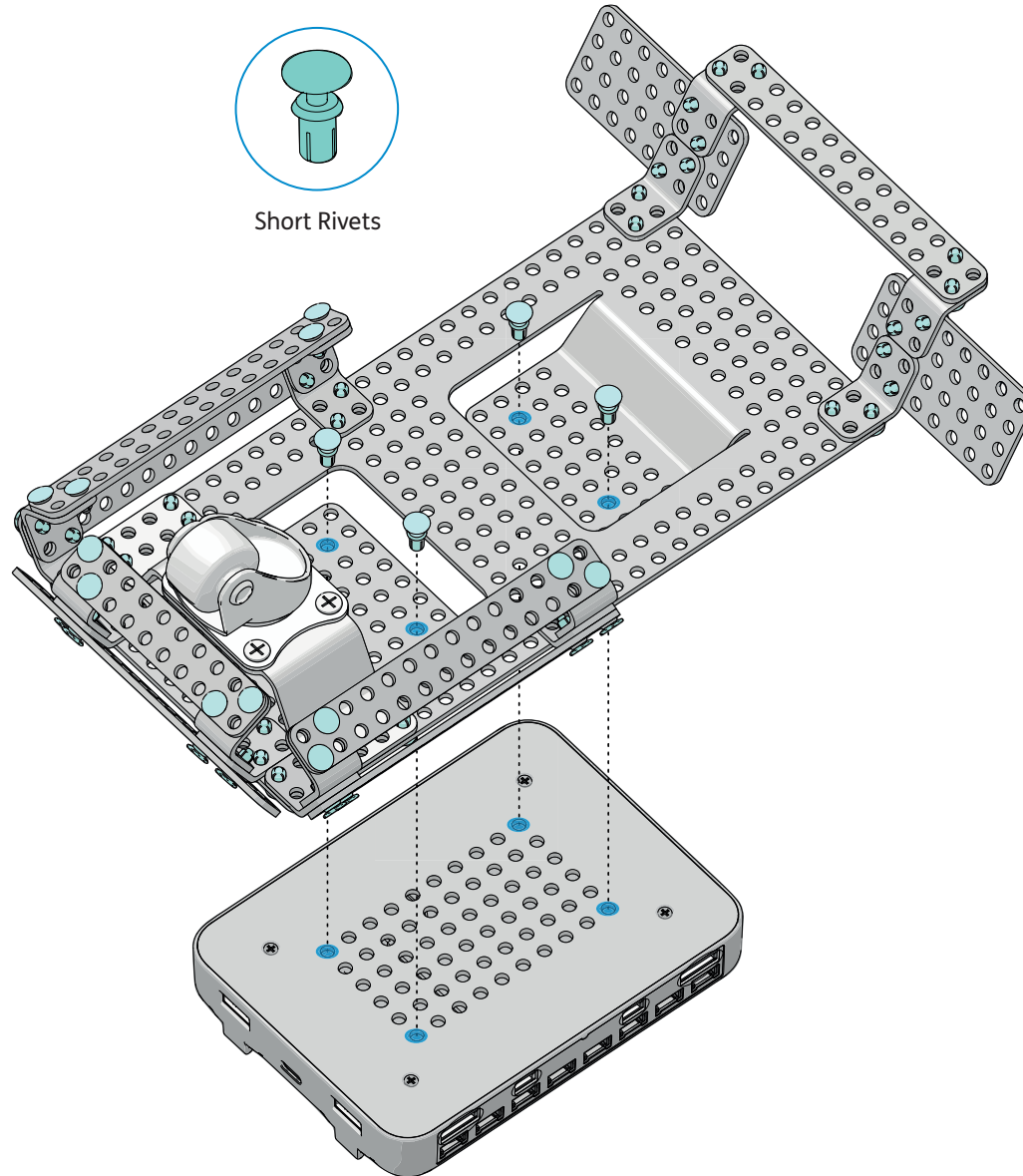

Make sure the
Expansion Plate is
pointing forwards!

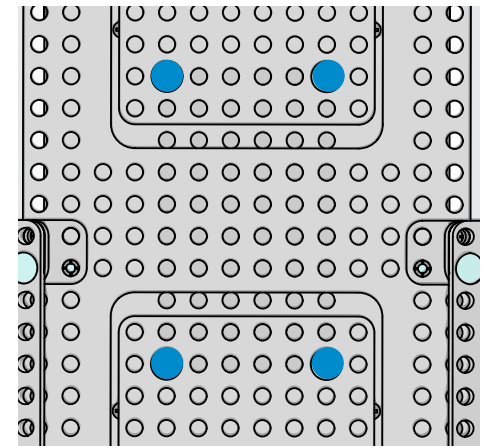

Left motor

Part 1

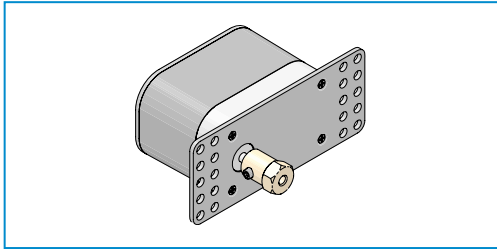
**x1**

Encoder Motor

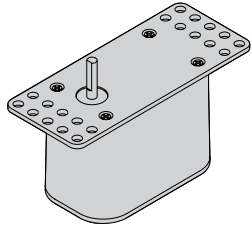
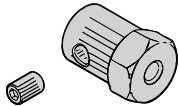
**x1**Wheel Connector
and Grub Screw**x1**

2mm Hex Key

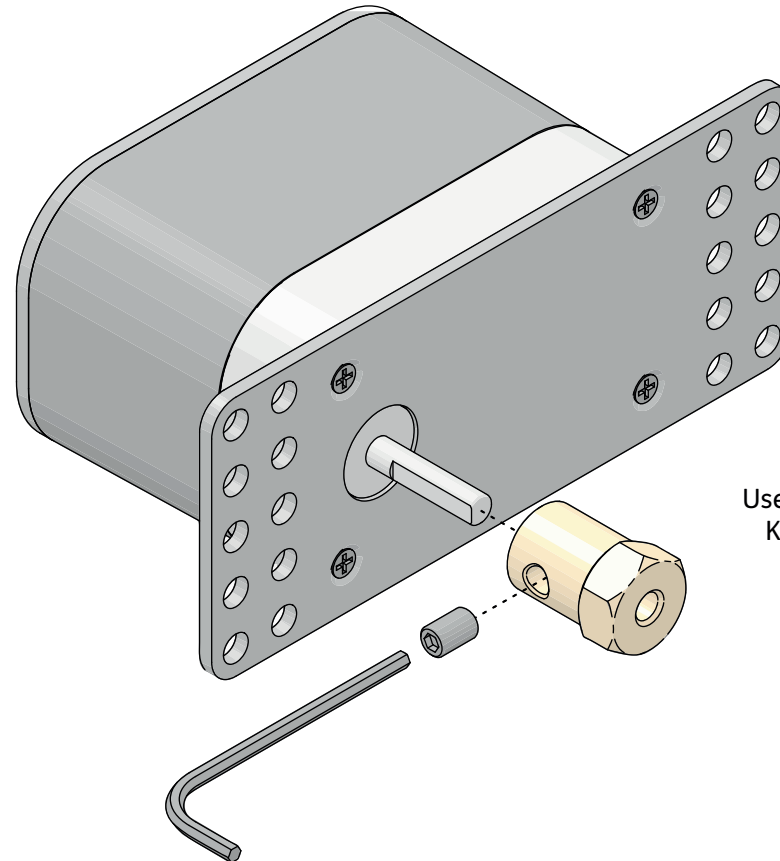
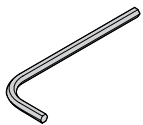
Use the 2mm Hex
Key to tighten

Left motor

Part 2

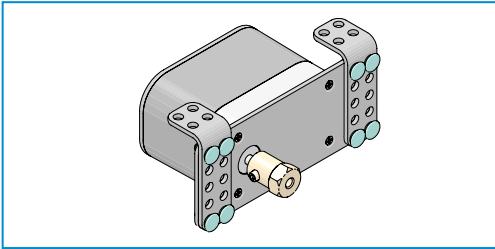
**x2**

90° Build Plates
(2x5)

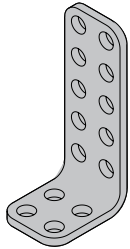
**x8**

Short Rivets

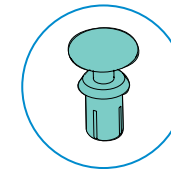

Short Rivets

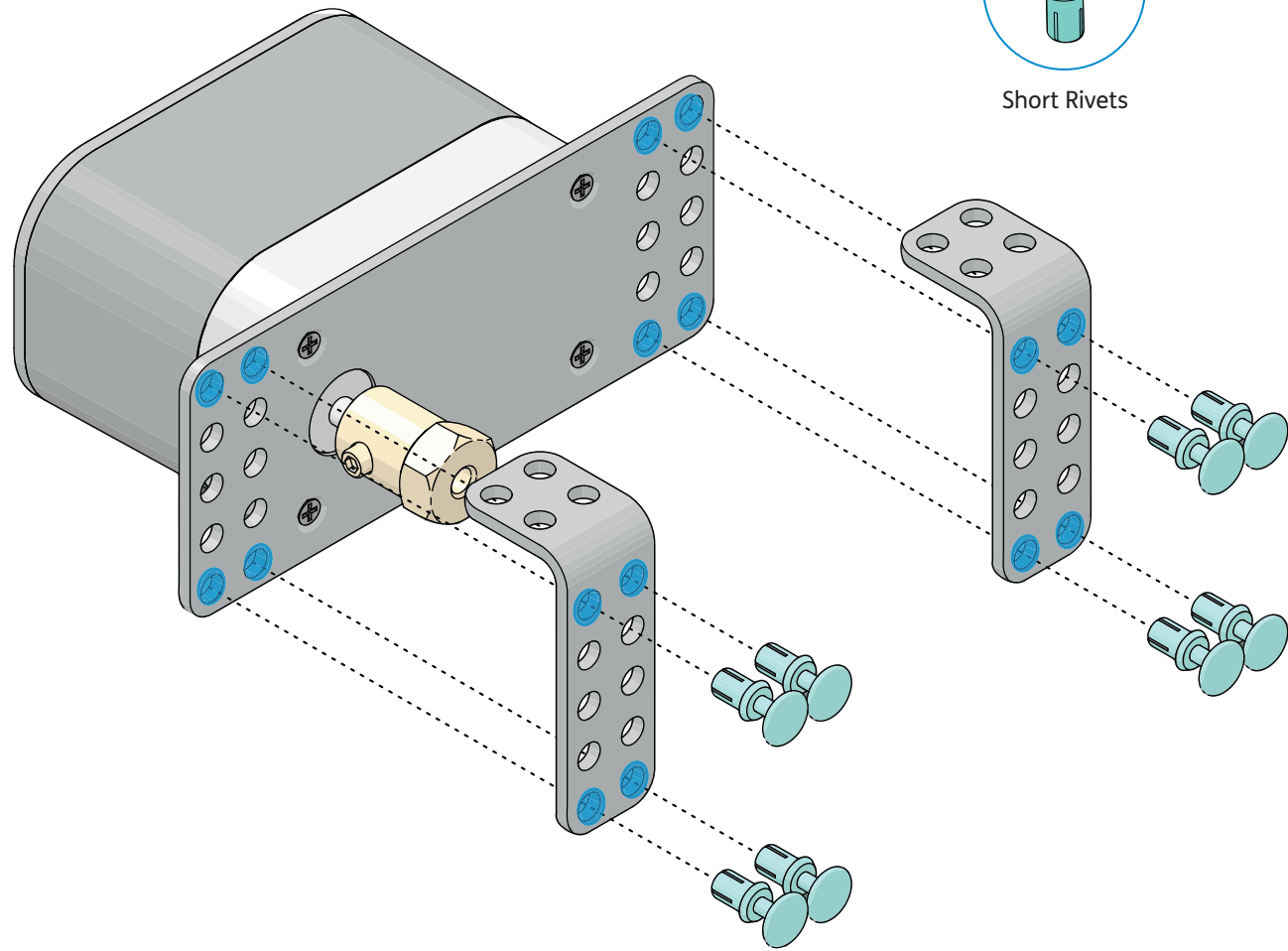

Right motor

Part 1

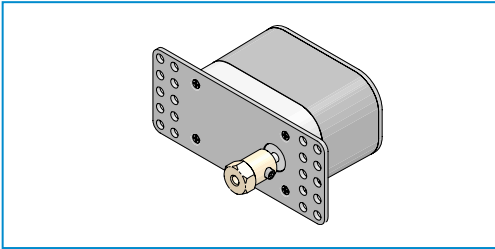
**x1**

Encoder Motor

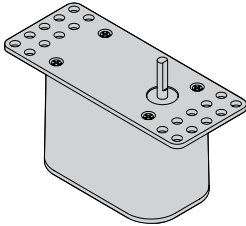
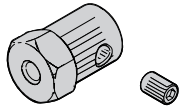
**x1**Wheel Connector
and Grub Screw**x1**

2mm Hex Key

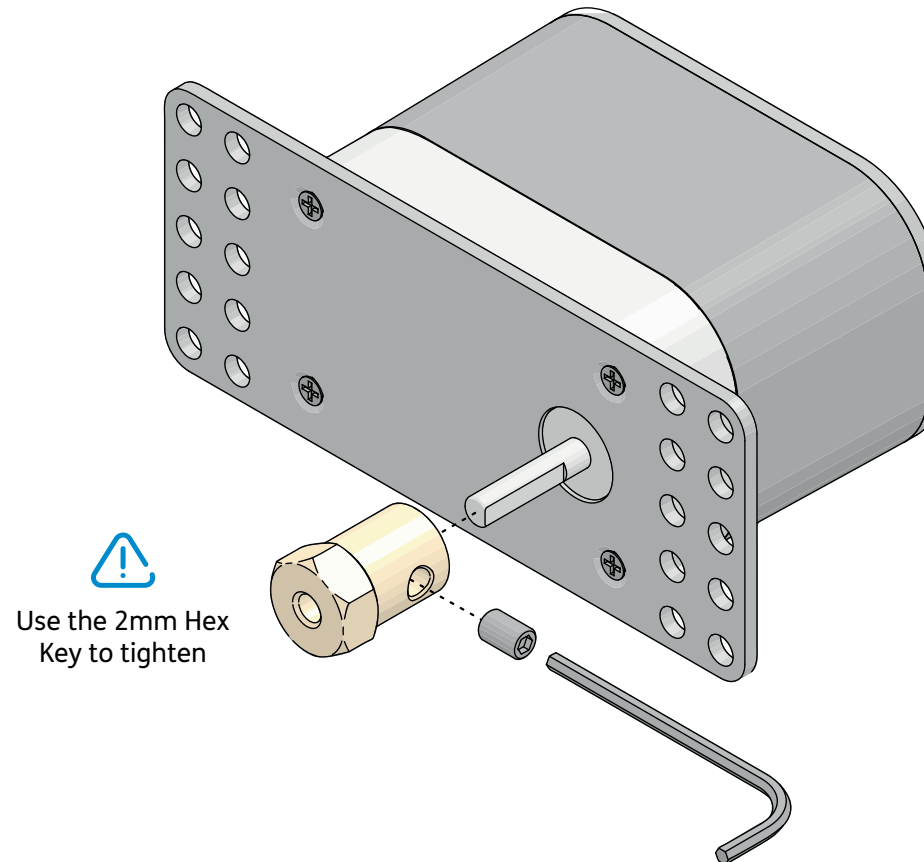

Use the 2mm Hex
Key to tighten

Right motor

Part 2

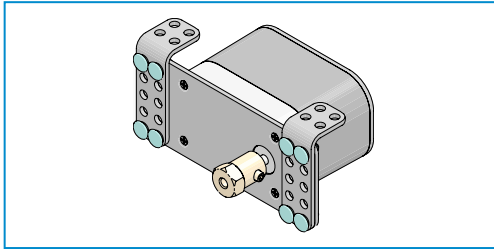
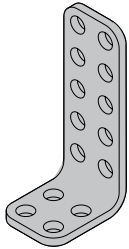
**x2**90° Build Plates
(2x5)**x8**

Short Rivets

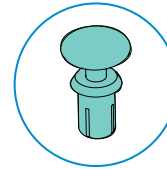

Short Rivets

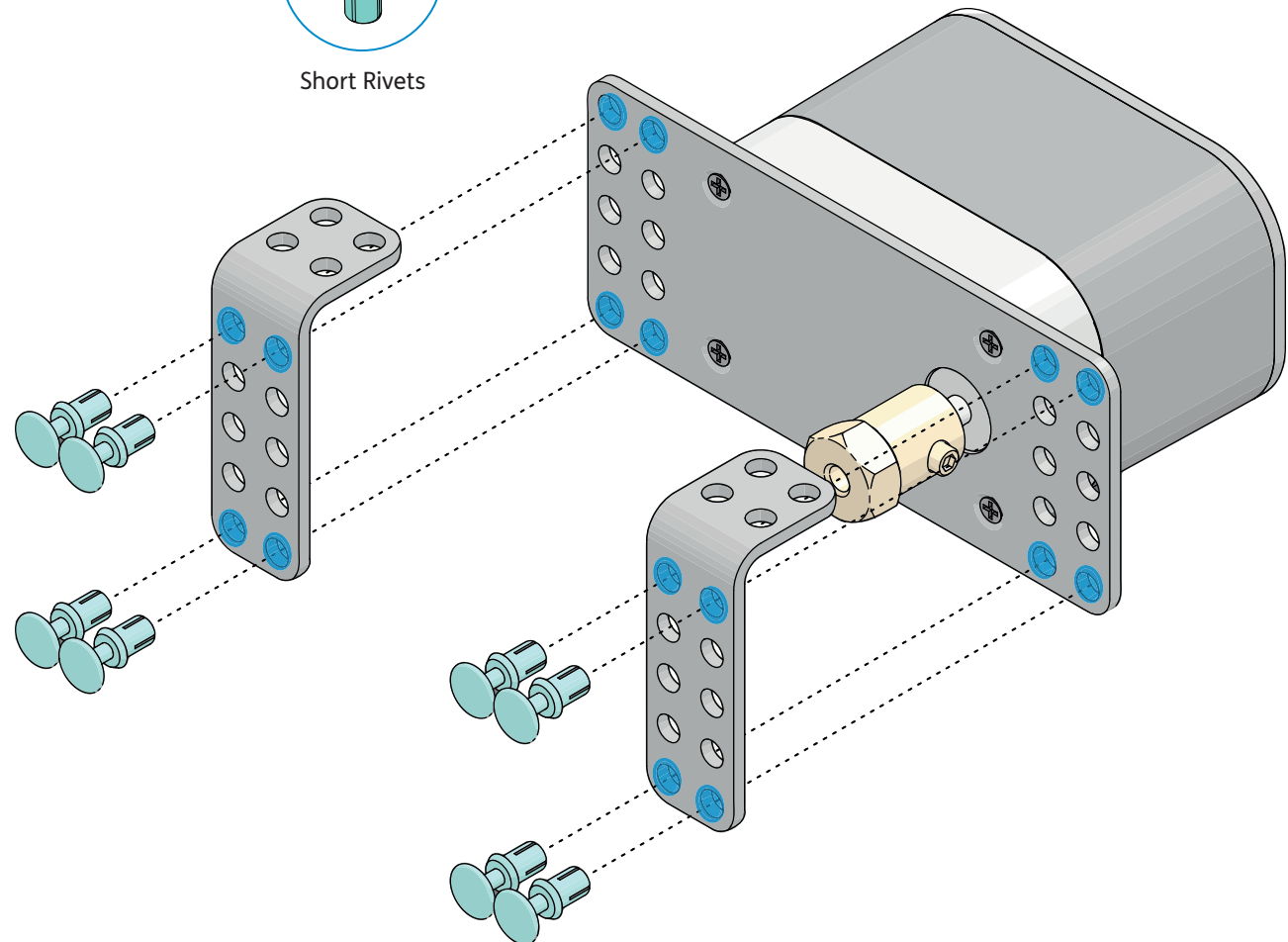

Motor assembly

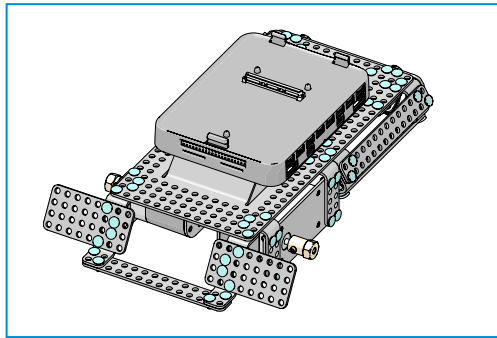
**x8**

Short Rivets

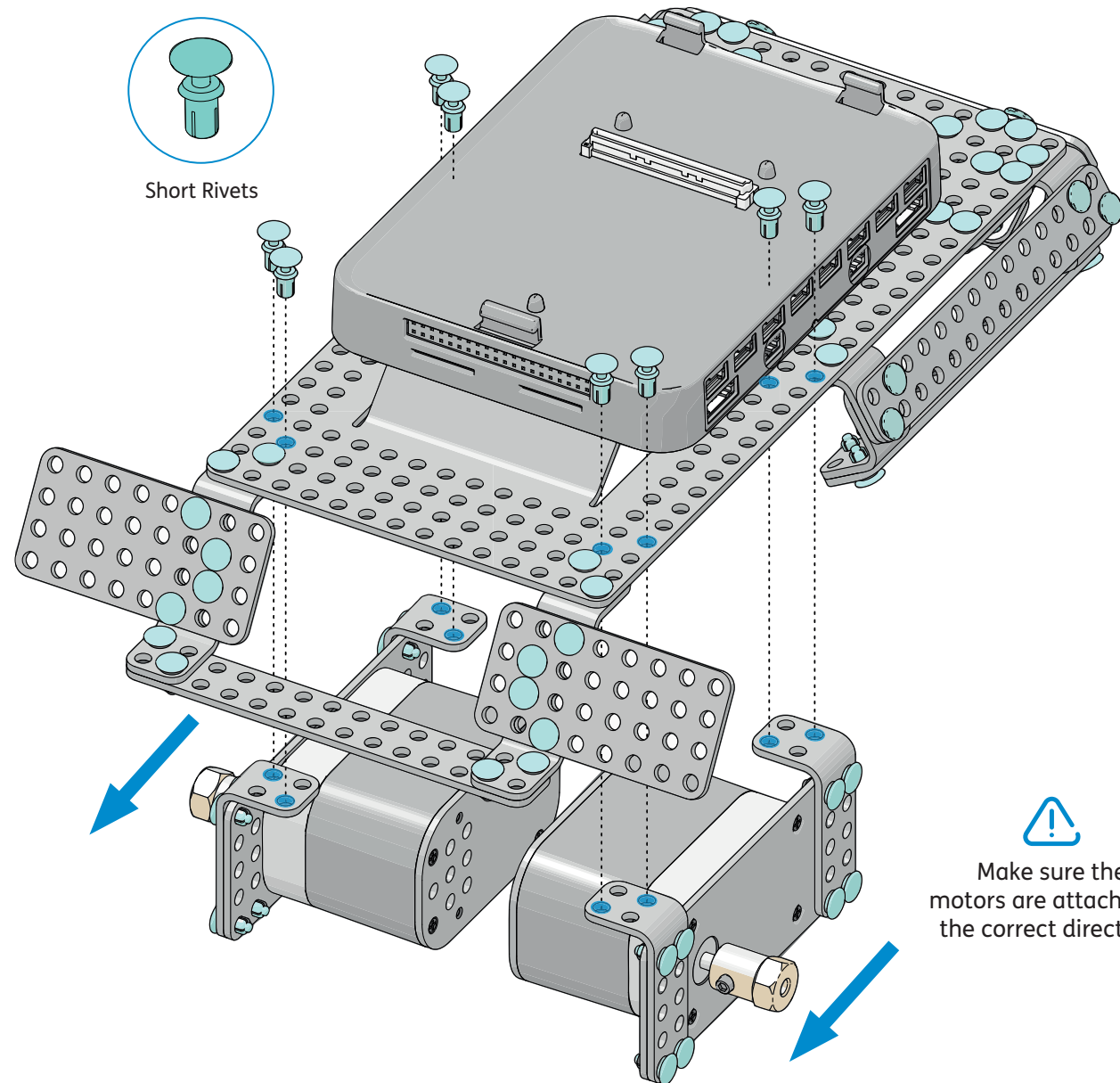

Wheels

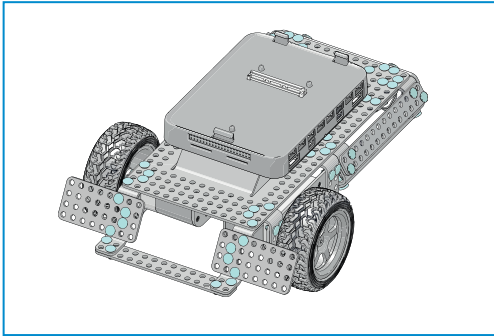
**x2**

Wheels

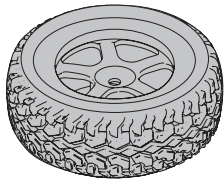
**x2**

M4 Wheel Screws

**x1**

2.5mm Hex Key

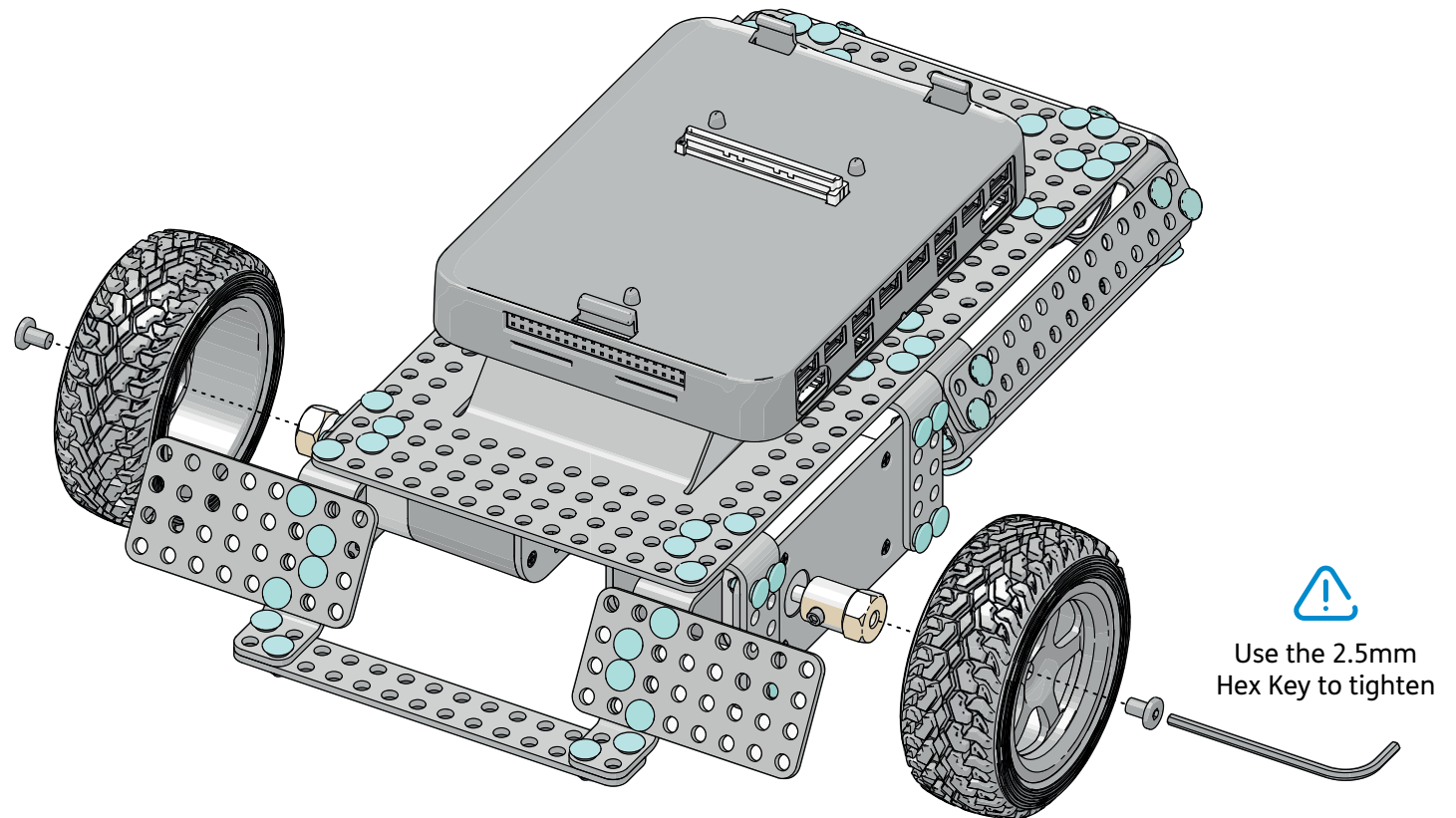
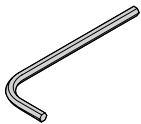

Pan-tilt servo mechanism

Part 1

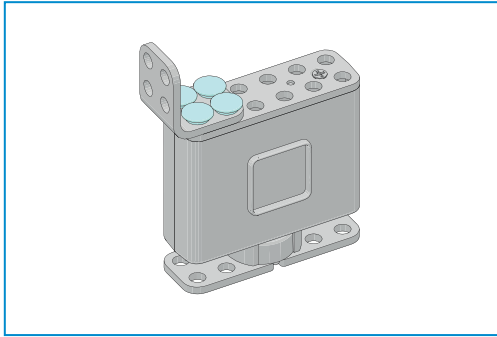

x1

90° Bracket
(2x2)

x1

Servo Motor

x4

Short Rivets

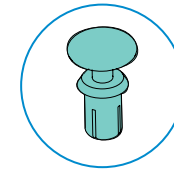
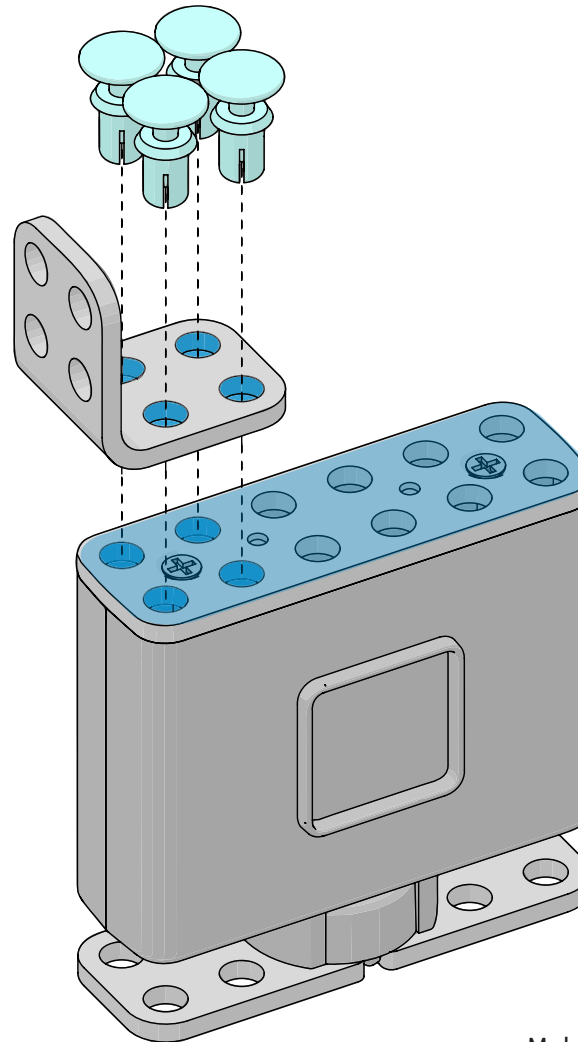
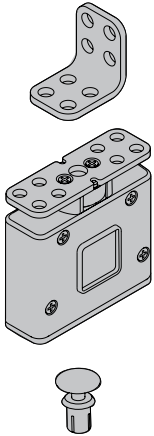

Short Rivets

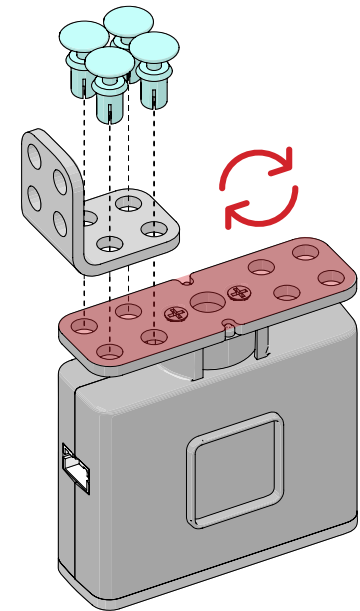

Make sure the
90° Bracket is attached
to the correct side!

Pan-tilt servo mechanism

Part 2

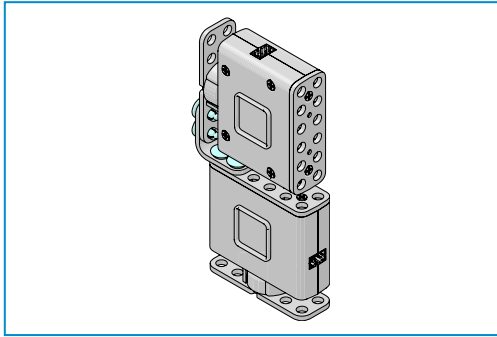

x1

Servo Motor

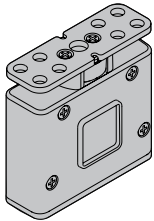

x4

Short Rivets

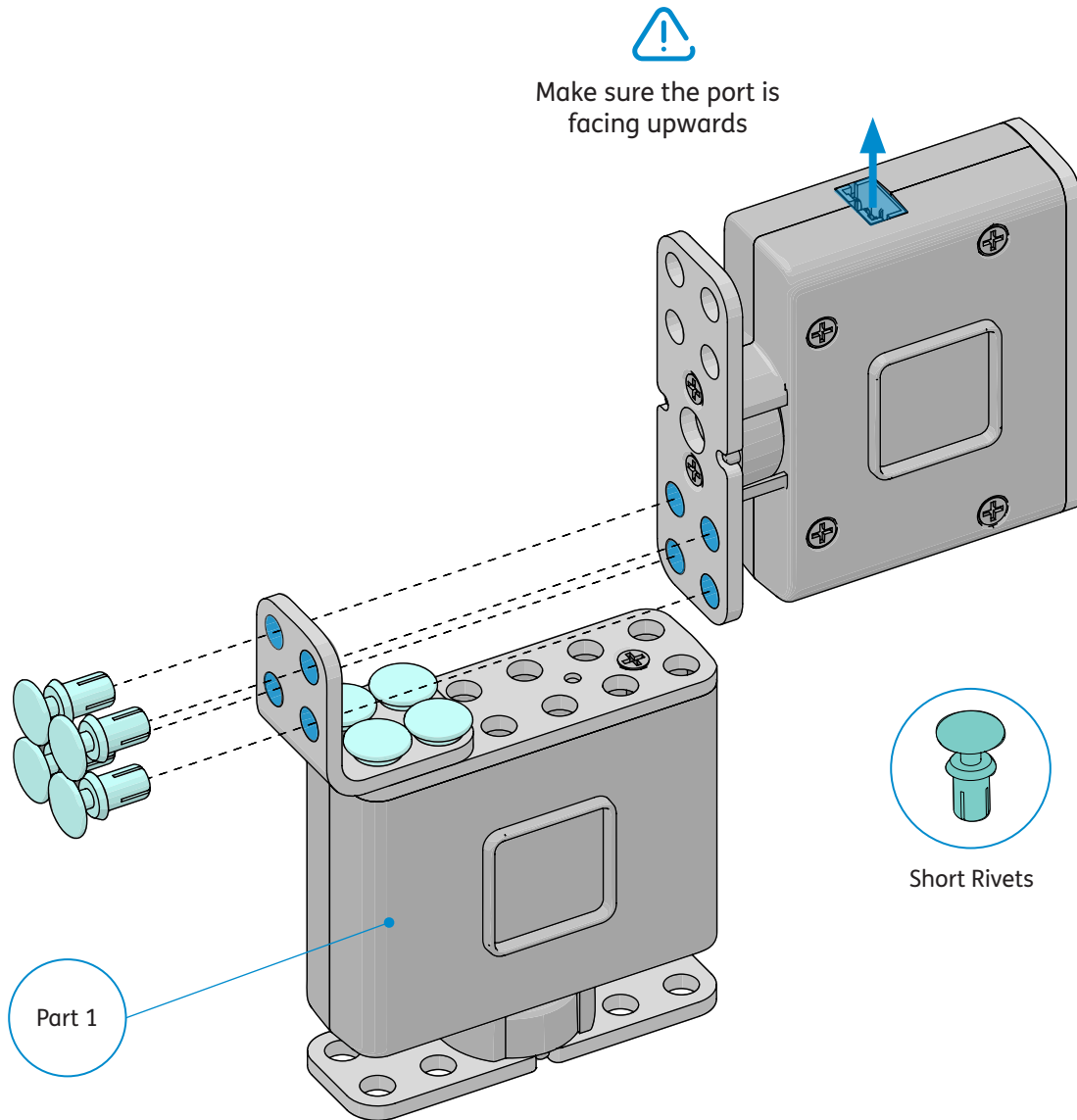

Pan-tilt servo mechanism

Part 3

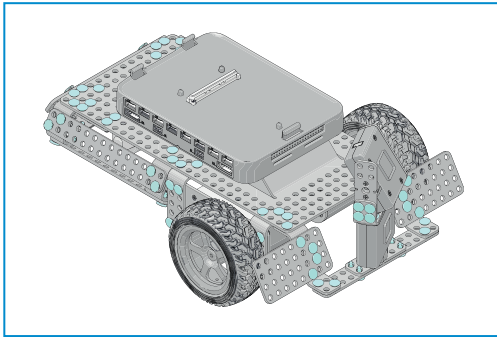

x4

Short Rivets

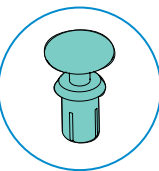
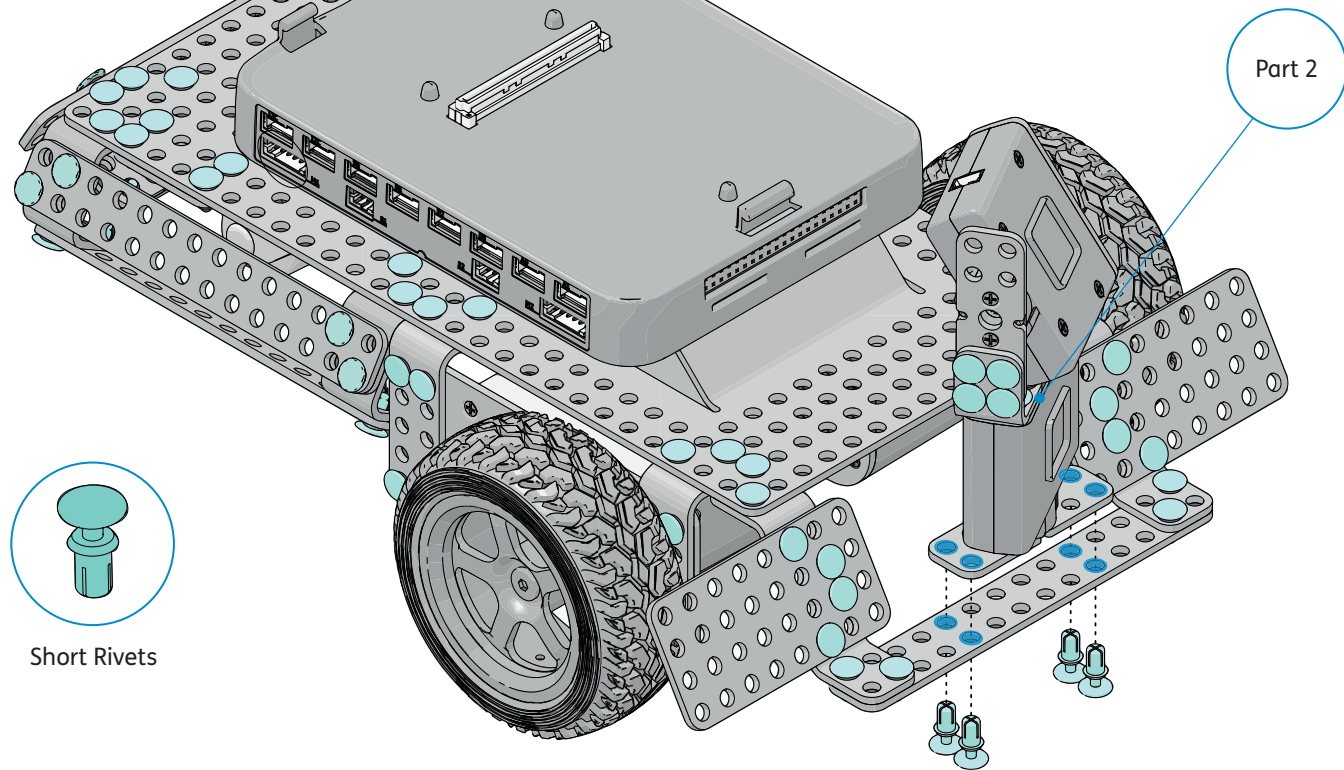

Short Rivets

Camera

x1

Camera

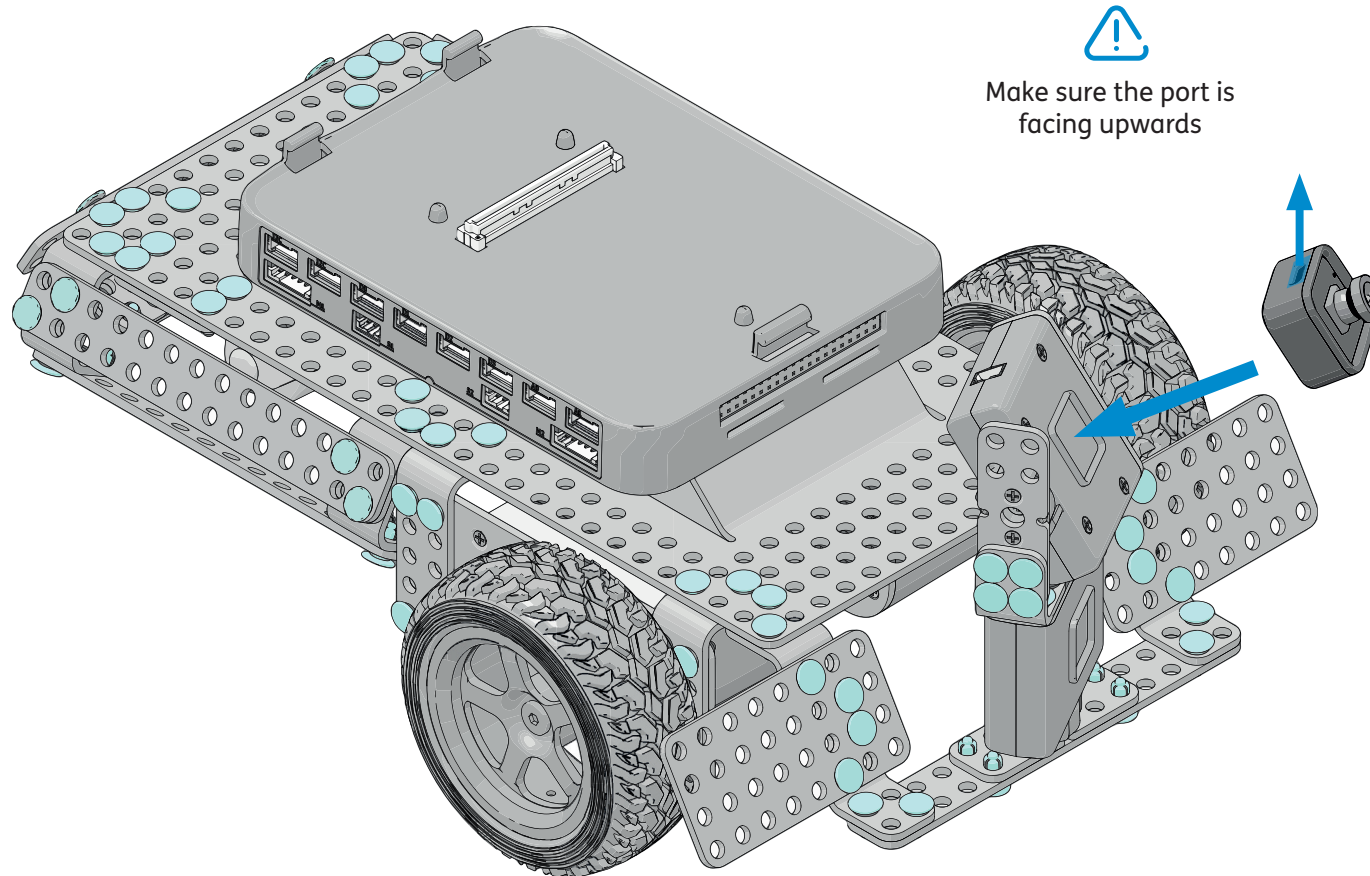
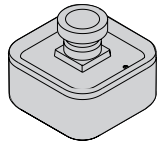

Make sure the port is
facing upwards

Ultrasonic Sensor

x1

Ultrasonic Sensor

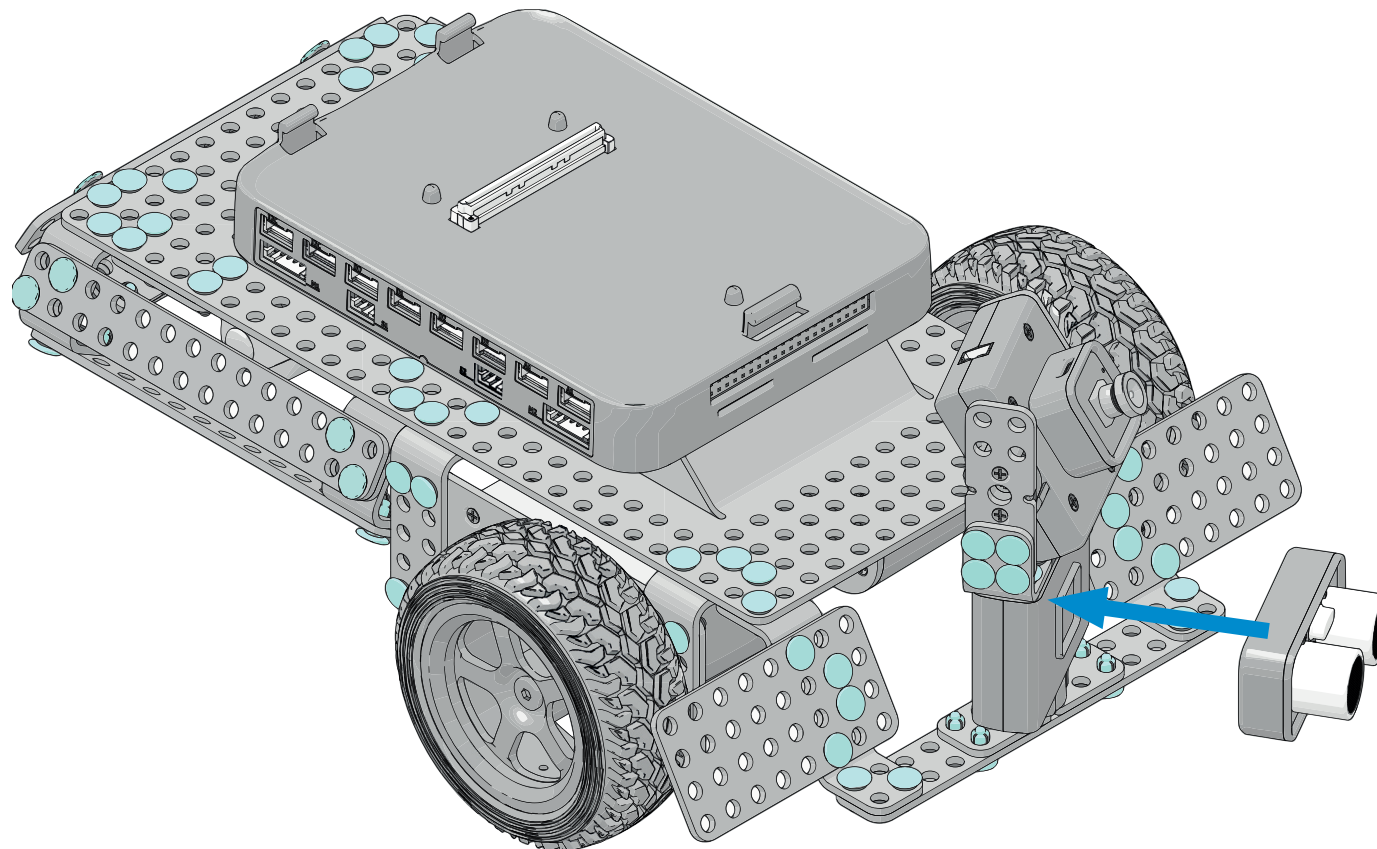
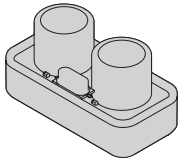

Make sure the port is
facing downwards

Dock the pi-top [4]

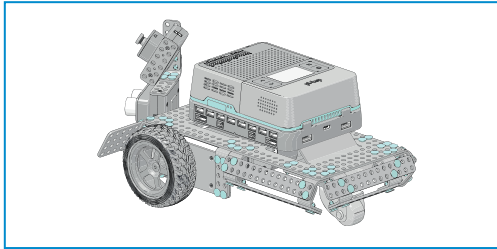

x1

pi-top [4]

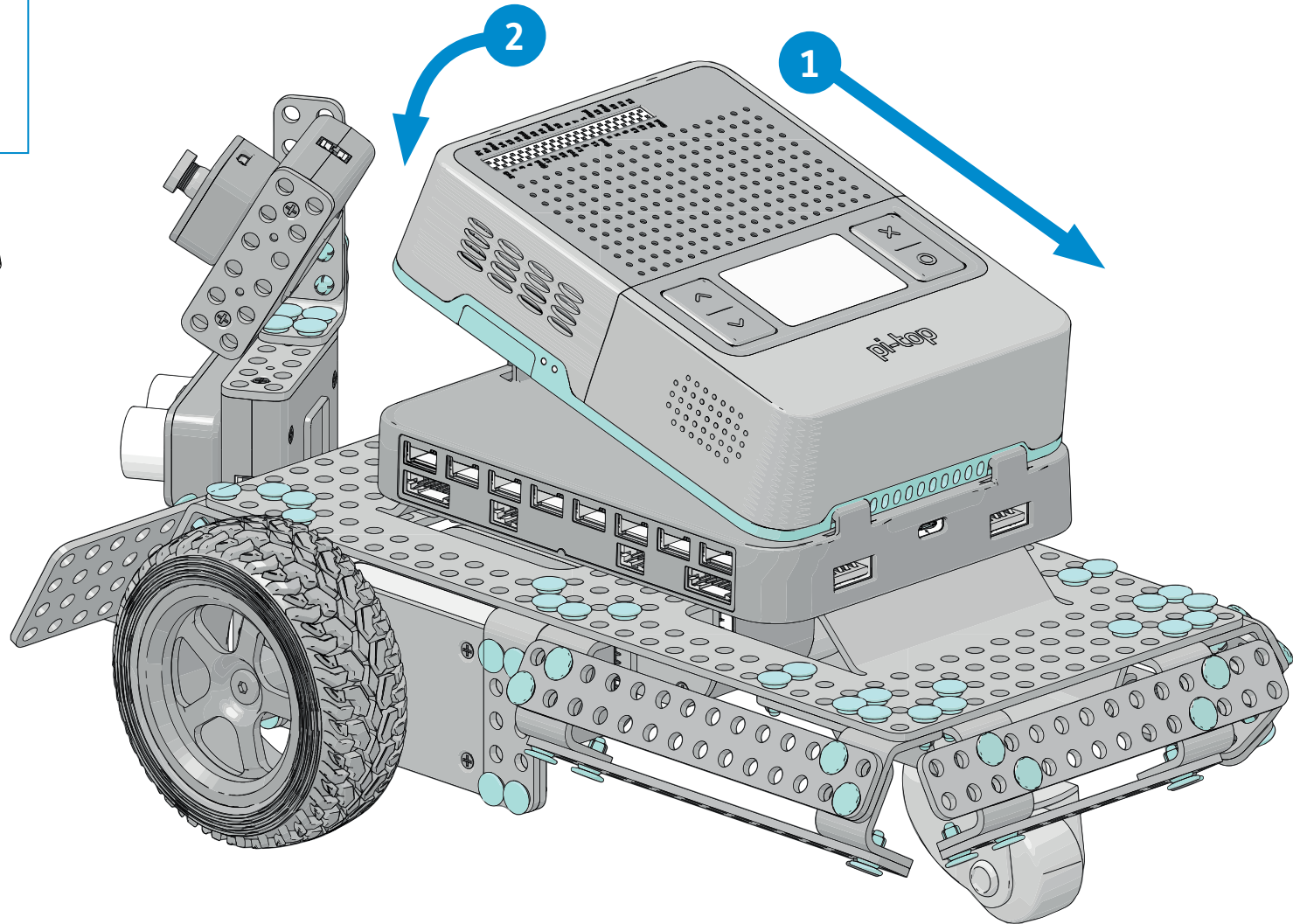
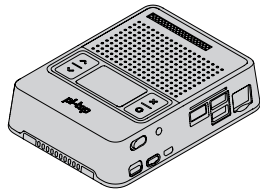

Connecting the Encoder Motors

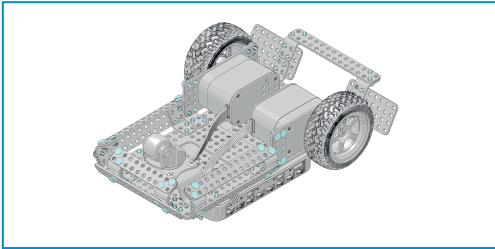

x2

6-pin Encoder Motor Cables

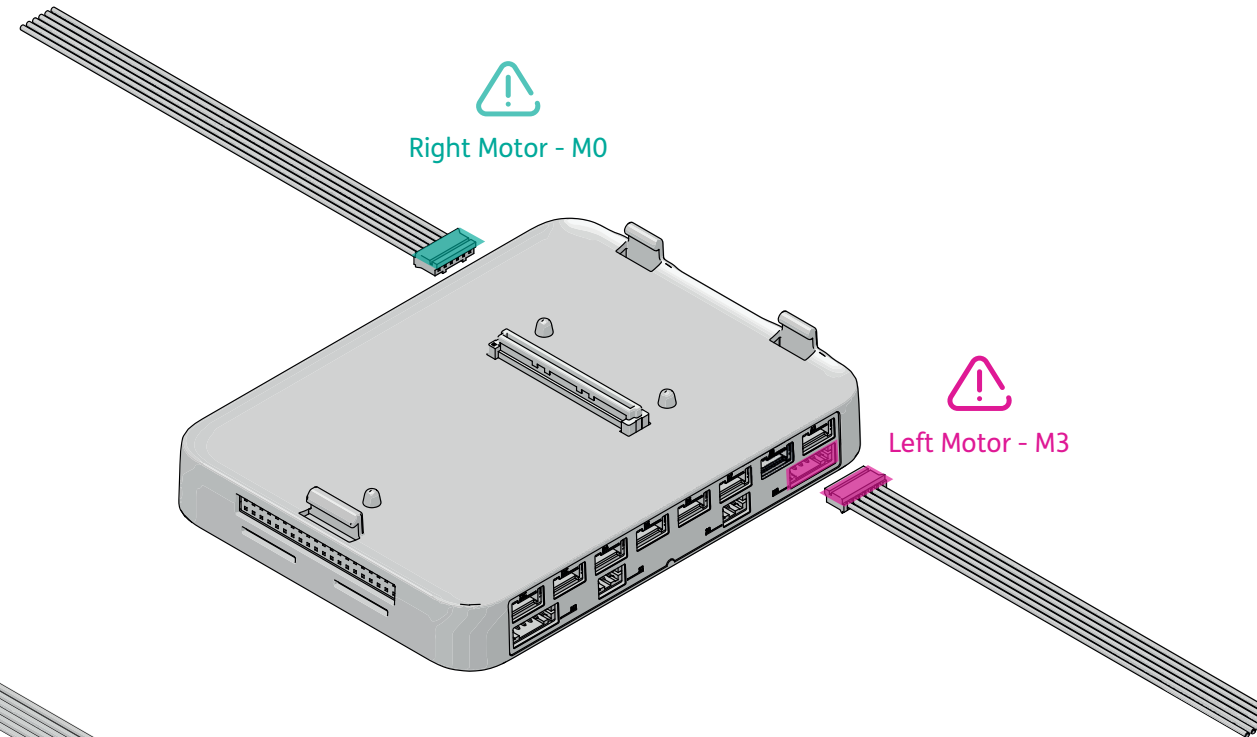
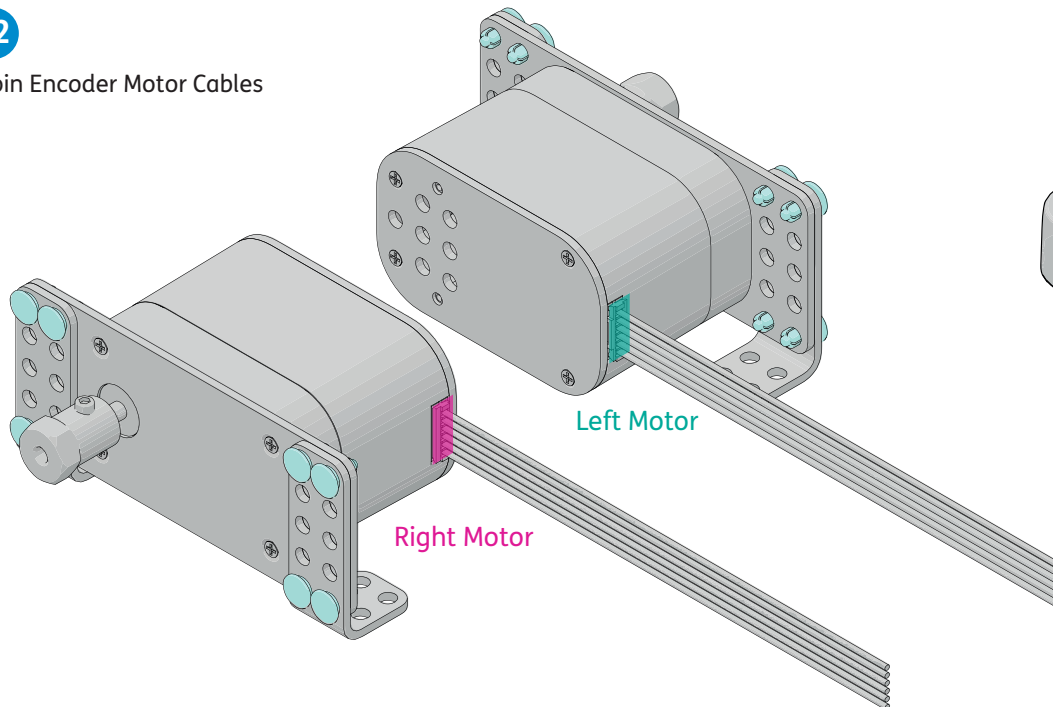

Connecting the Servo Motors

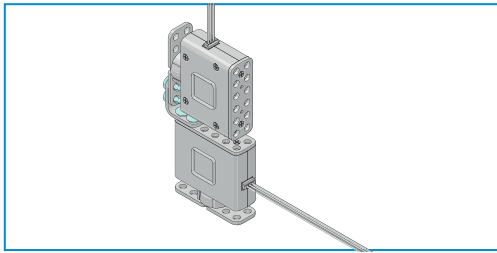

x2

3-pin Servo Motor Cables

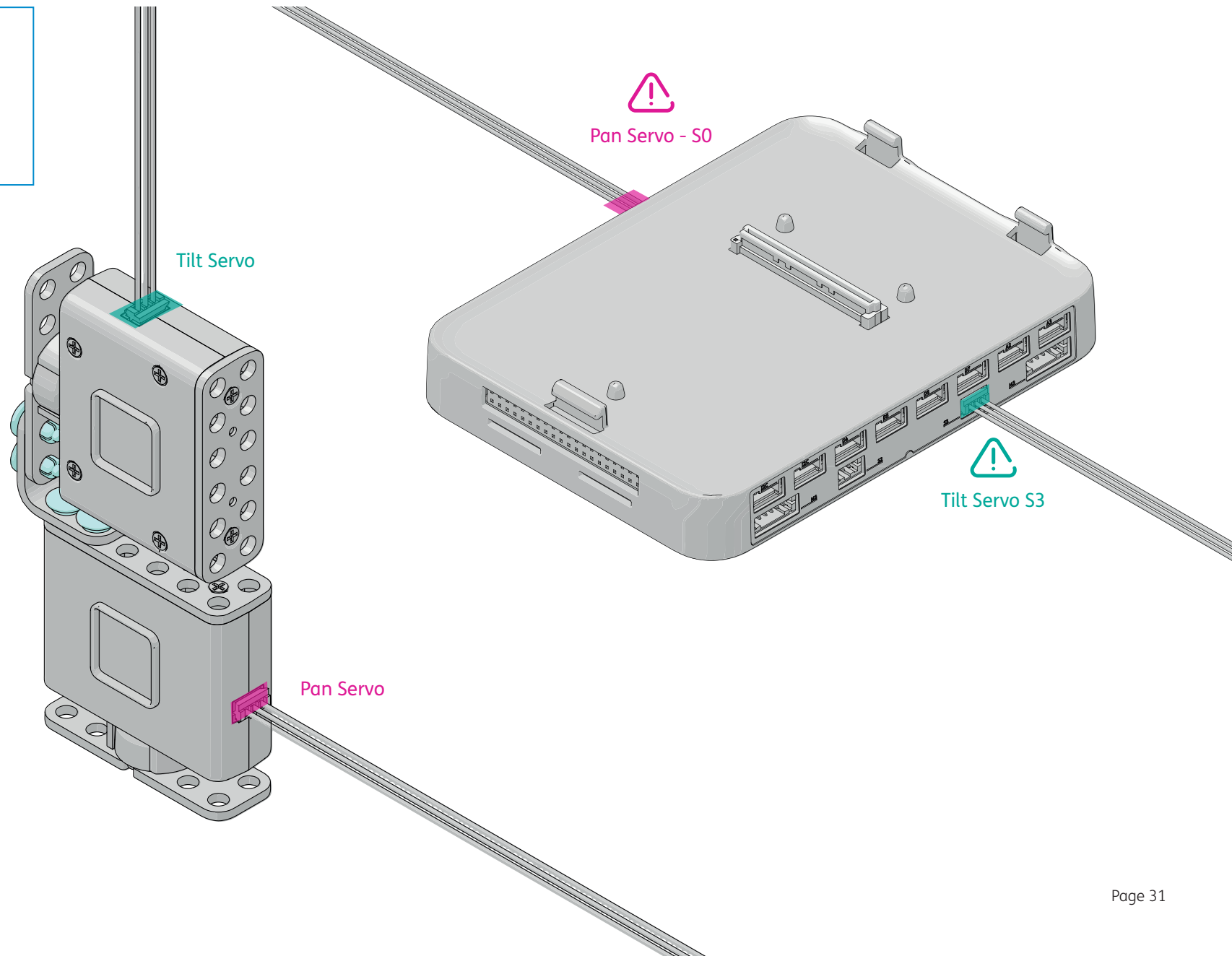

Connecting the Camera

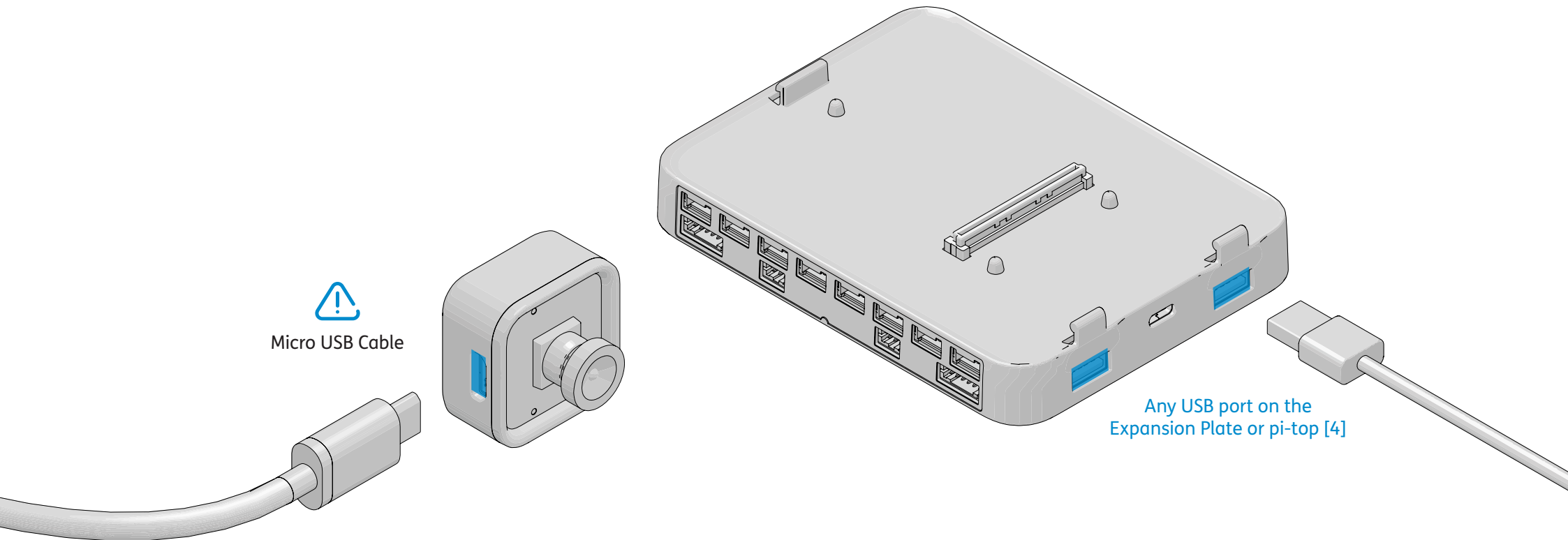

Connecting the Ultrasonic Sensor

x2

4-pin Sensor Cable

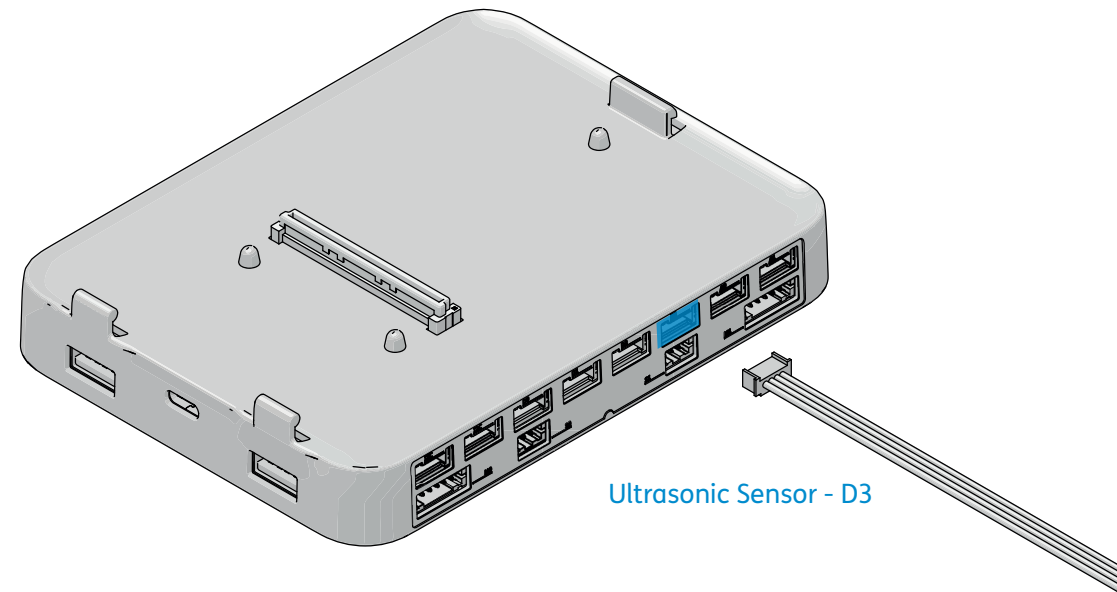
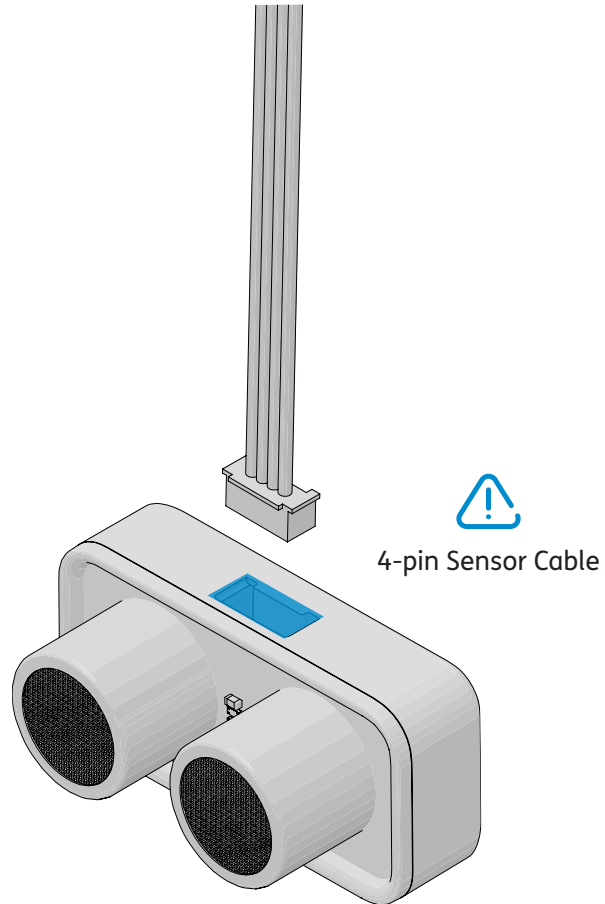



**You're ready to
get coding!**

What's next?

pi-top Robotics Kit has a wide range of resources you can use to hit the ground running with your robotics journey. Whether you're just starting out, are a seasoned pro or anything in between there's something for everyone!

Beginner

Tutorials, courses and code libraries to help you make the most of your pi-top [4]

Our online learning platform that guides students and beginners through developing coding projects.

[Log on to Further >](#)

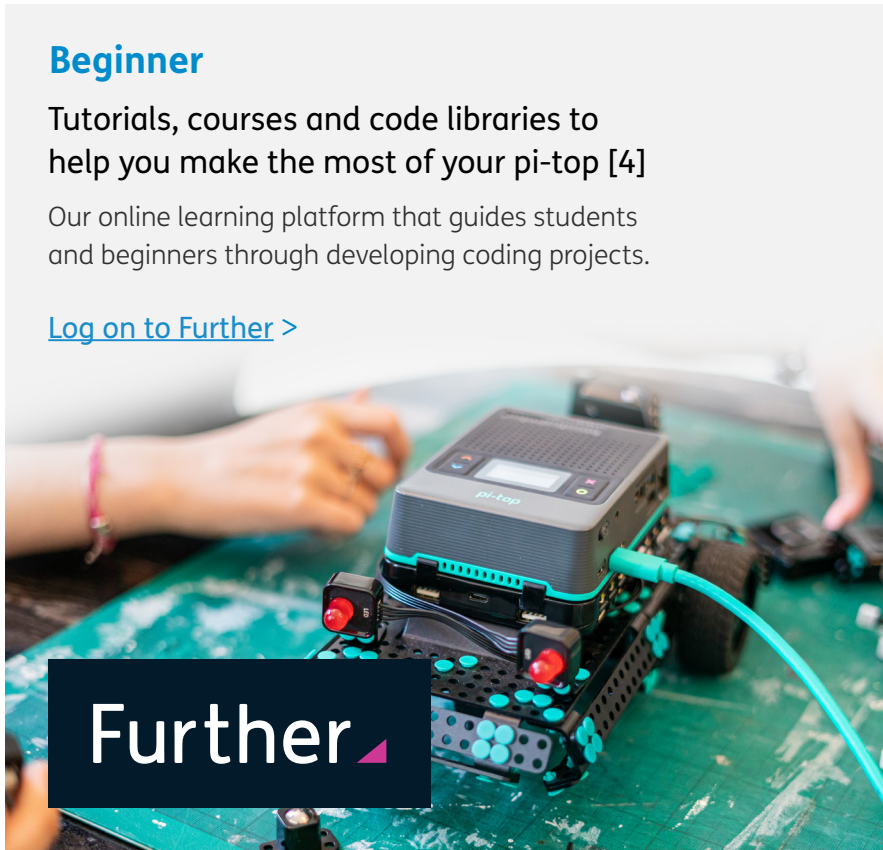

[pi-top Python SDK](#)

(Beginner to advanced)

Here you'll find all of our hardware drivers and libraries to make Python development as easy as possible.

[pi-top Python SDK Documentation](#)

(Beginner to advanced)

Comprehensive documentation for all pi-top products, including the Robotics Kit. It will help you navigate our SDKs so you can get the most out of them in the least amount of time.



[pi-top Robotics Engine \(ROS\)](#)

(Advanced)

A ROS (Robot OS) implementation that can be run on the pi-top hardware as a Docker container or as a simulation package on any Debian system - perfect for developing advanced machine learning and computer vision algorithms that you can then run in the real world! Here you'll find ROS packages, Gazebo simulation files and various apps we've developed so far that we are actively seeking community support on.



[pi-top .NET Core SDK](#)

Made in collaboration with Microsoft, you can see this SDK in action by watching our .NET Conf live video where we use it to demonstrate what a remote computer science class might look like using Microsoft Teams.



Raspberry Pi made simple,
robust and modular.

pi-top.com

Having trouble? Check out:

pi-top.com/support or forum.pi-top.com