

od5

High-end outdoor Intercom station



Ready for
Symphony
Cloud

Weather-
proof
IP65

Impact-
proof
IK08

Modular
solution

5" touch
display

Future-proof
system

Adaptive solutions for outdoor areas

Touch display equipped Intercom stations by Commend are suitable for any type of application requiring intuitive, yet precise user interaction. While offering standard menus for features such as subscriber lists, the graphical user interface can be adjusted to suit the user's requirements. Options range from creating custom menus to integrating interactive on-screen elements such as video feeds.

High-performance processors turn the od5 into a communication powerhouse. With a dedicated emergency mode feature-set, it transforms from everyday use into an emergency station for managing crises events. This means perfect preparation to meet upcoming standards – such as Advanced Security Building Intercom Systems (ASBIS) according to EN 62820-2.

These high-end Intercom stations are crafted using high-quality materials, including glass and anodised aluminium. Thanks to their timeless look, they are ideally suited for use as multi-functional Intercom stations with advanced security mode for modern office buildings.

Ready for Symphony Cloud Services

The Intercom stations can be connected to Symphony and use its services. Symphony is the world's first cloud-based Intercom platform with "Privacy and Security by Design". Visit the Symphony website to find out about the services currently available and if they are already offered in your country.

symphony.commend.com

Features and highlights

- Suitable for indoor and outdoor use
- High protection against vandalism (mechanical impact resistance IK08)
- 3 mm thick, tempered front glass
- Innovative sound concept with two lateral loudspeakers and two digital MEMS microphones
- Crystal-clear sound with up to 20 kHz speech quality and high volume
- Durable and resistant to wind and weather thanks to high-quality components and IP65 rating
- Robust, ultra-bright 5" touch display with brilliant colour reproduction
- Anti-reflective glass surface for good readability of the display – even in direct sunlight
- High-resolution wide view angle video camera
- Sophisticated housing concept for simple, safe installation
- Surface and flush mount kits with locking mechanism
- OpenDuplex® for natural, hands-free communication
- Permanent line and function testing
- Easy to extend with add-on equipment via USB interface
- Motion detection for triggering action sequences

Key benefits at a glance

Crystal clear sound: two loudspeakers and high-quality audio technology ensure a perfect listening and speaking experience.

Enhanced overview: the built-in high-resolution video camera has a picture-perfect viewing angle that allows it to capture persons who are not at eye-level with it, such as wheelchair users or children.

The Intercom stations are optimally protected against vandalism (IK08 rating).

The waterproof housing predestines the od5 for outdoor use (protection class IP65).

A question of attitude: the stations are quick and easy to configure individually over the Commend web interface.

The 5" colour touch display is individually configurable and shows the live image from the other station during video calls.



CONCERTO always strikes the right note, with two MEMS microphones making sure that no interfering background noise gets through. The software and special audio algorithms provide an exceptionally high level of speech intelligibility.

Accessories

Gypsum wall/panel kit OD5 FB

With the gypsum wall/panel mount kit OD5 FB, a base module can be installed e.g. to a gypsum wallboard. The OD5 FB is designed for wall mounting during the construction or renovation phase. The OD5 FB has a sabotage contact that can be connected to an input to inform that the od5 is being removed.



Surface mount kit OD5 SH

With the surface mount kit OD5 SH, a base module can be installed to any wall. The OD5 SH is especially designed for subsequent mounting to a wall or for mounting to thin walls. The OD5 SH has a sabotage contact that can be connected to an input to inform that the od5 is being removed.

The surface mount kit OD5 SH can be mounted to a flush mount wall box (acc. EN 60670-1; 60 mm/2.36 in screw distance; single or double box).



Flush mount box ID5 FBS

With the flush mount box ID5 FBS, a base module can be installed e.g. to a brick wall. The ID5 FBS is designed for wall mounting during the construction or renovation phase. To mount the Intercom station, the gypsum wall/panel kit OD5 FB is required.



Power injector PA 25W POE-DC

In applications where PoE sourcing equipment is not available, the optional power injector PA 25W POE-DC offers a compact, convenient solution. It supports a wide DC input range (24–48 V) and is IEEE 802.3af/at compliant. The power injector connects easily and conveniently to a station through an Ethernet cable.



Safety switch box IP Secure Connector

The IP Secure Connector provides high performance and high, absolute security, even if the connected Intercom station is located outdoors: If an unauthorised attempt is made to remove the Intercom station, e.g. to access the connected Ethernet cable, the IP Secure Connector interrupts the connection to Intercom station and LAN. This ensures that it is neither possible to access the network nor to open a door or gate.



Expansion module EB3E2A-AUD

The EB3E2A-AUD expansion module provides an easy way to expand the I/O and audio capabilities of a station. The expansion module is suitable for any applications where inputs and outputs are required. It has three inputs, two output relays and ports for direct connection of an external loudspeaker, external microphones and handset. Line-in and line-out connectors provide additional flexibility. The board can be connected to the station PCB through a USB cable and is immediately available in the system.



Induction loop kit AFIL-USB

With the AFIL-USB, a station can easily and quickly be equipped with an induction loop amplifier module. For this, only a free USB jack is required at the station. Thanks to its compact size, the AFIL-USB fits easily into a flush or surface mounting box.



USB output module EB1A

With the USB output module EB1A, a base module can be expanded with a relay output (normally open contact). The EB1A can be connected to a free USB port. By doing this, a floating, galvanically-isolated output contact is available immediately – e.g. for use with a door opener.



System overview

Serverless operation

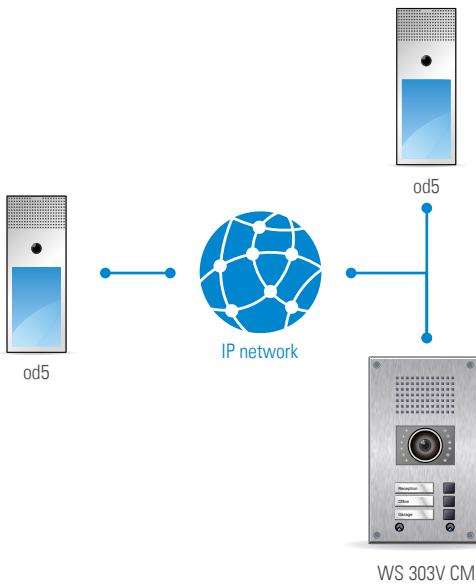

Operation with server



Wall application examples

od5 with EB1A (1 output for door opener, connected via USB)

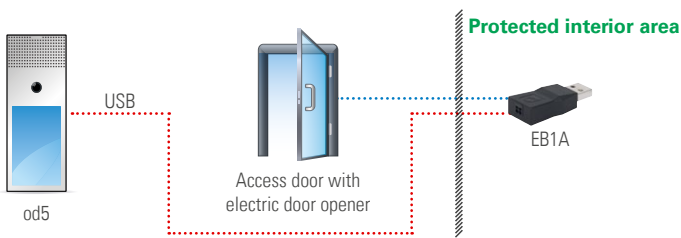

od5 with EB3E2A-AUD (3 inputs, 2 outputs, connected via USB)

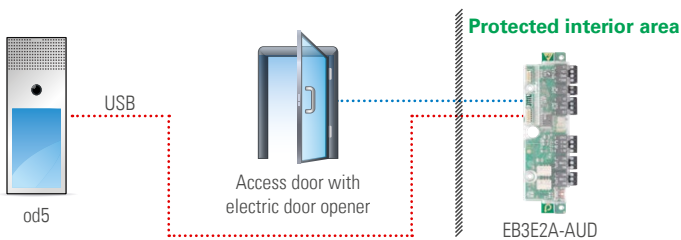

od5 with IP Secure Connector (door opener, network security and PoE, connected via Ethernet)

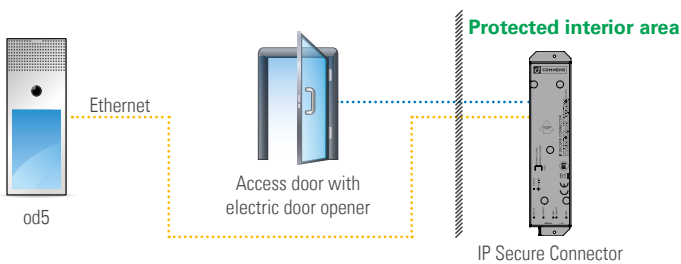

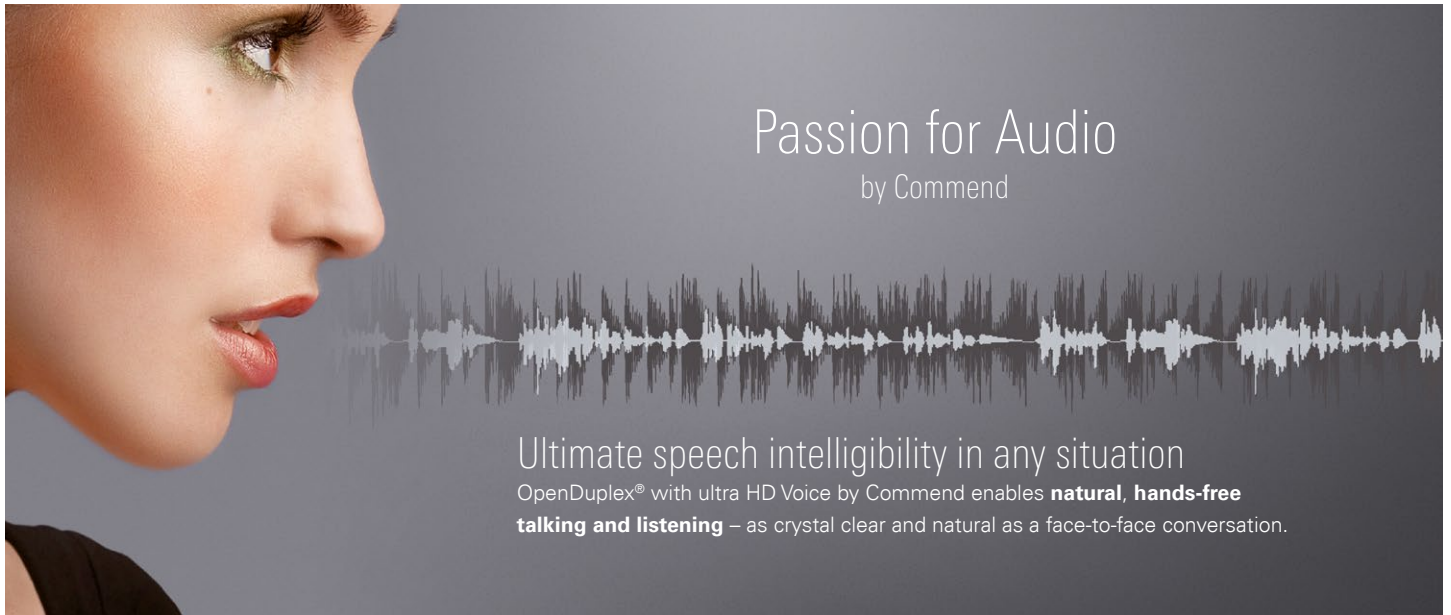

Natural communication

Beamforming

High volume

Background noise suppression

Loudspeaker/microphone surveillance

Audio // Basics

ultra HD Voice	ultra HD Voice by Commend transfers the audio signal at a bandwidth of 20 kHz
Amplifier	High efficient class-D amplifier with 2.5 W
Microphone	Two digital MEMS microphones
Loudspeaker	2 x 8 Ω loudspeaker with humidity-resistant special membrane type for optimum sound quality

Learn more audio.commend.com

Audio // Functions

- Dynamic **background noise suppression** virtually eliminates all ambient noise
- Beamforming** for best intelligibility and ambient noise suppression
- Loudspeaker/microphone surveillance** – ensures the availability of the Intercom station while reducing the need for manual verification of its functionality
- Peer-to-peer audio** – reduces network and server load to ensure efficient use of resources
- Conference call function** for simultaneous talking with multiple conversation partners
- OpenDuplex®** for natural, hands-free communication
- Switched Duplex** for situations with high noise level

od5

Technical specifications

Technical data od5

IP rating:	IP65 (acc. to EN 60529)
Mechanical impact resistance:	IK08 (acc. to EN 62262)
Salt spray test:	672 h (acc. to IEC 60068-2-11/EN 9227)
Front panel:	hardened glass, AG85, 3 mm (0.12 in)
Microphone:	two digital MEMS microphones
Loudspeaker:	special membrane type for optimal sound quality
Amplifier:	integrated class-D amplifier with 2.5 W
Sound pressure level:	max. 82 dB (± 3 dB, at 1 m)
Display:	5" touch display (TFT) resolution: 720 x 1280 pixel luminance: typ. 800 cd/m ²
Audio bandwidth:	up to 20 kHz
Audio codecs:	Opus, G.722, G.711 a-law and G.711 u-law
Video features:	codecs: H.264 (SIP video and ONVIF), Motion JPEG (HTTP video and ONVIF) and RTSP ONVIF specification: ONVIF Profile S
IT security:	SIP via TLS, SRTP, IEEE 802.1X, Motion JPEG via HTTPS, HTTPS for accessing the web interface and interfaces
Operating temperature range:	-25 °C to +55 °C (-13 °F to +131 °F)
Storage temperature range:	-25 °C to +70 °C (-13 °F to +158 °F)
Relative humidity:	up to 95%, not condensing
Connection:	RJ45 jack for Ethernet and PoE (10/100 Mbit/s) 2 x 2.0 USB (Type A) for external devices ¹⁾
Power supply ²⁾:	PoE: IEEE 802.3af/Class 0, IEEE 802.3at/Type 1
Cabling:	min. Cat. 5, shielded ³⁾
Wall mounting:	gypsum wall/panel mount kit OD5 FB flush mount box ID5 FBS (requires OD5 FB) surface mount kit OD5 SH
Dimensions (H x W x D):	with flush mount kit: 228 x 86 x 11 mm (8.98 x 3.38 x 0.43 in) with surface mount kit: 228 x 86 x 35 mm (8.98 x 3.38 x 1.38 in)
Weight incl. packaging:	approx. 600 g (1.32 lbs)
Optional accessories:	AFIL-USB (induction loop kit) EB1A (USB output module) EB3E2A-AUD (expansion module) IP Secure Connector (safety switch box)

¹⁾ The USB connections are only intended for use with Commend devices. Do not use the USB jacks e.g. to charge mobile phones.

If a USB device should be installed separately using a USB extension cable, the USB cable length must not exceed 5 m. In addition to that, it is recommended to attach a ferrite to a USB cable with a length of 1 m or more.

²⁾ For power supply, a PoE switch or PoE injector is required (not included in extent of supply), e.g. IP Secure Connector.

³⁾ The maximum line length of Cat. 5 cabling in a LAN is 100 m (328 ft) – e.g. from switch to Intercom station.



Technical data camera

Image sensor:	1/3 in RGB CMOS
Lens:	F1.9, fixed aperture, 130° horizontal angle, 110° vertical angle
Lighting conditions:	min. 5 lux (below the video image is shown in black and white)
Resolution (W x H):	720 x 1280 pixels
Frame rate:	up to 30 fps
Video streaming:	up to 6 HTTP video streams simultaneously

Extent of supply

- Intercom station
- Microfiber cloth
- Tx08 screwdriver
- Short reference

Fallback IP address

Fallback IPv4 address within a network without DHCP server:
192.168.1.150 (subnet mask: 255.255.255.0)

od5

Installation instructions

Installation instructions

- Avoid direct sunlight.
- Install the Intercom station with a distance of min. 150 mm (6 in) downwards to enable access to the locking screw (Tx08).
- For surface mounting, a surface mount kit OD5 SH is required (available separately).
- For flush mounting, a flush mount kit OD5 FB is required (available separately).
- For brick wall mounting, a flush mount kit OD5 FB and a flush mount box ID5 FBS are required (available separately).
- For mounting details, see corresponding short reference of the mount kit.
- Do not install the Intercom station on unstable walls or on surfaces which cannot support the device's weight.
- Make sure the mount kit is not subject to torsional forces (e.g. on uneven walls).
- No water may penetrate into the mount kit.
- All connected circuits shall fulfil the requirements for Electrical Energy Source Class 1 (ES1) and Limited Power Source (LPS) according to IEC/EN 62368-1.
- Use shielded Ethernet cables only.
- Before using the device, ensure all cables are correctly connected and not damaged.
- Use moistened microfibre cloths for cleaning the Intercom station.

Recommended mounting height

The upper edge of the Intercom station approx. 1,650 mm (65 in) from the finished floor. Adapt the mounting height to the individual needs.

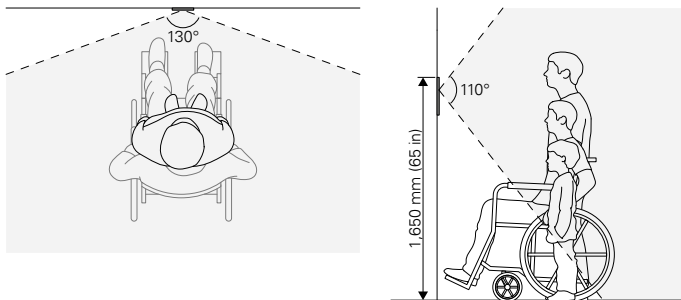

NOTE:

- For a barrier-free accessibility, it is recommended to mount the Intercom station with sufficient distance to walls or corners.
- When mounting the Intercom station OD5 TD CM, pay attention to the correct camera angle in terms of accessibility so that wheelchair users and children can be detected by the camera:
110° (vertical) x 130° (horizontal)

Safety instructions

- This Intercom station shall be installed or replaced by trained and qualified personnel only.
- Observe the country-specific standards for installation, mounting and configuration.
- Only use Commend accessories that comply with the Intercom station's technical specifications.
- The front of the Intercom station is made of glass. Do not use the Intercom station when the glass is damaged.
- Disconnect the Ethernet cable for any maintenance of the device.
- Do not make any modifications to the Intercom station.
- This equipment has been tested and found to comply with the limits for a Class B digital device, pursuant to part 15 of the FCC Rules. These limits are designed to provide reasonable protection against harmful interference in a residential installation. This equipment generates, uses and can radiate radio frequency energy and, if not installed and used in accordance with the instructions, may cause harmful interference to radio communications. However, there is no guarantee that interference will not occur in a particular installation. If this equipment does cause harmful interference to radio or television reception, which can be determined by turning the equipment off and on, the user is encouraged to try to correct the interference by one or more of the following measures:
 - Reorient or relocate the receiving antenna.
 - Increase the separation between the equipment and receiver.
 - Connect the equipment into an outlet on a circuit different from that to which the receiver is connected.
 - Consult the dealer or an experienced radio/TV technician for help.

Dimensions

OD5 TD CM

Measuring units in mm (in), not to scale!

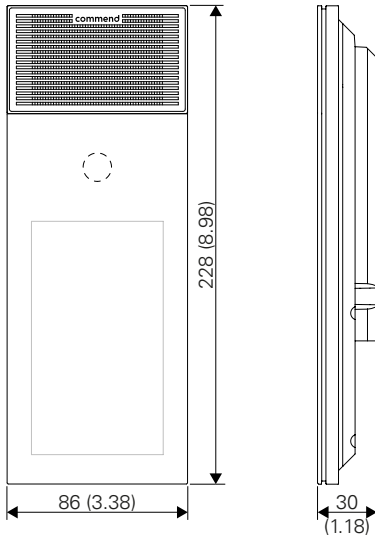

Surface mount kit OD5 SH

Measuring units in mm (in), not to scale!

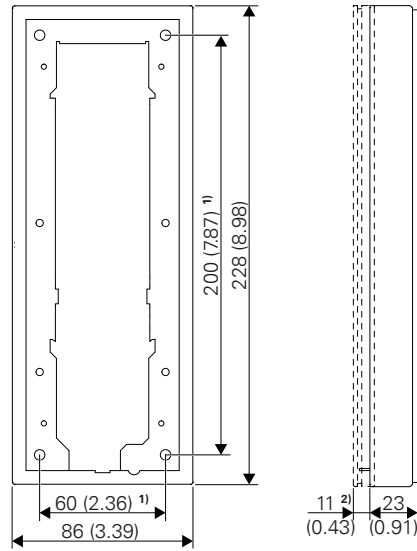

¹⁾ Dimensions for wall holes (ø 5 mm/0.2 in)

²⁾ OD5 TD CM

Gypsum wall/panel mount kit OD5 FB

Measuring units in mm (in), not to scale!

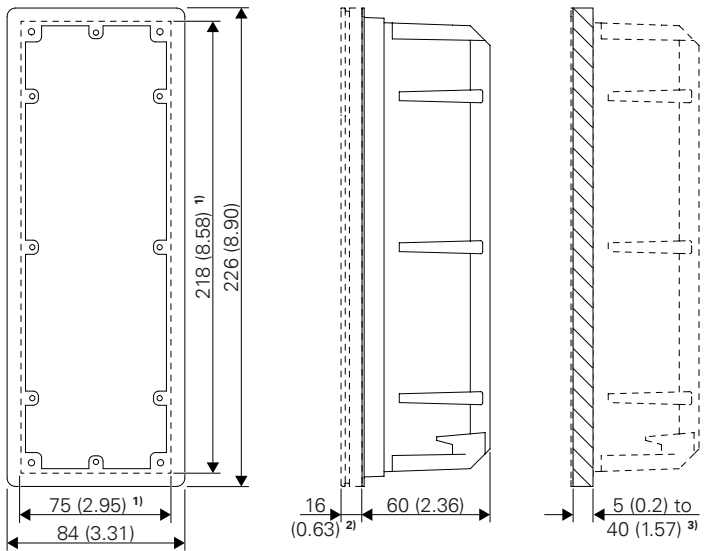

¹⁾ Cut-out for wall mounting

²⁾ OD5 TD CM

³⁾ Wall thickness

Flush mount box ID5 FBS

Measuring units in mm (in), not to scale!

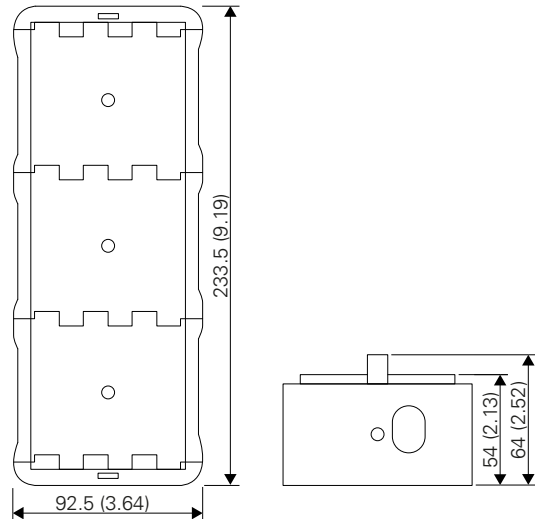

NOTE:

For mounting of an Outdoor series Intercom station to the flush mount box ID5 FBS, the gypsum/panel mount kit OD5 FB is required.

Wall mounting with OD5 FB

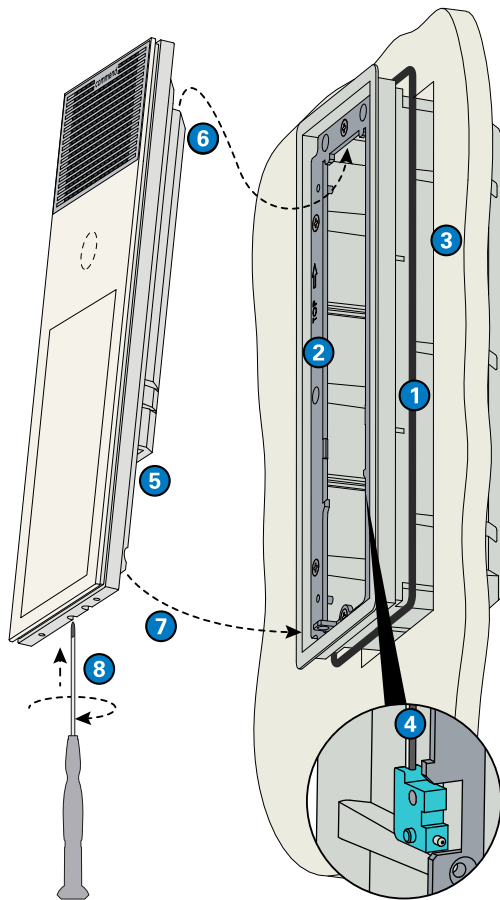

- 1 If necessary, stick the supplied gasket onto the mounting box.
- 2 Make sure the arrows on the mounting frame point upwards.
- 3 Install the mounting box to the wall by means of the supplied drilling template.
- 4 If required, connect the tamper switch to a module with an input (e.g. IP Secure Connector or EB2E3A-AUD). This input must be configured accordingly via the web interface of the OD5 TD (see also manual "OD5 TD").
- 5 Connect the required cables (Ethernet and USB cable, if needed).
- 6 Insert the Intercom station at the top of the surface mount kit.
- 7 Press the Intercom station with its lower end onto the mounting box.
- 8 Turn the locking screw anti-clockwise down as far as it will go using the Tx08 screwdriver (included in extent of supply of the OD5 TD). Check whether the lower end of the Intercom station is fixed on the mounting frame.

NOTE:

For mounting on brick walls, additionally the flush mount box ID5 FBS is required (not included in extent of supply). In this case, mount the flush mount box ID5 FBS to the wall and then continue with 1.

Surface mounting with OD5 SH

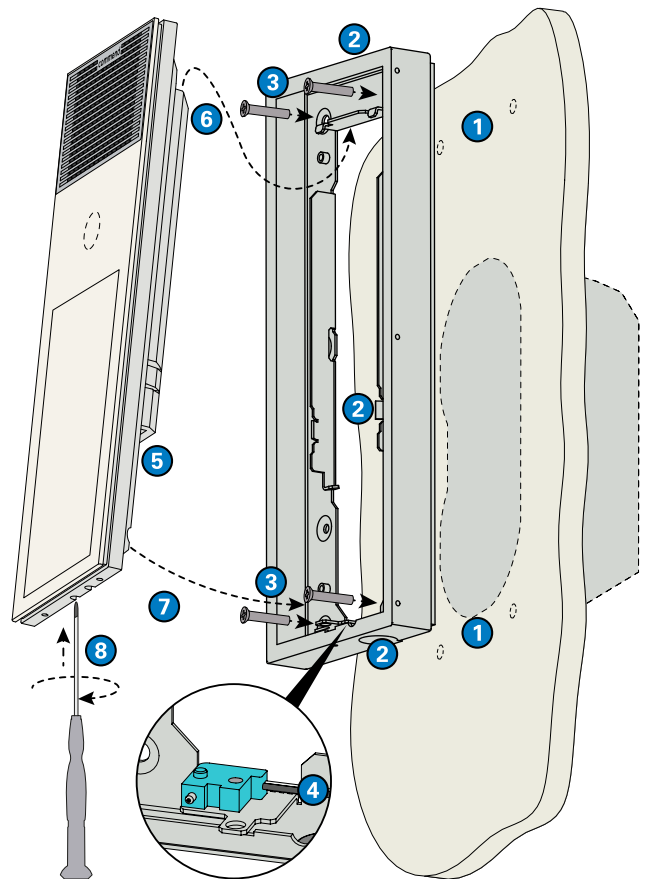

- 1 Drill four holes in the wall (see "Dimensions") and insert the supplied dowels or alternatively prepare a standard double flush mount box for mounting.
- 2 Guide the required cables (Ethernet and USB cable, if needed) through one of the provided cable entries (from bottom or rear).
- 3 Install the surface mount kit to the wall using the supplied mounting screws (the locking element must be at the lower end).
- 4 If required, connect the tamper switch to a module with an input (e.g. IP Secure Connector or EB2E3A-AUD). This input must be configured accordingly via the web interface of the OD5 TD (see also manual "OD5 TD").
- 5 Connect the cables. Observe the cable run.
- 6 Insert the Intercom station at the top of the surface mount kit.
- 7 Press the Intercom station with its lower end firmly onto the surface mount kit.
- 8 Turn the locking screw anti-clockwise down as far as it will go using the Tx08 screwdriver (included in extent of supply of the OD5 TD). Check whether the lower end of the Intercom station is fixed on the surface mount kit.

Quality tested. Reliable. Smart.

COMMEND products are developed and manufactured by Commend International in Salzburg, Austria.

The development and manufacturing processes are certified in accordance with **EN ISO 9001:2015**.



The technical data contained herein has been provided solely for informational purposes and is not legally binding. Subject to change, technical or otherwise. lolP®, OpenDuplex® and Commend® are trademarks registered by Commend International GmbH. All other brands or product names are trademarks or registered trademarks of the respective owner and have not been specifically earmarked.

A strong worldwide network

COMMEND is represented all over the world by local Commend Partners and helps to improve security and communication with tailored Intercom solutions.

www.commend.com