

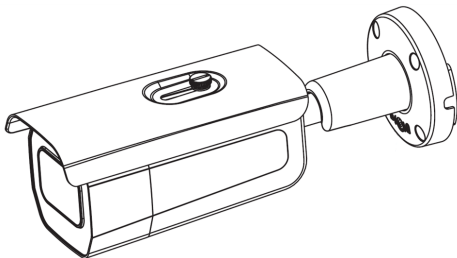

ClareVision Video
Surveillance

Varifocal Series Bullet Camera Installation Guide



For Setting up cameras and complete user manuals, please scan these QR codes:

Quick Start Guide



<https://bit.ly/34bIIIND>

User Manual



<https://bit.ly/34eKmsq>

Box Contents

- Camera
- Mounting template
- Mounting kit
- Accessory kit

Required Equipment

- Phillips head screwdriver
- Power source: Ethernet cable
- Drill with ¼" drill bit

Inspection

Ensure that the device is in good condition and all the assembly parts are included.

- Make sure that all equipment is powered off during installation.
- Ensure the mounting surface is strong enough to withstand three times the weight of the camera and the mount.
- If the product does not function properly, please contact technical support. **Do not disassemble the camera for repair or maintenance.**



WARNING: This product can expose you to chemicals including cadmium, which which is known to the State of California to cause cancer. For more information, go to www.p65warnings.ca.gov.

Overview

Before installing, familiarize yourself with the different parts of the camera.

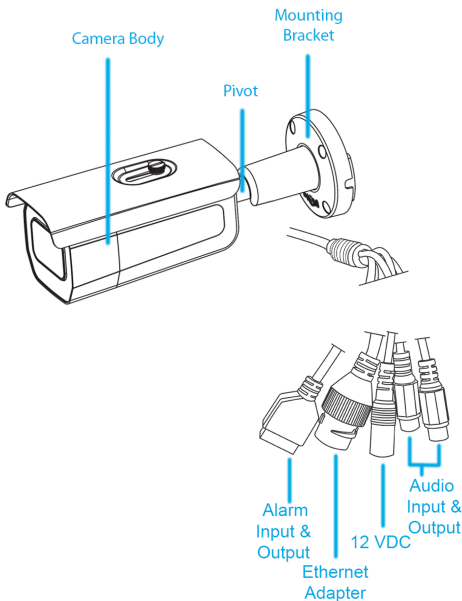

Installation

1. Drill a cable hole and ¼" pilot holes using the supplied template.
2. Connect an ethernet cable that is connect-
ed to the desired POE enabled network into
the camera's ethernet adapter.

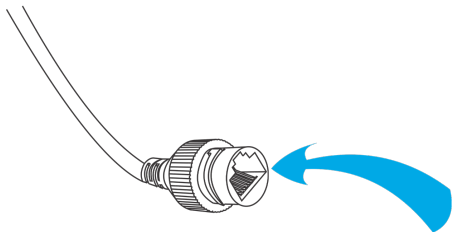

Installation

3. Insert the drywall anchors. Secure the base to the mounting surface using provided screws.

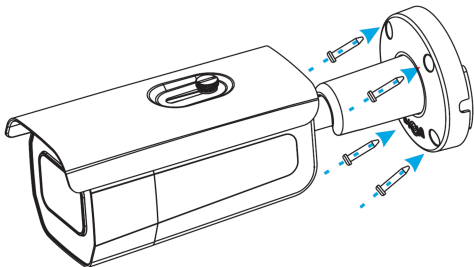

Installation

4. Using the provided hex-key, loosen the machine screws and adjust the viewing angle.

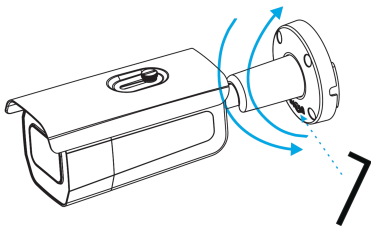

5. Using the provided hex-key, tighten the machine screw on the side until the camera body is secured firmly to the base.

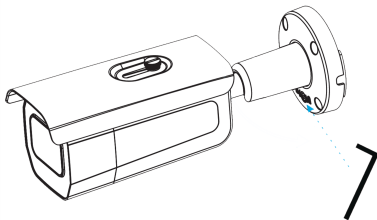

Camera Setup & Default Password

IMPORTANT NOTE: The default camera setup password is the **FIRST 6 Characters of the UUID/SN.**

You will be prompted to change the password when setting up the camera. Please refer to the Quick Start Guide for complete setup instructions or by visiting:
<https://bit.ly/34bIIND>

Support

For additional help:

Integrator/Dealer Support:

Phone: 941.404.1072

Email: claresupport@clarecontrols.com

For more information, instructional videos, or support documentation, visit our Help Center and view your item's product page:

<https://www.clarecontrols.com/helpcenter>

Contact Information

Clare Controls, LLC.

7519 Pennsylvania Ave, Suite 104

Sarasota, FL 34243

General: 941.328.3991

Fax: 941.870.9646

www.clarecontrols.com

Warranty Information

Clare Controls offers a two (2) year limited warranty on original Clare Controls components, from the date of shipment from Clare Controls. To view complete limited warranty details, including limitations and exclusions, please visit:

www.clarecontrols.com/warranty

Camera Information

Please provide this guide to the customer and notate the camera installation location and new camera password. This guide includes important camera details.

Camera Password: _____

Installattion Location: _____

Camera Details:

