

HIGH VOLUME DRY SHIPPER: ADD MORE LN2 WITHOUT SAMPLES INSIDE

PERSONAL PROTECTIVE EQUIPMENT: CRYOGENIC GLOVES, SAFETY GOGGLES

STEP 1

UNLATCHING INSTRUCTIONS



Once the shipper has arrived, remove old shipping pouch and zip-ties.



Remove zip-ties from both black handles with scissors.

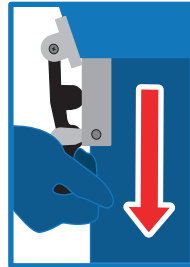

Unlatch both sides by pulling black handle down & away from the shipper.

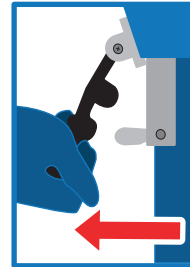

Open lid to expose the dewar.

STEP 2

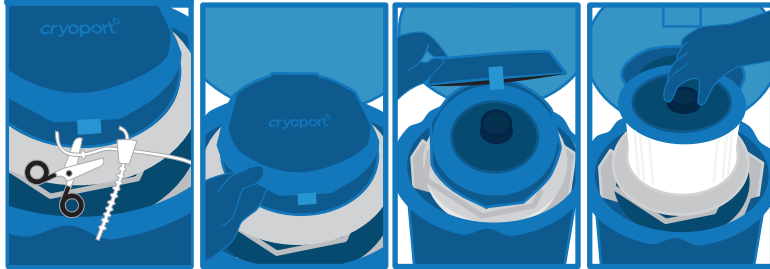

Cut off the zip tie on the hinged cap with scissors.

Open the hinged cap by pulling up on one of the two lift handles on the lid. With gloved hands, pull up on the circular handle in the center of the vapor plug to remove the vapor plug. Set the vapor plug aside.

STEP 3



Slowly pour Liquid Nitrogen into opening. Fill the dewar up to the bottom of the neck tube.

STEP 4

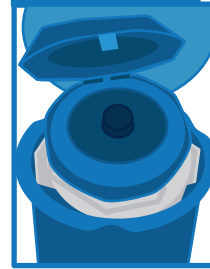

Replace the vapor plug.

STEP 5

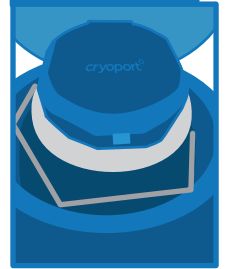

Close the hinged cap by pulling down on the lid. Let the shipper stabilize, undisturbed, for at least 30 minutes.

STEP 6

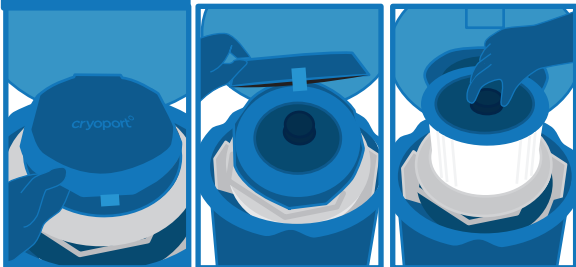

Open the hinged cap by pulling up on one of the two lift handles on the lid. With gloved hands, pull up on the circular handle in the center of the vapor plug to remove the vapor plug. Set the vapor plug aside.

STEP 7



Slowly pour Liquid Nitrogen into opening. Fill the dewar up to the bottom of the neck tube.

STEP 8

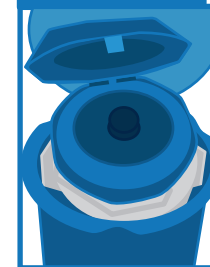

Replace the vapor plug.

STEP 9

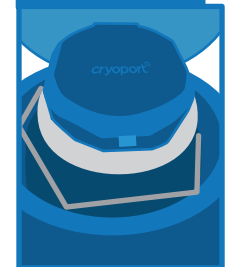

Close the hinged cap by pulling down on the lid. Let the shipper stabilize, undisturbed, overnight.

IF THE DRY SHIPPER DOES NOT EMIT VAPOR WHEN PLUG IS REMOVED
PLEASE CONTACT CUSTOMER SERVICE IMMEDIATELY, BY CALLING (949) 470-2305 OR EMAIL CS@CRYOPORT.COM

HIGH VOLUME DRY SHIPPER: ADD MORE LN2 WITHOUT SAMPLES INSIDE

STEP 10

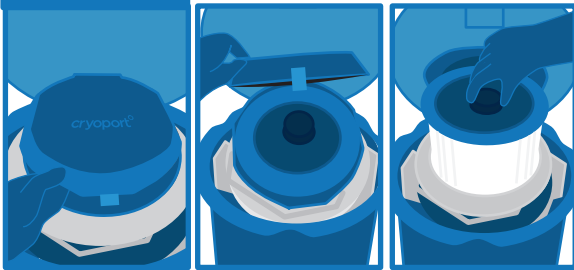

Open the hinged cap by pulling up on one of the two lift handles on the lid. With gloved hands, pull up on the circular handle in the center of the vapor plug to remove the vapor plug. Set the vapor plug aside.

STEP 11



Pour off any excess liquid nitrogen by removing the lid and tipping the open end of the dry shipper toward the ground for two seconds.

STEP 12

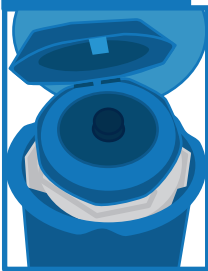

Replace the vapor plug.

STEP 13



Close the hinged cap by pulling down on the lid.

STEP 14



Secure the hinged cap with a zip tie.

STEP 15

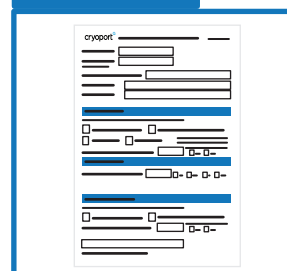

Complete the In Field Recharging form and send it to cs@cryoport.com

STEP 16

LATCHING INSTRUCTIONS

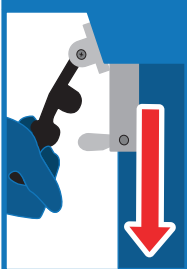

Latch handle on both sides by pulling the black handle down & then towards the shipper.

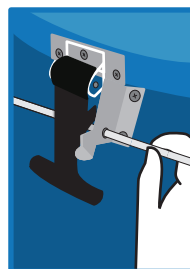
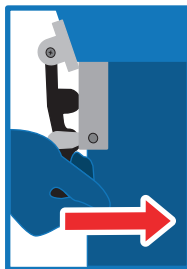

Insert zip-tie through one of the holes on the metal latch hardware.



Thread end of zip-tie through the hole on the other side of the metal hardware.

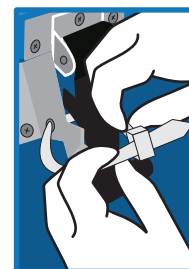

Insert zip-tie through the lid buckle and tighten.

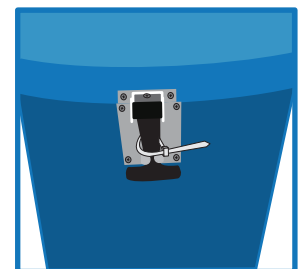

Zip-tie is now securely around the black handle.

For those shipments containing regulated dangerous goods/hazardous materials, the shipper is responsible for correctly preparing the shipment according to the current International Air Transport Association (IATA) and International Civil Aviation Organization (ICAO) dangerous goods regulations.

This includes correct identification, classification, packaging, dangerous goods markings and labeling as well as completion of all pertinent and required documentation. The shipper is the customer who is preparing the shipment at each leg in the transportation of the dry dewar packaging.

24-hour Help Line
(949) 470-2305

Cryoport, Inc. • 17305 Daimler St. • Irvine, CA 92614
Phone: 1-949-470-2300 | Fax: 1-949-470-2306
www.cryoport.com • e-mail contact: cs@cryoport.com