

## HIGH VOLUME DRY SHIPPER: ADD MORE LN2 WITH SAMPLES INSIDE

### PERSONAL PROTECTIVE EQUIPMENT: CRYOGENIC GLOVES, SAFETY GOGGLES

#### STEP 1 UNLATCHING INSTRUCTIONS

UNLATCH THE ENCLOSURE PER INSTRUCTION 9356,  
*HOW TO UNLATCH & LATCH HIGH VOLUME ENCLOSURES*

#### STEP 2

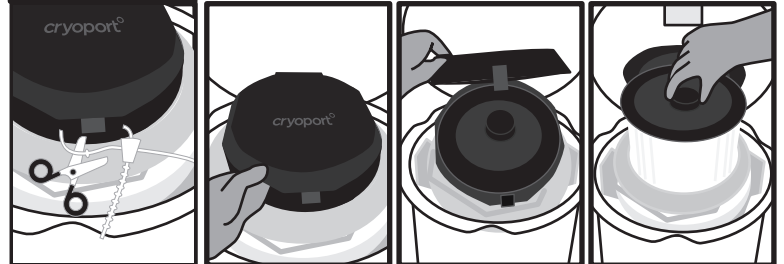

Cut off the zip tie on the hinged cap with scissors.

Open the hinged cap by pulling up on one of the two lift handles on the lid. With gloved hands, pull up on the circular handle in the center of the vapor plug to remove the vapor plug. Set the vapor plug aside.

#### CAUTION

This process may expose samples directly to liquid nitrogen.

#### STEP 3

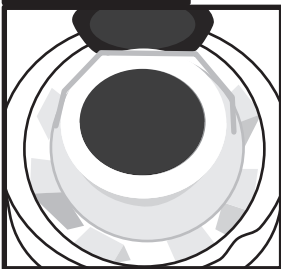

Slowly pour Liquid Nitrogen into opening. (Cryoport Client Care will provide information on the amount of LN2 to use for your specific use case.)

#### STEP 4

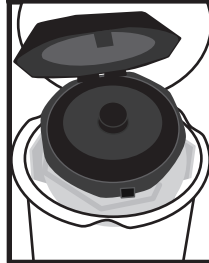

Replace the vapor plug.

#### STEP 5

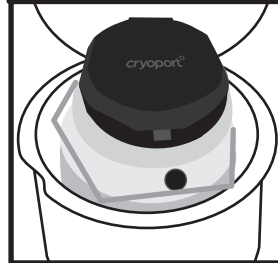

Close the hinged cap by pulling down on the lid. Let the Dry Shipper stabilize, undisturbed, for at least 30 minutes before handing it over to the carrier.

#### STEP 6

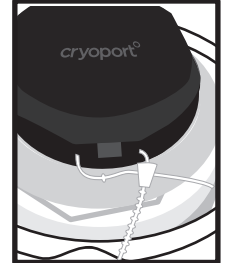

Secure the hinged cap with a zip tie.

#### STEP 7

Complete the In Field Recharging form and send it to [cs@cryoport.com](mailto:cs@cryoport.com)

#### STEP 8 LATCHING INSTRUCTIONS

LATCH THE ENCLOSURE PER INSTRUCTION 9356,  
*HOW TO UNLATCH & LATCH HIGH VOLUME ENCLOSURES*

**IF THE DRY SHIPPER DOES NOT EMIT VAPOR WHEN PLUG IS REMOVED**  
PLEASE CONTACT CUSTOMER SERVICE IMMEDIATELY, BY CALLING (949) 470-2305 OR EMAIL [CS@CRYOPORT.COM](mailto:CS@CRYOPORT.COM)

24-hour Help Line  
(949) 470-2305

Cryoport, Inc. • 17305 Daimler St. • Irvine, CA 92614  
Phone: 1-949-470-2300 | Fax: 1-949-470-2306  
[www.cryoport.com](http://www.cryoport.com) • e-mail contact: [cs@cryoport.com](mailto:cs@cryoport.com)