

PROJECT: _____	UNIT TAG: _____	QUANTITY: _____
REPRESENTATIVE: _____	TYPE OF SERVICE: _____	DATE: _____
ENGINEER: _____	SUBMITTED BY: _____	DATE: _____
CONTRACTOR: _____	APPROVED BY: _____	DATE: _____
	ORDER NO.: _____	DATE: _____



CRNE 15-12 N-FGJ-A-E-HQQE

Vertical, multistage centrifugal pump with integrated frequency converter. Pump materials in contact with the liquid are in high-grade stainless steel (EN 1.4401)

Note! Product picture may differ from actual product

Conditions of Service		Pump Data		Motor Data	
Liquid:	Water	Max pressure at stated temp:	363 psi / 250 °F	Rated power - P2:	25 HP
Temperature:	68 °F	Liquid temperature range:	-4 .. 248 °F	Rated voltage:	460 V
Specific Gravity:	1.000	Maximum ambient temperature:	104 °F	Mains frequency:	60 Hz
		Shaft seal:	HQQE	Enclosure class:	IP55
		Product number:	98181594	Insulation class:	F
				Motor protection:	YES
				Motor type:	160AC
				Eta 1/1:	91.7 %

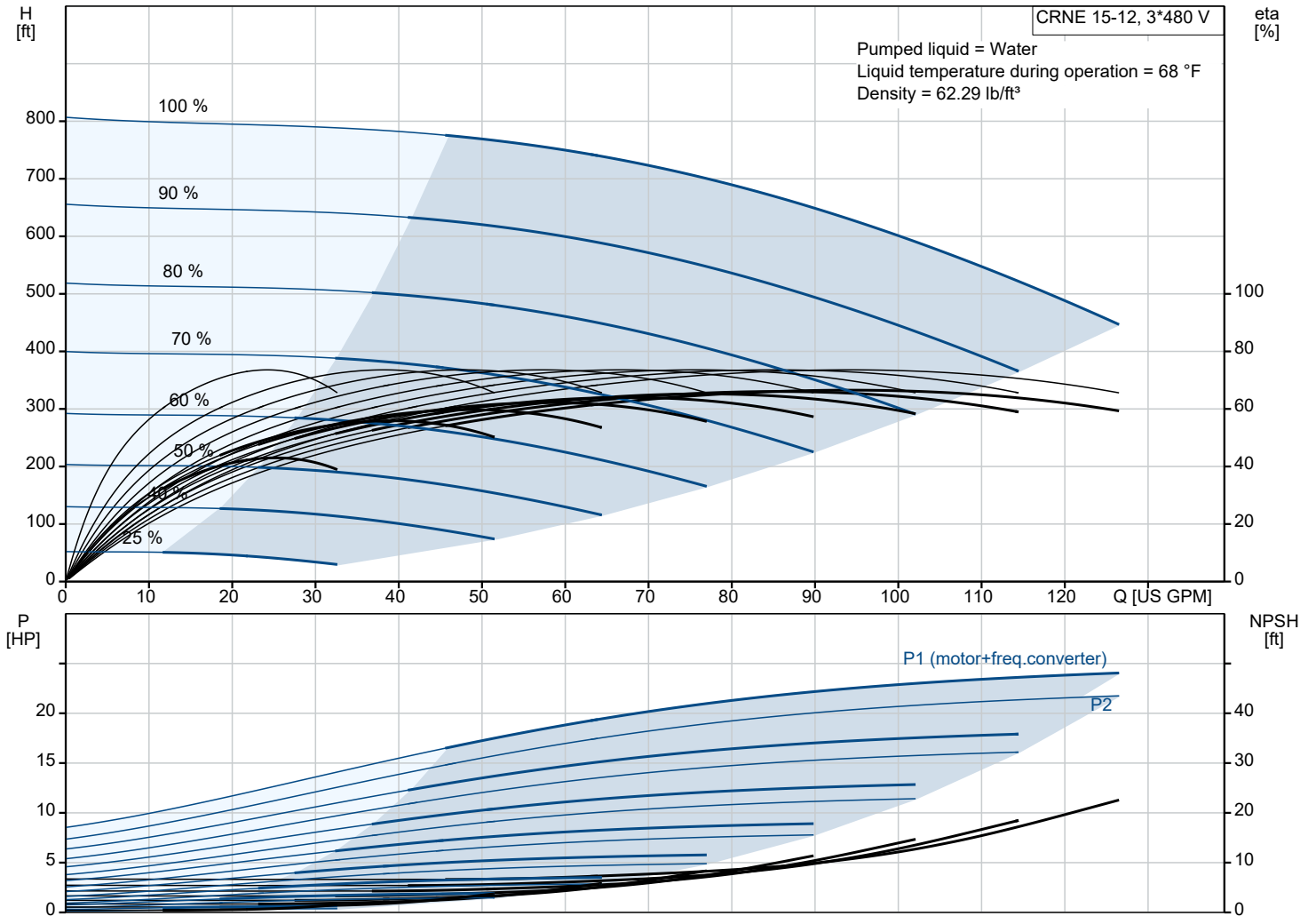

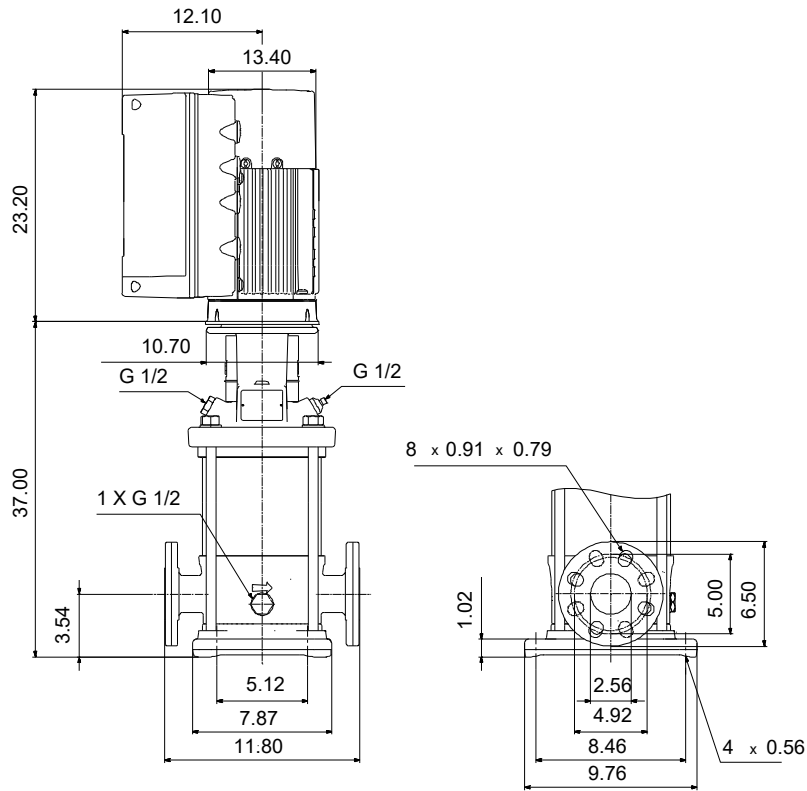

Materials:

- Base: Stainless steel
- Base: EN 1.4408
- Base: AISI 316
- Impeller: Stainless steel
- Impeller: AISI 316
- Impeller: EN 1.4401
- Material code: A
- Code for rubber: E

Qty.	Description
1	<p data-bbox="124 85 472 114">CRNE 15-12 N-FGJ-A-E-HQQE</p> <p data-bbox="124 114 389 143">Product No.: 98181594</p> <p data-bbox="124 174 1520 253">Vertical, multistage centrifugal pump with inlet and outlet ports on same the level (inline). Pump materials in contact with the liquid are in high-grade stainless steel. A cartridge shaft seal ensures high reliability, safe handling, and easy access and service. Power transmission is via a rigid split coupling. Pipe connection is via combined DIN-ANSI-JIS flanges.</p> <p data-bbox="124 264 839 293">The pump is fitted with a 3-phase, fan-cooled asynchronous motor.</p> <p data-bbox="124 293 1520 344">The motor includes a frequency converter and PI controller in the motor terminal box. This enables continuously variable control of the motor speed, which again enables adaptation of the performance to a given requirement.</p> <p data-bbox="124 344 1477 400">An operating panel on the motor terminal box enables setting of required setpoint as well as setting of pump to "Min." or "Max." operation or to "Stop". The operating panel has indicator lights for "Operation" and "Fault".</p> <p data-bbox="124 400 1469 481">Communication with the pump is possible by means of Grundfos GO Remote (accessory). The remote control enables further settings as well as reading out of a number of parameters such as "Actual value", "Speed", "Power input" and total "Power consumption".</p> <p data-bbox="124 492 719 521">The terminal box holds terminals for these connections:</p> <ul data-bbox="164 521 1453 846" style="list-style-type: none"> • pump start/stop input (potential-free contact) • remote setpoint setting via analog signal, 0-10 V, 0(4)-20 mA • 10 V voltage supply for setpoint potentiometer, I_{max} = 5 mA • three analog sensor inputs, 0-10 V, 0(4)-20 mA; the factory-fitted pressure sensor is connected to one of these inputs • 24 V voltage supply for sensor, I_{max} = 40 mA • one analog output • three digital inputs • two Pt100 inputs • two potential-free fault signal relays with changeover contact, reporting "Fault", "Operation" or "Ready" • RS-485 GENibus connection • interface for Grundfos CIM fieldbus module. <p data-bbox="124 880 201 909">Liquid:</p> <p data-bbox="124 909 557 938">Pumped liquid: Water</p> <p data-bbox="124 938 611 967">Liquid temperature range: -4 .. 248 °F</p> <p data-bbox="124 967 549 996">Selected liquid temperature: 68 °F</p> <p data-bbox="124 996 606 1025">Density: 62.29 lb/ft³</p> <p data-bbox="124 1059 237 1088">Technical:</p> <p data-bbox="124 1088 743 1117">Pump speed on which pump data are based: 3521 rpm</p> <p data-bbox="124 1117 639 1146">Rated flow: 90.3 US GPM</p> <p data-bbox="124 1146 574 1176">Rated head: 644.4 ft</p> <p data-bbox="124 1176 564 1205">Actual impeller diameter: 4.13 in</p> <p data-bbox="124 1205 572 1234">Pump orientation: Vertical</p> <p data-bbox="124 1234 560 1263">Shaft seal arrangement: Single</p> <p data-bbox="124 1263 564 1292">Code for shaft seal: HQQE</p> <p data-bbox="124 1292 577 1321">Approvals: CURUS</p> <p data-bbox="124 1321 635 1350">Approvals for drinking water: NSF/ANSI 61</p> <p data-bbox="124 1350 683 1379">Curve tolerance: ISO9906:2012 3B</p> <p data-bbox="124 1413 233 1442">Materials:</p> <p data-bbox="124 1442 647 1529">Base: Stainless steel EN 1.4408 AISI 316</p> <p data-bbox="124 1529 647 1617">Impeller: Stainless steel EN 1.4401 AISI 316</p> <p data-bbox="124 1617 533 1646">Bearing: SIC</p> <p data-bbox="124 1680 250 1709">Installation:</p> <p data-bbox="124 1709 564 1738">t max amb: 104 °F</p> <p data-bbox="124 1738 603 1767">Maximum operating pressure: 362.59 psi</p> <p data-bbox="124 1767 660 1825">Max pressure at stated temp: 363 psi / 250 °F 363 psi / -4 °F</p> <p data-bbox="124 1825 665 1854">Type of connection: DIN / ANSI / JIS</p> <p data-bbox="124 1854 560 1883">Size of inlet connection: DN 50</p> <p data-bbox="124 1883 560 1912">Size of outlet connection: DN 50</p> <p data-bbox="124 1912 560 1942">Pressure rating for connection: PN 25</p> <p data-bbox="124 1942 560 1971">Flange rating inlet: 300 lb</p> <p data-bbox="124 1971 564 2000">Flange size for motor: 284TC</p> <p data-bbox="124 2033 287 2063">Electrical data:</p> <p data-bbox="124 2063 564 2092">Motor standard: NEMA</p> <p data-bbox="124 2092 564 2121">Motor type: 160AC</p> <p data-bbox="124 2121 783 2150">IE Efficiency class: NEMA Premium / IE3 60Hz</p>

Qty.	Description
	Rated power - P2: 25 HP
	Power (P2) required by pump: 25 HP
	Mains frequency: 60 Hz
	Rated voltage: 3 x 460 V
	Service factor: 1.15
	Rated current: 30.5 A
	Cos phi - power factor: 0.88
	Rated speed: 480-3540 rpm
	Efficiency: IE3 91,7%
	Motor efficiency at full load: 91.7 %
	Number of poles: 2
	Enclosure class (IEC 34-5): IP55
	Insulation class (IEC 85): F
	Motor No: 85901138
	Controls:
	Frequency converter: Built-in
	Pressure sensor: Y
	Others:
	DOE Pump Energy Index VL: 0.47
	Net weight: 434 lb
	Gross weight: 564 lb
	Shipping volume: 28.4 ft ³

98181594 CRNE 15-12 N-FGJ-A-E-HQQE 60 Hz

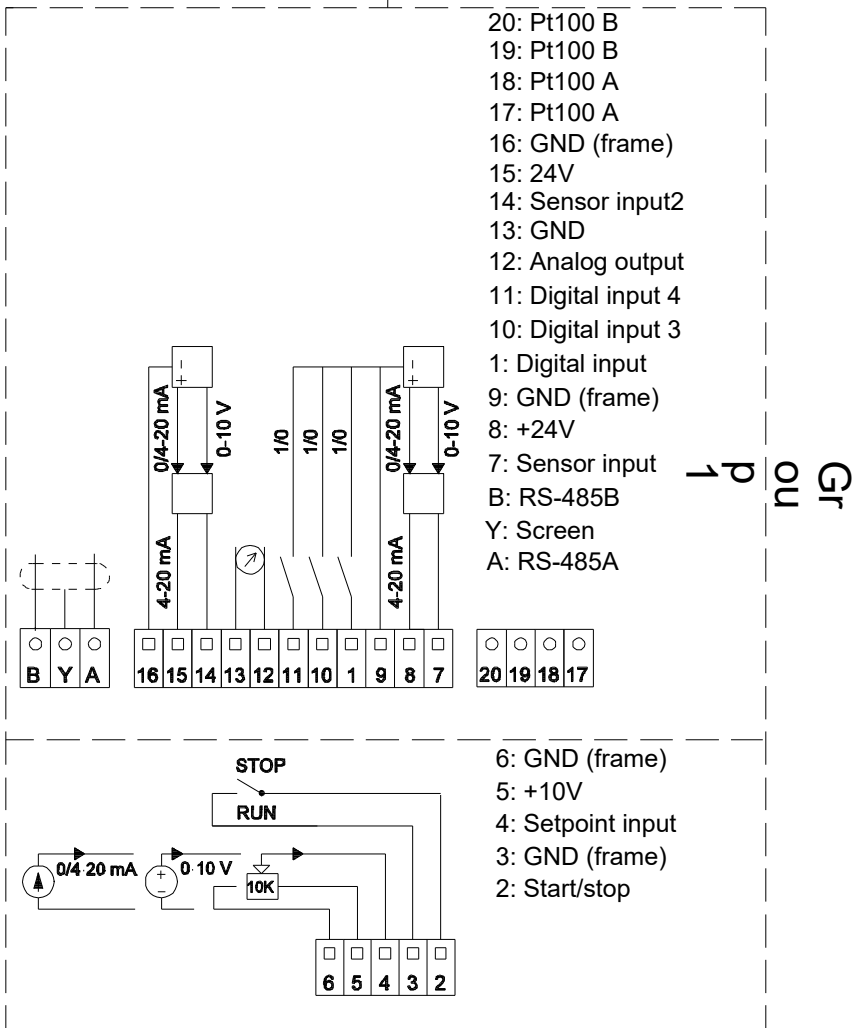
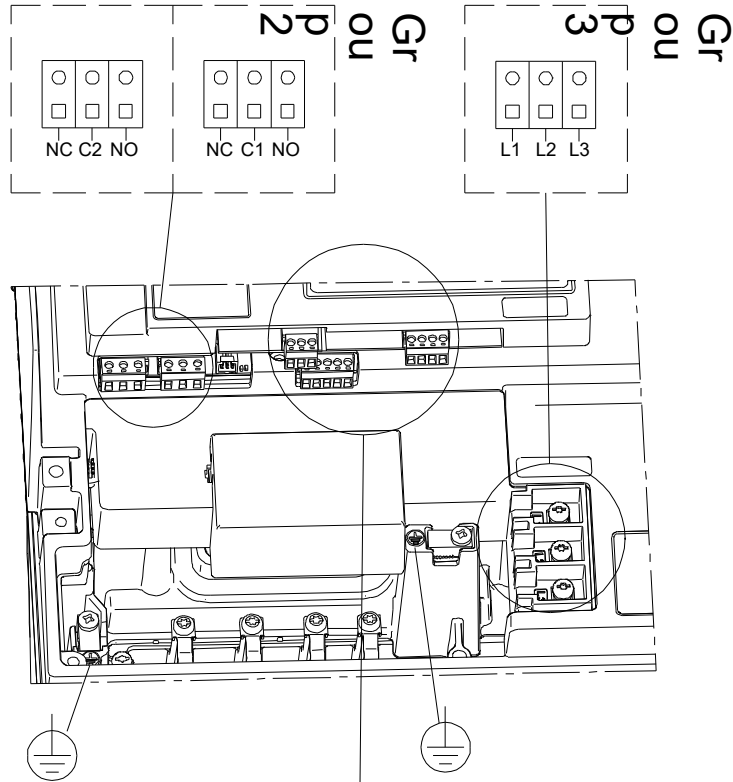

Note! All units are in [in] unless others are stated.